



Doing Our Best to Provide You the Best

AC20034, Rev 7
02/15

"QUICK TACH" INLINE

Side Mount Tanks



OPERATOR MANUAL

INTRODUCTION

Thank you for purchasing a Demco "Quick Tach" Inline Side Mount Tanks. We feel you have made a wise choice and hope you are completely satisfied with your side mounts and tanks. If you have any questions regarding the applications of certain solutions or chemicals, contact your chemical supplier and follow chemical manufacturer recommendations as well as all licensing and use restrictions or regulations.

WARRANTY POLICY, OPERATOR MANUALS, PARTS MANUALS & REGISTRATION

Go online to www.demco-products.com to review Demco warranty policies, operator manuals and register your Demco product.



WARNING: TO AVOID PERSONAL INJURY OR PROPERTY DAMAGE, OBSERVE FOLLOWING INSTRUCTIONS:

Chemicals are dangerous. Know exactly what you’re going to do and what is going to happen before attempting to work with these products. Improper selection or use can injure people, animals, plants and soil.

Always wear protective clothing such as coveralls, goggles and gloves when working with chemicals or sprayer.

Be sure to dispose of all unused chemicals or solutions in a proper and ecologically sound manner.

GENERAL INFORMATION

1. Unless otherwise specified, high-strength (grade5) (3 radial-line head markings) hex head bolts are used throughout assembly of this sprayer.

2. Whenever terms **"LEFT"** and **"RIGHT"** are used in this manual it means from a position behind tractor and facing forward.
3. When placing a parts order, refer to this manual for proper part numbers and place order by **PART NO. and DESCRIPTION.**

Table of Contents

General information.....	2
Safety Instructions	3-9
Bolt Torque.....	10
Assembly Instructions for Side Mount Brackets.....	11
300 Gallon Skid Mount and Tank Assembly	12
Plumbing and Options	13
Optional Wheel Jackstand.....	13
Equipment Checklist.....	15

TAKE NOTE! THIS SAFETY ALERT SYMBOL FOUND THROUGHOUT THIS MANUAL IS USED TO CALL YOUR ATTENTION TO INSTRUCTIONS INVOLVING YOUR PERSONAL SAFETY AND SAFETY OF OTHERS. FAILURE TO FOLLOW THESE INSTRUCTIONS CAN RESULT IN INJURY OR DEATH!



**THIS SYMBOL MEANS
ATTENTION
BECOME ALERT
YOUR SAFETY IS INVOLVED!**

SIGNAL WORDS:

This manual uses the following signal words--**DANGER**, **WARNING**, and **CAUTION**-- with safety messages. The appropriate signal word has been selected using the following guidelines.

WARNING:

Indicates a potentially hazardous situation that, if not avoided, could result in death or serious injury, and includes hazards that are exposed when guards are removed. It may also be used to alert against unsafe practices.

DANGER:

Indicates an imminently hazardous situation that, if not avoided, will result in death or serious injury. This signal word is to be limited to most extreme situations typically for machine components which, for functional purposes, cannot be guarded.

CAUTION:

Indicates a potentially hazardous situation that, if not avoided, may result in minor or moderate injury. It may also be used to alert against unsafe practices.

If you have questions not answered in this manual, require additional copies, or if your manual is damaged, please contact your dealer or DEMCO, 4010 320th Street, Boyden, IA 51234
ph: (712) 725-2311 or Toll Free: 1-800-543-3626 Fax: (712) 725-2380 or 1-800-845-6420
<http://www.demco-products.com>



SAFETY...YOU CAN LIVE WITH IT



EQUIPMENT SAFETY GUIDELINES

Every year many accidents occur which could have been avoided by a few seconds of thought and a more careful approach to handling equipment. You, the operator, can avoid many accidents by observing the following precautions in this section. To avoid personal injury, study the following precautions and insist those working with you, or you yourself, follow them.

In order to provide a better view, certain illustrations in your owners manual may show an assembly with a safety shield removed. However, equipment should never be operated in this condition. Keep all shields in place. If shield removal becomes necessary for repairs, replace shield prior to use.

Replace any caution, warning, danger or instruction safety decal that is not readable or is missing.

Do not attempt to operate this equipment under the influence of alcohol or drugs.

Review safety instructions with all users annually.

Operator should be a responsible adult. **DO NOT ALLOW PERSONS TO OPERATE OR ASSEMBLE THIS UNIT UNTIL THEY HAVE DEVELOPED A THOROUGH UNDERSTANDING OF SAFETY PRECAUTIONS AND HOW IT WORKS.**

To prevent injury or death, use a tractor equipped with a roll over protective system (ROPS). Do not paint over, remove, or deface any safety signs or warning decals on your equipment. Observe all safety signs and practice instructions on them.

Never exceed limits of a piece of machinery. If its ability to do a job, or to do so safely is in question **DON'T TRY IT.**



LIGHTING AND MARKING

It is the responsibility of customer to know lighting and marking requirements of local highway authorities and to install and maintain equipment to provide compliance with regulations. Add extra lights when transporting at night or during periods of limited visibility.

Lighting kits are available from your dealer or from manufacturer.



TIRE SAFETY

- Failure to follow proper procedures when mounting a tire on a rim can produce an explosion which may result in a serious injury or death.
- Do not attempt to mount a tire unless you have proper equipment and experience to do job.
- Inflating or servicing tires can be dangerous. Whenever possible, trained personnel should be called to service and/or mount tires.
- Always order and install tires and wheels with appropriate type and load capacity to meet or exceed anticipated weight to be placed on sprayer.

**SAFETY SIGN CARE**

- Keep safety signs clean and legible at all times.
- Replace safety signs that are missing or have become illegible.
- Replacement parts that displayed a safety sign should also display current sign.
- Safety signs are available from your distributor, dealer parts department, or factory.

How to install safety signs:

- Be sure that installation area is clean and dry.
- Decide on exact position before you remove backing paper.
- Remove smallest portion of split backing paper.
- Align decal over specified area and carefully press small portion with exposed sticky backing in place.
- Slowly peel back remaining paper and carefully smooth remaining portion of decal into place.
- Small air pockets can be pierced with a pin and smoothed out using piece of decal backing paper.

**REMEMBER**

Your best assurance against accidents is a careful and responsible operator. If there is any portion of this manual or function you do not understand, contact your local authorized dealer or manufacturer.

**BEFORE OPERATION:**

- Carefully study and understand this manual and the Owner's Manual.
- Do not wear loose-fitting clothing which may catch in moving parts.
- Always wear protective clothing and substantial shoes.
- It is recommended that suitable protective hearing and eye protection be worn.
- Operator may come in contact with certain materials which may require specific safety equipment relative to handling of such materials. (Examples: extreme dust, molds, fungus, bulk fertilizers, etc.)
- Keep wheel and lug nuts tightened to specified torque.
- Assure that agricultural implement tires are inflated evenly.
- Give unit a visual inspection for any loose bolts, worn parts, or cracked welds, and make necessary repairs. Follow maintenance safety instructions included in this manual.
- Be sure there are no tools lying on or in equipment.
- Manufacturer does not recommend usage of a tractor with the ROPS removed.
- Move tractor wheels to widest recommended settings to increase stability.

- Do not use the sprayer until you are sure that area is clear, especially around children and animals.
- Don't hurry learning process or take sprayer for granted. Ease into it and become familiar with your new equipment.
- Practice operation of your sprayer and its attachments. Completely familiarize yourself and other operators with its operation before using.
- Use a tractor equipped with Roll Over Protection System (ROPS) and fasten your seat belt prior to starting engine.
- Do not allow anyone to stand between tongue or hitch and towing unit when backing up to equipment.



DURING OPERATION

- Beware of bystanders, **PARTICULARLY CHILDREN!** Always look around to make sure engine of towing vehicle or move unit. This is particularly important with higher speeds as you may not hear people shouting.
- **NOPASSENGERSALLOWED**-Donotcarrypasseengersanywhereonorintractororequipment.
- Keep hands and clothing clear of moving parts.
- Do not clean, lubricate, or adjust your equipment while it is moving.
- When halting operation, even periodically, set tractor or towing unit brakes, disengage PTO, shut off engine, and **remove ignition key.**
- Be especially observant of operating area and terrain - watch for holes, rocks, or other hidden hazards. Always inspect area prior to operation.
 - DO NOT operate near edge of drop-offs or banks.
 - DO NOT operate on steep slopes as overturn may result.
 - Operate up and down (not across) intermediate slopes. Avoid sudden starts and stops.
- Pick the most level possible route when transporting across fields. Avoid edges of ditches, gullies, and steep hillsides.
- Be extra careful when working on inclines.
- Periodically clear equipment of brush, twigs, or other materials to prevent buildup of dry combustible materials.
- Maneuver tractor or towing unit at safe speeds.
- Avoid overhead wires or other obstacles. Contact with overhead lines could cause serious injury or death.
- Allow for sprayer length when making turns.
- Keep all bystanders, pets, and livestock clear of work area.
- Do not walk or work under raised components or attachments unless securely positioned and blocked.
- Avoid loose gravel, rocks, and holes; they can be dangerous for equipment operation or movement.
- Operate towing unit from operator's seat only.

- Never stand alongside of unit with engine running or attempt to start engine and/or operate machine while standing alongside of unit.
- Never leave running equipment attachments unattended.
- As a precaution, always recheck hardware on equipment following every 100 hours of operation. Correct all problems. Follow maintenance safety procedures.



FOLLOWING OPERATION

- Following operation, or when unhitching, stop tractor or towing vehicle, set brakes, shut off engine and **remove ignition key**.
- Store sprayer in an area away from human activity.
- Do not park sprayer where it will be exposed to livestock for long periods of time. Damage and livestock injury could result.
- Do not permit children to play on or around stored unit.
- Make sure all parked machines are on a hard, level surface and engage all safety devices.
- Wheel chocks may be needed to prevent unit from rolling.



HIGHWAY AND TRANSPORT OPERATIONS

- **SAFETY CHAINS:** If equipment is going to be transported on a public highway, always follow state and local regulations regarding safety chains and auxiliary lighting. Be sure to check with local law enforcement agencies for your own particular regulations. Only safety chains (not elastic or nylon/plastic tow straps) should be used to retain connection between towing and towed machines in event of separation of primary attaching system. Use a high strength, appropriately sized hitch pin with a mechanical retainer and attach safety chains. Criss cross chains under tongue and secure to draw bar cage, mounting loops, or bumper frame.
- Adopt safe driving practices:
 - Keep brake pedals latched together at all times. **NEVER USE INDEPENDENT BRAKING WITH MACHINE IN TOW, LOSS OF CONTROL AND/OR UPSET OF UNIT CAN RESULT.**
 - Always drive at a safe speed relative to local conditions, ensure that your speed is low enough for an emergency stop. Keep speed to a minimum.
 - Reduce speed prior to turns to avoid risk of overturning.
 - Always keep tractor or towing unit in gear to provide engine braking when going downhill. Do not coast.
 - Do not drink and drive!
- Comply with state and local laws governing highway safety and movement of farm machinery on public roads.
- Use approved accessory lighting, flags and necessary warning devices to protect yourself and operators of other vehicles on highway during transport. Various safety lights and devices are available from your dealer.
- Use of flashing amber lights is acceptable in most localities. However, some localities prohibit their use. Local laws should be checked for all highway lighting and marking requirements.

- When driving tractor and sprayer on road under 20 m.p.h. (40 kph) at night or during day, use flashing amber warning lights and a slow moving vehicle (SMV) identification emblem.
- Plan your route to avoid heavy traffic.
- Be a safe and courteous driver. Always yield to oncoming traffic in all situations, including narrow bridges, intersections, etc.
- Be observant of bridge load ratings. Do not cross bridges rated lower than gross weight at which you are operating.
- Watch for obstructions overhead and side to side while transporting.
- Always operate equipment in a position to provide maximum visibility. Make allowances for increased length and weight of equipment when making turns, stopping unit, etc.



PERFORMING MAINTENANCE

- Good maintenance is your responsibility. Poor maintenance is an invitation to trouble.
- Make sure there is plenty of ventilation. Never operate engine of towing vehicle in a closed building. Exhaust fumes may cause asphyxiation.
- Before working on this machine, stop towing vehicle, set brakes, shut off engine and **remove ignition key**.
- Always use safety support and block wheels. Never use a jack to support machine.
- Always use proper tools or equipment for job at hand.
- Use extreme caution when making adjustments.
- Follow torque chart in owners manual when tightening bolts and nuts.
- Never use your hands to locate a hydraulic leak on attachments. Use a small piece of cardboard or wood. Hydraulic fluid escaping under pressure can penetrate skin.
- Openings in skin and minor cuts are susceptible to infection from hydraulic fluid. **Without immediate medical treatment, serious infection and reactions can occur.**
- When disconnecting hydraulic lines, shut off hydraulic supply and relieve all hydraulic pressure.
- Replace **all shields** and **guards** after servicing and before moving.
- After servicing, be sure all tools, parts and service equipment are removed.
- Do not allow grease or oil to build up on any steps or platform.
- When replacing bolts, refer to owners manual.
- Refer to bolt torque chart in owners manual for head identification marking.
- Where replacement parts are necessary for periodic maintenance and servicing, genuine factory replacement parts must be used to restore your equipment to original specifications. Manufacturer will not claim responsibility for use of unapproved parts or accessories and other damages as a result of their use.

- If equipment has been altered in any way from original design, manufacturer does not accept any liability for injury or warranty.
- A fire extinguisher and first aid kit should be kept readily accessible while performing maintenance on this equipment.
- Be certain all moving parts and attachments have come to a complete stop before attempting to perform maintenance.

TORQUE SPECIFICATION



TORQUE SPECIFICATION

Torque figures indicated are valid for non-greased or non-oiled threads and heads unless otherwise specified. Therefore, do not grease or oil bolts or capscrews unless otherwise specified in this manual. When using locking elements, increase torque values by 5%.

* GRADE or CLASS value for bolts and capscrews are identified by their head markings.

BOLT TORQUE DATA FOR STANDARD NUTS, BOLTS, AND CAPSCREWS.

Tighten all bolts to torques specified in chart unless otherwise noted. Check tightness of bolts periodically, using bolt chart as guide. Replace hardware with same grade bolt.

NOTE: Unless otherwise specified, high-strength Grade 5 hex bolts are used throughout assembly of equipment.

Bolt Torque for Standard bolts *						
"A"	GRADE 2		GRADE 5		GRADE 8	
	lb-ft	(N.m)	lb-ft	(N.m)	lb-ft	(N.m)
1/4"	6	(8)	9	(12)	12	(16)
5/16"	10	(13)	18	(25)	25	(35)
3/8"	20	(27)	30	(40)	45	(60)
7/16"	30	(40)	50	(70)	80	(110)
1/2"	45	(60)	75	(100)	115	(155)
9/16"	70	(95)	115	(155)	165	(220)
5/8"	95	(130)	150	(200)	225	(300)
3/4"	165	(225)	290	(390)	400	(540)
7/8"	170	(230)	420	(570)	650	(880)
1"	225	(300)	630	(850)	970	(1310)

Bolt Torque for Metric bolts *						
"A"	CLASS 8.8		CLASS 9.8		CLASS 10.9	
	lb-ft	(N.m)	lb-ft	(N.m)	lb-ft	(N.m)
6	9	(13)	10	(14)	13	(17)
7	15	(21)	18	(24)	21	(29)
8	23	(31)	25	(34)	31	(42)
10	45	(61)	50	(68)	61	(83)
12	78	(106)	88	(118)	106	(144)
14	125	(169)	140	(189)	170	(230)
16	194	(263)	216	(293)	263	(357)
18	268	(363)	--	--	364	(493)
20	378	(513)	--	--	515	(689)
22	516	(699)	--	--	702	(952)
24	654	(886)	--	--	890	(1206)

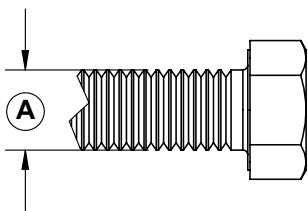

GRADE-2

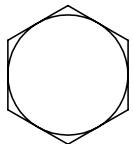

GRADE-5

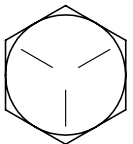

GRADE-8

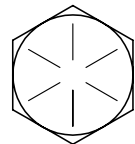

CLASS 8.8

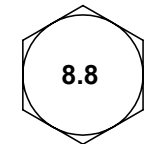

CLASS 9.8

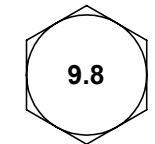

CLASS 10.9



ASSEMBLY INSTRUCTIONS FOR SIDE MOUNT BRACKETS

Preparations

- Remove front fenders and front fender stops.
- Remove auxiliary ground bolts.

1. Mount the right and left mounting attachments (#8, #9) to the sides of the tractor as shown in View A. **Refer to the Tractor specific page for the Mounting Brackets, Attachments, and Fasteners part numbers.** Tighten only one of the mounting attachments leaving the other loose.

2. Insert all but two of the 3/4" bolts (#5) as shown in **View A** into the mounting plates. Use all of the holes except the outside top hole on both sides. Then place a 3/4" lockwasher (#3) and nut (#4) on, but do not tighten the bolts.

3. If a spacer assembly is included in the baseplate kit, attach the spacer assembly (#10) to the mounting attachments using the specified fasteners listed on Tractor specific page. The spacer assembly will slide in between the two mounting attachments beneath the underbelly of the tractor.

4. Tighten the bolts securing the mounting brackets to the tractor. Then tighten the bolts securing the spacer assembly to the mounting attachments. Make sure to tighten bolts in that order. Torque the fasteners according to the tables on page 10.

5. Insert main frame assembly (#1), into the mounting brackets between the 3/4" bolts (#5). Make sure the keystick is to the top and closest to the tractor.

6. Insert the last two 3/4" bolts (#5) (one for each side) from the front of the tractor. Then place 3/4" lockwasher (#3) and nut (#4) on. Make sure the bolts are to the outside of the keystick. Torque all the 3/4" bolts (#5) on the mounting brackets according to the tables on page 10. Tighten the outside bolts first, and work towards the tractor.

7. Mount the rail assembly (#2) on the door side of the tractor with the step to the front of the tractor. Measure in 38" from the outside of the 7" tube for an estimated setting for the right side of the rail assembly. Use 1/2" bolts (#6) and 1/2" nylon insert locknuts (#7) to fasten. Do not tighten bolts. After skid mounts are mounted securely the rail may be spaced evenly between and securely fastened down.

Torque all bolts according to specs on page 10.

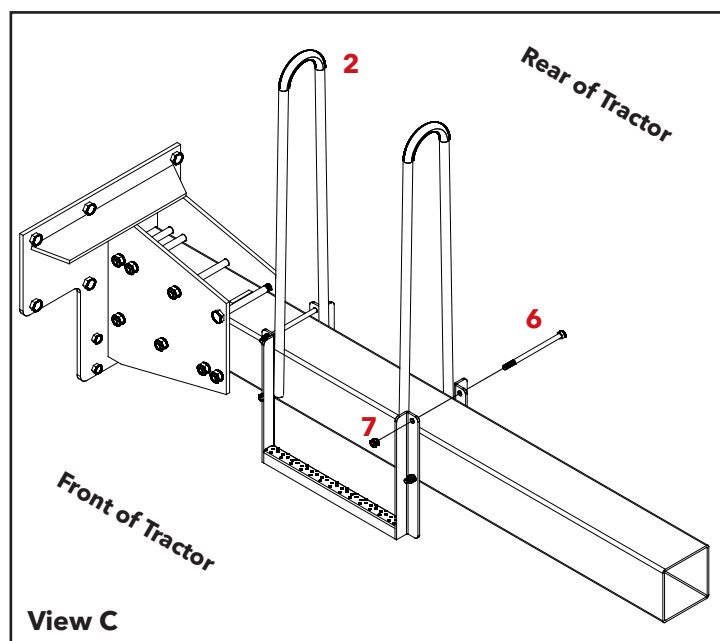
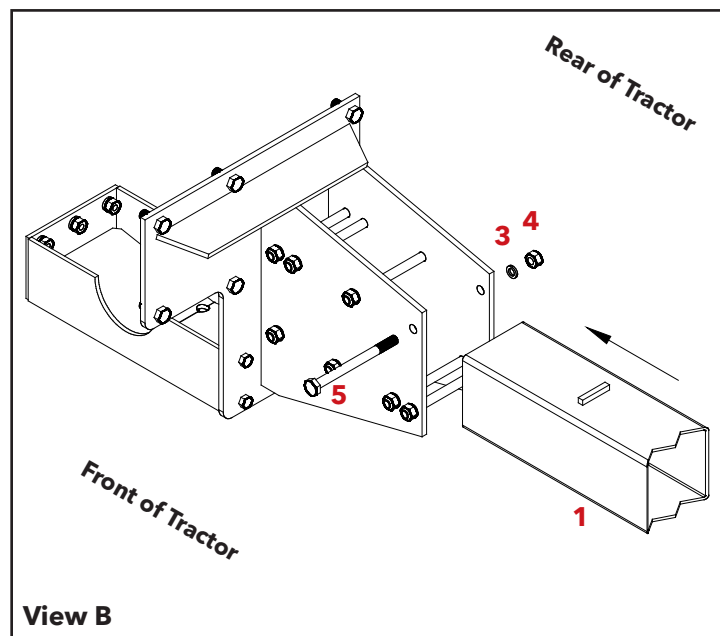
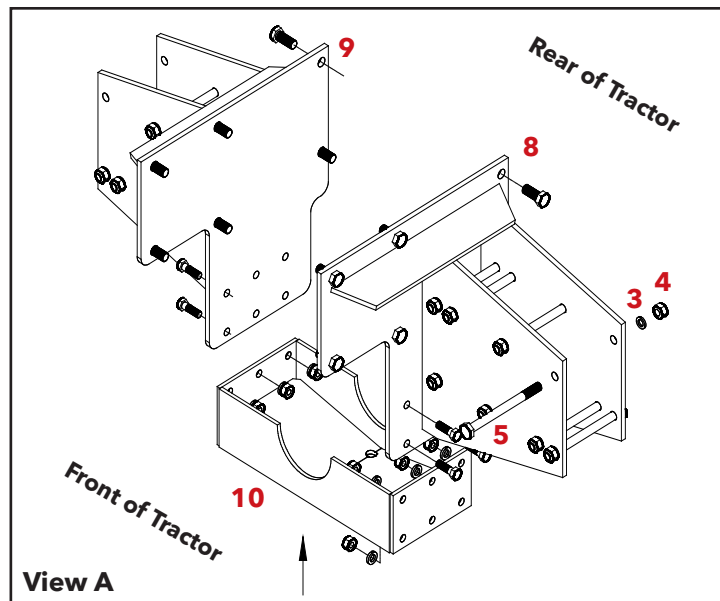

REF	PART #	QTY.	DESCRIPTION
1	09631-76	2	Main Frame Assembly (7"x7")
-	14652-76	2	Main Frame Assembly (7"x5")
2	09626-76	1	Rail Step Assembly
3	00254	16	3/4" Lockwasher
4	00253	16	3/4"-10UNC Hex Nut
5	07681	16	3/4"-10UNC x 9" Hex Bolt (Gr.5)
-	01964	16	3/4"-10UNC x 7" Hex Bolt (Gr.5)
6	00678	4	1/2"-13UNC x 8-1/2" Hex Bolt (Gr.5)
-	04916	4	1/2"-13UNC x 6-1/2" Hex Bolt (Gr.5)
7	00083	4	1/2"-13UNC Hex Nut
8	-	1	Mounting Attachment (Left Side)
9	-	1	Mounting Attachment (Right Side)
*10	-	1	Spacer Assembly

Order replacement parts by PART NO. and DESCRIPTION.

*A Spacer Assembly may not be required for every tractor. See your specific tractor insert for Mounting Brackets, Attachments, and Fasteners part numbers

300 GALLON SKID & TANK ASSEMBLY

Assembly

1. Mount the outer front support with stand mount (#3) with outer rear support with stand mount (#4) on to the 7" square tube. Use 5/8" bolts (#7) and nylon insert locknuts. Make sure back plate of the stand mount gusset supports are flush with the outside of tube. Then tighten the bolts.
2. Mount the inner front angle support (#1) with inner rear angle support (#2) to the 7" tube. Use 5/8" bolts (#7) and nylon insert locknuts. Leave bolts loose so that it may be adjusted on the tube.
3. Mount the skid mount (#5) to the angle support gussets and stand mount gussets from steps 1 and 2. Line up the slots on the skid mount with the holes on the stand mount gussets and angle support gussets. Insert 1/2" bolts (#9) with flatwashers (#10) from the top and place nut (#11) on the under side.
4. Tighten bolts that hold angle support gussets to tube. Then tighten the bolts holding skid mount to stand mount gussets and angle gusset supports.
5. Mount tank (#6) to skid mount (#5). Line up flat spots on the bottom of the tank to cross members on skid mount. Put the two 4" straps (#12) over the top of tank and secure them with the strap brackets (#13) with the holes on the rails of the skid mount. Use 3/8" full threaded bolts (#14) with nut (#15) to secure. Use the view to the right to properly secure the strap to the strap bracket.

- * Torque all bolts according to specs on page 10.
- * Follow same procedure for opposite side.

Strap Assembly

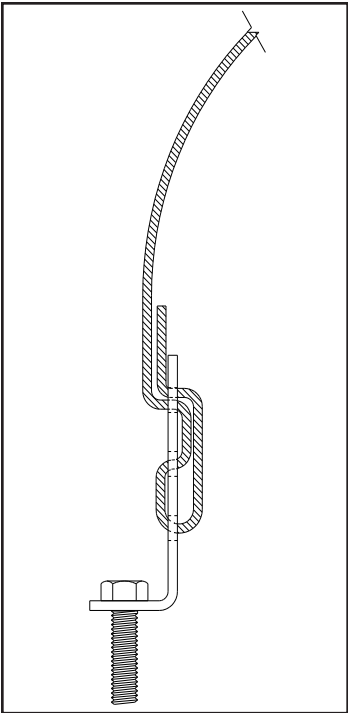

REF	PART #	QTY.	DESCRIPTION
1	09618-76	2	Inner Front Angle Support
2	09619-76	2	Inner Rear Angle Support
3	09638-76	2	Outer Front Support w/Stand Mount
4	09639-76	2	Outer Rear Support w/Stand Mount
5	09628-76	2	Skid Mount
6	PC300A	2	Tank with Lid
7	04835	16	5/8-11UNC x 9" Hex Bolt Gr.5
-	04836	16	5/8-11UNC x 7" Hex Bolt Gr.5
8	02587	16	5/8-11UNC Nylon Insert Locknut
9	00967	24	1/2-13UNC x 1-1/4" Hex Bolt Gr.5
10	00085	24	1/2 Flatwasher
11	02178	24	1/2-13UNC Nylon Insert Locknut
12	09829	4	4" Tie Down Strap x 94"
13	05784-95	8	Tie Down Strap Bracket
14	01885	16	3/8-16UNC x 5" Full Thread
15	02592	16	3/8-16UNC Nylon Insert Locknut
16	5470R	1	Replacement Tank Lid with 4" Vent Cap

Order replacement parts by PART NO. and DESCRIPTION.

LEFT SIDE SHOWN (Quantities are for both sides)

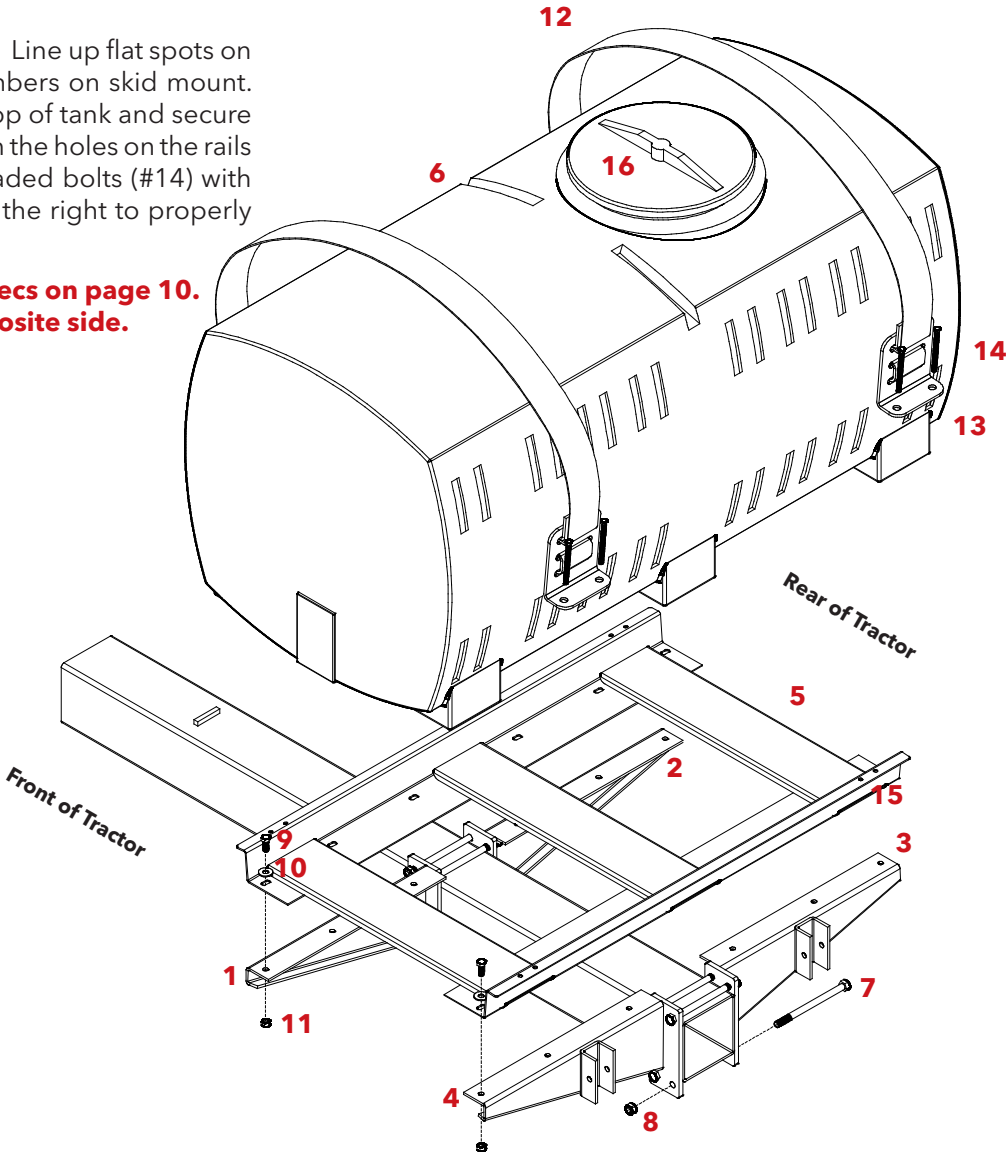

REF	PART #	QTY.	DESCRIPTION
D3371PSA - Tank Agitation Assy (Item #1-#5)			
1	5044 1	2	Jet Agitation Wand
2	FC1200	1	1/2" FPT Coupling
3	M1200	1	1/2" MPT Close Nipple (GFP)
4	P012DA	1	1/2" Bulkhead Fitting, Double Thread
5	R1212	1	Agitation Tee Fitting
6	P114A	1	1-1/4" Bulkhead Fitting, Double Thread
7	11422	1	Anti-Vortex Plate

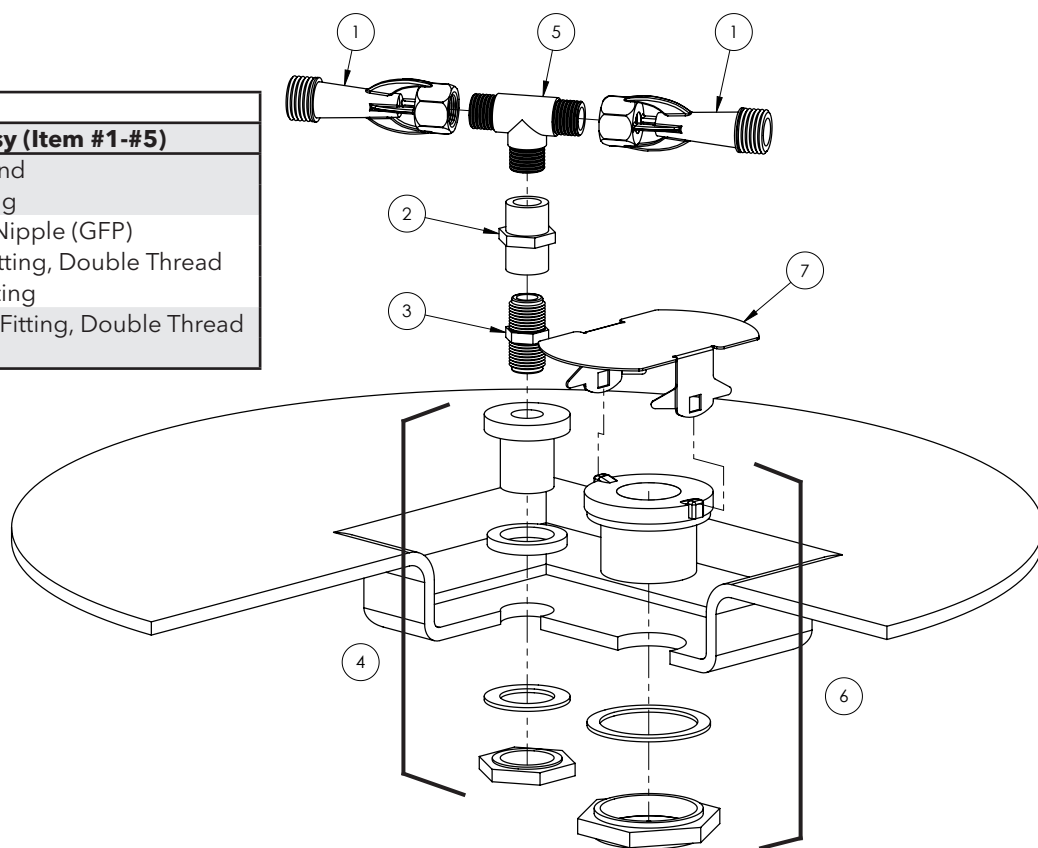

OPTIONAL WHEEL JACKSTANDS (9470015)

REF	PART #	QTY.	DESCRIPTION
1-14	9470015	1	Optional Wheels and Jackstand
1	09632-76	1	Stand Mounting Bracket
2	09633-76	1	Backing Plate
3	00678	2	1/2-13UNC x 8.5" Hex Hd. Bolt
4	02178	3	1/2-13UNC Nylon Insert Locknut
5	00182	3	Hair Pin
6	00477	4	5/8 Flatwasher
7	00489	2	5/8 Jam Nut
8	01718-95	3	Lock Pin
9	02496	2	5/8-11UNC x 4" Hex Hd. Bolt
10	02587	2	5/8-11UNC Nylon Insert Locknut
11	03646	2	6" x 2" Wheel
12	05290	1	1/2-13UNC x 3 1/4" Hex Hd. Nut
13	07551-76	3	Wheel Mount Stand
14	07552-76	1	Stand Base

Order replacement parts by PART NO. and DESCRIPTION.

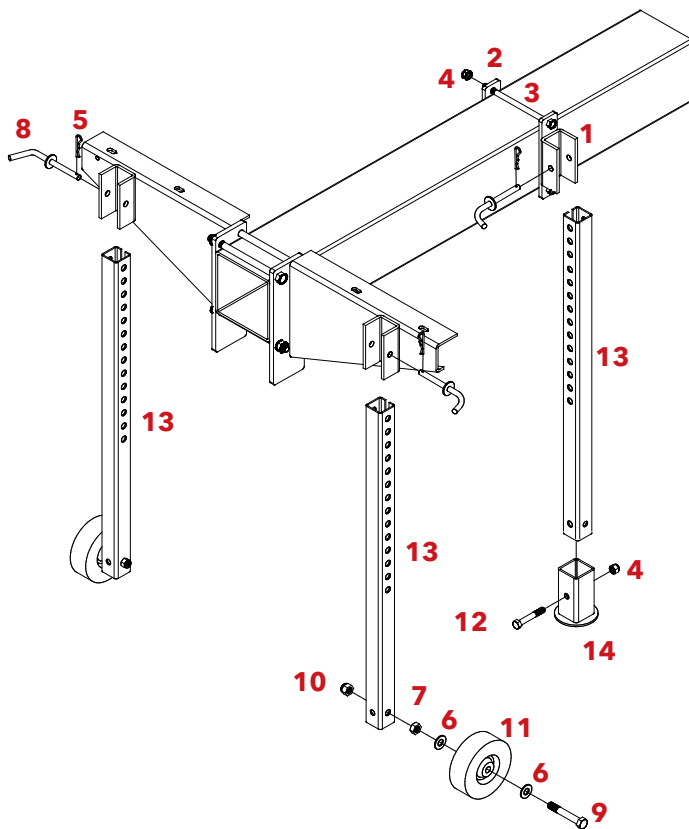

EQUIPMENT CHECKLIST:

Downtime caused by field breakdowns is costly and time consuming. Many breakdowns can be eliminated by periodic equipment maintenance. By spending time reviewing this checklist before seasonal spraying application time and following proper after-season care, you can save time and money later.

After Season Care:

NOTE: It is important to wear proper safety equipment when cleaning the sprayer. See your chemical or

WARNING: To Prevent Serious Injury Or Death

- Keep hands, feet, and loose clothing away from rotating parts.
- Wear protective clothing recommended by your chemical and fertilizer manufacturer when working with chemicals.

Check Before Going To The Field :

1. HOSES

Check all hoses for worn or soft spots. Be sure all hose clamps are tightened and hoses are not kinked or pinched. Check for leakage in any lines.

2. TANK

Inspect fitting and grommets to insure they are in good condition.

3. CONTROLS

Check for leakage, plugging, or wear on all valves, fittings, etc. Clean off any build up of foreign material.

4. PUMP

Check to be sure pump turns freely.

5. FRAME

Be sure all bolts are tightened.

6. REPLACEMENT PARTS

Replace all worn or damaged parts.

fertilizer package for this information.

1. After spraying chemicals, run water mixed with cleaners through tank, pump and all hose hookups. If wettable powder dries out in the system, it is very difficult to put back into suspension and can cause malfunction, damage or injury.
2. When cleaned, tank should have all openings closed or covered to keep dirt from entering.
3. Pump should be flushed with soluble oil and pump ports plugged to keep out moisture and air.
4. Disassemble tips and rinse with water or cleaning solution. (Appropriate for chemical sprayed). Never use wire or hard object that could distort opening.
5. Dispose of all unused chemicals or solutions in a proper and ecologically sound manner.
6. Water rinse and dry tips before storing.

NOTE: DEMCO does not and will not make any recommendations concerning application of various chemicals or solutions. These recommendations relate to either amount or procedure of materials applied. If you have any questions regarding application of certain chemicals or solutions, contact your chemical supplier and follow chemical manufacturer recommendations.



4010 320th St., Boyden, IA. 51234

Phone: (712) 725-2311

Fax: (712) 725-2380

Toll Free: 1-800-54DEMCO (1-800-543-3626)

**Demco warranty policies, operator manuals, and product registration
can be found online:**

www.demco-products.com