

PREP RAILS UL 6099

Dodge

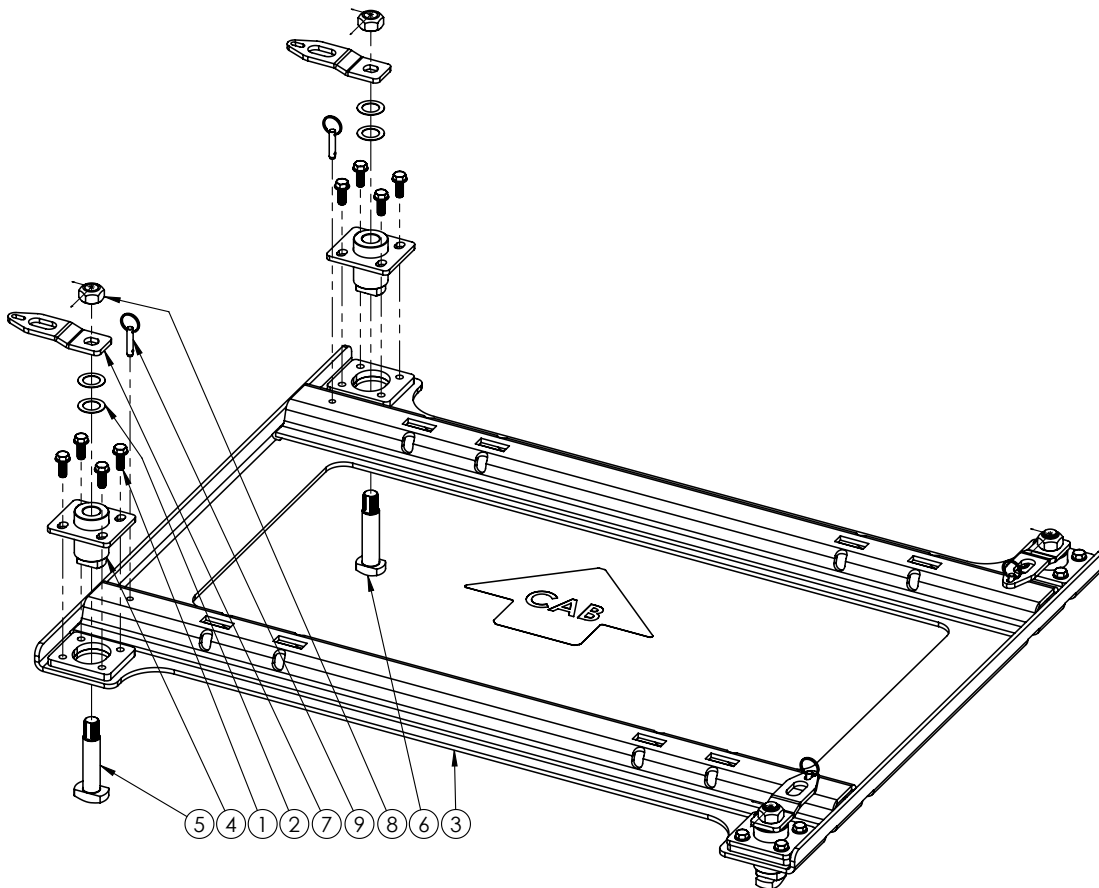

ITEM	PART #	QTY	DESCRIPTION
1	14930	16	BOLT .375NC X 1.00 GR5 HEX W/ SRTD FLNG
2	14423	8	WASHER SHIM .875 ID X .030 THK
3	14915-76	1	DODGE PREP FRAME
4	17133-76	4	DODGE RAM PREP SOCKET
5	17113-91	2	LOCKING STUD F/RAM (GOLD)
6	17112-95	2	LOCKING STUD (SILVER)
7	17134-95	4	HANDLE
8	09726	4	NUT .75NF LOCK STOVER GR. C
9	15826	4	PIN, QUICK RELEASE .313 X 1.00

Please order replacement parts by PART NO. and DESCRIPTION



1. Remove covers from each mounting pod (except the center) in the truck bed.
2. On first install, make sure the four bolts on the four latches are loose before installing.
3. Pull the quick release pins and turn the handles 90 degrees left or right. Place the main frame with the silver locking studs to the front of the truck bed and the gold locking studs to the tailgate side of the truck. Reference decal on prep bracket.

IMPORTANT NOTE: Apply a little grease or lubricant to the part of the pins that insert into the mounting pods to help maintain smooth operation and rotation of pins and to protect from the elements. Turn the pins occasionally to prevent them from seizing. **If handles turn to hard for desired fit remove nut on top of handle and remove one shim from the top. Repeat if needed. Location of shims shown on manual cover.**

4. Pull back on main frame towards back of truck and snug the prep socket bolts. Make sure studs are free to operate and the prep frame can be easily removed. Once this is done torque all bolts to 35 ft-lbs.

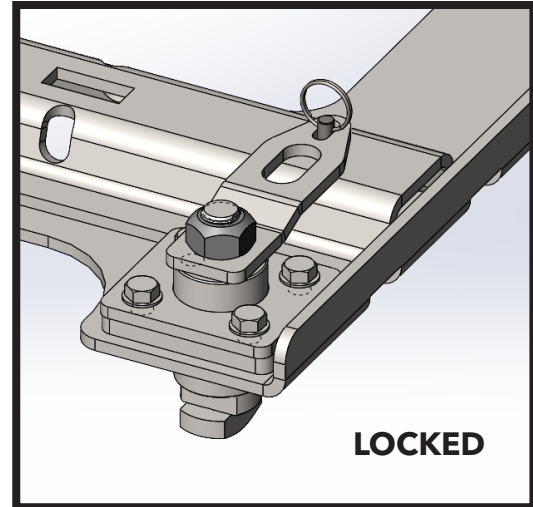
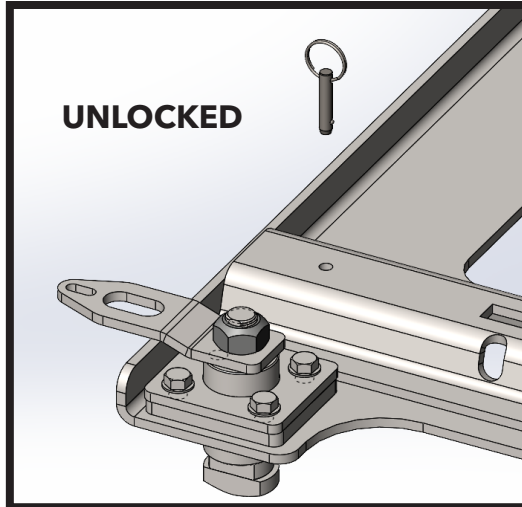

5. Once prep socket bolts are torqued properly, turn the handles 90 degrees back and place the quick release pin back into the hole, making sure the quick release pin does not fall out.

DEMCO

4010 320th St., Boyden, IA. 51234

Phone: (712) 725-2311

Fax: (712) 725-2380

Toll Free: 1-800-54DEMCO (1-800-543-3626)

Demco warranty policies, operator manuals, and product registration
can be found online:

www.demco-products.com

