



Doing Our Best to Provide You the Best

8H000023, Rev A
9/23

HEAD TRANSPORT BRACKETS

9H000005, 9H000006, 9H000035, 9H000067 & 9H000094

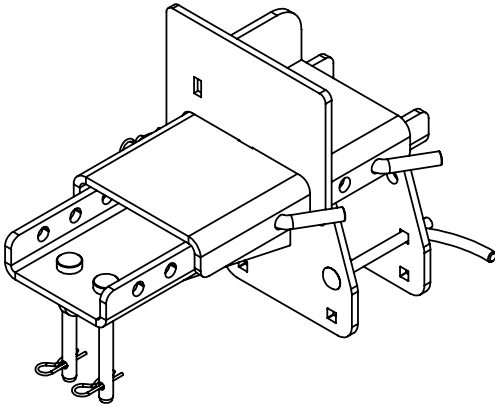

9H000006

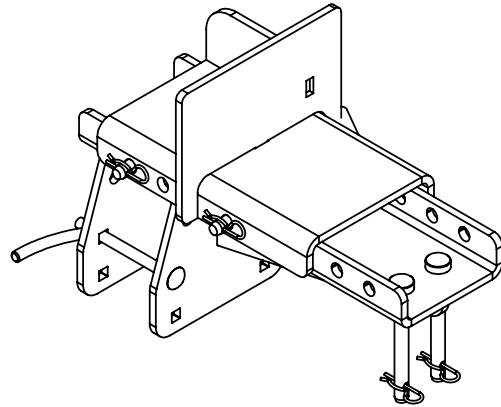

9H000005

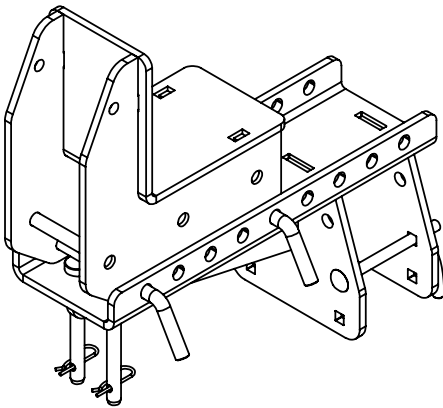

9H000035

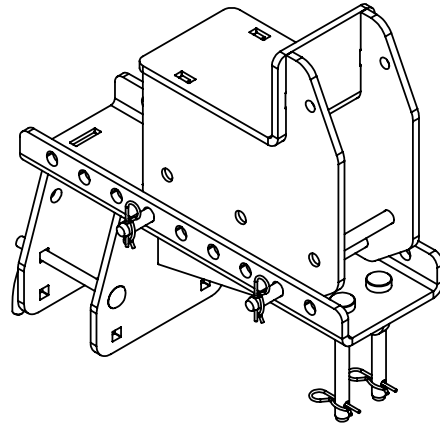

9H000067

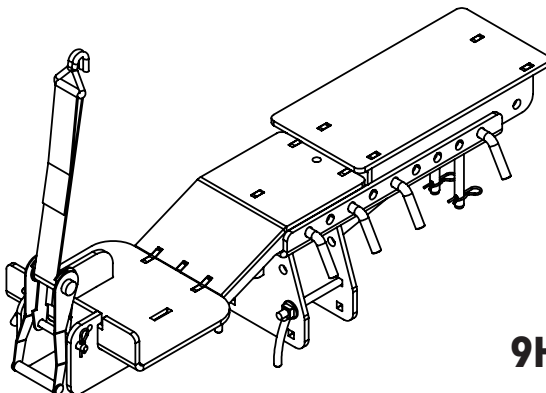

9H000094

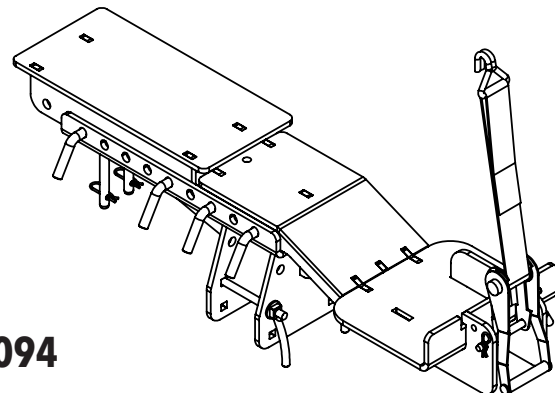

INSTALLATION MANUAL

INTRODUCTION

Thank you for purchasing Demco Head Transport Brackets. We feel you have made a wise choice and hope you are completely satisfied with your new brackets. Proper care and use will result in many years of service.

WARRANTY POLICY, OPERATOR MANUALS, PARTS MANUALS & REGISTRATION

Go online to www.demco-products.com to review Demco warranty policies, operator manuals and register your Demco product.

GENERAL INFORMATION

1. Unless otherwise specified, high-strength (grade 5) (3 radial-line head markings) hex head bolts are used throughout assembly of this piece of equipment.

2. Whenever terms "LEFT" and "RIGHT" are used in this manual it means from a position behind the combine head transport and facing forward.
3. When placing a parts order, refer to this manual for proper part numbers and place order by PART NO. and DESCRIPTION.

4. Read assembly instructions carefully. Study assembly procedures and all illustrations before you begin assembly. Note which parts are used in each step. This unit must be assembled in proper sequence or complications will result.

TABLE OF CONTENTS

Introduction

General Information & Table of Contents

Safety Signal Words

9H000005 & 9H000006 STANDARD SADDLE BRACKET

9H000035 & 9H000067 L5 & L8 BRACKET ASSEMBLY

9H000094 JD HINGED DRAPER BRACKET ASSEMBLY

NOTES

2

2

2

4-5

6-7

8-10

11

SAFETY SIGNAL WORDS

Throughout this manual, the term IMPORTANT is used to indicate that failure to observe can cause damage to equipment. The terms CAUTION, WARNING and DANGER are used in conjunction with the Safety-Alert Symbol (a triangle with an exclamation mark) to indicate the degree of hazard for items of personal safety.

- 

This Safety-Alert Symbol indicates a hazard and means ATTENTION! BECOME ALERT! YOUR SAFETY IS INVOLVED!
-  **DANGER**

Indicates an imminently hazardous situation that, if not avoided, will result in death or serious injury.
-  **WARNING**

Indicates a potentially hazardous situation that, if not avoided, could result in death or serious injury, and include hazards that are exposed when guards are removed.
-  **CAUTION**

Indicates a potentially hazardous situation that, if not avoided, may result in minor or moderate injury.
- IMPORTANT**

Indicates that failure to observe can cause damage to equipment.
- NOTE**

Indicates helpful information.

THIS PAGE INTENTIONALLY LEFT BLANK

Right Mounting Bracket - 9

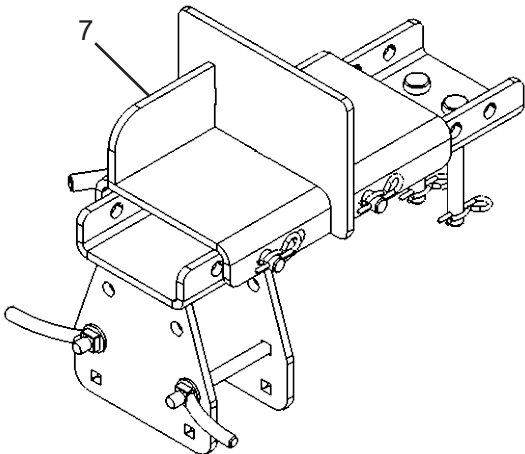

Left Mounting Bracket - 10

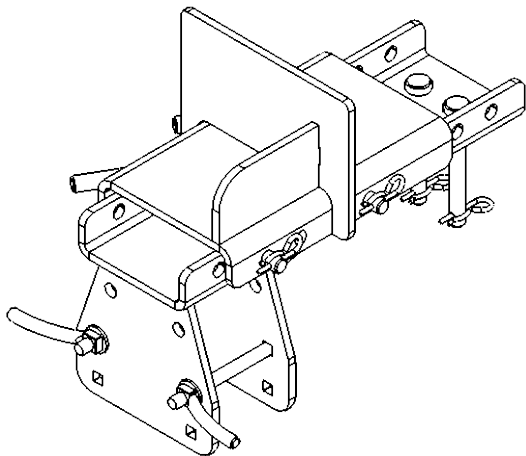

Ref No.	Part Number	Qty	Description
1	1AF052BBAH0	4	1/8" X 2-1/2" BRIDGE PIN
2	1AFC04HEAH0	2	1/2" X 5-1/2" CARRIAGE BOLT PLATED
3	1AFZ29H0000	2	1/2"-13 HANDLE NUT
4	1AFZ51JHAH0	2	5/8" X 8-1/2" BENT PIN LONG
5	1AFZ06JEAD0	2	5/8" X 5-1/4" CLEVIS PIN - SHORT
6	5H000153	1	HT ADJUSTABLE SLIDER - BASE ASSY
7	5H000009	1	STANDARD SADDLE BRACKET TOP - RIGHT
8	5H000010	1	STANDARD SADDLE BRACKET TOP - LEFT
9	9H000005	1	STANDARD SADDLE BRACKET ASSY - RIGHT
10	9H000006	1	STANDARD SADDLE BRACKET ASSY - LEFT

Please order replacement parts by Part Number and Description.

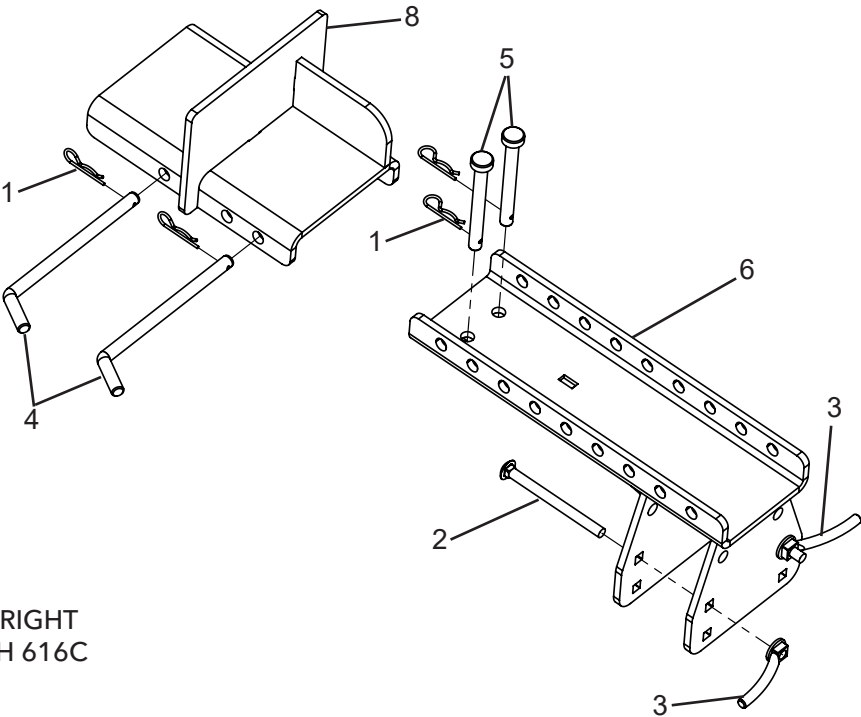

WARNING DO NOT USE LEFT AND RIGHT STANDARD SADDLE BRACKETS WITH 616C OR 618C HEADS

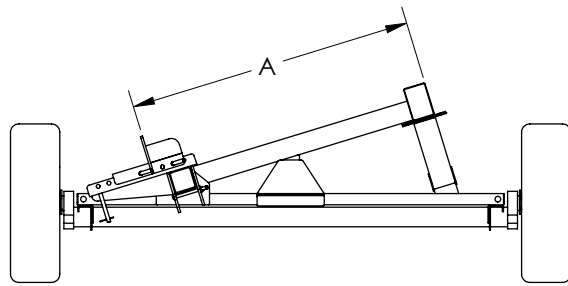

Position #1
End View

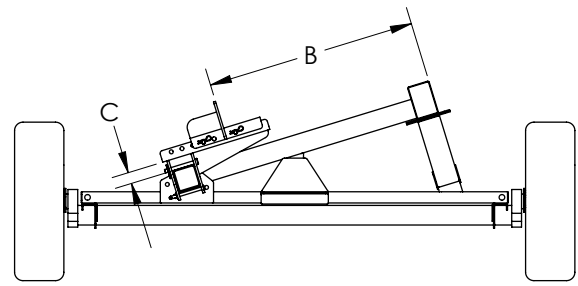

Position #2
End View

Position #1

This is suggested for use with corn heads and draper heads. Notice the Slider-Base Assembly points toward the left side of the transporter. The head will rest against the top slider assembly bracket and on the top rail of the header transport. Adjust the brackets according to dimension "A" and the reference chart provided below.

Position #1 has the brackets shown in the lowered position, which allows the transporter to be utilized for older models of heads and combines. Locate heads so the stalk rollers are to the left of the top rail and there is clearance between the left tire and drive shafts.

Position #2

This is suggested for use with platform type heads. Notice the Slider-Base Assembly points toward the right side of the transporter. The head will rest against the top slider assembly bracket and on the top rail of the header transport. Adjust the brackets according to dimension "B" and the reference chart provided below.

Position #2 has the brackets shown in the raised position. This is illustrated by dimension "C". The brackets are pinned 2 in (5 cm) higher to prevent floating arms on the bottom of platforms from resting on the frame of the transport. This also allows corn head to be raised up and create more clearance between PTO shafts and transport tires. Locate skid shoes so they rest on the top rail.

Brand	Model	Type	"A" Dim.
Gleaner	830 Hug	Corn Head	36.5"(93cm)
Gleaner	3000	Corn Head	52"(132cm)
Harvestec	630, 830	Corn Head	52"(132cm)
IH	944	Corn Head	42"(107cm)
IH	1063	Corn Head	44"(112cm)
IH	2208, 2212	Corn Head	56"(142cm)
JD	643, 843	Corn Head	52"(132cm)
JD	612FC	Corn Head	54"(137cm)
JD	693, 893, 1293	Corn Head	54"(137cm)
JD	894	Corn Head	56"(142cm)
JD	606c, 608c, 612c, 616c, 618c	Corn Head	54"(137cm)
MF	863, 883	Corn Head	48"(122cm)
MF	884	Corn Head	52"(132cm)

Brand	Model	Type	"A" Dim.
JD	936D	Draper	56"(142cm)
JD	625D	Draper	56"(142cm)
JD	630D	Draper	56"(142cm)
JD	635D	Draper	56"(142cm)
JD	640D	Draper	56"(142cm)
JD	635FD	Draper	50"(127cm)
JD	640FD	Draper	50"(127cm)
JD	645FD	Draper	50"(127cm)

Brand	Model	Type	"B" Dim.
Cat	f530	Platform	38.5"(98cm)
Gleaner	550	Platform	36.5"(93cm)
Gleaner	320, 800, 8000	Platform	38.5"(98cm)
IH	1020, 2020	Platform	36.5"(93cm)
JD	935	Platform	36.5"(93cm)
JD	220	Platform	36.5"(93cm)
JD	920, 925	Platform	36"(91cm)
JD	625F, 630F, 635F	Platform	36"(91cm)
JD	930F	Platform	36"(91cm)
JD	620R, 625R, 630R	Platform	36"(91cm)
MF	8000	Platform	38.5"(98cm)
NH	74c	Platform	38.5"(98cm)
NH	973	Platform	42.5"(108cm)
NH	740	Platform	42.5"(108cm)

NOTE Dimensions in these tables are for reference only. Due to model changes and aftermarket equipment, the brackets may have to be adjusted to ensure the header will mount properly on the transport.

L5 BRACKET ASSEMBLY - 9

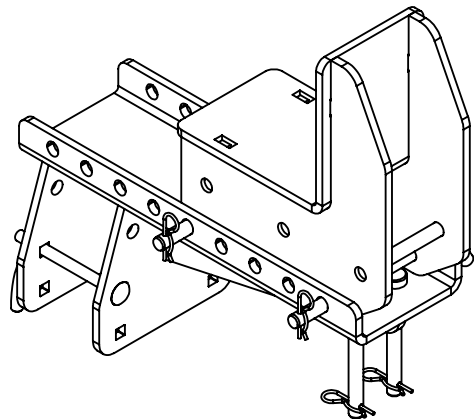

Ref No.	Part Number	Qty	Description
1	1AF052BBAH0	4	1/8" X 2-1/2" BRIDGE PIN
2	1AFC04HFA00	2	1/2"-12 X 6" CARRIAGE BOLT PLATED
3	1AFZ06JEAD0	2	5/8" X 5-1/4" CLEVIS PIN - ZINC PLATED
4	1AFZ29H0000	2	1/2"-13 HANDLE NUT
5	1AFZ51JHAH0	2	5/8" X 8-1/2" BENT PIN LONG
6	5H000152	1	L5 BRACKET - TOP
7	5H000153	1	HT ADJUSTABLE SLIDER - BASE ASSY
8	5H000293	1	L8 BRACKET - TOP
9	9H000035	1	L5 BRACKET ASSEMBLY
10	9H000067	1	L8 BRACKET ASSEMBLY

Please order replacement parts by Part Number and Description.

L8 BRACKET ASSEMBLY - 10

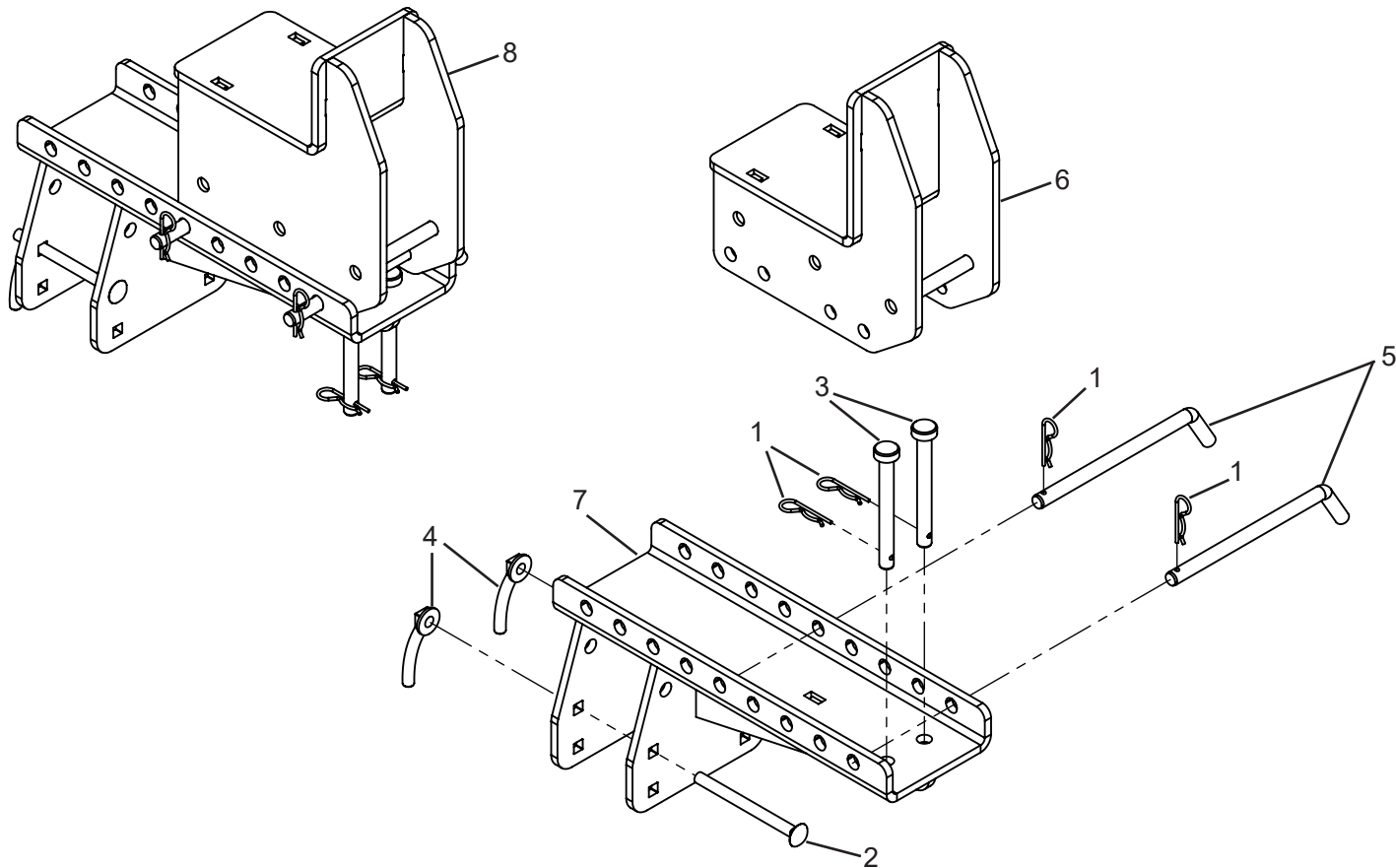

L5 or L8 Bracket Locations for 616C & 618C

This illustration shows the approximate locations for the L5 or L8 Brackets used to mount John Deere 616C & 618C corn heads. The brackets can be raised to allow more clearance between PTO shafts and transport tires. This is done by placing the pins, provided with the bracket, in the upper holes of the clamping plates and resting the pins on the bottom bed rail. The picture to the right shows a bracket in the raised position. The brackets should be adjusted, as needed, so the skid shoes on the head rest on the top bed rail.

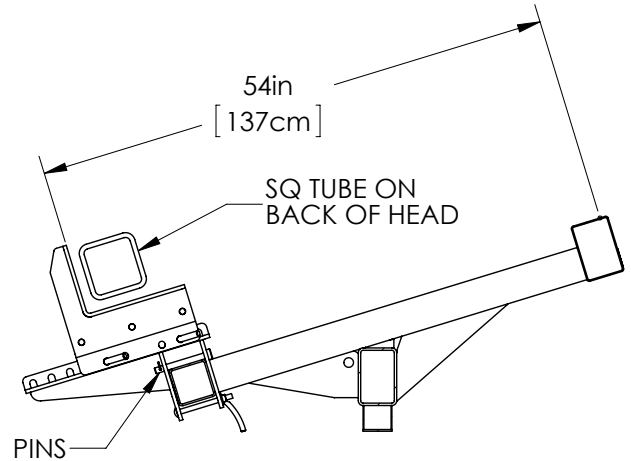

NOTE Dimensions on this page are for reference only. Due to model changes and aftermarket equipment, the brackets may have to be adjusted to ensure the header will mount properly on the transport.

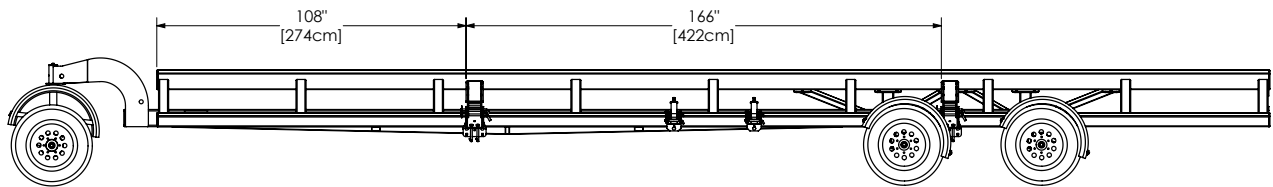

HT or HDHT-32 (618C)

WARNING 2 L5 OR L8 BRACKETS MUST BE USED FOR 618C CORN HEADS

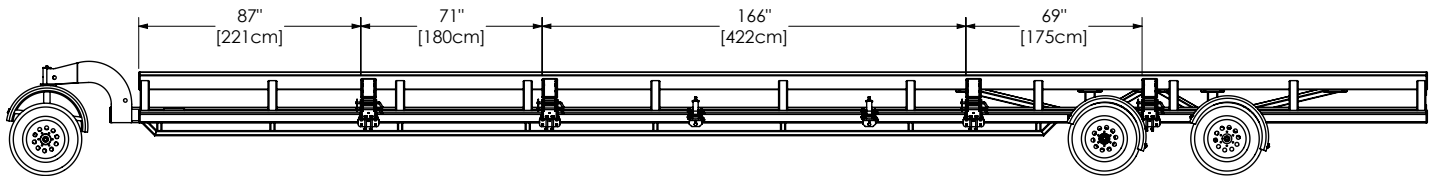

HT or HDHT-42 (616C)

WARNING 4 L5 OR L8 BRACKETS MUST BE USED FOR 616C CORN HEADS

WARNING DO NOT USE LEFT AND RIGHT STANDARD SADDLE BRACKETS WITH 616C OR 618C HEADS

9H000094 JD HINGED DRAPER BRACKET ASSEMBLY

RIGHT BRACKET ASSEMBLY - 15

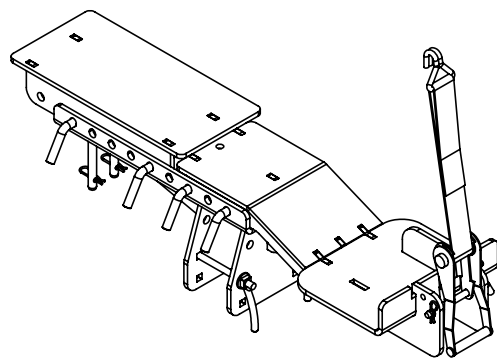

LEFT BRACKET ASSEMBLY - 15

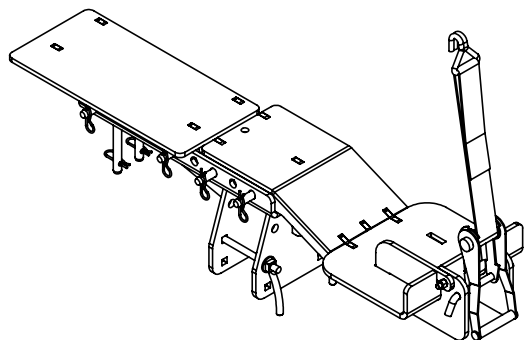

Ref No.	Part Number	Qty	Description
1	1AF052BBAH0	6	1/8" X 2-1/2" BRIDGE PIN
2	1AFC04HFA00	2	1/2"-12 X 6" CARRIAGE BOLT PLATED
3	1AFC12FAAH0	1	3/8" x 1-1/2" HEX BOLT
4	1AFC18F0000	1	3/8"-16 HEX NUT NYLOK
5	1AFZ06JEAD0	2	5/8" x 5-1/4" CLEVIS PIN - ZINC PLATED
6	1AFZ29H0000	2	1/2"-13 HANDLE NUT
7	1AFZ51HEA00	1	1/2 x 5 BENT PIN w/CLIP - ZINC PLATED
8	1AFZ51JHAH0	4	5/8" X 8-1/2" BENT PIN LONG
9	1AU00000196	1	RATCHET WITH HOOK & LOOPED STRAP, 6' LG
10	3H000710	1	JD HINGED DRAPER BRACKET SIDE SUPPORT
11	5H000153	1	HT ADJUSTABLE SLIDER - BASE ASSY
12	5H000468	1	JD HD FEEDER ADD-ON SUPPORT BRACKET
13	5H000469	1	JD HD FEEDER UPPER SUPPORT BRACKET
14	5H000556	1	JD HINGED DRAPER BRACKET TOP KIT (NO BASE)
15	9H000094	1	JD HINGED DRAPER BRACKET ASSY

Please order replacement parts by Part Number and Description.

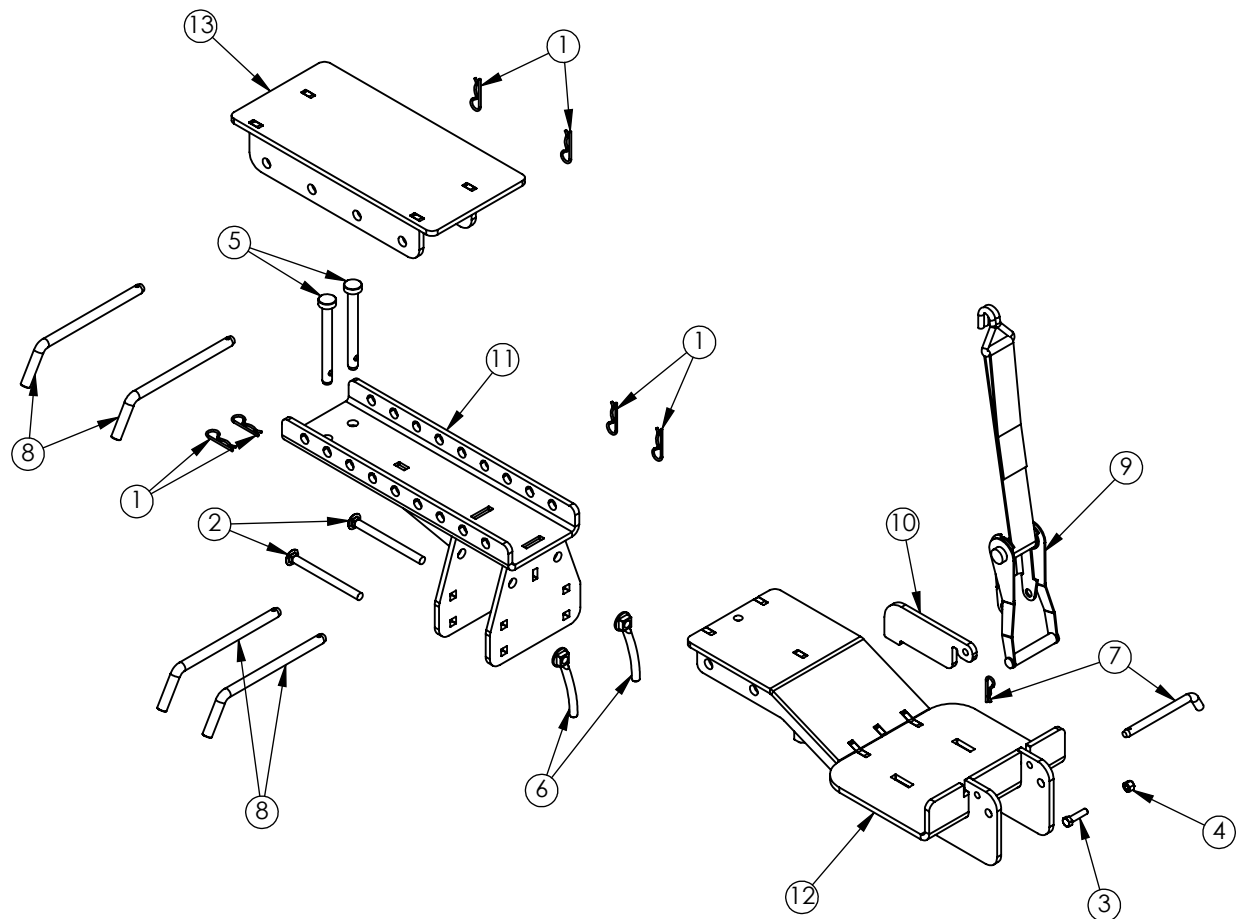

JD HINGED DRAPER BRACKET & L5 OR L8 BRACKET LOCATIONS

1. Using the diagrams below, position 9H000094, JD Hinged Draper Brackets on the lower rail 51.5" from the center of the head location and spaced 103" on center.
2. Position 9H000035, L5 Brackets (pinned up) or 9H000067, L8 Brackets on lower rail where they will support the round tube on the bottom of the draper frame.
3. Use a minimum of 4 tie downs to secure the draper to the transport. Two at the center feeder feed section, use the straps on the hinged draper brackets. Two on the wings by the L5 or L8 Brackets.

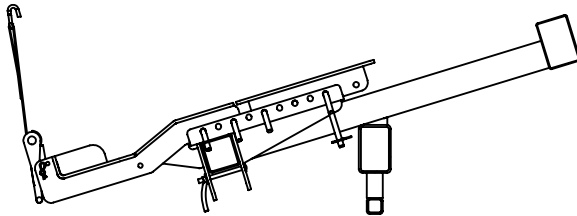

9H000094
JD Hinged Draper Bracket

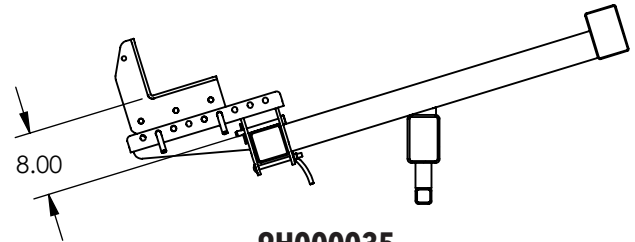

9H000035
L5 Bracket Pinned Up

NOTE Dimensions on this page are for reference only. Due to model changes and aftermarket equipment, the brackets may have to be adjusted to ensure the header will mount properly on the transport.

WARNING 2 L5 OR L8 BRACKETS MUST BE USED FOR HD35F & HD40F DRAPERS

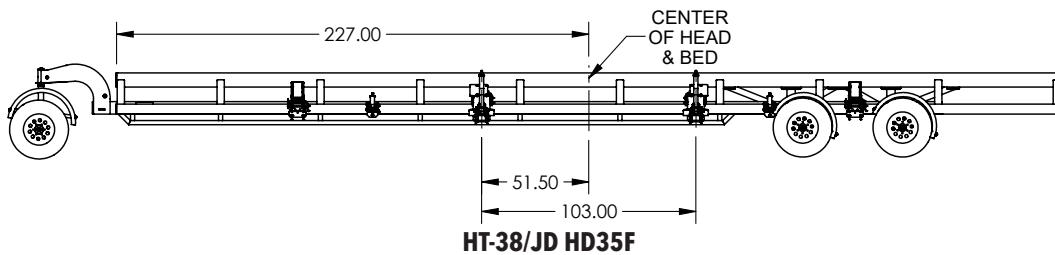

HT-38/JD HD35F

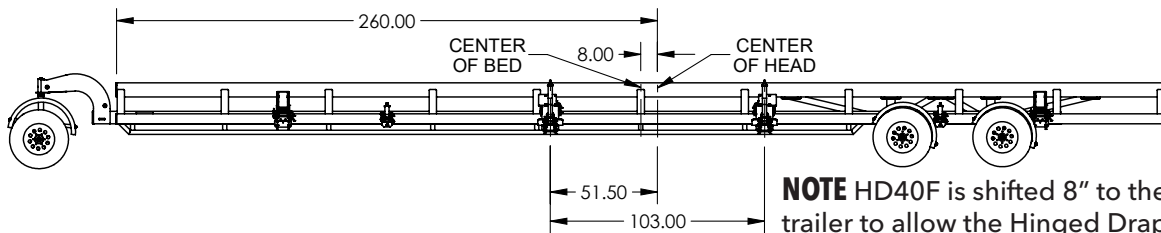

HT-42/JD HD40F

NOTE HD40F is shifted 8" to the rear of the trailer to allow the Hinged Draper Brackets to be installed on the lower bed rail.

WARNING 4 L5 OR L8 BRACKETS MUST BE USED FOR HD45F & HD50F DRAPERS

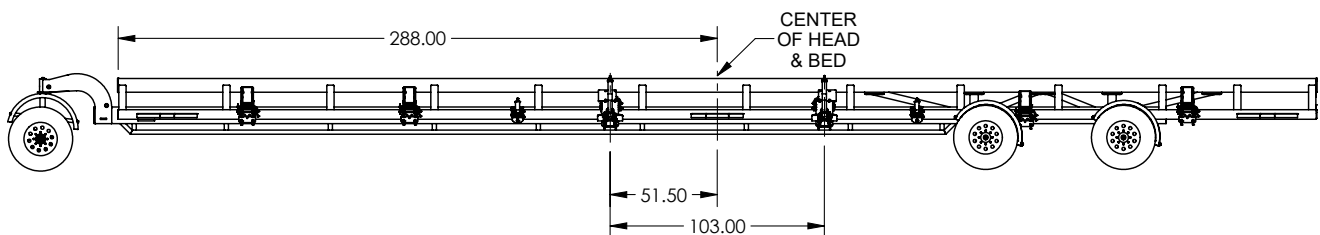

HT-48/JD HD45F

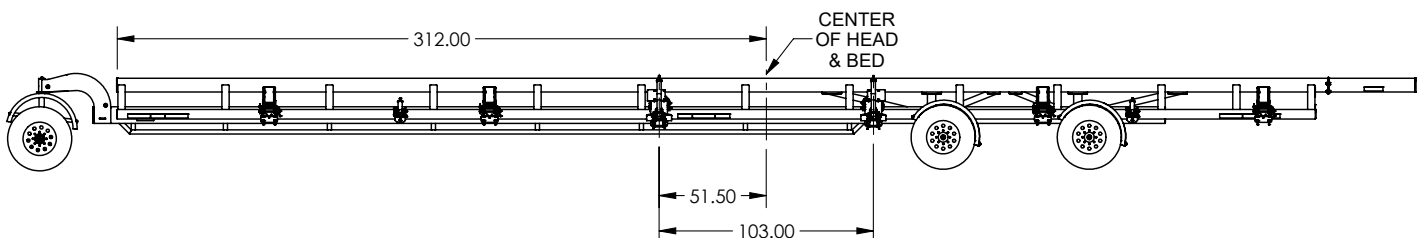

HT-52/JD HD50F

9H000094 JD HINGED DRAPER BRACKET ASSEMBLY

LOADING DRAPER ON TRANSPORT

1. Position the transport on a level hard surface.
2. Block the transport wheels.
3. Prepare the draper for transport. Using the header transport feature, press and hold control (A) to activate the transport position.



4. Verify that:
 - Reel is in down and back position.
 - Ground conditions are adjusted to very firm.
 - Gauge wheels are fully retracted.

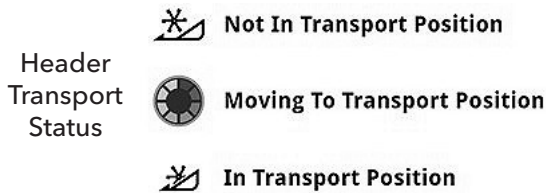

5. Verify that the draper is level when lifted off the ground.
6. Disconnect multicoupler and driveshaft. (Disconnect the 9-pin connector located above the multicoupler on S-Series Combines.)
7. Fully raise the draper and center it on the transport brackets.
8. Set draper securely on the transport.

- IMPORTANT:** Avoid damage to the draper during transport. Wing manual override valves must always remain pushed in and turned to the left during transport of the draper on a trailer.
9. Push in the left-hand wing manual override valve (B) and turn counterclockwise to unlock the wings.
 10. Verify that the safety wing lock ball valve (C) is in the unlocked position. (Handle in vertical position)

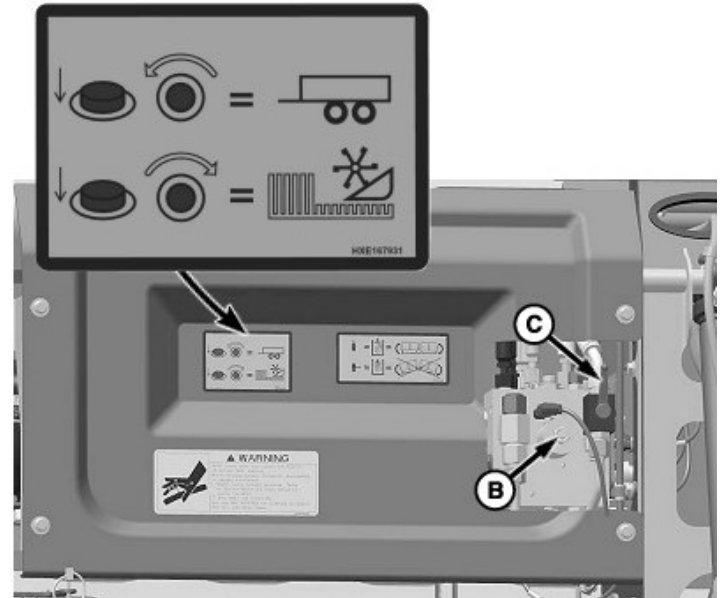

11. Repeat steps 9 & 10 for the right-hand wing.
12. Detach draper from the feeder house.
13. Secure the draper to the transport.

UNLOADING DRAPER FROM TRANSPORT

1. Position the transport on a level hard surface.
2. Block the transport wheels.
3. Remove tie-down straps.

IMPORTANT: Locking the wing manual override valves ensures that the wings will not move when the draper is lifted.

4. Push the left-hand wing manual override valve (A) inward and rotate clockwise to lock the wing.
5. Repeat step 3 for the right-hand wing.
6. Attach the draper to the feeder house.
7. Slowly raise the draper from the transport.

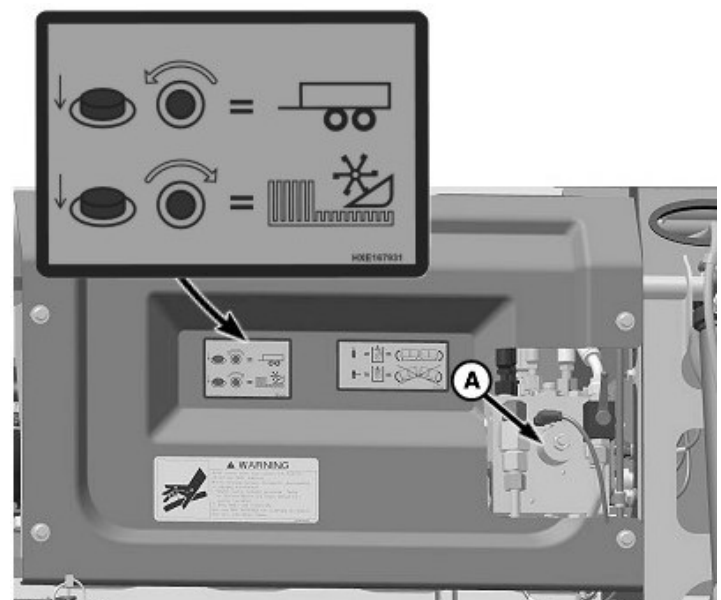

[illegible]



4010 320th St., Boyden, IA. 51234

Phone: (712) 725-2311

Fax: (712) 725-2380

Toll Free: 1-800-54DEMCO (1-800-543-3626)

**Demco warranty policies, operator manuals, and product registration
can be found online:**

www.demco-products.com