



Doing Our Best to Provide You the Best

8H000022, Rev C
05/26

MD200 CUTTER BAR SUPPORT BRACKET KIT

9H000100	MD200 CUTTER BAR SUPPORT BRACKET KIT (SET OF 5)
9H000101	MD230 CUTTER BAR SUPPORT BRACKET KIT 32'
9H000102	MD235 CUTTER BAR SUPPORT BRACKET KIT 38'

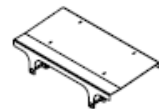
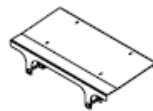
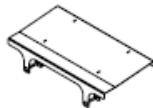
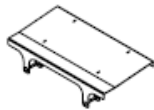
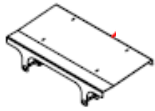

INSTALLATION MANUAL

9H000100 PARTS LIST & INSTALLATION

BOM ID	PART NUMBER	QTY.	DESCRIPTION
1	1AFC04HEAH0	10	CARRIAGE BOLT, 1/2"-13 x 5-1/2", GRA ZINC
2	1AFC18H0000	10	NYLOCK NUT, 1/2"-13, GR2 ZINC
3	5H000535	5	MD200 CUTTER BAR SUPPORT BRACKET - 36"

TORQUE NUTS TO 10-20 FT-LB TO AVOID BENDING THE BRACKETS

Please order replacement parts by Part Number and Description.

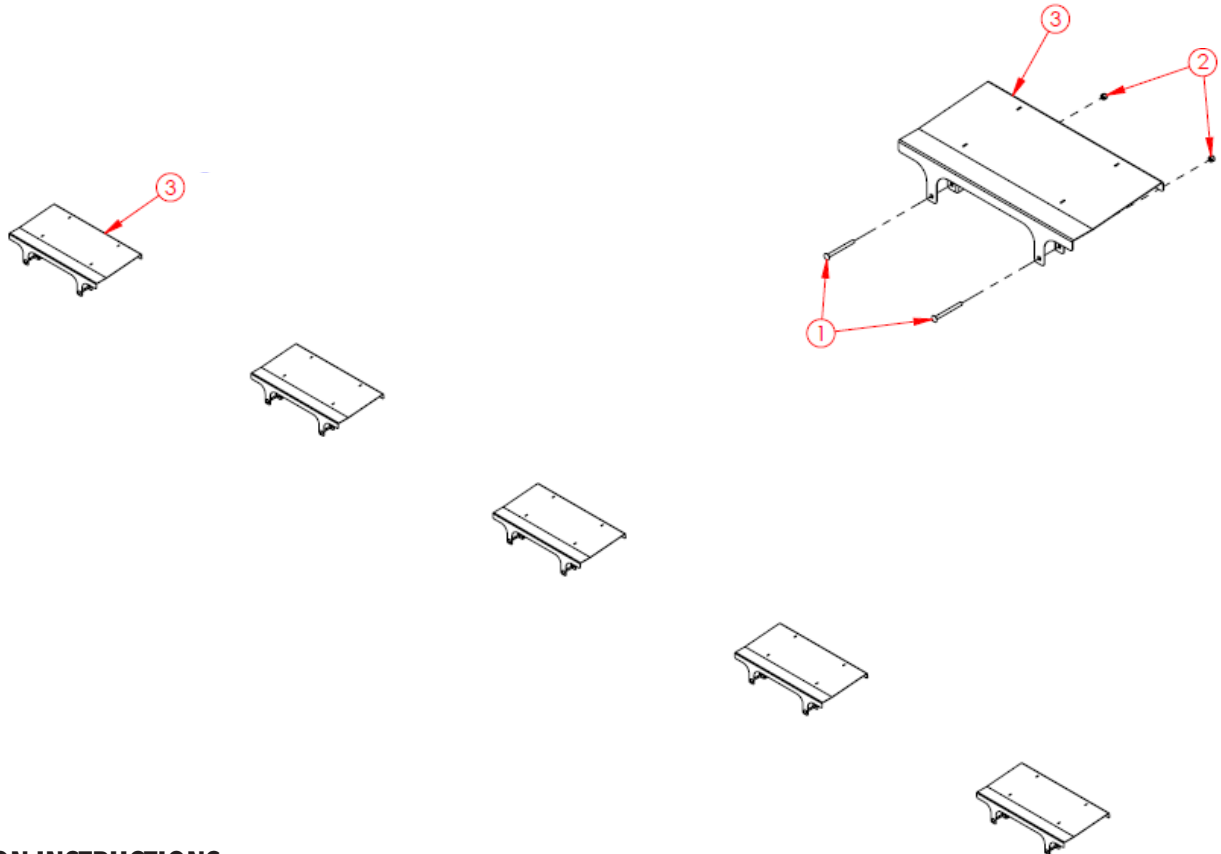

INSTALLATION INSTRUCTIONS

1. Place Cutter Bar Support Brackets on top rail as shown below for your model of transport and header.
2. Install carriage bolts and lock nuts. TORQUE TO 10-20 FT-LB TO AVOID BENDING THE BRACKETS.
3. Position 9H000035, L5 Brackets or 9H000067, L8 Brackets on lower rail, centered on header location and spaced 106" to the outside of the brackets. (As shown below)

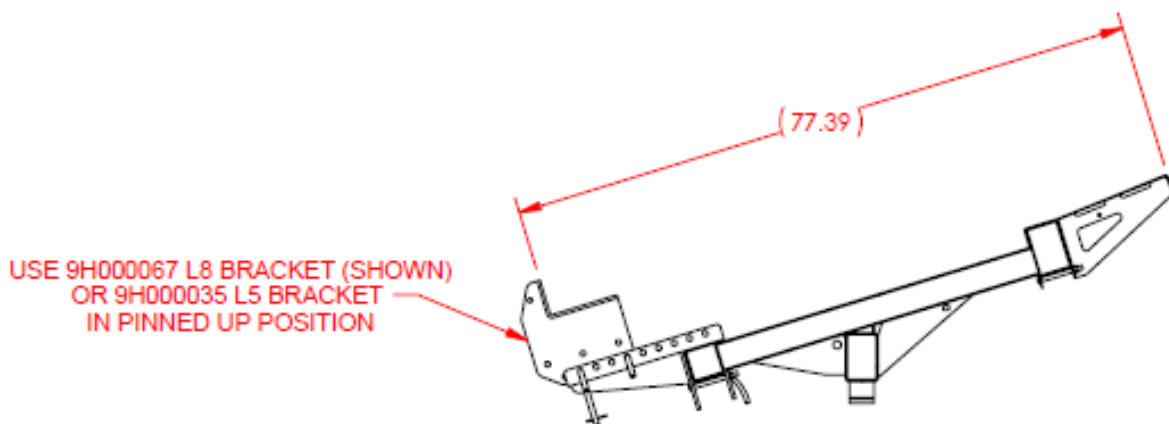

POSITION DIMENSIONS

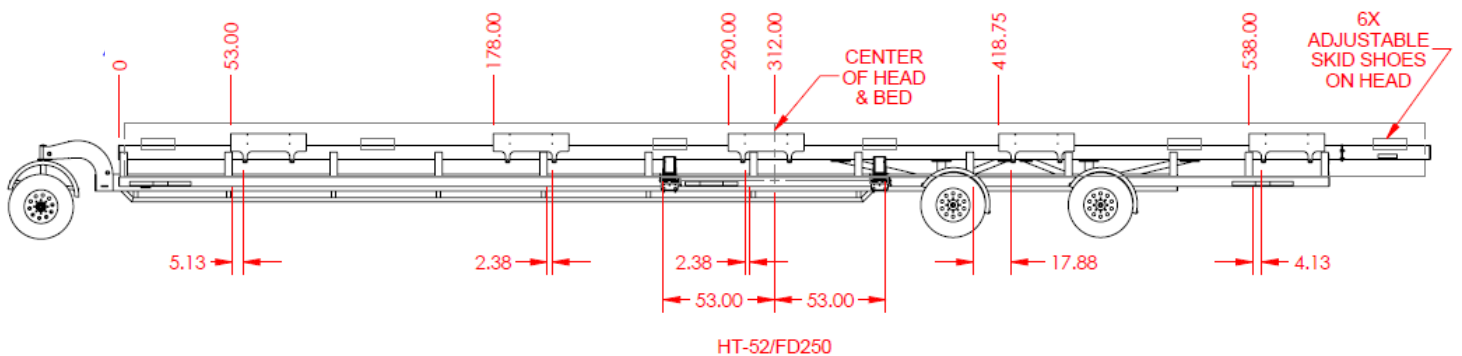
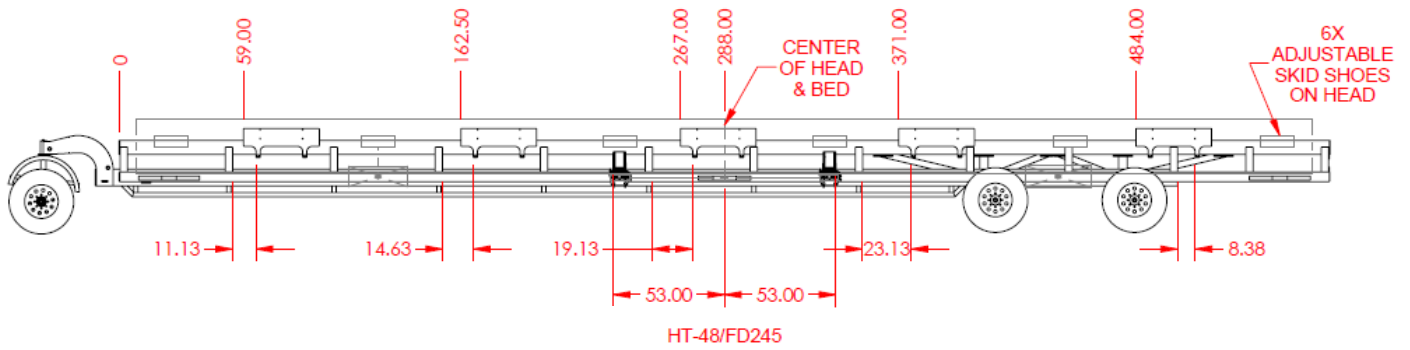
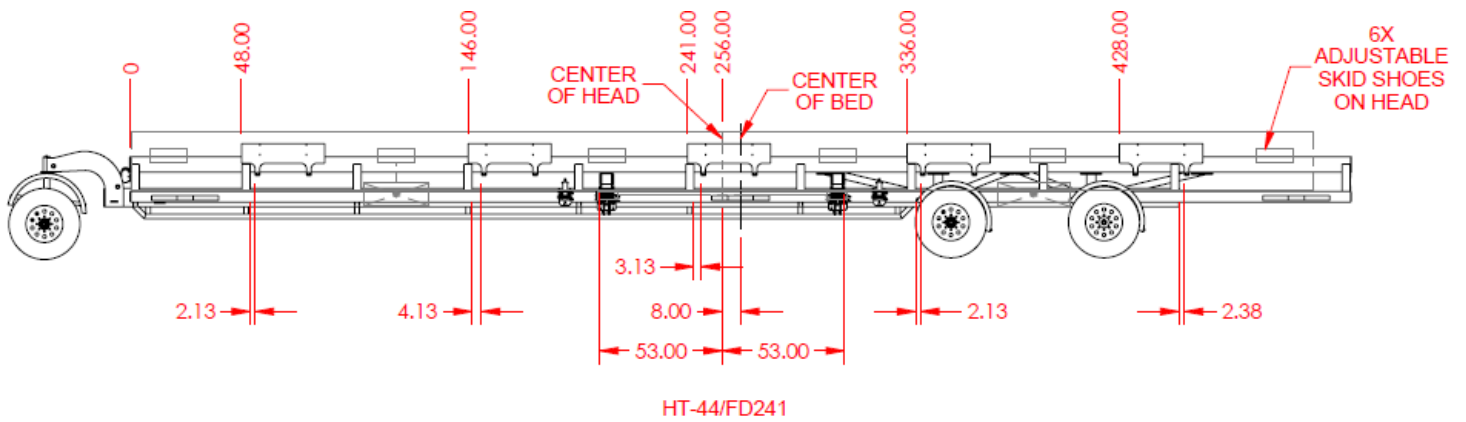
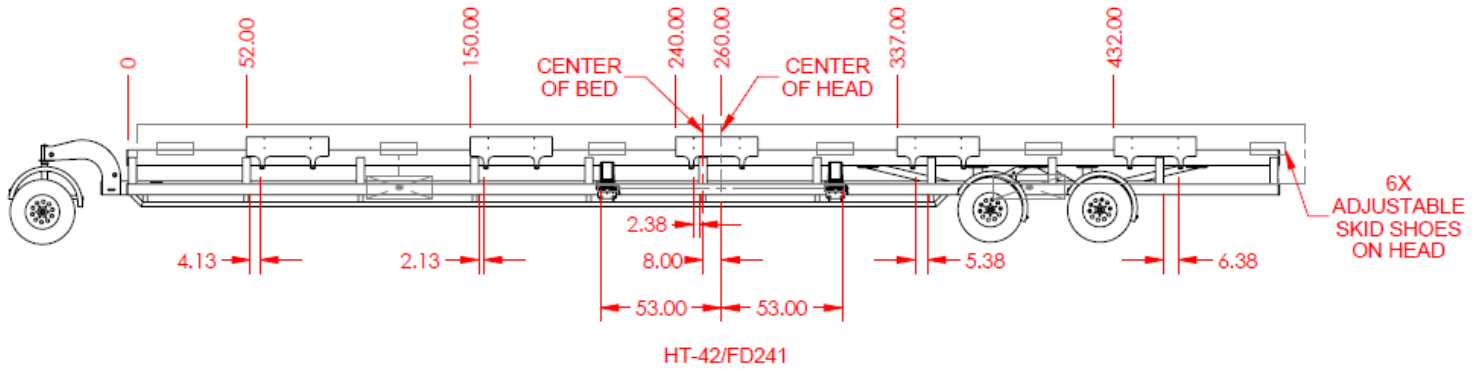

9H000101 PARTS LIST

BOM ID	PART NUMBER	QTY.	DESCRIPTION
1	1AFC04HEAH0	10	CARRIAGE BOLT, 1/2"-13 x 5-1/2", GRA ZINC
2	1AFC18H0000	10	NYLOCK NUT, 1/2"-13, GR2 ZINC
3	5H000535	3	MD200 CUTTER BAR SUPPORT BRACKET - 36"
4	5H000557	2	MD200 CUTTER BAR SUPPORT BRACKET - 24"

TORQUE NUTS TO 10-20 FT-LB TO AVOID BENDING THE BRACKETS

Please order replacement parts by Part Number and Description.

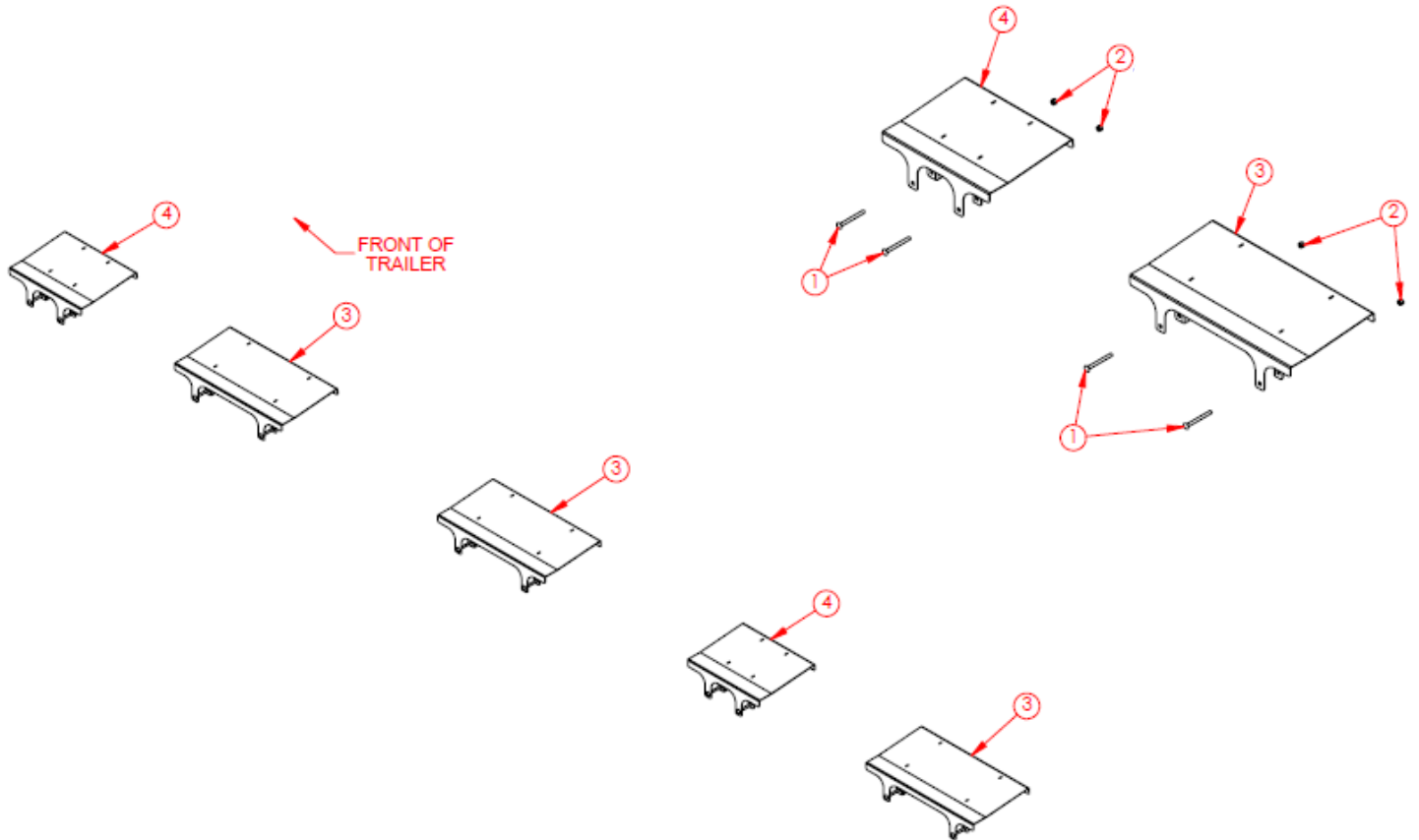

INSTALLATION INSTRUCTIONS

1. Place Cutter Bar Support Brackets on top rail as shown below for your model of transport and header.
2. Install carriage bolts and lock nuts. TORQUE TO 10-20 FT-LB TO AVOID BENDING THE BRACKETS.
3. Position 9H000035, L5 Brackets or 9H000067, L8 Brackets on lower rail as shown below and spaced 104" to the outside of the brackets. (As shown below)

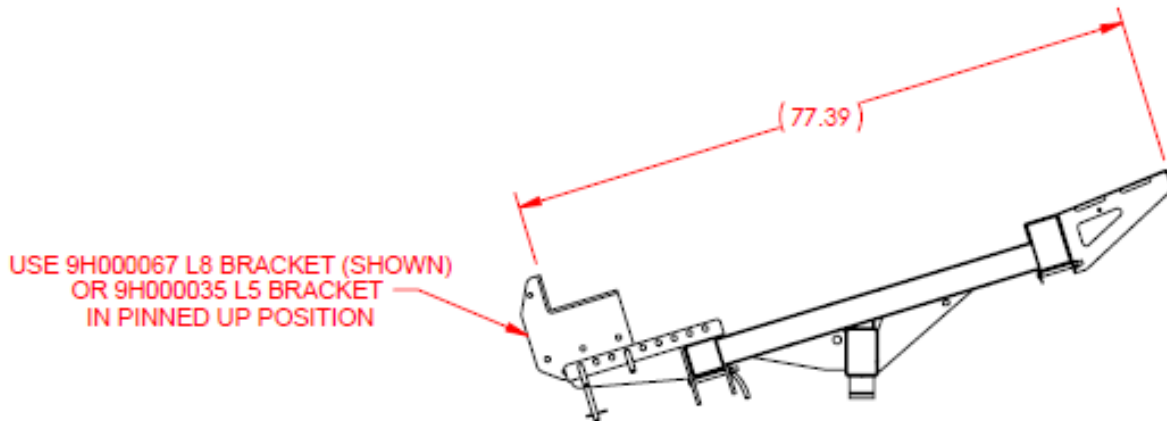

POSITION DIMENSIONS

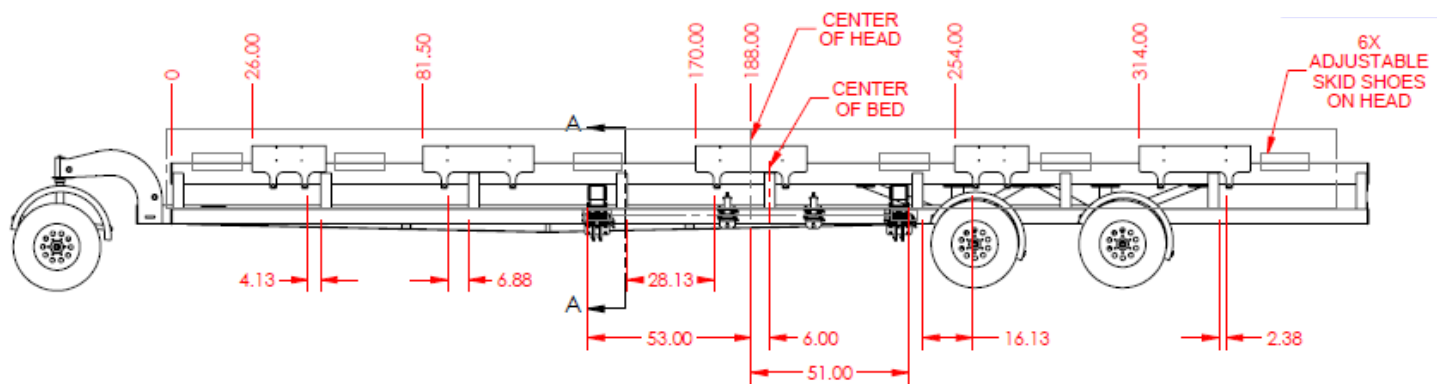

HT32/FD230

9H000102 PARTS LIST

BOM ID	PART NUMBER	QTY.	DESCRIPTION
1	1AFC04HEAH0	10	CARRIAGE BOLT, 1/2"-13 x 5-1/2", GRA ZINC
2	1AFC18H0000	10	NYLOCK NUT, 1/2"-13, GR2 ZINC
3	5H000535	4	MD200 CUTTER BAR SUPPORT BRACKET - 36"
4	5H000557	1	MD200 CUTTER BAR SUPPORT BRACKET - 24"

TORQUE NUTS TO 10-20 FT-LB TO AVOID BENDING THE BRACKETS

Please order replacement parts by Part Number and Description.

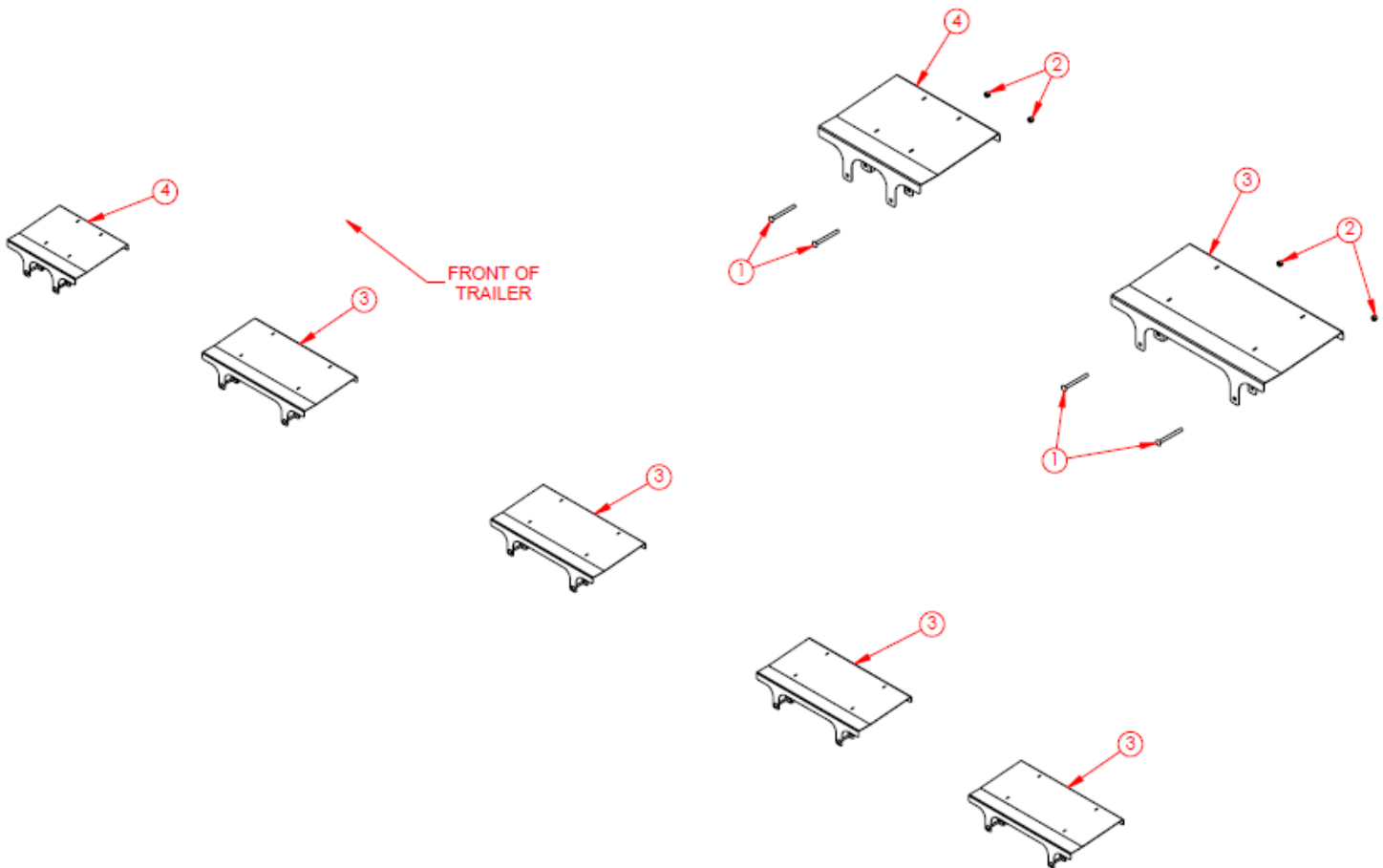

INSTALLATION INSTRUCTIONS

1. Place Cutter Bar Support Brackets on top rail as shown below for your model of transport and header.
2. Install carriage bolts and lock nuts. TORQUE TO 10-20 FT-LB TO AVOID BENDING THE BRACKETS.
3. Position 9H000035, L5 Brackets or 9H000067, L8 Brackets on lower rail centered, on header location and spaced 106" to the outside of the brackets. (As shown below)

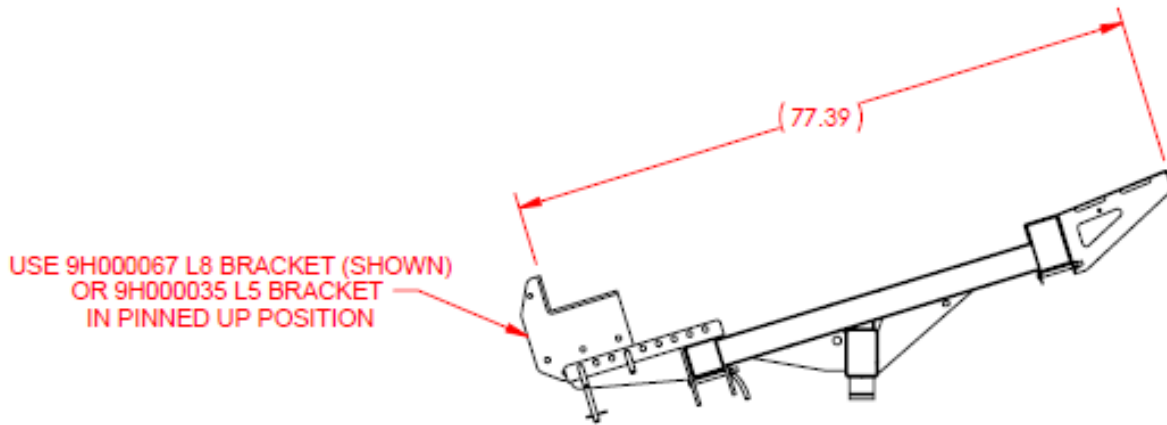

POSITION DIMENSIONS

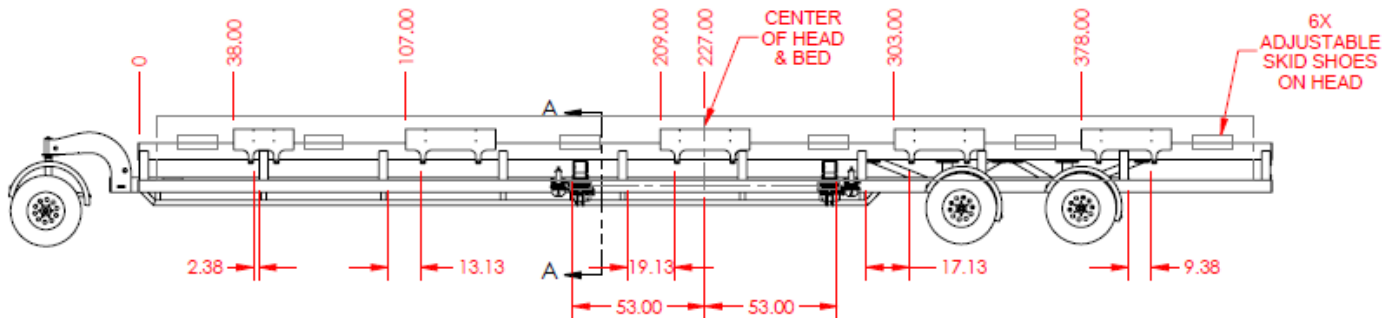

HT38/FD235

DEMCO

4010 320th St., Boyden, IA. 51234

Phone: (712) 725-2311

Fax: (712) 725-2380

Toll Free: 1-800-54DEMCO (1-800-543-3626)

**Demco warranty policies, operator manuals, and product registration
can be found online:**

www.demco-products.com