



Doing Our Best to Provide You the Best

8E000061, Rev B
11/29/22

COMBINE GRAIN TANK EXTENSION TIP-UP KIT

9E000063 - John Deere X9 1000 Tip-Up

FITS: JOHN DEERE X9 1000 COMBINES

**PLACE IN COMBINE CAB AFTER ASSEMBLY
FOR FUTURE REFERENCE.**



**FOR USE ON COMBINES WITH
POWER FOLD COVER ONLY**

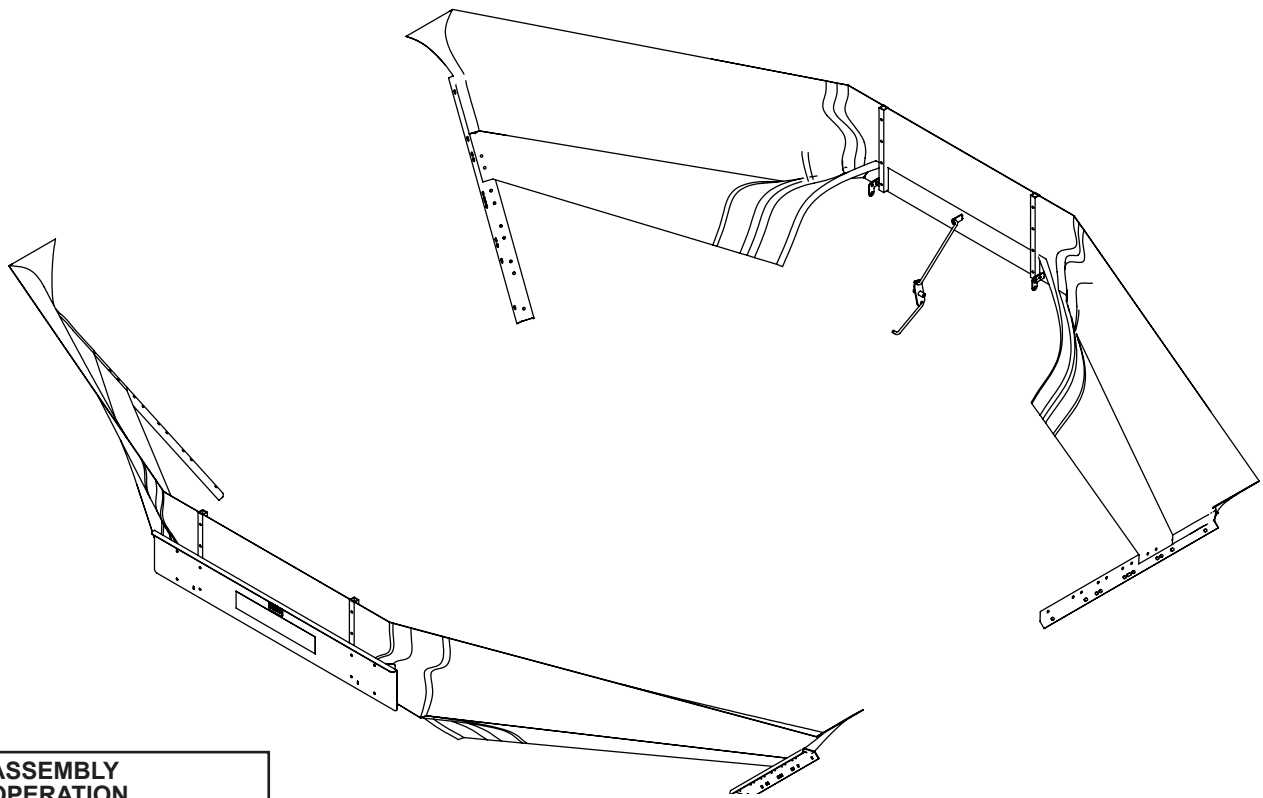

**ASSEMBLY
OPERATION
REPLACEMENT PARTS**

OPERATOR MANUAL

INTRODUCTION

Thank you for purchasing a Demco grain tank extension Tip-Up Kit. Proper care and use will result in many years of service.

WARRANTY POLICY, OPERATOR MANUALS, PARTS MANUALS & REGISTRATION

Go online to www.demco-products.com to review Demco warranty policies, operator manuals and register your Demco product.



WARNING: TO AVOID PERSONAL INJURY OR DEATH, OBSERVE FOLLOWING INSTRUCTIONS:

- Ensure that anybody present is clear before applying power to any machinery used in conjunction with a Demco grain tank extension.**
- Never allow anyone in or near the grain tank of a combine during loading or unloading of grain. The accumulation of grain is dangerous and can cause entrapment, resulting in serious injury or death by suffocation.**
- Adding a Demco Bin Extension or Tip-Up increases the overall height of your combine. Use caution when operating around trees, buildings, power lines, and when approaching bridges and over passes. Pay attention to height restrictions.**
- Do not exceed advertised maximum capacity of a Demco grain tank extension.**

GENERAL INFORMATION

- 1. Read assembly instructions carefully. Study assembly procedures and all illustrations before you begin assembly. Note which parts are used in each step. This unit must be assembled in proper sequence or complications will result.
- 2. When placing a parts order, refer to this manual for proper part numbers and place order by **PART NO.** and **DESCRIPTION.**
- 3. Whenever terms "LEFT" and "RIGHT" are used in this manual it means from a position behind combine and facing forward.

TABLE OF CONTENTS

General Information2

Safety, Signal Words3

Product Safety Guidelines.....4

Product Disclaimer.....4

Safety Sign Locations.....5

Safety Sign Care5

Parts Breakdown 6-7

Assembly Instructions 7-12

TAKE NOTE! THIS SAFETY ALERT SYMBOL FOUND THROUGHOUT THIS MANUAL IS USED TO CALL YOUR ATTENTION TO INSTRUCTIONS INVOLVING YOUR PERSONAL SAFETY AND SAFETY OF OTHERS. FAILURE TO FOLLOW THESE INSTRUCTIONS CAN RESULT IN INJURY OR DEATH!



**THIS SYMBOL MEANS
ATTENTION
BECOME ALERT
YOUR SAFETY IS INVOLVED!**

SIGNAL WORDS:

This manual uses the following signal words--**DANGER**, **WARNING**, and **CAUTION**-- with safety messages. The appropriate signal word has been selected using the following guidelines.

WARNING:

Indicates a potentially hazardous situation that, if not avoided, could result in death or serious injury, and includes hazards that are exposed when guards are removed. It may also be used to alert against unsafe practices.

DANGER:

Indicates an imminently hazardous situation that, if not avoided, will result in death or serious injury. This signal word is to be limited to most extreme situations typically for machine components which, for functional purposes, cannot be guarded.

CAUTION:

Indicates a potentially hazardous situation that, if not avoided, may result in minor or moderate injury. It may also be used to alert against unsafe practices.

If you have questions not answered in this manual, require additional copies, or if your manual is damaged, please contact your dealer or DEMCO, 4010 320th Street, Boyden, IA 51234
ph: (712) 725-2311 or Toll Free: 1-800-543-3626 Fax: (712) 725-2380 or 1-800-845-6420
<http://www.demco-products.com>



PRODUCT SAFETY GUIDELINES

Every year many accidents occur which could have been avoided by a few seconds of thought and a more careful approach to handling equipment. You, the operator, can avoid many accidents by observing the following precautions in this section. To avoid personal injury, study the following precautions and insist those working with you, or you yourself, follow them.

Replace any caution, warning, danger or instruction safety decal that is not readable or is missing. Location of such decals is indicated in this booklet.

Review safety instructions with all users annually.

Operator should be a responsible adult. **DO NOT ALLOW PERSONS TO OPERATE OR ASSEMBLE THIS UNIT UNTIL THEY HAVE DEVELOPED A THOROUGH UNDERSTANDING OF SAFETY PRECAUTIONS AND HOW IT WORKS.**

Do not paint over, remove, or deface any safety signs or warning decals on your equipment. Observe all safety signs and practice instructions on them.

Never exceed limits of a piece of machinery. If it's ability to do a job, or to do so safely is in question **DON'T TRY IT.**

Adding a Demco Bin Extension or Tip-Up increases the overall height of your combine. Use caution when operating around trees, buildings, power lines, and when approaching bridges and over passes. Pay attention to height restrictions.

Fold and secure (if needed) the grain tank extension panels when transporting the combine to avoid contact with low power lines and other obstructions.

Ensure that any additional bracing and safety equipment have been installed according to this manual. (Some models do not require additional bracing or safety equipment)

Never exceed the maximum advertised capacity of the grain tank extension. By doing so you risk damage to the grain tank extension and combine.

PRODUCT DISCLAIMER

Increasing the grain tank capacity of any combine by use of this product is at the discretion of the owner. Increasing the grain holding capacity of any combine may affect the structural aspects of the combine as well as drive line components and tires. Although Demco has included additional support bracing on selected models, it does not assume liabilities, or make any warranties pertaining to the structural stability or performance of any combine. See the combine owners/operators manual for additional combine specifications and safety information not listed in this manual.



SAFETY SIGN LOCATIONS

Types of safety sign and locations on equipment are shown in illustration below. Good safety requires that you familiarize yourself with various safety signs, type of warning, and area or particular function related to that area, that requires your SAFETY AWARENESS.

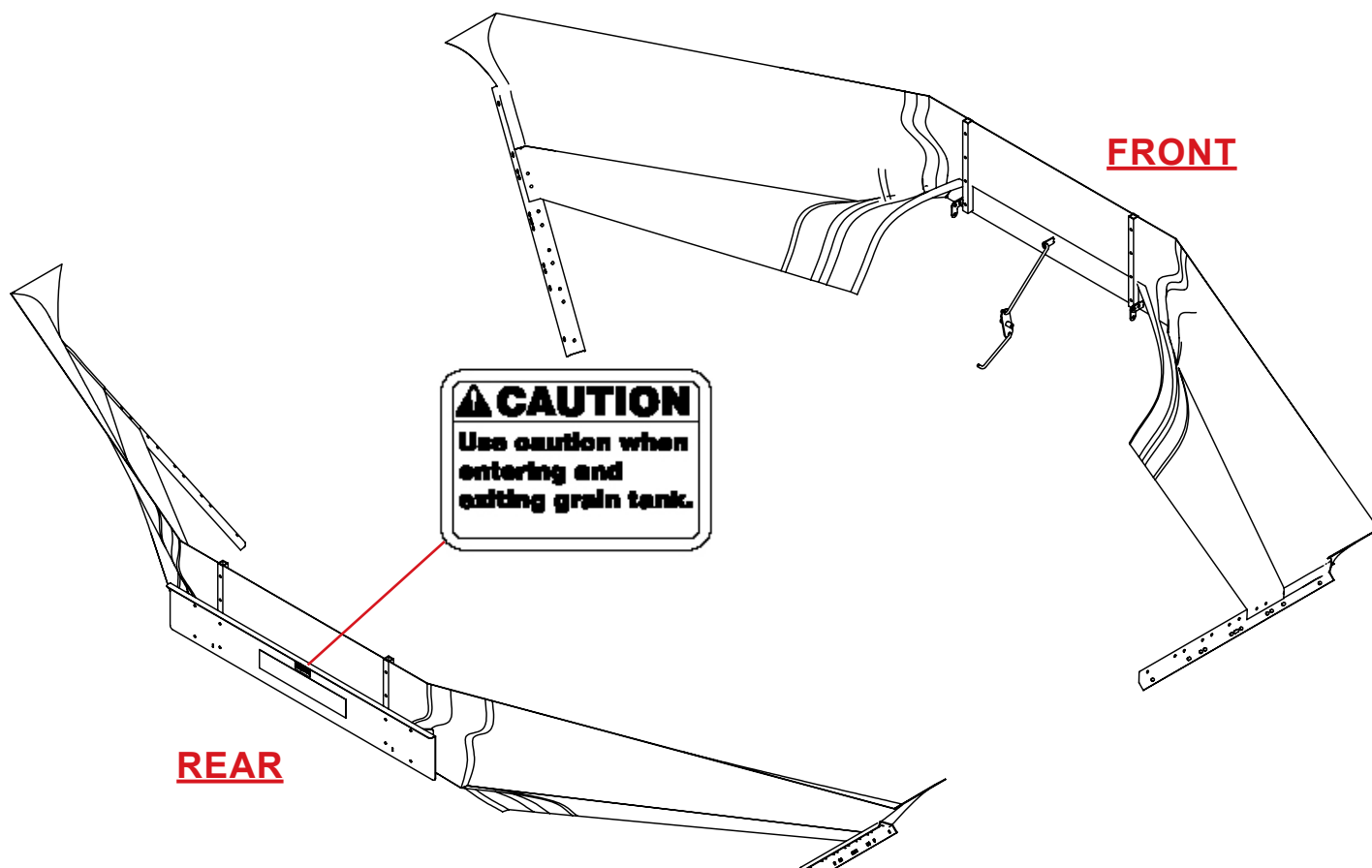

SAFETY SIGN CARE

- Keep safety signs clean and legible at all times.
- Replace safety signs that are missing or have become illegible.
- Replacement parts that displayed a safety sign should also display current sign.
- Safety signs are available from Demco.

JD X9 (1000) Tip-Up Kit

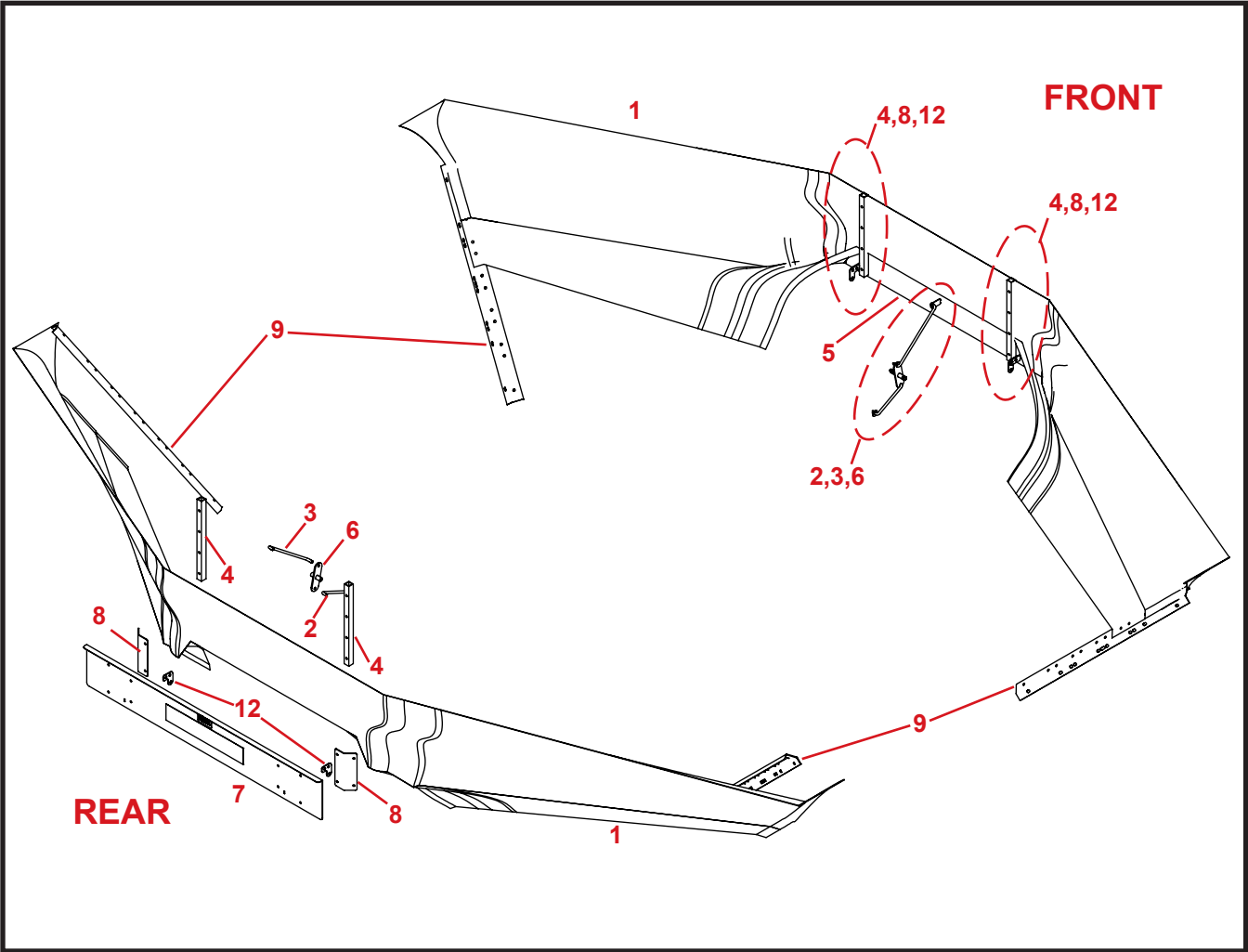

Figure 1

ITEM	PART #	QTY	DESCRIPTION
1	1AU00000294	2	X9 TIP-UP 1000 CORNER
2	1AU00000808	2	X9 TIP-UP LOWER ROD
3	1AU00000809	2	X9 TIP-UP UPPER ROD
4	1AU3E000374	4	X9 TIP-UP PANEL MOUNT TUBE
5	R5E000256P0	1	X9 TIP-UP FRONT PANEL ASSEMBLY
6	R5E000258P0	2	X9 TIP-UP PIVOT ASSEMBLY
7	R5E000262P0	1	X9 TIP-UP REAR PANEL ASSEMBLY
8	R3E000373P0	4	X9 TIP-UP PANEL BOLT BRACKET
9	R3E000375P0	4	X9 TIP-UP BOLT PLATE
10	R3E000377P0	2	X9 TIP-UP SENSOR BRACKET
11	R3E000378P0	1	X9 AUGER DEFLECTOR
12	R3E000380P0	4	X9 TIP-UP PANEL HINGE PIECE
13	1AF009E0000	48	5/16" FLAT WASHER
14	1AF009F0000	8	3/8" FLAT WASHER

Please order replacement parts by PART NO. and DESCRIPTION

ITEM	PART #	QTY	DESCRIPTION
15	1AFC08E0000	72	5/16" FLANGE NUT
16	1AFC12EAAL5	16	5/16" X 1 3/4" FLANGE BOLT
17	1AFC12FCA05	2	3/8" X 3" HEX BOLT
18	1AFC18F0000	6	3/8" NYLOCK NUT
19	1AFC35FAA00	4	5/16" X 1" SELF TAP FLANGE BOLT
20	1AFC37E00L0	24	5/16" X 3/4" FLANGE BOLT
21	1AFC37EAAD5	36	5/16" X 1 1/4" FLANGE BOLT
22	1AFC37F00L5	4	3/8" X 3/4" FLANGE BOLT
23	1AFR33BAA00	8	1/8" DIA X 1" COTTER PIN
24	1AL00060706	4	3/8" ID X 3/8" L SLEEVE BEARING

Please order replacement parts by PART NO. and DESCRIPTION



ATTENTION: During assembly ensure the following safety decals are located correctly. See illustration on page 5.



Located on outside of rear panel.

ASSEMBLY INSTRUCTIONS

STEP 1:

Attach two Panel Bolt Brackets (8) to the Front Panel Assembly (5) using the 5/16" x 3/4" flange bolts (20) and 5/16" flange nuts (15) provided. Attach two Panel Hinge Pieces (12) to the Front Panel Assembly (5) using the 5/16" x 3/4" flange bolts (20) and 5/16" flange nuts (15) provided. See Figure 2.

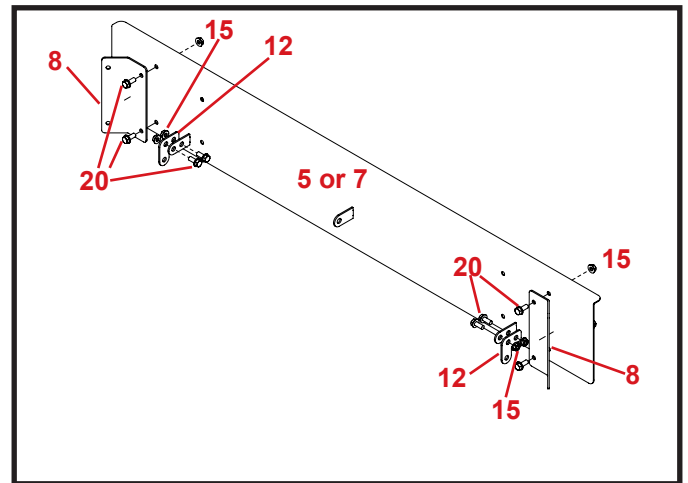

Figure 2

STEP 2:

Use the 3/8" x 3/4" flange bolts (22), 3/8" ID x 3/8" L sleeve bearing (24), and 3/8" lock nuts (18) provided to attach the Front Panel Assembly (5) to the factory front panel. See Figure 3.

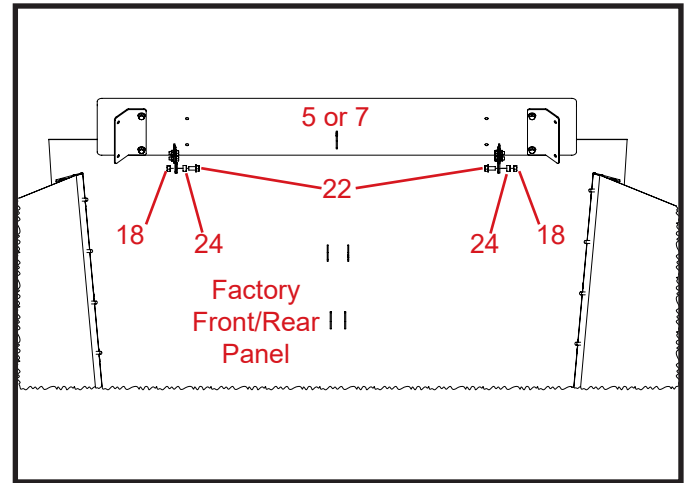

Figure 3

STEP 3:

Attach the Tip-Up Corner (1) to the Front Panel Assembly (5) using the Panel Mount Tubes (4), 5/16" x 1 3/4" bolts (16), 5/16" flat washers (13), and 5/16" flange nuts (15). See Figure 4.

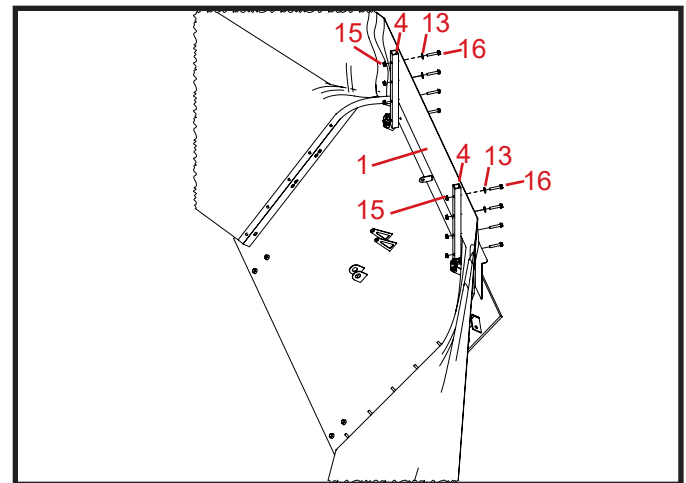

Figure 4

STEP 4:

Attach the Tip-Up Corner (1) to the Panel Bolt Bracket (8) using the 5/16" x 1 1/4" flange bolts (21), 5/16" washers (13), and 5/16" flange nuts (15) provided. Remove the M8 nuts and washers from the second and third bolts on the factory corner. Install the Tip-Up Corner (1) on the second and third bolts and replace M8 nuts and washers. Repeat on opposite side. See Figure 5.

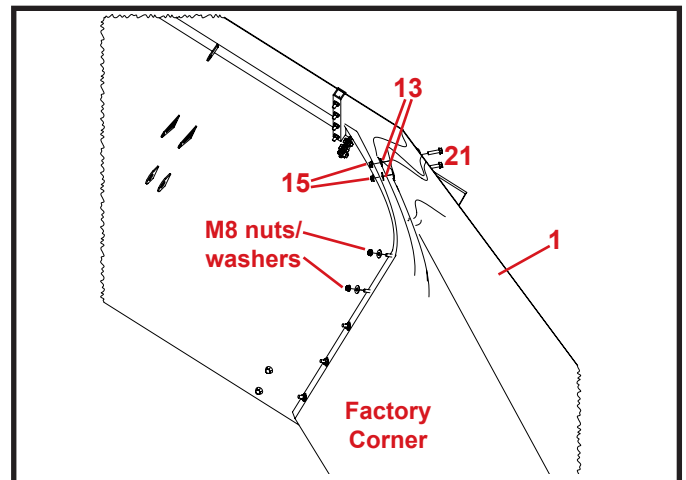

Figure 5

STEP 5:

Remove the M8 nuts and washers from the left factory panel mounting plate. Then remove the factory corner from the left factory panel. See Figure 6.



ATTENTION: Complete Steps 5-8 on only one corner at a time to prevent too much slack from becoming present.

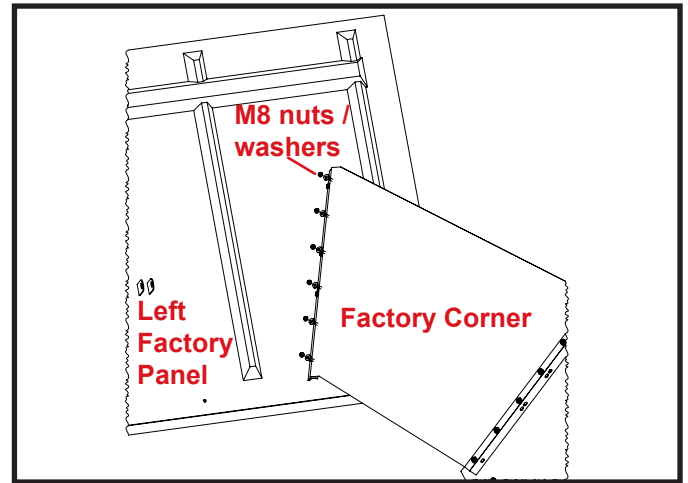

Figure 6

STEP 6:

Remove the left factory panel mounting plate for the factory cover by removing the M8 bolts and nuts. Set aside M8 bolts and nuts for future use. See Figure 7.

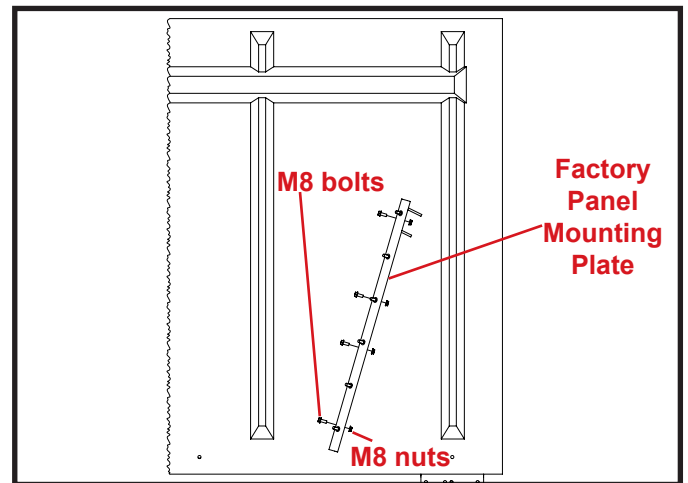

Figure 7

STEP 7:

Attach the Tip-Up Bolt Plate (9) to the Tip-Up Corner (1) and factory corner using the 5/16" x 1 1/4" bolts (21), 5/16" flat washers (13), and 5/16" flange nuts (15) provided. (Leave the outermost hole on the Tip-Up Corner (1) open for the self tapping bolt). See Figure 8.

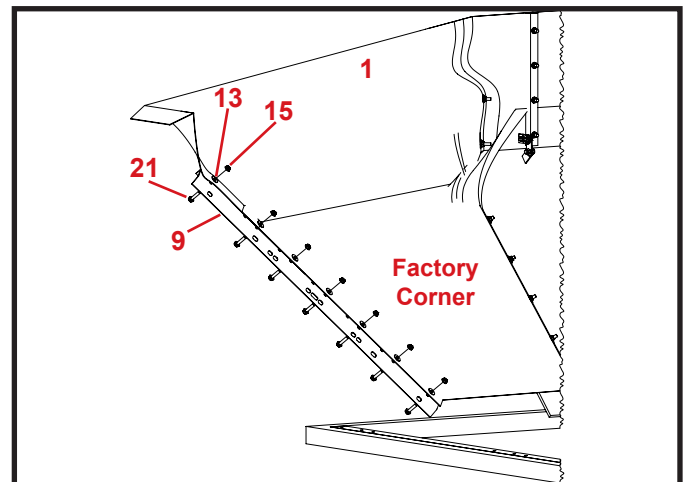

Figure 8

STEP 8:

Attach the Tip-Up Bolt Plate (9) to the left factory panel using the M8 bolts and nuts from Step 6. Corners will be very taut, some force may be required. See Figure 9.

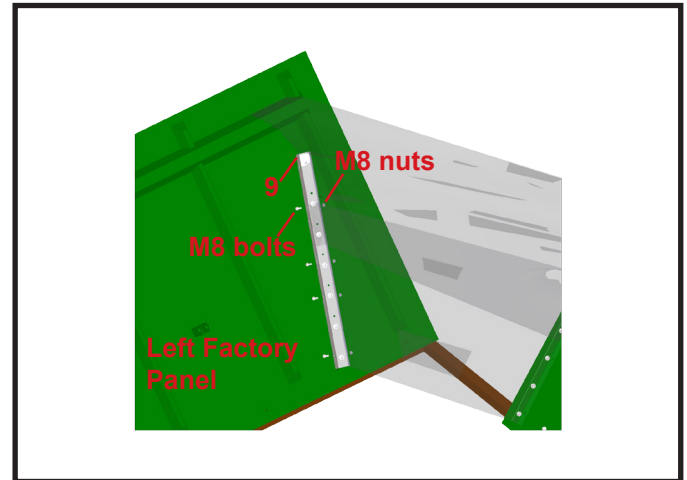

Figure 9

STEP 9:

Repeat Step 5-8 for the Right Side of the combine.

STEP 10:

Pull the Tip-Up Corner (1) taut and insert the 5/16" x 1" self tapping bolt (19) and 5/16" flat washer (13) provided. Repeat for the right side. See Figure 10.

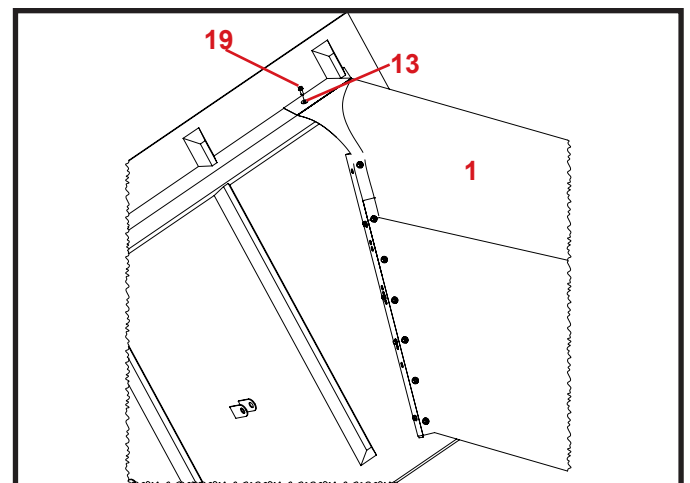

Figure 10

STEP 11:

Attach the Tip-Up Pivot (6) to the factory front panel using the 3/8" x 3" hex bolts (17) and 3/8" nylock nuts (18) provided. Attach the Upper Rod (3) to the Front Panel Assembly (5) using the 1/8" dia. cotter pins (23) and 3/8" flat washers (14) provided. In the same manor, attach the opposite end of the Upper Rod (3) to the Tip-Up Pivot (6), the Lower Rod (2) to the Tip-Up Pivot (6), and the Lower Rod (2) to the mounting point on the factory front panel. See Figure 11.

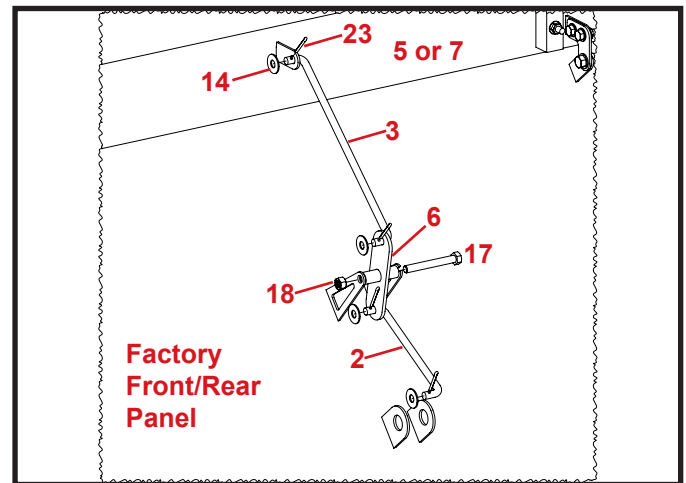

Figure 11

STEP 12:

Repeat Step 1-11 for the Rear of the combine.

TANK FULL BIN SENSOR:

Remove tank full bin sensor from the right panel mounting point. Attach Tip-Up Sensor Bracket to the sensor mounting point using 5/16" x 3/4" bolts and 5/16" flange nuts. Attach tank full bin sensor to the top of Tip-Up Sensor Bracket.

Repeat on left side if second tank full bin sensor is present.

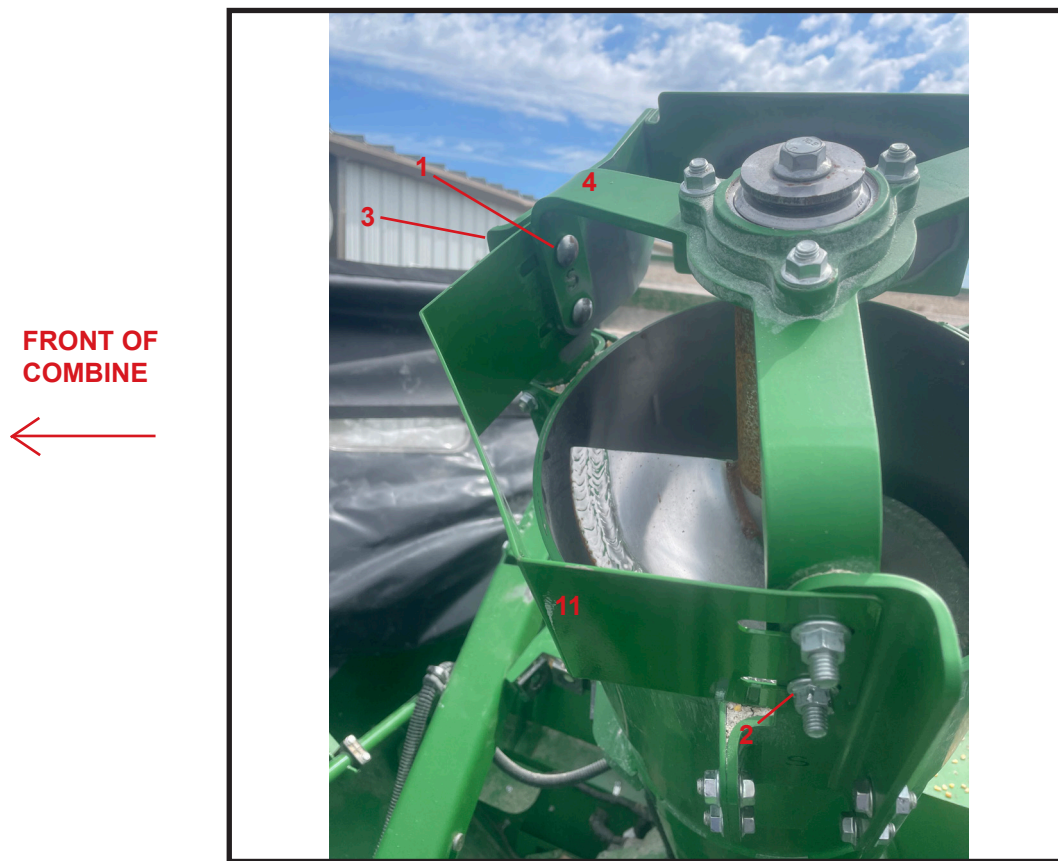

Figure 12

STEP 1:

Remove the bolts (1) on the front of the auger and the nuts (2) on the left side of the auger. Put aside for future use.

STEP 2:

Insert Auger Deflector Plate (7) in between the auger brace (3) and support (4) on the front side of the auger. Then reassemble and tighten bolts and nuts (1).

STEP 3:

Attach other end of the Auger Deflector Plate with the nuts (2) and tighten.

STEP 4:

Lower the auger using the open/close cover controls in the cab.
Caution: Carefully monitor the auger to ensure no contact occurs.

STEP 5:

Adjust Auger Deflector as needed for clearance.

NOTE: Make sure that Demco corners are tight and that the lag bolt is placed at it's approximate distance before mounting the plastics. See Figure 13 on Page 14.

STEP 1:

Starting on the outside of the left rear, find the top center of the Demco tarp corner and mark it.

STEP 2:

On the center mark from STEP 1, place the plastic stiffener perpendicular with the tarp and approximately 1-1/2" down from the top. Mark all three holes from the stiffener onto the Demco corner.

NOTE: Make sure that the 2 holes closest to each other are towards the bottom. See Figure 13 on Page 14.

STEP 3:

Drill out the top hole and loosely bolt the plastic to the tarp with the nuts, bolts, and washers provided.

STEP 4:

Drill holes for the center and bottom bolts.

STEP 5:

Add nuts, bolts, and washers to the center and bottom holes of the plastic stiffener and tighten all three bolts.

STEP 6:

Repeat steps 1-5 on the remaining corners.

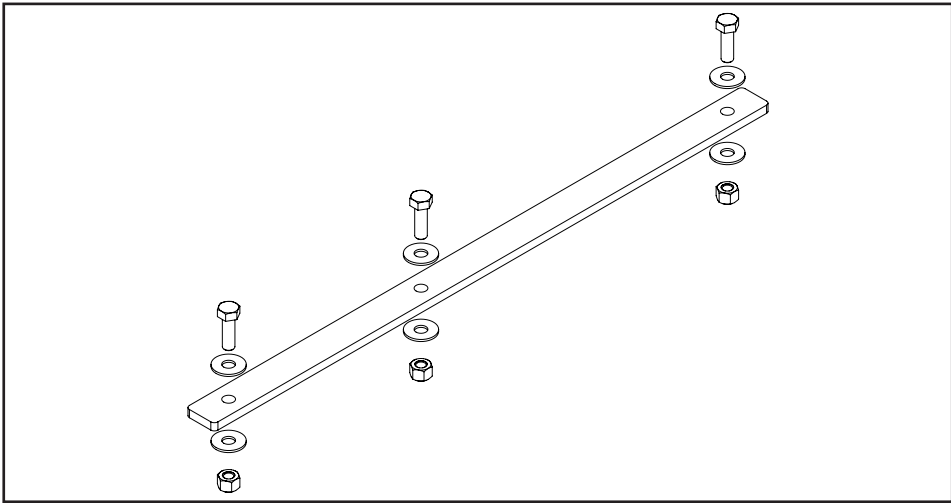

ITEM	PART #	QTY	DESCRIPTION
1	1AF009E0000	24	5/16" FLAT WASHER
2	1AFC12EAA05	12	5/16" X 1" HEX BOLT
3	1AFC18E0000	12	5/16" NYLOCK NUT
4	1AR00000028	4	JD MS75E CORNER PLASTIC
Please order replacement parts by PART NO. and DESCRIPTION			



Figure 13



4010 320th St., Boyden, IA. 51234

Phone: (712) 725-2311

Fax: (712) 725-2380

Toll Free: 1-800-54DEMCO (1-800-543-3626)

**Demco warranty policies, operator manuals, and product registration
can be found online:**

www.demco-products.com