



Doing Our Best to Provide You the Best

8E000042, Rev B
7/26/18

COMBINE GRAIN TANK EXTENSION TIP-UP KIT

9E000046 - MS120SQ Tip-up Kit

FITS: JOHN DEERE S660, S670, S760, S770 COMBINES

PLACE IN COMBINE CAB AFTER ASSEMBLY
FOR FUTURE REFERENCE.



FOR USE ON COMBINES WITH THE
FOLLOWING SERIAL NUMBERS
S660: 765172-
S670: 765253-

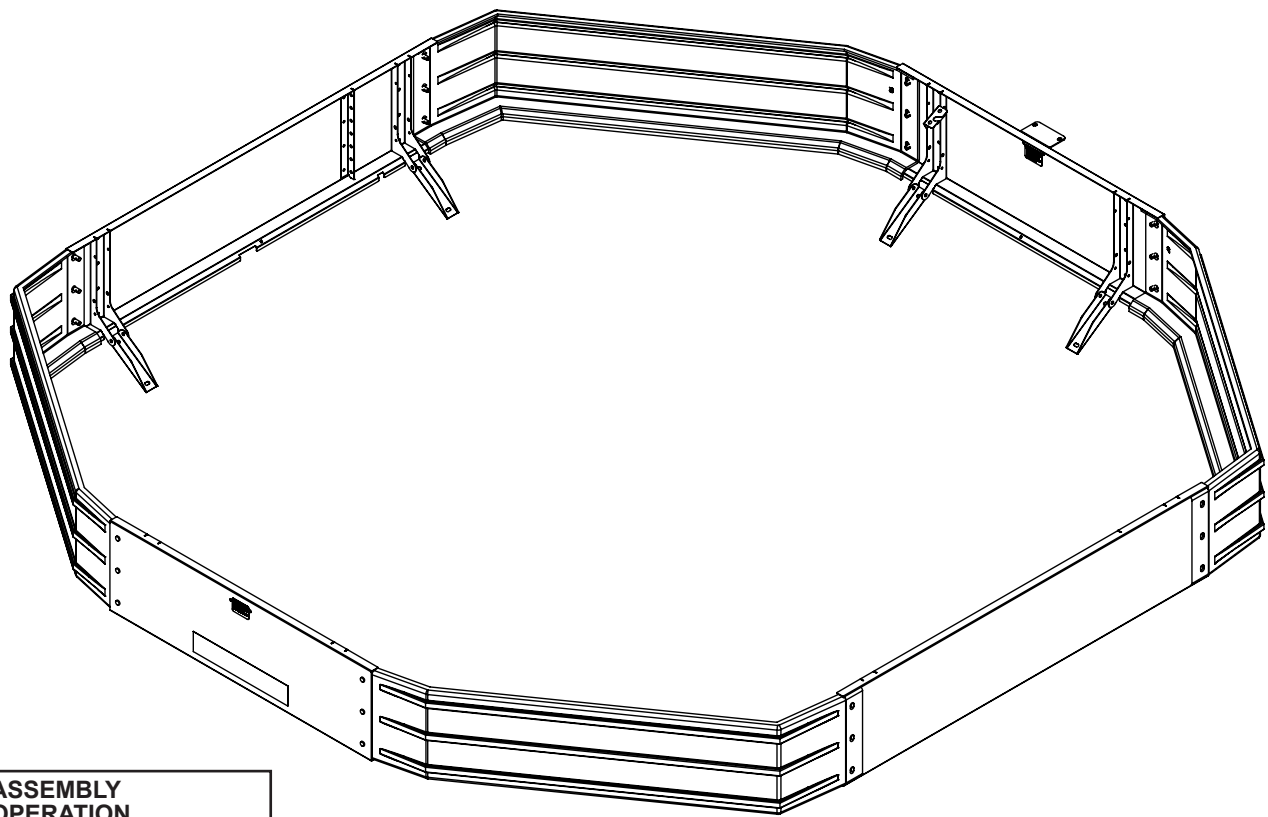

ASSEMBLY
OPERATION
REPLACEMENT PARTS

OPERATOR MANUAL

Introduction

Thank you for purchasing a Demco grain tank extension Tip-Up Kit. Proper care and use will result in many years of service.

WARRANTY POLICY, OPERATOR MANUALS, PARTS MANUALS & REGISTRATION

Go online to www.demco-products.com to review Demco warranty policies, operator manuals and register your Demco product.



WARNING: TO AVOID PERSONAL INJURY OR DEATH, OBSERVE FOLLOWING INSTRUCTIONS:

- Ensure that anybody present is clear before applying power to any machinery used in conjunction with a Demco grain tank extension.**
- Never allow anyone in or near the grain tank of a combine during loading or unloading of grain. The accumulation of grain is dangerous and can cause entrapment, resulting in serious injury or death by suffocation.**
- Adding a Demco Bin Extension or Tip-Up increases the overall height of your combine. Use caution when operating around trees, buildings, power lines, and when approaching bridges and over passes. Pay attention to height restrictions.**
- Do not exceed advertised maximum capacity of a Demco grain tank extension.**

GENERAL INFORMATION

1. Read assembly instructions carefully. Study assembly procedures and all illustrations before you begin assembly. Note which parts are used in each step. This unit must be assembled in proper sequence or complications will result.
2. When placing a parts order, refer to this manual for proper part numbers and place order by **PART NO.** and **DESCRIPTION.**
3. Whenever terms "LEFT" and "RIGHT" are used in this manual it means from a position behind combine and facing forward.

TABLE OF CONTENTS

General Information	2
Safety, Signal Words	3
Product Safety Guidelines.....	4
Product Disclaimer.....	4
Safety Sign Locations.....	5
Safety Sign Care	5
Parts Breakdown	6-7
Assembly Instructions	7-8
Tank Full Sensor	8
GPS Bracket	8
M120 Step Installation.....	9

TAKE NOTE! THIS SAFETY ALERT SYMBOL FOUND THROUGHOUT THIS MANUAL IS USED TO CALL YOUR ATTENTION TO INSTRUCTIONS INVOLVING YOUR PERSONAL SAFETY AND SAFETY OF OTHERS. FAILURE TO FOLLOW THESE INSTRUCTIONS CAN RESULT IN INJURY OR DEATH!



**THIS SYMBOL MEANS
ATTENTION
BECOME ALERT
YOUR SAFETY IS INVOLVED!**

SIGNAL WORDS:

This manual uses the following signal words--**DANGER**, **WARNING**, and **CAUTION**-- with safety messages. The appropriate signal word has been selected using the following guidelines.

DANGER:

Indicates an imminently hazardous situation that, if not avoided, will result in death or serious injury. This signal word is to be limited to most extreme situations typically for machine components which, for functional purposes, cannot be guarded.

WARNING:

Indicates a potentially hazardous situation that, if not avoided, could result in death or serious injury, and includes hazards that are exposed when guards are removed. It may also be used to alert against unsafe practices.

CAUTION:

Indicates a potentially hazardous situation that, if not avoided, may result in minor or moderate injury. It may also be used to alert against unsafe practices.

If you have questions not answered in this manual, require additional copies, or if your manual is damaged, please contact your dealer or DEMCO, 4010 320th Street, Boyden, IA 51234
ph: (712) 725-2311 or Toll Free: 1-800-543-3626 Fax: (712) 725-2380 or 1-800-845-6420
<http://www.demco-products.com>



PRODUCT SAFETY GUIDELINES

Every year many accidents occur which could have been avoided by a few seconds of thought and a more careful approach to handling equipment. You, the operator, can avoid many accidents by observing the following precautions in this section. To avoid personal injury, study the following precautions and insist those working with you, or you yourself, follow them.

Replace any caution, warning, danger or instruction safety decal that is not readable or is missing. Location of such decals is indicated in this booklet.

Review safety instructions with all users annually.

Operator should be a responsible adult. DO NOT ALLOW PERSONS TO OPERATE OR ASSEMBLE THIS UNIT UNTIL THEY HAVE DEVELOPED A THOROUGH UNDERSTANDING OF SAFETY PRECAUTIONS AND HOW IT WORKS.

Do not paint over, remove, or deface any safety signs or warning decals on your equipment. Observe all safety signs and practice instructions on them.

Never exceed limits of a piece of machinery. If it's ability to do a job, or to do so safely is in question DON'T TRY IT.

Adding a Demco Bin Extension or Tip-Up increases the overall height of your combine. Use caution when operating around trees, buildings, power lines, and when approaching bridges and over passes. Pay attention to height restrictions.

Fold and secure (if needed) the grain tank extension panels when transporting the combine to avoid contact with low power lines and other obstructions.

Ensure that any additional bracing and safety equipment have been installed according to this manual. (Some models do not require additional bracing or safety equipment)

Never exceed the maximum advertised capacity of the grain tank extension. By doing so you risk damage to the grain tank extension and combine.

PRODUCT DISCLAIMER

Increasing the grain tank capacity of any combine by use of this product is at the discretion of the owner. Increasing the grain holding capacity of any combine may affect the structural aspects of the combine as well as drive line components and tires. Although Demco has included additional support bracing on selected models, it does not assume liabilities, or make any warranties pertaining to the structural stability or performance of any combine. See the combine owners/operators manual for additional combine specifications and safety information not listed in this manual.



SAFETY SIGN LOCATIONS

Types of safety sign and locations on equipment are shown in illustration below. Good safety requires that you familiarize yourself with various safety signs, type of warning, and area or particular function related to that area, that requires your SAFETY AWARENESS.

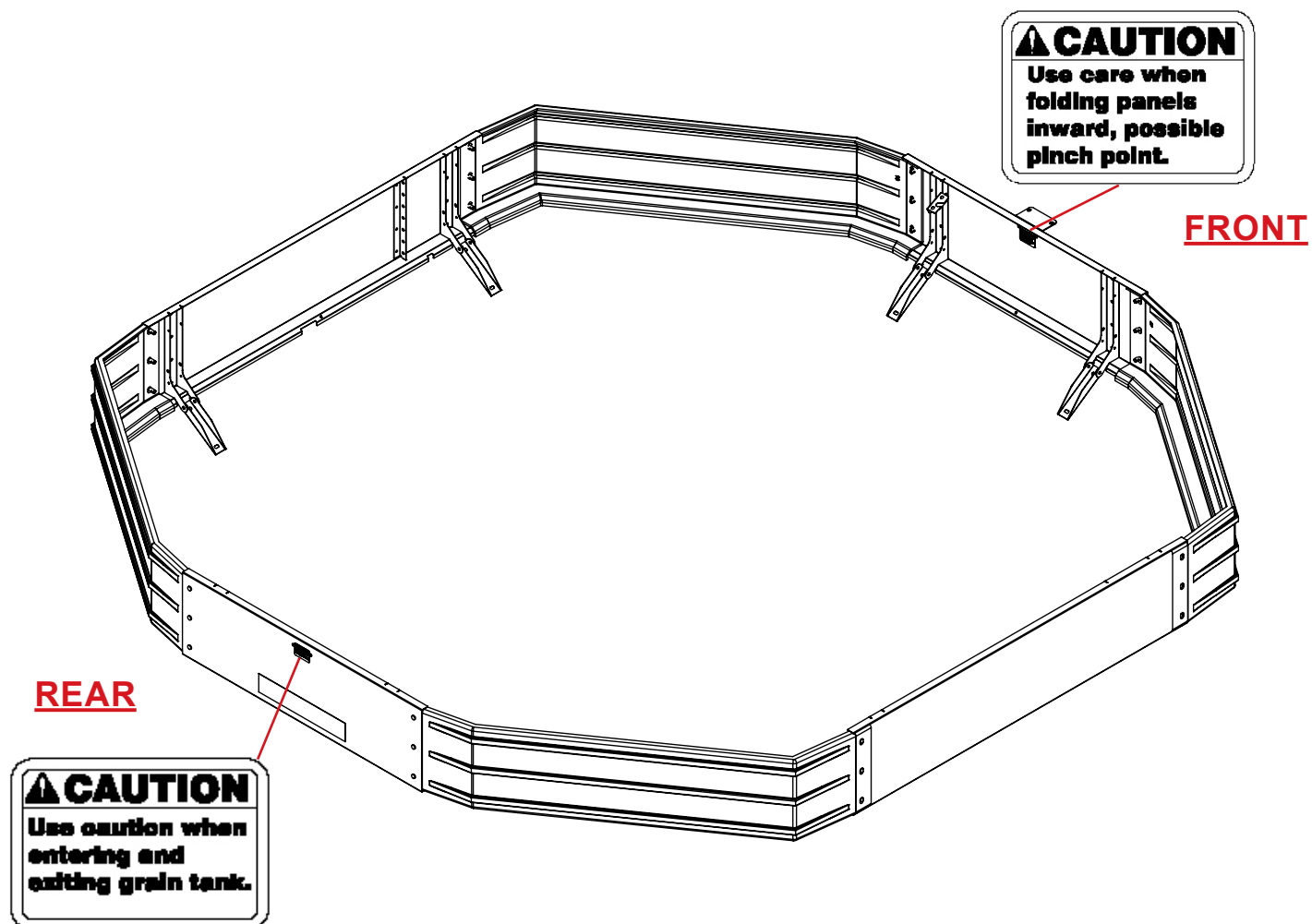

SAFETY SIGN CARE

- Keep safety signs clean and legible at all times.
- Replace safety signs that are missing or have become illegible.
- Replacement parts that displayed a safety sign should also display current sign.
- Safety signs are available from Demco.

MS120SQ Tip-Up Kit

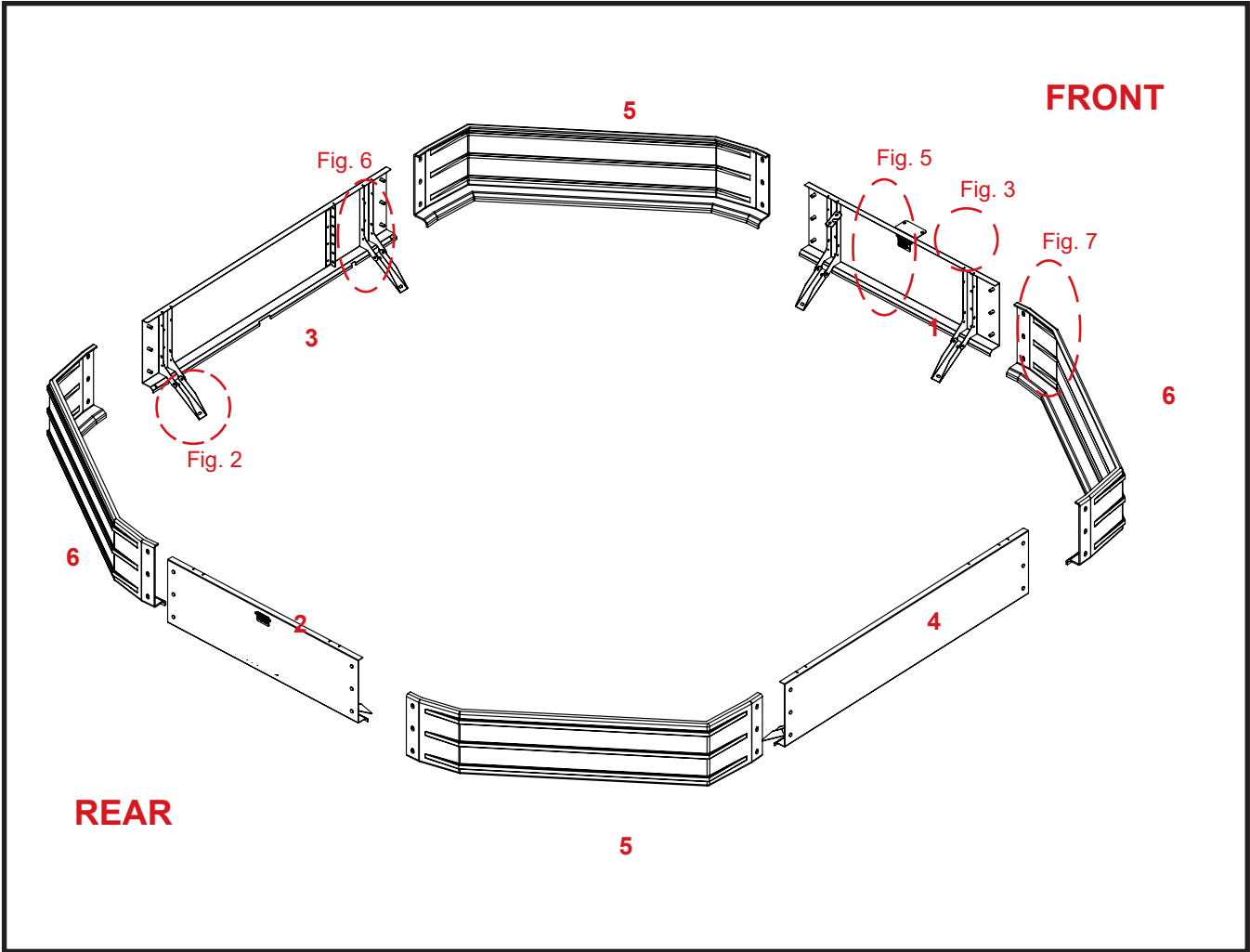

Figure 1

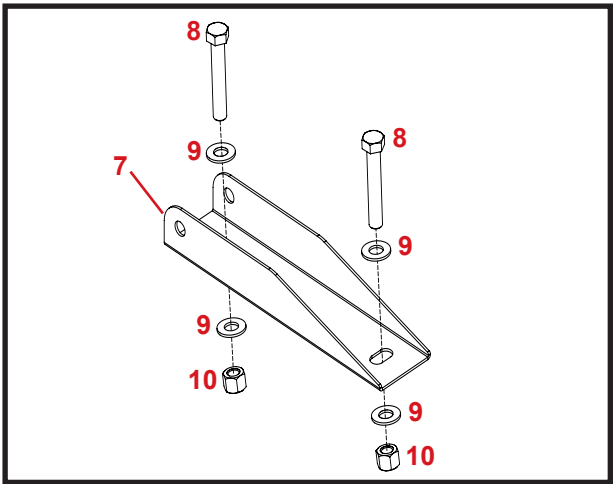

Figure 2

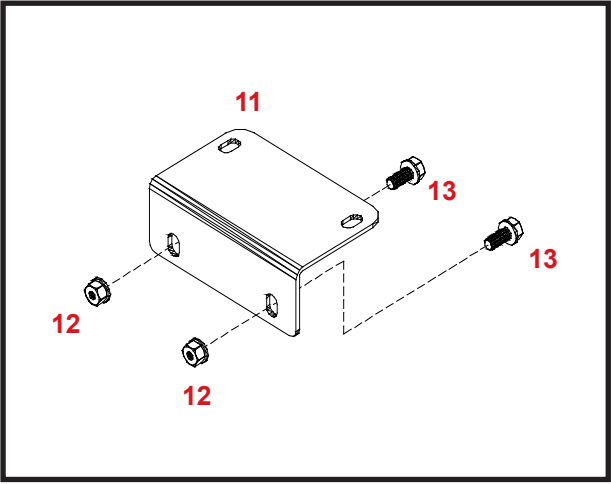

Figure 3

ITEM	PART #	QTY	DESCRIPTION
1	R5E000175P0	1	MS120SQ FRONT PANEL ASSEMBLY
2	R5E000176P0	1	MS120SQ REAR PANEL ASSEMBLY
3	R5E000177P0	1	MS120SQ LEFT PANEL ASSEMBLY
4	R5E000178P0	1	MS120SQ RIGHT PANEL ASSEMBLY
5	1AR00000086	2	MS120SQ LF/RR CORNER
6	1AR00000087	2	MS120SQ RF/LR CORNER
7	R3E000289P0	8	MS120SQ BOTTOM HINGE
8	1AFC12FBAD0	16	3/8" X 2-1/4" HEX BOLT
9	1AF009F000C	48	3/8" FLAT WASHER
10	1AFC18F0000	24	3/8" NYLON LOCK NUT
11	R3E000023P0	1	GPS BRACKET - JD LARGE
12	1AFC08E0000	2	5/16" FLANGE NUT
13	1AFC37E00L0	2	5/16" X 3/4" FLANGE BOLT
14	1AFC05D0000	3	1/4" CENTER LOCK NUT
15	1AF009D0000	3	1/4" FLAT WASHER
16	1AFC12DAA05	3	1/4" X 1" HEX BOLT
17	R3E000003P0	1	BASE LIGHT BRACKET
18	1AFC12FCA05	8	3/8" X 3" HEX BOLT
19	1AF034CAA10	24	3/16" X 1-9/16" LYNCH PIN
20	1AF032D0000	16	PLASTIC PRESS RIVOT FOR LANYARDS
21	1AF031DKA00	24	NYLON LANYARD
*22	1AEX0015240	2	M60 & M120 SENSOR WIRE HARNESS
Please order replacement parts by PART NO. and DESCRIPTION			

* Indicates items not shown in illustrations

ASSEMBLY INSTRUCTIONS

STEP 1:

The full bin sensor and bin light will need to be removed from the factory extension before any Tip-Up panels can be assembled to the factory extension.

STEP 2:

Use the existing holes in the outer ribs of the Factory JD Extension Panels as reference points. Use a 7/16" dia bit and electric drill, to drill holes completely through the panels as shown in figure 4.

NOTE: Some of the Factory JD Extension panels have a third rib located in the center of the panels. **DO NOT DRILL OUT EXISTING HOLES ON CENTER RIBS FOR HINGES!!**

STEP 3:

Fasten the bottom Tip-Up hinge to the Factory JD Extension panels using the 3/8" x 2-1/4" hex bolts, 3/8" flat washers, and 3/8" nylon lock nuts as shown in figure 2 on previous page.

NOTE: All steel Tip-Up panels must be installed first to ensure proper fit.

NOTE: DO NOT over tighten nuts and distort hinge component, but ensure nylon lock nut fully engages bolt threads.

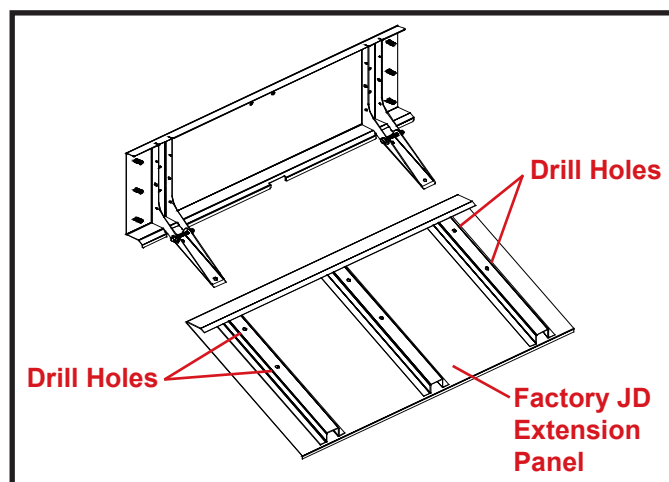

Figure 4

Assembly Instructions



ATTENTION: During assembly ensure the following safety decals are located correctly. See illustration on page 5.



Located on outside of rear panel.



Located on inside of front panel.

STEP 4:

Fasten the steel Tip-Up panels to the bottom hinges using the 3/8" x 3" hex bolts, 3/8" flat washers, and 3/8" nylon lock nuts. See figure 5.

STEP 5:

Once the front, rear, and side panels have been secured to the extension, fold the panels outward. Insert the four plastic corner panel to mate with the inside of the four steel panels. Fasten the joints with one 3/16" lynch pin per clevis pin. See figure 7.

STEP 6:

Align lanyards and press rivets as show in figure 7. Loop and lock the end of the lanyard around the ring of the lynch pin and proceed to pin the panel joint together.

LIGHT BRACKET & LIGHT

Mount the light bracket on the left hinge of the front Tip-Up panel. Use one 1/4" x 1" hex bolt, one 1/4" flat washer, and one 1/4" center lock nut. See figure 5. Mount OEM light on bracket using original hardware.

TANK FULL BIN SENSOR

Mount the tank full bin sensor to the desired height on the right Tip-Up panel. Use one 1/4" x 1" hex bolt, one 1/4" flat washer, and one 1/4" center lock nut. See figure 6.

GPS BRACKET

Remove the partial cut slugs from the front panel and fasten the provided GPS bracket to the outside of the panel using two 5/16" x 3/4" serrated flange bolts and two serrated flange nuts. See Figures 1& 3 on page 6.

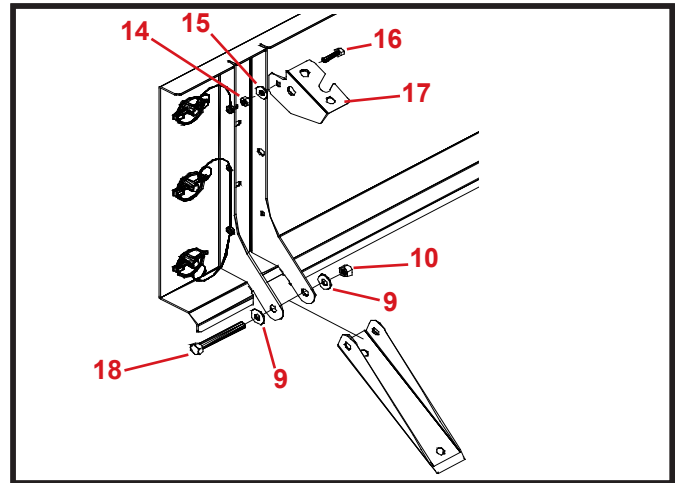

Figure 5

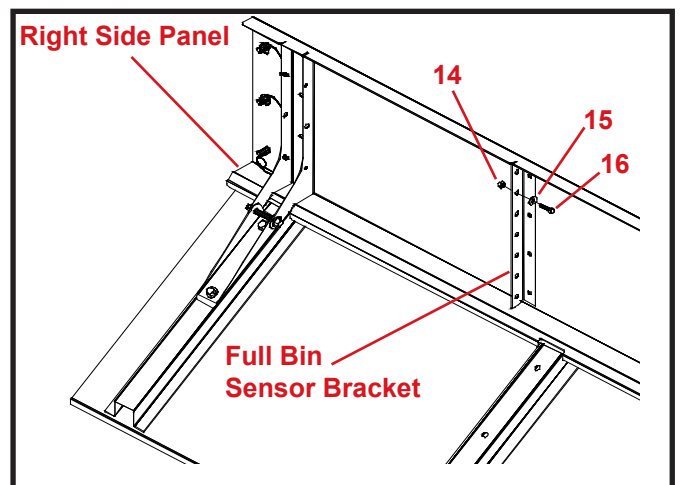

Figure 6

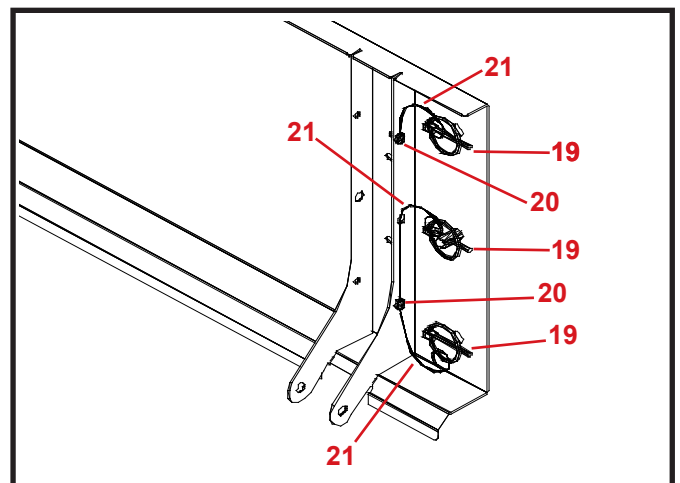

Figure 7

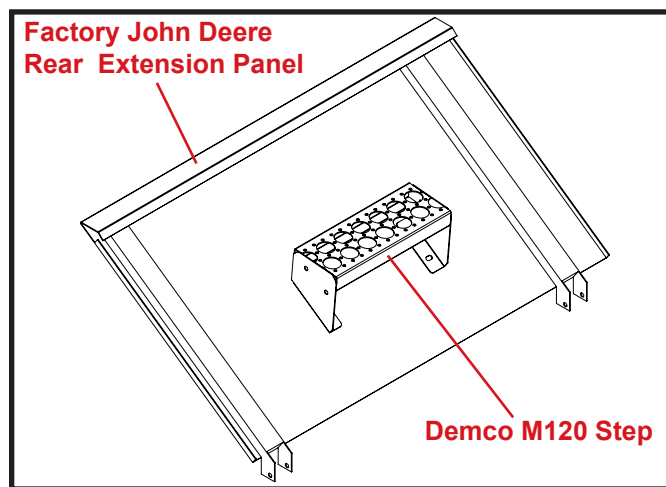

Figure 8

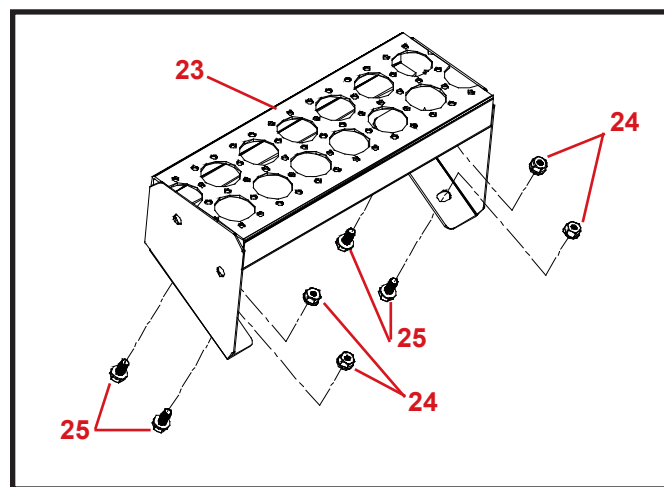

Figure 9

ITEM	PART #	QTY	DESCRIPTION
23	R5E000068P0	1	M120 STEP ASSEMBLY
24	1AFC08E0000	4	5/16" FLANGE NUT
25	1AFC37E0030	4	5/16" X 3/4" FLANGE BOLT
Please order replacement parts by PART NO. and DESCRIPTION			

STEP 1:

Place step on the rear panel of the factory Deere extension. Locate the step in a spot that is accessible for the user and allows the tip-up panel to fold down. Mark hole placements with a magic marker. See figure 8.

Caution: Be aware of the placement of the existing step located on the outside of the panel.

STEP 2:

Use a 7/16" diameter drill bit and electric drill to drill (4) holes thru the rear extension panel.

STEP 4:

Fasten the step to the rear extension panel using the (4) 5/16" x 3/4" flange bolts and (4) 5/16" flange nuts. See figure 9.



4010 320th St., Boyden, IA. 51234

Phone: (712) 725-2311

Fax: (712) 725-2380

Toll Free: 1-800-54DEMCO (1-800-543-3626)

**Demco warranty policies, operator manuals, and product registration
can be found online:**

www.demco-products.com