

2024 HARVEST EQUIPMENT

DEMCO

**NEW Dual Auger
Grain Cart design!**



Don't miss our new *High Speed All Wheel Steer* Header Transport! pg18

GRAIN CARTS
DUAL AUGER
1100-2200



GRAIN CARTS
SINGLE AUGER
850-1300



**GRAIN
WAGONS**
500-750



**HEADER
TRANSPORTS**



**GRAIN TANK
EXTENSIONS &
TIP-UPS**



**AUGERS &
EXTENDERS**



DUAL AUGER GRAIN CARTS

1700 DA
2200 DA

BUSHEL CAPACITY

	1700	2200
Level Full	1750	2200
Heaped	1900	2350

Bushel capacity measured with #2 corn at 15% moisture content (56 lb. test weight)

NOW
front folding

- DEMCO's newest Dual Auger Grain Cart design is available in **RIGHT SIDE** or **LEFT SIDE** unloading auger positions. The **NEW FRONT FOLDING AUGER** design allows us to maintain low clearance on both sides of the grain cart.
- These carts will maintain our corner auger design that gives the grain cart operator optimal visibility while unloading grain
- Demco grain carts are tough and reliable and help make our harvest operation productive and smooth
- Available on ALL Dual Auger Models in 2024 including the new 1500 Dual Auger Grain Cart

Demco's own forward reach and height adjust unloading auger!

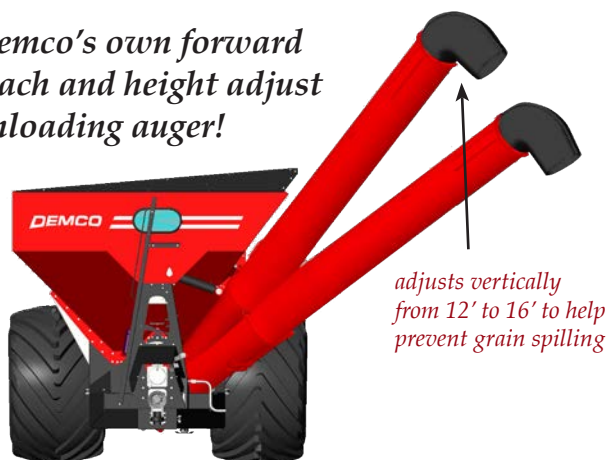

adjusts vertically from 12' to 16' to help prevent grain spilling

COLORS AVAILABLE:



picture shown is of 2023 side folding auger

STANDARD FEATURES

- 1 $\frac{3}{4}$ - 1000 RPM PTO
- Protect auger driver and tractor PTO with the automatic reset "cut-out" clutch with overrunning clutch
- NO Pulleys or Belts!** PTO driven drivetrain. Gearbox includes 2 output PTO shafts (1 for horizontal auger and 1 for vertical auger).
- Adjustable austempered cast hitch, fits category 4 or 5 hammer strap tractor drawbar
- Grain viewing windows
- 10,000 lb. drop-leg tongue jack with separate storage position **provides tighter turning radius**
- Hand wheel operated clean-out door at bottom of auger for **easy post season clean-out**
- High visibility** - reflective decals & LED lights
- Narrow transport width** - 14'
- Better clearance** - low side cart height **ONLY 11'1" (1700) and 11'8" (2200)**
- Low center of gravity for **side hill stability**
- 6 lever operated doors for trough clean-out
- Backlit ergonomic pendant (requires 1 remote outlet)
- Roll tarp
- 5-point scale system (monitor not included)

DUAL AUGERS

- 22" diameter vertical auger with 3/8" flighting and Posi-Drive connection
- 20" horizontal drag auger
- UltraFlyte made with 1008/1010 high carbon steel including a thicker outer edge, resulting in up to 50% longer wear and faster conveying
- Forward reach auger for optimum operator visibility - adjusts vertically from 12' to 16' to help prevent grain spilling
- Auger folds within the width of the box for compact transporting and storage
- 2 stage unload auger folding cylinder

OPTIONS

- Electric roll tarp
- Auto gate shutoff for drag auger doors (requires the Libra Cart Wireless Scale)
- Hydraulic Jack



Scan the QR code
for more
information on
the track system



NOTE: Demco grain carts are not to be towed down the road loaded

HOW TO ORDER: 1. Choose **Model** 2. Choose **Color** 3. Choose **Undercarriage Type** 4. Review **Accessories**

MODEL

** All grain carts require a Demco axle*

1700 Grain Cart - Gray	9445311	\$109,153.00
1700 Grain Cart - Red	9445308	\$109,153.00
1700 Grain Cart - Green	9445309	\$109,153.00
2200 Grain Cart - Gray	9445315	\$125,495.00
2200 Grain Cart - Red	9445312	\$125,495.00
2200 Grain Cart - Green	9445313	\$125,495.00

UNDERCARRIAGE with 5 POINT SCALE

1700 Grain Cart - Tandem Axle - 900/60/R32 - 10 Bolt Hub	9445464	\$89,308.00
2200 Grain Cart - Tandem Axle - 1050/50R/ 32 - 10 Bolt Hub	9445463	\$102,677.00
1700 42" Equalizer Tracks	9445481	\$180,210.00
2200 46" Equalizer Tracks	9445482	\$202,820.00

FACTORY INSTALLED ACCESSORIES

Cat 4 Bull-Pull Hitch™ (I.L.O. Cast Hitch)	9440125	\$461.00
Cat 5 Bull-Pull Hitch™ (I.L.O. Cast Hitch)	9440127	\$692.00
Electric Roll Tarp Kit	9440191	\$4,750.00
Hydraulic Jack	9445616	\$1,241.00

FIELD INSTALLED ACCESSORIES

Cat 4 Bull-Pull Hitch™	9440126	\$864.00
Cat 5 Bull-Pull Hitch™	9440128	\$1,094.00
Electric Roll Tarp Kit	9440192	\$5,414.00
Hydraulic Jack	9445617	\$1,522.00

ACCESSORIES

640 Console with harnesses	9440111	\$1,478.00
2060 Console with harnesses	9440116	\$2,803.00
ISO Bus ECU with harnesses	9440131	\$4,949.00
Wireless Scale Libra Cart *	9440177	\$3,152.00
Wireless Scale Libra Cart w/ Auto Gate Shutoff*	9440149	\$4,919.00
12 VDC Printer with interface cable	14990	\$1,102.00
Fire Safety System Kit	9440182	\$5,380.00

** Libra Cart is Android and Apple compatible*

DUAL AUGER GRAIN CARTS

1500 DA

BUSHEL CAPACITY

	<u>1500</u>
Level Full	1500
Heaped	

Bushel capacity measured with #2 corn at 15% moisture content (56 lb. test weight)

NOW
front folding

◀ DEMCO's newest Dual Auger Grain Cart design is available in **RIGHT SIDE or LEFT SIDE** unloading auger positions. The **NEW FRONT FOLDING AUGER** design allows us to maintain low clearance on both sides of the grain cart.

◀ These carts will maintain our corner auger design that gives the grain cart operator optimal visibility while unloading grain

◀ Demco grain carts are tough and reliable and help make our harvest operation productive and smooth

◀ Available on ALL Dual Auger Models in 2024 including the new 1500 Dual Auger Grain Cart

COLORS AVAILABLE:



STANDARD FEATURES

- 1 $\frac{3}{4}$ - 1000 RPM PTO
- **Protect auger driver and tractor PTO** with the automatic reset "cut-out" clutch with overrunning clutch
- **NO Pulleys or Belts!** PTO driven drivetrain. Gearbox includes 2 output PTO shafts (1 for horizontal auger and 1 for vertical auger).
- Adjustable austempered cast hitch, fits category 4 or 5 hammer strap tractor drawbar
- Grain viewing windows
- 10,000 lb. drop-leg tongue jack with separate storage position **provides tighter turning radius**
- Hand wheel operated clean-out door at bottom of auger for **easy post season clean-out**
- **High visibility** - reflective decals & LED lights
- **Narrow transport width** - 14'
- **Better clearance** - low side cart height
- Low center of gravity for **side hill stability**
- 6 lever operated doors for trough clean-out
- Backlit ergonomic pendant (requires 1 remote outlet)
- Roll tarp
- 5-point scale system (monitor not included)

DUAL AUGERS

- 22" diameter vertical auger with 3/8" flighting and Posi-Drive connection
- 20" horizontal drag auger
- UltraFlyte made with 1008/1010 high carbon steel including a thicker outer edge, resulting in up to 50% longer wear and faster conveying
- Forward reach auger for optimum operator visibility - adjusts vertically from 12' to 16' to help prevent grain spilling
- Auger folds within the width of the box for compact transporting and storage
- 2 stage unload auger folding cylinder

OPTIONS

- Camso Track Systems - 100 Series, 36" Wide Belt
- Soucy Track Systems - 36" Wide Belt
- Electric roll tarp
- Auto gate shutoff for drag auger doors (requires the Libra Cart Wireless Scale)
- Hydraulic Jack



NOTE: Demco grain carts are not to be towed down the road loaded

HOW TO ORDER: 1. Choose **Model** 2. Choose **Color** 3. Choose **Undercarriage Type** 4. Review **Accessories**

MODEL

** All grain carts require a Demco axle*

1500 Grain Cart - Gray	9445307	\$99,255.00
1500 Grain Cart - Red	9445304	\$99,255.00
1500 Grain Cart - Green	9445305	\$99,255.00

UNDERCARRIAGE with 5 POINT SCALE

1500 Camso Track with Axle	9445456	\$137,579.00
1500 Soucy Track with Axle	9445479	\$137,579.00

FACTORY INSTALLED ACCESSORIES

Cat 4 Bull-Pull Hitch™ (I.L.O. Cast Hitch)	9440125	\$461.00
Cat 5 Bull-Pull Hitch™ (I.L.O. Cast Hitch)	9440127	\$692.00
Electric Roll Tarp Kit	9440189	\$4,750.00
Hydraulic Jack	9445616	\$1,241.00

FIELD INSTALLED ACCESSORIES

Cat 4 Bull-Pull Hitch™	9440126	\$864.00
Cat 5 Bull-Pull Hitch™	9440128	\$1,094.00
Electric Roll Tarp Kit	9440190	\$5,414.00
Hydraulic Jack	9445617	\$1,522.00

ACCESSORIES

640 Console with harnesses	9440111	\$1,478.00
2060 Console with harnesses	9440116	\$2,803.00
ISO Bus ECU with harnesses	9440131	\$4,949.00
Wireless Scale Libra Cart *	9440177	\$3,152.00
Wireless Scale Libra Cart w/ Auto Gate Shutoff*	9440149	\$4,919.00
12 VDC Printer with interface cable	14990	\$1,102.00
Fire Safety System Kit	9440182	\$5,380.00

** Libra Cart is Android and Apple compatible*

DUAL AUGER GRAIN CARTS

1100 DA
1300 DA

BUSHEL CAPACITY

	1100	1300
Level Full	1150	1325
Heaped	1250	1425

Bushel capacity measured with #2 corn at 15% moisture content (56 lb. test weight)

*picture shown
is of 2023 side
folding auger*



**EASY TO
FUNCTION IN
THE DARK**

BACKLIT PENDANT GRIP CONTROL

*Ergonomic pendant operates "1 touch"
auger fold, adjustable spout, unload auger
height adjust, and drag auger door*

STANDARD FEATURES

- 1 $\frac{3}{4}$ - 1000 RPM PTO
- **Protect auger driver and tractor PTO** with the automatic reset "cut-out" clutch with overrunning clutch
- **NO Pulleys or Belts!** PTO driven drivetrain. Gearbox includes 2 output PTO shafts (1 for horizontal auger and 1 for vertical auger).
- Adjustable austempered cast hitch, fits category 4 or 5 hammer strap tractor drawbar
- Grain viewing windows
- 10,000 lb. drop-leg tongue jack with separate storage position **provides tighter turning radius**
- Hand wheel operated clean-out door at bottom of auger for **easy post season clean-out**
- **High visibility** - reflective decals & LED lights
- **Narrow transport width** - w/ 1050 tires: 11' 9", w/ 1250 tires: 12' 4"
- **Better clearance** - low side cart height ONLY 11'
- Low center of gravity for **side hill stability**
- 6 lever operated doors for trough clean-out
- Backlit ergonomic pendant (requires 1 remote outlet)
- Roll tarp
- 5-point scale system (monitor not included)

"PTO Driven Drivetrain"

"Reflective Decals"



"Low Profile"

**"5 Point Scale
System"**

DUAL AUGERS

- 22" diameter vertical auger with 3/8" flighting and Posi-Drive connection
- 20" horizontal drag auger
- UltraFlyte made with 1008/1010 high carbon steel including a thicker outer edge, resulting in up to 50% longer wear and faster conveying
- Forward reach auger for optimum operator visibility - adjusts vertically from 12' to 16' to help prevent grain spilling
- Auger folds within the width of the box for compact transporting and storage
- 2 stage unload auger folding cylinder

OPTIONS

- Camso Track Systems - 100 Series, 36" Wide Belt
- Soucy Track Systems - 36" Wide Belt
- Electric roll tarp
- Auto gate shutoff for drag auger doors (requires the Libra Cart Wireless Scale)
- Hydraulic Jack

COLORS AVAILABLE:



**Demco's own forward reach and
NEW height adjust unloading auger!**



◀ DEMCO's newest Dual Auger Grain Cart design is available in **RIGHT SIDE or LEFT SIDE** unloading auger positions. The **NEW FRONT FOLDING AUGER** design allows us to maintain low clearance on both sides of the grain cart.

◀ These carts will maintain our corner auger design that gives the grain cart operator optimal visibility while unloading grain

◀ Demco grain carts are tough and reliable and help make our harvest operation productive and smooth

◀ Available on ALL Dual Auger Models in 2024 including the new 1500 Dual Auger Grain Cart

NOTE: Demco grain carts are not to be towed down the road loaded

HOW TO ORDER: 1. Choose **Model** 2. Choose **Color** 3. Choose **Undercarriage** 4. Review **Accessories**

MODEL

**All grain carts require a Demco axle*

1100 Grain Cart - Gray	9445199	\$87,460.00
1100 Grain Cart - Red	9445196	\$87,460.00
1100 Grain Cart - Green	9445197	\$87,460.00
1300 Grain Cart - Gray	9445303	\$90,216.00
1300 Grain Cart - Red	9445300	\$90,216.00
1300 Grain Cart - Green	9445301	\$90,216.00

AXLE TYPE with 5 POINT SCALE

1100 Axle with 1050/50R32 Tires - 10 Bolt	9445453	\$64,180.00
1300 Axle with 1250/50R32 Tires - 20 Bolt	9445461	\$73,125.00
Camso Track w/ Axle	9445456	\$137,579.00
Soucy Track w/ Axle	9445479	\$137,579.00

FACTORY INSTALLED ACCESSORIES

Cat 4 Bull-Pull Hitch™ (I.L.O. Cast Hitch)	9440125	\$461.00
Cat 5 Bull-Pull Hitch™ (I.L.O. Cast Hitch)	9440127	\$692.00
Electric Roll Tarp Kit	9440189	\$3,897.00
Hydraulic Jack	9445616	\$1,241.00

FIELD INSTALLED ACCESSORIES

Cat 4 Bull-Pull Hitch™	9440126	\$864.00
Cat 5 Bull-Pull Hitch™	9440128	\$1,094.00
Hydraulic Jack	9445617	\$1,522.00
Electric Roll Tarp Kit	9440190	\$3,458.00

ACCESSORIES

640 Console with harnesses	9440111	\$1,478.00
2060 Console with harnesses	9440116	\$2,803.00
ISO Bus ECU with harnesses	9440131	\$4,949.00
Wireless Scale Libra Cart	9440177	\$3,152.00
Wireless Scale Libra Cart w/ Auto Gate Shutoff*	9440149	\$4,919.00
12 VDC Printer with interface cable	14990	\$1,102.00
Slip plate coating	SLIPPL	Net. \$549.00
Fire Safety System Kit	9440182	\$5,380.00

** Libra Cart is Android and Apple compatible*

SINGLE AUGER GRAIN CARTS

1300 SA
1500 SA

BUSHEL CAPACITY

	1500	1300
Level Full	1500	1300
Heaped	1575	1375

Bushel capacity measured with #2 corn at 15% moisture content (56 lb. test weight)



Standard Feature



**EASY TO
FUNCTION IN
THE DARK**

BACK LIT PENDANT GRIP

Optional ergonomic pendant operates grain flow gate, auger fold, and adjustable spout

HYDRAULICS NOTES:

- A standard grain cart requires three hydraulic remotes.
- Optional Pendant Control manages slide gate, folding auger and adjustable spout. Requires one hydraulic remote.
- 70 GPM max oil flow is required for high speed high torque hydraulic unloading drive.

COLORS AVAILABLE:



NOTE: Demco grain carts are not to be towed down the road loaded

STANDARD FEATURES

- 1 $\frac{3}{4}$ - 1000 RPM PTO
- Protect auger driver and tractor PTO with the automatic reset "cut-out" clutch with overrunning clutch
- Adjustable austempered cast hitch, fits category 4 or 5 hammer strap tractor drawbar
- High visibility - reflective decals
- LED Tail, flasher/turn signal lights and auger spotlight for nighttime operation
- Tube and truss design
- Welded box construction with silicone sealed seams resists rust and corrosion
- Heavy duty spindles and hubs

AUGER

- 20" diameter balanced auger with 3/8" flighting and Posi-Drive connection
- UltraFlyte made with 1008/1010 high carbon steel including a thicker outer edge, resulting in up to 50% longer wear and faster conveying
- Forward reach auger for optimum operator visibility
- 2 stage unload auger folding cylinder

OPTIONS

- Roll top tarp
- Ergonomic pendant control
- Scale kits
- Hydraulic Drive Kit - High Speed/Torque
- Camso Track Systems - 100 Series, 36" Wide Belt
- Soucy Track Systems - 36" Wide Belt



HOW TO ORDER: 1. Choose **Model** 2. Choose **Color** 3. Choose **Undercarriage** 4. Review **Accessories**

MODEL

** All grain carts require a Demco axle*

1300 Grain Cart - Gray	9445185	\$64,460.00
1300 Grain Cart - Red	9445182	\$64,460.00
1300 Grain Cart - Green	9445183	\$64,460.00
1500 Grain Cart - Gray	9445189	\$66,028.00
1500 Grain Cart - Red	9445186	\$66,028.00
1500 Grain Cart - Green	9445187	\$66,028.00

UNDERCARRIAGE

1300 Axle with 1250 LSW Tires - 10 Bolt		Call for Price and Availability
1300 Axle with 1250/50 R32 Tires - 10 Bolt	9445472	\$45,831.00
1300/1500 Axle with 1250/50R32 Tires - 20 Bolt	9445473	\$51,645.00
Track System - Camso 100 Series	9445471	\$114,927.00
Track System - Soucy	9445480	\$114,927.00

FACTORY INSTALLED ACCESSORIES

1300 Roll Up Tarp System	9440162	\$4,590.00
1300 Electric Tarp Kit (Does not include tarp)	9440175	\$6,145.00
1500 Roll Up Tarp System	9440164	\$4,818.00
1500 Electric Tarp Kit (Does not include tarp)	9440173	\$6,145.00
Scale System - 5 Point (Less Console)	9440166	\$7,591.00
12" Auger Spout Extension	9440122	\$315.00
Cat 4 Bull -Pull Hitch™ (I.L.O Cast Hitch)	9440125	\$461.00
Cat 5 Bull -Pull Hitch™ (I.L.O Cast Hitch)	9440127	\$692.00
Pendant Grip Control	9440081	\$3,955.00
High Speed High Torque Hydraulic (70 PGM Max oil flow and 3 remote outlets required)	9445619	\$5,836.00

FIELD INSTALLED ACCESSORIES

1300 Roll Up Tarp System	9440161	\$3,457.00
1300 Electric Tarp Kit (Does not include tarp)	9440174	\$5,638.00
1500 Roll Up Tarp System	9440163	\$3,773.00
1500 Electric Tarp Kit (Does not include tarp)	9440172	\$5,638.00
Scale System - 5 Point (Less Console)	9440165	\$10,928.00
12" Auger Spout Extension	9440121	\$161.00
Pendant Grip Control	9440104	\$4,482.00
High Speed High Torque Hydraulic Drive (70 GPM Max oil flow and 3 remote outlets required)	9445618	\$7,446.00

ACCESSORIES

Slip plate coating (Recommended for Rice)	SLIPPL	Net. \$549.00
Chrome Flighting (In Lieu of Standard Flighting)	9440158	\$3,942.00
Wireless Scale Libra Cart	9440112	\$2,980.00
640 Console with Harness	9440111	\$1,478.00
Pendant Extension Harness	17060	\$660.00

SINGLE AUGER GRAIN CARTS

1000 SA
1100 SA

BUSHEL CAPACITY

	1000	1100
Level Full	1000	1100
Heaped	1100	1200

Buschel capacity measured with #2 corn at 15% moisture content (56 lb. test weight)



Standard Feature



**EASY TO
FUNCTION IN
THE DARK**

BACK LIT PENDANT GRIP

Optional ergonomic pendant operates grain flow gate, auger fold, and adjustable spout

HYDRAULICS NOTES:

- A standard grain cart requires three hydraulic remotes.
- Optional Pendant Control manages slide gate, folding auger and adjustable spout. Requires one hydraulic remote.
- 70 GPM max oil flow is required for high speed high torque hydraulic unloading drive.

COLORS AVAILABLE:



NOTE: Demco grain carts are not to be towed down the road loaded

STANDARD FEATURES

- 1 $\frac{3}{4}$ - 1000 RPM PTO
- Protect auger driver and tractor PTO with the automatic reset "cut-out" clutch with overrunning clutch
- Adjustable austempered cast hitch, fits category 4 or 5 hammer strap tractor drawbar
- High visibility - reflective decals
- LED Tail, flasher/turn signal lights and auger spotlight for nighttime operation
- Tube and truss design - adjustable axle
- Welded box construction with silicone sealed seams resists rust and corrosion
- Heavy duty spindles and hubs

AUGER

- 20" diameter balanced auger with 3/8" flighting and Posi-Drive connection
- UltraFlyte made with 1008/1010 high carbon steel including a thicker outer edge, resulting in up to 50% longer wear and faster conveying
- Forward reach auger for optimum operator visibility
- 2 stage unload auger folding cylinder

OPTIONS

- Roll top tarp
- Ergonomic pendant control
- Scale kits
- Hydraulic Drive Kit - High Speed /Torque
 - 1000 SA - 70 Series
 - 1100 SA - 70 or 100 Series
- Soucy Hub Mount Track System



HOW TO ORDER: 1. Choose **Model** 2. Choose **Color** 3. Choose **Undercarriage** 4. Review **Accessories**

MODEL

** All grain carts require a Demco axle*

1000 Grain Cart - Gray	9445175	\$47,891.00
1000 Grain Cart - Red	9445172	\$47,891.00
1000 Grain Cart - Green	9445173	\$47,891.00
1100 Grain Cart - Gray	9445179	\$53,159.00
1100 Grain Cart - Red	9445176	\$53,159.00
1100 Grain Cart - Green	9445177	\$53,159.00

UNDERCARRIAGE

Axle with 1250/50 R32 tires	9445477	\$45,228.00
Axle with 1050/50 R32 tires	9445468	\$39,936.00
Axle with 900/60R32 tires	9445467	\$26,562.00
Track System - Camso 70 Series	9445466	\$108,238.00
Track System - Camso 100 Series	9445469	\$114,857.00
Track System - Soucy	9445478	\$114,857.00

FACTORY INSTALLED ACCESSORIES

1000/1100 Roll Up Tarp System	9440152	\$4,136.00
1000/1100 Electric Tarp Kit (Does not include tarp)	9440171	\$5,402.00
Scale System - 5 Point (Less console)	9440154	\$6,988.00
Scale System - 5 Point Track - 100 Series ONLY (Less console)	9440160	\$8,820.00
12" Auger Spout Extension	9440122	\$315.00
Cat 3-4 Bull-Pull Hitch™ (I.L.O. Cast Hitch)	9440179	\$467.00
Cat 5 Bull-Pull Hitch™ (I.L.O. Cast Hitch)	9440127	\$692.00
Pendant Grip Control	9440081	\$3,955.00
High Speed High Torque Hydraulic (70 GPM Max oil flow and 3 remote outlets required)	9445619	\$5,836.00

FIELD INSTALLED ACCESSORIES

1000/1100 Roll Up Tarp System	9440151	\$3,526.00
1000/1100 Electric Tarp Kit (Does not include tarp)	9440170	\$4,895.00
Scale System - 5 Point (Less console)	9440153	\$9,529.00
Scale System - 5 Point - 4 Bogie Track (Less console)	9440159	\$12,469.00
12" Auger Spout Extension	9440121	\$161.00
Pendant Grip Control	9440104	\$4,482.00
High Speed High Torque Hydraulic Drive (70 GPM Max oil flow and 3 remote outlets required)	9445618	\$7,446.00
Cat 3-4 Bull-Pull Hitch	9440180	\$876.00

ACCESSORIES

Slip plate coating (Recommended for Rice)	SLIPPL	Net. \$549.00
Chrome Flighting (In Lieu of Standard Flighting)	9440158	\$3,942.00
Wireless Scale Libra Cart	9440112	\$2,980.00
640 Console with Harness	9440111	\$1,478.00
Pendant Extension Harness	17060	\$660.00

SINGLE AUGER GRAIN CARTS

850 SA

BUSHEL CAPACITY

	850
Level Full	850
Heaped	925

Bushel capacity measured with #2 corn at 15% moisture content (56 lb. test weight)



Standard Feature



BACK LIT PENDANT GRIP

Optional ergonomic pendant operates grain flow gate, auger fold, and adjustable spout

HYDRAULICS NOTES:

- A standard grain cart requires three hydraulic remotes.
- Optional Pendant Control manages slide gate, folding auger and adjustable spout. Requires one hydraulic remote.
- 70 GPM max oil flow is required for high speed high torque hydraulic unloading drive and requires 3 remote outlets.

COLORS AVAILABLE:



NOTE: Demco grain carts are not to be towed down the road loaded

STANDARD FEATURES

- 1 $\frac{3}{4}$ - 1000 RPM PTO
- **Protect auger driver and tractor PTO** with the automatic reset "cut-out" clutch with overrunning clutch
- Adjustable austempered cast hitch, fits category 4 or 5 hammer strap tractor drawbar
- **High visibility** - reflective decals
- LED Tail, flasher/turn signal lights and auger spotlight for nighttime operation
- **Tube and truss design** - adjustable axle
- Welded box construction with silicone sealed seams resists rust and corrosion
- Heavy duty spindles and hubs

AUGER

- 20" diameter balanced auger with 3/8" flighting and Posi-Drive connection
- UltraFlyte made with 1008/1010 high carbon steel including a thicker outer edge, resulting in up to 50% longer wear and faster conveying
- Forward reach auger for optimum operator visibility
- 2 stage unload auger folding cylinder

OPTIONS

- Roll top tarp
- Ergonomic pendant control
- Scale kits
- Hydraulic Drive Kit - High Speed/Torque
- Camso Track System
 - 850 SA - 70 Series
- Soucy Hub Mount Track System



HOW TO ORDER: 1. Choose **Model** 2. Choose **Color** 3. Choose **Undercarriage** 4. Review **Accessories**

MODEL

** All grain carts require a Demco axle or approved track system*

850 Grain Cart - Gray	9445195	\$45,589.00
850 Grain Cart - Red	9445191	\$45,589.00
850 Grain Cart - Green	9445192	\$45,589.00

UNDERCARRIAGE

850 Axle with 24.5 x 32 Lug Tires	9445474	\$19,736.00
850 Axle with 30.5 x 32 Lug Tires	9445475	\$21,889.00
850 Axle with 900/60 R32 Lug Tires	9445476	\$26,163.00
Track System - Camso 70 Series	9445466	\$108,238.00

FACTORY INSTALLED ACCESSORIES

850 Roll Up Tarp	9440152	\$4,136.00
Scale System - 5 Point (Less Console)	9440154	\$6,988.00
12" Auger Spout Extension	9440122	\$315.00
Cat 3-4 Bull-Pull Hitch™ (I.L.O. Cast Hitch)	9440179	\$467.00
Pendant Grip Control	9440081	\$3,955.00
High Speed High Torque Hydraulic (70 PGM Max oil flow and 3 remote outlets required)	9445619	\$5,836.00

FIELD INSTALLED ACCESSORIES

850 Roll Up Tarp	9440151	\$3,526.00
Scale System - 5 Point (Less Console)	9440153	\$9,529.00
12" Auger Spout Extension	9440121	\$161.00
Pendant Grip Control	9440104	\$4,482.00
High Speed High Torque Hydraulic Drive (70 PGM Max oil flow and 3 remote outlets required)	9445618	\$7,446.00
Cat 3-4 Bull-Pull Hitch	9440180	\$876.00

ACCESSORIES

Slip plate coating	SLIPPL	Net. \$549.00
Chrome Flighting (In Lieu of Standard Flighting)	9440158	\$3,942.00
Wireless Scale Libra Cart	9440112	\$2,980.00
640 Console with Harness	9440111	\$1,478.00

** Libra Cart is Android and Apple compatible*

SINGLE AUGER GRAIN CARTS

650
750



BUSHEL CAPACITY

	650	750
Level Full	625	700
Heaped	675	725

Bushel capacity measured with #2 corn at 15% moisture content (56 lb. test weight)

STANDARD FEATURES

- 1000 RPM PTO
- **Protect auger driver and tractor PTO** with the automatic reset "cut-out" clutch with overrunning clutch
- 2 grain viewing windows
- 7,000 lb. drop-leg tongue jack with separate storage position **provides tighter turning radius**
- Hand wheel operated clean-out door at bottom of auger for **easy post season clean-out**
- 30" hydraulic controlled flow gate
- **High visibility** - reflective decals
- LED Tail, flasher/turn signal lights and auger spotlight for nighttime operation
- **Transport width: 12' 9"**
- Welded box construction with silicone sealed seams resists rust and corrosion
- 22,500 lb. Ductile Iron Hubs

Optional Feature



EASY TO FUNCTION IN THE DARK

BACK LIT PENDANT GRIP

Optional ergonomic pendant operates grain flow gate, auger fold, and adjustable spout

AUGER

- 14" diameter balanced auger with 3/8" flighting and Posi-Drive connection
- UltraFlyte made with 1008/1010 high carbon steel including a thicker outer edge, resulting in up to 50% longer wear and faster conveying
- Forward reach auger for optimum operator visibility
- Auger folds within the width of the box for compact transporting and storage

OPTIONS

- Hydraulic Drive Kit (15-25 GPM oil flow required)
- Roll top tarp
- Ergonomic pendant control
- Adjustable auger spout
- Scale Kits

HYDRAULICS NOTES:

- A standard grain cart requires two hydraulic remotes.

COLORS AVAILABLE:



NOTE: Demco grain carts are not to be towed down the road loaded

HOW TO ORDER: 1. Choose **Model** 2. Choose **Color** 3. Choose **Axle Type** 4. Choose **Drive Package** 5. Choose **Wheels** 6. Review **Accessories**

MODEL

** All grain carts require a Demco axle*

650 Grain Cart - Gray	9445136	\$26,870.00
650 Grain Cart - Red	9445041	\$26,870.00
650 Grain Cart - Green	9445042	\$26,870.00
750 Grain Cart - Gray	9445137	\$31,555.00
750 Grain Cart - Red	9445043	\$31,555.00
750 Grain Cart - Green	9445044	\$31,555.00

AXLE TYPE

650 - 120" Axle less wheels	9445405	\$7,465.00
650 - 120" - 144" Adj. Axle less wheels (for use with single wheels)	9445406	\$8,379.00
650/750 - Dual Wheels fixed 120" - 180" less wheels	9445419	\$10,112.00
750 - 120" Axle less wheels	9445409	\$9,146.00
750 - 120" - 144" Adj. Axle less wheels (for use with single wheels)	9445410	\$10,530.00

DRIVE PACKAGE

1000 RPM PTO - 1 3/8" spline with automatic clutch	13399	\$1,089.00
1000 RPM PTO - 1 3/4" spline with automatic clutch	13398	\$1,190.00
Hydraulic drive (15-25 GPM oil flow required. Reduces auger speed)	9445611	\$2,773.00

WHEELS AND TIRES (2 REQUIRED)

24.5 x 32 12 ply lug tire & wheel (silver) (09380-60)	9445201-60	\$5,094.00/ea x 2=	\$10,188.00
24.5 x 32 12 ply diamond tire & wheel (silver) (09380-60) <i>Special Order</i>	9445202-60	\$6,035.00/ea x 2=	\$12,070.00
30.5 x 32 12 ply lug tire & wheel (silver) (09381-60)	9445203-60	\$6,131.00/ea x 2=	\$12,262.00
30.5 x 32 12 ply diamond tire & wheel (silver) (09381-60) <i>Special Order</i>	9445204-60	\$6,502.00/ea x 2=	\$13,004.00
Duals - 18.4 x 38 - 8 ply lug tire & wheel (silver) 30" row spacing	9445215-60	\$12,483.00/ea x 2=	\$24,966.00
Duals - 520/85R38 155B load index, lug tire & wheel (silver) (10830-60) 30" row spacing	9445213-60	\$12,167.00/ea x 2=	\$24,334.00

Note: Units ordered less wheels is NOT recommended and voids any and all warranty consideration on hubs, spindles, bearings, axle and related components

FACTORY INSTALLED ACCESSORIES

Roll Up Tarp* (end caps reduce load capacity)	9440090	\$3,300.00
Scale (less console)	9440067	\$4,473.00
Pendant Grip Control	9440082	\$2,695.00

FIELD INSTALLED ACCESSORIES

Roll Up Tarp (end caps reduce load capacity)	9440020	\$2,661.00
Scale (less console)	9440069	\$5,172.00
Standard Hydraulic Drive (15-25 GPM oil flow required. Reduces auger speed)	9445611	\$2,773.00
Pendant Grip Control	9440105	\$3,241.00

ACCESSORIES

640 Console with harnesses	9440111	\$1,478.00
Wireless Scale Libra Cart *	9440112	\$2,980.00
15' Harness Extension for Scale	13266	\$298.00
12 VDC Printer with interface cable	14990	\$1,102.00
Adjustable Auger Spout (requires 1 hydraulic remote)	9440077	\$1,370.00
Slip Plate Coating	SLIPPL	Net. \$549.00

** Roll tarps: some dealer assembly required. Tarp & bows are removed due to shipping restrictions*

** Libra Cart is Android and Apple compatible*

GRAIN WAGONS STRONGER & SAFER

500 SS
650 SS
750 SS



Demco wagons lead the industry in unloading performance!

BUSHEL CAPACITY

500 SS - 500 bushels

650 SS - 650 bushels

750 SS - 750 bushels

Bushel capacity measured with #2 corn at 15% moisture content (56 lb. test weight)

NOTE: All capacities are based on level full

NOTE: Used truck tires furnished by Demco will vary in quality and outward appearance. Demco will guarantee used tires to hold air for 30 days from date wagon is delivered to dealer lot and assumes no warranty or liability on used tires once removed from dealer premises.

NOTE: Units are factory setup.

COLORS AVAILABLE:



STANDARD FEATURES

- Easiest opening door in the industry
- Adjustable door opener for easy access from either side of chute
- Ergonomic tongue latch
- Reflective decals
- LED lights
- 22" hand wheel
- Large viewing windows: 12" x 24"
- More chute clearance
- Fenders - 650/750
- Cast spindle carriers
- 3-1/2" bolt in spindles
- 10 bolt hubs
- Narrow box width for better visibility
- New interior bracing for less grain splat
- 2 wheel (rear) brakes - 500 SS
- 4 wheel brakes - 650 SS/750 SS

OPTIONS

- Additional Front brakes - 500 SS
- Fenders - 500 SS
- Roll tarp
- Rear ladder kit
- Electric door opener



Adjustable Door Opener
with Larger Hand Wheel



Cast Spindle Carriers -
front and rear

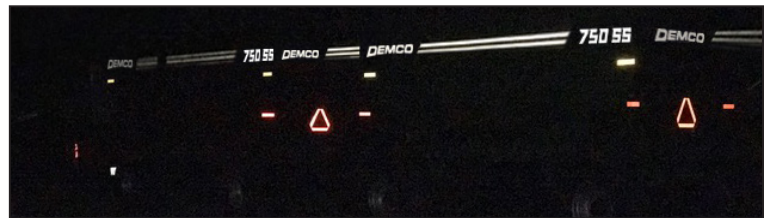

REFLECTIVE DECALS

The photo above shows the superior safety of our new, reflective decals at night!



500 SS & 650 SS

Heavy duty torsion bar suspension reduces wagon stress and improves ride and handling



750 SS

HOW TO ORDER: 1. Choose **Wagon** 2. Review **Accessories**

WAGON

w/425-65R 22.5 Used Tires

500 SS Wagon - Gray	9443190	\$30,197.00
500 SS Wagon - Red	9443161	\$30,197.00
500 SS Wagon - Green	9443162	\$30,197.00
650 SS Wagon - Gray	9443191	\$35,997.00
650 SS Wagon - Red	9443167	\$35,997.00
650 SS Wagon - Green	9443168	\$35,997.00

w/445-65R 22.5 Used Tires

500 SS Wagon - Gray	9443192	\$30,912.00
500 SS Wagon - Red	9443164	\$30,912.00
500 SS Wagon - Green	9443165	\$30,912.00
650 SS Wagon - Gray	9443193	\$36,664.00
650 SS Wagon - Red	9443170	\$36,664.00
650 SS Wagon - Green	9443171	\$36,664.00
750 SS Wagon - Gray	9443194	\$39,487.00
750 SS Wagon - Red	9443176	\$39,487.00
750 SS Wagon - Green	9443177	\$39,487.00

w/455-55R 22.5 Used Tires

750 SS Wagon - Gray	9443196	\$40,826.00
750 SS Wagon - Red	9443179	\$40,826.00
750 SS Wagon - Green	9443180	\$40,826.00

** New tires are special order - call for pricing*

FACTORY INSTALL ACCESSORIES

500 SS Additional Front Brakes	9440178	\$731.00
500 SS Fenders	9440134	\$1,411.00
500 SS Roll tarp	9440136	\$2,580.00
500 SS Rear Ladder Kit	6282	\$455.00
650 SS & 750 SS Rear Ladder Kit	6293	\$455.00
650 SS & 750 SS Roll tarp	9440138	\$2,667.00
Electric Door Opener	9440147	\$1,985.00

FIELD INSTALL ACCESSORIES

500 SS Fenders	9440135	\$1,270.00
500 SS Roll tarp	9440137	\$2,200.00
650 SS & 750 SS Roll tarp	9440139	\$2,286.00
Electric Door Opener	9440148	\$1,637.00

ALL WHEEL STEER HEADER TRANSPORTS

32' • 38' • 42' • 48' • 52'

NEW

High Speed AWS Header Transport

- ◀ DEMCO's newest Header Transport gives you the **All Wheel Steer maneuverability along with the HIGH SPEED** features of the Standard & Heavy Duty transports.
- ◀ All Header Transport features designed into 1 Header Transport
- ◀ As the Combine Headers get larger, Demco's HIGH SPEED All Wheel Steer design will check all the boxes that you are looking for in a Header Transport.
- ◀ Available in 32' - 38' - 42' - 48' - 52' lengths



STANDARD FEATURES

- 7K Torsion Flex Front & Rear Axles
- Tandem Rear Torsion Steerable Axles with 1 Brake (32' - 38' - 42')
- Tandem Rear Torsion Steerable Axles with 2 Brakes (48' - 52')
- 91" Telescoping Tongue w/ Clevis & 1" Hitch Pin
- LED Lighting w/ 7 pole RV plug
- 8 Bolt Hubs w/ ST 235/80R16 Tires
- 2 Adjustable Tie Downs
- 2 Adjustable Mounting Brackets (32' - 38')
- 4 Adjustable Mounting Brackets (42' - 48' - 52')
- GVW = 21,000 lbs
- Poly Front Fenders

OPTIONS

- 139" Telescoping Tongue
- 2 5/16 EZ Latch Coupler or 3" Pintle Ring
- Electric Brakes - Front Axle and 2nd Rear Axle
- Mounting brackets to fit all models of headers





ADJUSTABLE MOUNTING BRACKETS



Standard Bracket



L5 Bracket



Hinged Draper Bracket



L8 Bracket

HOW TO ORDER: 1. Choose Header Transports 2. Review Options

HEADER TRANSPORT

32' Header Transport	2H000391	\$18,952.00
38' Header Transport	2H000392	\$20,355.00
42' Header Transport	2H000393	\$22,341.00
48' Header Transport	2H000394	\$23,910.00
52' Header Transport	2H000371	\$24,741.00

UPGRADE OPTIONS - pricing in lieu of Standard Features

91" Telescoping Tongue w/ Ball Coupler (I.L.O. Clevis)	2H000373	\$139.00
91" Telescoping Tongue w/ Pintle Eye (I.L.O. Clevis)	2H000374	\$100.00
AWS 7K Front Axle-Brake, (48 - 52)	2H000376	\$913.00
AWS 7K Rear Axle - 2 Brake (32' - 38' - 42')	2H000396	\$658.00
AWS 7K Front Axle - Brake (32' - 38' - 42')	2H000400	\$913.00
139" Telescoping Tongue - Clevis	2H000385	\$624.00
139" Telescoping Tongue - Pintle	2H000386	\$543.00

ADDITIONAL OPTIONS

Additional Adjustable Tie Downs (Each)	5H000148	\$148.00
Standard Saddle Bracket Assembly - Right	9H000005	\$425.00
Standard Saddle Bracket Assembly - Left	9H000006	\$425.00
L5 Bracket Assembly	9H000035	\$464.00
L8 Bracket Assembly	9H000067	\$504.00
MacDon 200 Series Brackets - 32'	9H000101	\$990.00
MacDon 200 Series Brackets - 38'	9H000102	\$990.00
MacDon 200 Series Brackets - 42' - 48' - 52'	9H000100	\$990.00
JohnDeere Hinged Draper Brackets	9H000094	\$445.00
AWS Rear Fender	2H000379	\$651.00

STANDARD HEADER TRANSPORTS

20' • 24' • 28'



Two fully adjustable ratcheting straps for securing all brands of heads

STANDARD FEATURES

- 6K Torsion Flex Tricycle Front & Rear Axles
- Single Rear Torsion Flex Axle
- Axle Down Configuration (Axle Up Configuration available)
- LED Lighting w/ 7 pole RV plug
- New 225/75R15 Load Range E Import Tires
- Black Paint with Rubberized Undercoating
- 2 Adjustable Tie Downs
- 46" Telescoping Tongue w/ Clevis & 1" Hitch Pin
- 2 Standard Saddle Brackets
- GVW 11,200 lbs.

OPTIONS

- 71" Telescoping Tongue
- 2-5/16 Ball Coupler or 3" Pintle Ring
- Electric Brakes - Front and Rear
- Brackets: Standard/L5/Hinged Draper/L8
- MacDon 200 Series Brackets
- Top Rail Extender
- Fenders - Front and Rear

ADJUSTABLE MOUNTING BRACKETS



Standard Bracket



L5 Bracket



Hinged Draper Bracket



L8 Bracket

HOW TO ORDER: 1. Choose **Header Transporter** 2. Review **Options**

HEADER TRANSPORT

20' Header Transport	2H000304	\$9,526.00
24' Header Transport	2H000305	\$10,121.00
28' Header Transport	2H000306	\$11,051.00

UPGRADE OPTIONS - pricing in lieu of Standard Features

46" Telescoping Tongue w/ 2 5/16" Ball Coupler (I.L.O. Clevis)	2H000136	\$137.00
46" Telescoping Tongue w/ 3" Pintle Eye (I.L.O. Clevis)	2H000141	\$98.00
71" Telescoping Tongue w/ Clevis Hitch (I.L.O. Standard Tongue)	2H000132	\$197.00
71" Telescoping Tongue w/ 2 5/16" Ball Coupler (I.L.O. Standard Tongue)	2H000133	\$295.00
71" Telescoping Tongue w/ 3" Pintle Eye (I.L.O. Standard Tongue)	2H000135	\$249.00
Electric Brakes w/ Breakaway on Single Rear Axle	2H000331	\$644.00
Front Braking Torsion Flex Tricycle Axle (I.L.O. Standard Idler Axle)	2H000169	\$716.00

ADDITIONAL OPTIONS

Front Fender Package	5H000415	\$390.00
Rear Fender Package - Single Axle	5H000190	\$336.00
Spare Tire Mounted w/ Carrier	2H000113	\$429.00
Additional Adjustable Tie Downs (Each)	5H000148	\$148.00
Manufacture Statement of Origin	MSO	Net. \$30.00
Standard Saddle Bracket Assembly - Right	9H000005	\$425.00
Standard Saddle Bracket Assembly - Left	9H000006	\$425.00
L5 Bracket Assembly	9H000035	\$464.00
L8 Bracket Assembly	9H000067	\$504.00
JohnDeere Hinged Draper Brackets	9H000094	\$445.00
Top Rail Extender Kit - 20' - 9H000056 / 24' - 9H000057 / 28' - 9H000058		\$1,239.00

STANDARD HEADER TRANSPORTS

32' • 38' • 42'

STANDARD FEATURES

- 6K Torsion Flex Tricycle Front & Rear Axles
- Single Rear Torsion Flex Axle (32', 38')
- Tandem Rear Torsion Flex Axle (42')
- Axle Down Configuration
- 1 Rear Brake Standard on 42'
- LED Lighting w/ 7 pole RV plug
- New 225/75R15 Load Range E Import Tires
- Black Paint with Rubberized Undercoating
- 2 Adjustable Tie Downs
- 46" Telescoping Tongue w/ Clevis & 1" Hitch Pin
- 2 Adjustable Slider Brackets (32', 38')
- 4 Adjustable Slider Brackets (42')
- Single Rear Axle GVW 11,200 lbs.
- Tandem Rear Axle GVW 16,800 lbs.
- Poly Front Fenders

OPTIONS

- 71" Telescoping Tongue
- 2-5/16 Ball Coupler or 3" Pintle Ring
- Electric Brakes - Front and Rear
- Rear Fenders
- Tandem Rear Torsion Axles(32' - 38')
- Brackets: Standard/L5/Hinged Draper/L8
- MacDon 200 Series Brackets
- Top Rail Extender



Torsion flex axles provide a smooth ride

HOW TO ORDER: 1. Choose **Header Transporter** 2. Review **Options**

HEADER TRANSPORT

32' Header Transport	2H000307	\$12,369.00
38' Header Transport	2H000308	\$13,821.00
42' Header Transport	2H000309	\$19,474.00

UPGRADE OPTIONS - pricing in lieu of Standard Features

46" Telescoping Tongue w/ 2 5/16" Ball Coupler (I.L.O. Clevis)	2H000136	\$137.00
46" Telescoping Tongue w/ 3" Pintle Eye (I.L.O. Clevis)	2H000141	\$98.00
71" Telescoping Tongue w/ Clevis Hitch (I.L.O. Standard Tongue)	2H000132	\$197.00
71" Telescoping Tongue w/ 2 5/16" Ball Coupler (I.L.O. Standard Tongue)	2H000133	\$295.00
71" Telescoping Tongue w/ 3" Pintle Eye (I.L.O. Standard Tongue)	2H000135	\$249.00
Electric Brakes w/Breakaway on Single Rear Axle	2H000162	\$644.00
Rear Tandem Suspension w/o Brakes (2 Idler Axles)	2H000165	\$2,127.00
Rear Tandem Suspension w/ Brakes (1 Idler, 1 Electric Brake Axles)	2H000166	\$2,771.00
Rear Tandem Suspension w/ Brakes (2 Electric Brake Axles)	2H000164	\$3,256.00
Front Braking Torsion Flex Tricycle Axle (I.L.O. Standard Idler Axle)	2H000170	\$716.00
42' Electric Brakes on Second Rear Axle	2H000167	\$485.00

ADDITIONAL OPTIONS

Rear Fender Package - Single Axle	5H000190		\$336.00
Rear Fender Package - Tandem Axle	5H000190	\$336.00/ea x 2=	\$672.00
Spare Tire Mounted w/Carrier	2H000113		\$429.00
Additional Adjustable Tie Downs (Each)	5H000148		\$148.00
Manufacture Statement of Origin (MSO)	MSO		Net. \$30.00
Standard Saddle Bracket Assembly - Right	9H000005		\$425.00
Standard Saddle Bracket Assembly - Left	9H000006		\$425.00
L5 Bracket Assembly	9H000035		\$464.00
L8 Bracket Assembly	9H000067		\$504.00
JohnDeere Hinged Draper Brackets	9H000094		\$445.00
MacDon 200 Series Brackets - 32'	9H000101		\$990.00
MacDon 200 Series Brackets - 38'	9H000102		\$990.00
MacDon 200 Series Brackets - 42'	9H000100		\$990.00
Top Rail Extender Kit - 32' - 9H000059 / 38' - 9H000061			\$1,859.00
Top Rail Extender Kit - 42'	9H000062		\$2,469.00

STANDARD HEADER TRANSPORTS

48' • 52'



*Torsion flex axles provide
a smooth ride*

STANDARD FEATURES

- 7K Torsion Flex Tricycle Front & Rear Axles
- Tandem Rear Torsion Flex Axle with 2 Brakes
- Axle Down Configuration
- LED Lighting w/ 7 pole RV plug
- New 16" ST 235/80R16 Load Range E Tires
- 8 Bolt Hubs
- Black Paint with Rubberized Undercoating
- 2 Adjustable Tie Downs
- 46" Telescoping Tongue w/ Clevis & 1" Hitch Pin
- 4 Adjustable Slider Brackets
- Tandem Rear Axle GVW 20,000 lbs.
- Poly Front Fenders

OPTIONS

- 71" Telescoping Tongue
- 2-5/16 Ball Coupler or 3" Pintle Ring
- Electric Brakes - Front Axle
- Rear Fenders
- Brackets: Standard/L5/Hinged Draper/L8
- MacDon 200 Series Brackets
- Top Rail Extender

HOW TO ORDER: 1. Choose **Header Transporter** 2. Review **Options**

HEADER TRANSPORT

48' Header Transport	2H000323	\$21,824.00
52' Header Transport	2H000327	\$24,095.00

UPGRADE OPTIONS - pricing in lieu of Standard Features

46" Telescoping Tongue w/ 2 5/16" Ball Coupler (I.L.O. Clevis)	2H000136	\$137.00
46" Telescoping Tongue w/ 3" Pintle Eye (I.L.O. Clevis)	2H000141	\$98.00
71" Telescoping Tongue w/ Clevis Hitch (I.L.O. Standard Tongue)	2H000132	\$197.00
71" Telescoping Tongue w/ 2 5/16" Ball Coupler (I.L.O. Standard Tongue)	2H000133	\$295.00
71" Telescoping Tongue w/ 3" Pintle Eye (I.L.O. Standard Tongue)	2H000135	\$249.00
Front Braking Torsion Flex Tricycle Axle (I.L.O. Standard Idler Axle)	2H000170	\$716.00

ADDITIONAL OPTIONS

Rear Fender Package - Tandem Axle	5H000200	\$332.00/ea x 2=	\$664.00
Spare Tire Mounted w/Carrier	2H000212		\$484.00
Additional Adjustable Tie Downs (Each)	5H000148		\$148.00
Manufacture Statement of Origin (MSO)	MSO		Net \$30.00
Standard Saddle Bracket Assembly - Right	9H000005		\$425.00
Standard Saddle Bracket Assembly - Left	9H000006		\$425.00
L5 Bracket Assembly	9H000035		\$464.00
L8 Bracket Assembly	9H000067		\$504.00
MacDon 200 Series Brackets	9H000100		\$990.00
JohnDeere Hinged Draper Brackets	9H000094		\$445.00
Shelbourne Brackets, Qty 2 (Requires Draper Brackets)	9H000070		\$825.00
Top Rail Extender Kit - 48'	9H000063		\$2,499.00
Top Rail Extender Kit - 52'	9H000091		\$2,622.00

HEAVY DUTY HEADER TRANSPORTS

32' • 38' • 42'



STANDARD FEATURES

- 7K Torsion Flex Tricycle Front & Rear Axles
- Axle Down Configuration
- 1 Rear Brake
- LED Lighting w/ 7 pole RV plug
- New 16" ST 235/80R16 Load Range E Tires on 8 Bolt Hub
- Black Paint with Rubberized Undercoating
- Manufacturer's Statement of Origin (MSO)
- Front and Rear Fenders
- Horizontal Rear Bumper
- 2 Adjustable Tie Downs
- 46" Telescoping Tongue w/ 2-5/16" Ball Hitch
- 2 Adjustable Slider Brackets(32, 38)
- 4 Adjustable Slider Brackets (42)
- GVW 20,000 lbs.
- Additional Options Available

OPTIONS

- 71" Telescoping Tongue
- 3" Pintle Ring
- Electric Brakes - Front and Rear
- Brackets: Standard / L5 / Hinged Draper / L8
- MacDon 200 Series Brackets
- Cotton Header Brackets
- Top Rail Extender

Standard telescoping tongue and eZ-Latch 2 5/16" ball coupler and safety chains



Optional top rail extender kit



Cotton Head brackets and extender kits available. Contact your Demco Rep for part numbers and pricing.

HOW TO ORDER: 1. Choose **Header Transporter** 2. Review **Options**

HEADER TRANSPORT

32' Heavy Duty Header Transport	2H000310	\$18,939.00
38' Heavy Duty Header Transport	2H000311	\$20,718.00
42' Heavy Duty Header Transport	2H000312	\$23,894.00

UPGRADE OPTIONS - pricing in lieu of Standard Features

46" Telescoping Tongue w/ 3" Pintle Eye (I.L.O. Ball)	2H000141	\$98.00
71" Telescoping Tongue w/ 2 5/16" Ball Coupler (I.L.O. Standard Tongue)	2H000133	\$295.00
71" Telescoping Tongue w/ 3" Pintle Eye (I.L.O. Standard Tongue)	2H000135	\$249.00
Electric Brakes on Second Rear Axle	2H000207	\$485.00
Front Braking Torsion Flex Tricycle Axle (I.L.O. Standard Idler Axle)	2H000234	\$913.00

ADDITIONAL OPTIONS

Spare Tire Mounted w/ Carrier -HD Model	2H000212	\$484.00
Additional Adjustable Tie Downs (Each)	5H000148	\$148.00
Standard Saddle Bracket Assembly - Right	9H000005	\$425.00
Standard Saddle Bracket Assembly - Left	9H000006	\$425.00
L5 Bracket Assembly	9H000035	\$464.00
L8 Bracket Assembly	9H000067	\$504.00
MacDon 200 Series Brackets	9H000100	\$990.00
JohnDeere Hinged Draper Brackets	9H000094	\$445.00
Top Rail Extender Kit (HT32 & HT38) - 32' - 9H000059 / 38' - 9H000061		\$1,859.00
Top Rail Extender Kit (HT42) - 42' - 9H000062		\$2,469.00
Shelbourne Brackets Qty 2 (Available for 32', 38' & 42' - Requires Draper Brackets)	9H000070	\$825.00

HEAVY DUTY HEADER TRANSPORTS

48' • 52'



Standard telescoping tongue and eZ-Latch 2 5/16" ball coupler and safety chains

STANDARD FEATURES

- 7K Torsion Flex Tricycle Front & Rear Axles
- Axle Down Configuration
- 2 Rear Brakes Standard
- LED Lighting w/ 7 pole RV plug
- New 16" ST 235/80R16 Load Range E Tires on 8 Bolt Hub
- Black Paint with Rubberized Undercoating
- Manufacturer's Statement of Origin (MSO)
- Front and Rear Fenders
- Horizontal Rear Bumper
- 2 Adjustable Tie Downs
- 46" Telescoping Tongue w/ 2-5/16" Ball Hitch
- 4 Adjustable Slider Brackets
- GVW 20,000 lbs.
- Additional Options Available

OPTIONS

- 71" Telescoping Tongue
- 3" Pintle Ring
- Electric Brakes - Front and Rear
- Brackets: Standard/L5/Hinged Draper/L8
- MacDon 200 Series Brackets
- Cotton Header Brackets
- Top Rail Extender



Optional top rail extender kit



HOW TO ORDER: 1. Choose **Header Transporter** 2. Review **Options**

HEADER TRANSPORT

48' Heavy Duty Header Transport	2H000313	\$27,309.00
52' Heavy Duty Header Transport	2H000328	\$30,120.00

UPGRADE OPTIONS - pricing in lieu of Standard Features

46" Telescoping Tongue w/ 3" Pintle Eye (I.L.O. Ball)	2H000141	\$98.00
71" Telescoping Tongue w/ 2 5/16" Ball Coupler (I.L.O. Standard Tongue)	2H000133	\$295.00
71" Telescoping Tongue w/ 3" Pintle Eye (I.L.O. Standard Tongue)	2H000135	\$249.00
Front Braking Torsion Flex Tricycle Axle (I.L.O. Standard Idler Axle)	2H000347	\$913.00

ADDITIONAL OPTIONS

Spare Tire Mounted w/ Carrier -HD Model	2H000212	\$484.00
Additional Adjustable Tie Downs (Each)	5H000148	\$148.00
Standard Saddle Bracket Assembly - Right	9H000005	\$425.00
Standard Saddle Bracket Assembly - Left	9H000006	\$425.00
L5 Bracket Assembly	9H000035	\$464.00
L8 Bracket Assembly	9H000067	\$504.00
MacDon 200 Series Brackets	9H000100	\$990.00
JohnDeere Hinged Draper Brackets	9H000094	\$445.00
Top Rail Extender Kit (HT48)	9H000063	\$2,499.00
Top Rail Extender Kit (HT52)	9H000091	\$2,622.00
Shelbourne Brackets Qty 2 (Available for 32', 38' & 42' - Requires Draper Brackets)	9H000070	\$825.00

Don't settle for less - Demco Tip-ups will help add capacity to your existing OEM extension.

STANDARD FEATURES

- Easy installation
- Durable and sturdy design
- Convenient fold down for storage and transport
- Unmatched quality
- Attractive appearance
- Additional 60 bushels: 8" tall
- Additional 120 bushels: 14" tall



JOHN DEERE

HOW TO ORDER: 1. Choose **Correct Part Number** 2. Determine **Extension Size** 3. Review **Accessories**

COMBINE MODEL	ADDED BUSHELS:	YEAR	MODEL	PART NO.	PRICE
9660/9670/9760/9770/9860/9870 STS	300 + 60 bu.		M60	9E000018	\$1,939.00
9660/9670/9760/9770/9860/9870 STS	300 + 120 bu.		M120	9E000021	\$2,821.00
S660/S670	300 + 60 bu.	2012-2014*	MS67	9E000041	\$2,021.00
S660/S670	300 + 120 bu.	2012-2014*	MS120	9E000036	\$2,913.00
S660/S670/S760/S770	300 + 60 bu.	2014*-2023	MS67SQ	9E000047	\$2,217.00
S660/S670/S760/S770	300 + 120 bu.	2014*-2023	MS120 SQ	9421046	\$3,099.00
S680/S690	400 + 60 bu.	2012-2014*	MS60	9E000037	\$1,939.00
S680/S690/S780/S790	400 + 60 bu.	2014*-2023	MS60SQ	9E000043	\$1,939.00

** Contact a Demco Representative when ordering a Tip-Up kit for a 2014 JD S Series Combine*



CASE-IH AND NEW HOLLAND

HOW TO ORDER: 1. Choose **Correct Part Number** 2. Determine **Extension Size** 3. Review **Accessories**

CASE IH COMBINE MODEL	ADDED BUSHELS:	HEIGHT	MODEL	PART NO.	PRICE
5088/5130 /5140/5150/6150/7150	24" + 100 bu.	14" Tall	MX250	9E000025	\$2,821.00
5088/5130/6088/6130/7088/7130/ 5140/6140/7140/ 5150/6150/7150	32" + 100 bu.	14" Tall	MX300	9E000024	\$2,821.00
7010/7120/7230/7240	24" + 100 bu.	14" Tall	MZ315	9E000026	\$2,821.00
7230/8010/8120/8230/9120/9230	27" + 100 bu.	14" Tall	MZ350	9E000027	\$2,821.00
7240/ 8240/9240/7250/8250/9250	33" + 65 bu.	8" Tall	MX410	9E000048	\$2,821.00
NEW HOLLAND COMBINE MODEL					
CR940/CR960/CR9040/CR9060/CR6090/ CR7090/CR8080/ CR6.80, CR6.90, CR7.90	24" + 100 bu.	14" Tall	MZ315	9E000026	\$2,821.00
CR970/CR980/ CR9070/CR9080/CR9090	27" + 100 bu.	14" Tall	MZ350	9E000027	\$2,821.00
CR8090/CR9090/CR8.90/CR9.90	33" + 65 bu.	8" Tall	MZ410	9E000045	\$2,821.00

NOTE: All capacities are based on level full

DEMCO TIP UP KITS - POWER FOLD

Demco Tip-Ups for power fold combines allow you to gain more capacity while using the OEM power fold extension.



HOW TO ORDER: 1. Choose **Correct Part Number** 2. Determine **Extension Size** 3. Review **Accessories**

COMBINE MODEL	ADDED BUSHELS:	YEAR	HEIGHT	MODEL	PART NO.	PRICE
JOHN DEERE FACTORY POWER FOLD EXTENSION						
S660/S670/S760/S770	300 + 150 bu.		14" Tall	MS150E	9421044	\$1,817.00
S680/S690/S780/S790	400 + 75 bu.	2012-2023	7" Tall	MS75E	9421049	\$2,552.00
S780/S790	400 + 100 bu.	2023 & Newer	10" Tall		9421068	\$2,588.00
<i>* Aftermarket hydraulic cylinder included: 9421049 and 9421068</i>						
X9-1000	420 + 180 bu.		8" Tall		9E000063	\$1,968.00
X9-1100	460 + 140 bu.		8" Tall		9E000064	\$1,236.00
CASE IH FACTORY POWER FOLD EXTENSION						
7120, 7230, 7240, 7250 (24" panels)	315. + 75 bu.		13" Tall	MZ315P	9E000050	\$3,162.00
Handrail Options at no charge:						
<i>R5E000163LO -Required for CIH 7120</i>						
<i>R5E000193LO Required for CIH 7240</i>						
<i>OEM Handrail will work on CIH 7230</i>						
8120, 9120, 7230, 8230, 9230 (27" panels)	350 + 75 bu.		13" Tall	MZ350P	9E000051	\$3,319.00
7240, 8240, 9240, 7250, 8250, 9250 (34" rear panels) HR Optional	410 + 65 bu.		6" Tall	MX410P	9E000054	\$2,475.00
CASE IH FACTORY POWER FOLD COVER EXTENSION						
7120, 7230, 7240, 7250 (24" front/rear panels)	315 + 75 bu.		13" Tall	MZ315C	9E000052	\$2,984.00
Handrail Options at no charge:						
<i>R5E000163LO -Required for CIH 7120</i>						
<i>R5E000193LO Required for CIH 7240</i>						
<i>OEM Handrail will work on CIH 7230</i>						
8120, 9120, 7230, 8230, 9230 (27" panels)	350 + 75 bu.		13" Tall	MZ350C	9E000053	\$3,304.00
7240, 8240, 9240, 7250, 8250, 9250 (34" rear panels) HR Optional	410 + 65 bu.		6" Tall	MX410C	9E000055	\$2,316.00
CASE NEW HOLLAND FACTORY POWER FOLD EXTENSION						
CR6.80, CR6.90, CR7.90	315 + 75 bu.		13" Tall	MZ315P	9E000050	\$3,162.00
CASE NEW HOLLAND FACTORY POWER FOLD COVER EXTENSION						
CR8.90, CR9.90, CR10.90	410 + 65 bu.		6" Tall	CNH MZ410C	9E000056	\$2,316.00

NOTE: All capacities are based on level full

DEMCO XL EXTENSIONS

Save time and increase productivity while harvesting with the Demco **XL** Extension/Tip-up

STANDARD FEATURES

- Convenient fold down for storage or transport
- Durable and sturdy design
- Total capacity 560 bu
- Height above cab approx. 33"
- Overall height approx. 15'-6"

Largest Extension/Tip-up on the market!

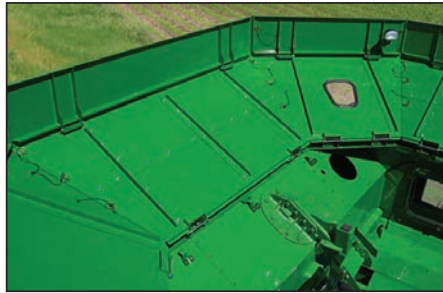

HOW TO ORDER: 1. Choose **Correct Part Number** 2. Determine **Extension Size** 3. Review **Accessories**

JOHN DEERE

JD-XL (S680/S690/S780/S790)

9E000040

\$7,213.00

CASE IH - CNH

Case IH 8010, 8120, 9120, 8230, 9230, 8240, 9240, 8250, 9250
CNH CR980, CR9080, CR9090, CR8080, CR8090, CR8.90, CR9.90

9E000042

\$7,209.00

Handrail Options at no charge:

Case IH 8010

Case IH 8240/9240/8250/9250

Case IH 8120/9120/8230/9230

CNH CR8080/CR9080/CR6090/7090/8090/9090

CR6.80/6.90/7.90/8.90/9.90/10.90

R5E000164L0

R5E000193L0

R5E000163L0

R5E000233L0

NOTE: All capacities are based on level full



Demco Grain Tank Tip-ups are vertical panels that add to either the Demco Grain Tank Extension or to the factory OEM extension for added bushel capacity

Demco Grain Tank Extension *replaces* the factory extension for added bushel capacity and lower clearance of the combine

DEMCO EXTENSIONS

Demco Grain Tank Extensions allow you to add more capacity by *replacing* the factory extension



STANDARD FEATURES

- 3" formed channel frame provides unmatched strength and stability
- Rear entry step for added safety and convenience on Generation II extensions
- Corner caps on all Generation II extensions to prevent leakage
- Quick and easy fold down of extension for lower transport height

JOHN DEERE

ADDED BUSHEL CAPACITY PER EXTENSION

MODEL	ORIGINAL CAPACITY	EXTENSION	TIP-UP	TOTAL LEVEL CAPACITY
9400W, 9410W, 9450W	182 bu.	9E000003 - 300 bu.	9E000004 - 50 bu.	350
9500W, 9510W, 9550W	204 bu.	9E000003 - 300 bu.	9E000004 - 50 bu.	350
9550W, 9560W (2002 and Newer)	204 bu.	9E000008 - 300 bu.	9E000004 - 50 bu.	350
9600W, 9610W, 9650W	240 bu.	9E000003 - 350 bu.	9E000004 - 40 bu.	390
9650W, 9660W (2002 and Newer)	240 bu.	9E000009 - 350 bu.	9E000010 - 40 bu.	390
STS Series	300 bu.	9E000001 - 375 bu.	9E000002 - 60 bu.	435
S Series with Std. Rate Unload	250 bu.	9E000033 - 375 bu.	9E000034 - 60 bu.	435
S Series with High Rate Unload	300 bu.	9E000032 - 375 bu.	9E000002 - 60 bu.	435

HOW TO ORDER: 1. Choose **Correct Part Number** 2. Determine **Extension Size** 3. Review **Accessories**

JD 9400, 9410, 9450W (Prior to Serial # 695101) - Extension	9E000003	\$2,814.00
JD 9450W (Serial # 695101 and up) - Extension	9E000008	\$2,865.00
JD 9500, 9510, 9550W (Prior to Serial # 695201) - Extension	9E000003	\$2,814.00
JD 9550, 9560W (Serial # 695201 and up) - Extension	9E000008	\$2,865.00
JD 9600, 9610, 9650W (Prior to Serial # 695301) - Extension	9E000003	\$2,814.00
JD Walker 9400-9500-9600 Series - Tip-up	9E000004	\$1,093.00
JD 9650, 9660W (Serial # 695301 and up) - Extension	9E000009	\$2,865.00
JD 9650, 9660W (Serial # 695301 and up) - Tip-up	9E000010	\$1,093.00
JD 96/9750, 96/97/9860, 96/97/9870 STS - Extension	9E000001	\$3,355.00
JD 96/9750, 96/97/9860, 96/97/9870 STS - Tip-up	9E000002	\$1,200.00
*JD STS (Required for High Rate Unloading Auger) - Mounting Kit	9E000017	\$460.00
*JD STS (Additional Corner Filler Strips, NOT Required) - Mounting Kit	9E000031	\$131.00
JD S Series with HIGH RATE UNLOADING AUGER - Extension + Mounting Kit	9E000032	\$3,840.00
JD S Series (Use with part # 9E000032) - Tip-up	9E000002	\$1,200.00
JD S Series with STANDARD RATE UNLOADING AUGER - Extension	9E000033	\$3,416.00
JD S Series (Use with part # 9E000033) - Tip-up	9E000034	\$1,222.00

NOTE: All capacities are based on level full

STANDARD FEATURES

- 3" formed channel frame provides unmatched strength and stability
- Rear entry step for added safety and convenience on Generation II extensions
- Corner caps on all Generation II extensions to prevent leakage
- Quick and easy fold down of extension for lower transport height



CASE-IH

ADDED BUSHEL CAPACITY PER EXTENSION

MODEL	ORIGINAL CAPACITY	EXTENSION	TIP-UP	TOTAL LEVEL CAPACITY
7010, 7120, 7230, 7240, 7250	315 bu.	9E000015 - 365 bu.	9E000016 - 70 bu.	435
All 8000/9000 Series	330 bu.	9E000015 - 365 bu.	9E000016 - 70 bu.	435
60-66 SERIES BLACK	185 bu.	9E000011 - 290 bu.	9E000012 - 45 bu.	335
80-77-88 SERIES BLACK	210 bu.	9E000011 - 305 bu.	9E000012 - 45 bu.	350
LEGACY SERIES	300 bu.	9E000057 - 300 bu.	9E000058 - 75 bu.	375

NOTE: Demco Extension will not fit a CIH 2588

HOW TO ORDER: 1. Choose **Correct Model Number** 2. Determine **Extension Size** 3. Review **Accessories**

CIH 60, 80, 66, 77, 88 Series Black (60/66/reqs riser) - Extension	9E000011	\$3,050.00
CIH 60, 80, 66, 77, 88 Series Black - Tip-up	9E000012	\$1,093.00
CIH 60/66 - Riser Kit	9E000007	\$399.00
CIH 7010/8010, 7120/8120/9120, 7230/8230/9230 Black - Extension	9E000015	\$3,355.00
CIH 7010/8010, 7120/8120/9120, 7230/8230/9230 Black - Tip-up	9E000016	\$1,200.00
CIH Legacy Series - Extension	9E000057	\$3,355.00
CIH Legacy Series - Tip-up	9E000058	\$1,200.00

NEW HOLLAND

ADDED BUSHEL CAPACITY PER EXTENSION

MODEL	ORIGINAL CAPACITY	EXTENSION	TIP-UP	TOTAL LEVEL CAPACITY
CR920	205 bu.	9E000015 - 315 bu.	9E000016 - 70	385
CR940, 9040	255 bu.	9E000015 - 365 bu.	9E000016 - 70	435
CR960, 9060	300 bu.	9E000015 - 365 bu.	9E000016 - 70	435
CR970, 9070	330 bu.	9E000015 - 365 bu.	9E000016 - 70	435
CR6090, 7090, 8080	315 bu.	9E000015 - 365 bu.	9E000016 - 70	435
CR9080, 8090, 9090	350 bu.	9E000015 - 365 bu.	9E000016 - 70	435

HOW TO ORDER: 1. Choose **Correct Model Number** 2. Determine **Extension Size** 3. Review **Accessories**

NH CR920, 940, 960, 970, 9040/60/70/80, 60/70/80/9090, 8080 - Extension	9E000015	\$3,355.00
NH CR920, 940, 960, 970, 9040/60/70/80, 60/70/80/9090, 8080 - Tip-up	9E000016	\$1,200.00

NOTE: All capacities are based on level full

AUGERS AND EXTENDERS™

BIN FILL AUGER

- Available to fit most makes and models of combines
- Reduces auger flighting wear, relieves belts, pulleys, clutches, chains and gear boxes
- Set screws allow for infinite adjustment to maximize grain holding capacity
- Quick release pivot to lower to transport position in seconds
- Mounting brackets attach easily to your grain tank



Bin Fill Auger (does NOT include hoses!)	9A000013	\$2,030.00
<i>Please note combine size for proper length of support pipe</i>	5A000013	N/C
BFA Auger Extender 2010 (adds 16" in height of auger)	9A000051	\$183.00
Flow Control Valve (w/ built in relief valve)	1AKFADD0000	\$321.00
Check Valve (required on CIH combine w/ hydraulic reverser)	1AKGANGANGO	\$118.00
Flat Face Hydraulic Fitting Kit	97961000	\$61.00

SPOUT RE-DIRECT KIT

- Spout mounts on to factory spout and directs the grain downward
- Ideal for small grains, swathing, short header, windy conditions and low grain truck or wagon applications as well



Case and New Holland	9A000058	\$393.00
John Deere - 17" High Capacity	9A000069	\$725.00

COMBINE UNLOADING AUGER EXTENDER

The Extender is a Trade Mark of Stewart Steel Inc. and is manufactured in Canada by Stewart Steel Inc.

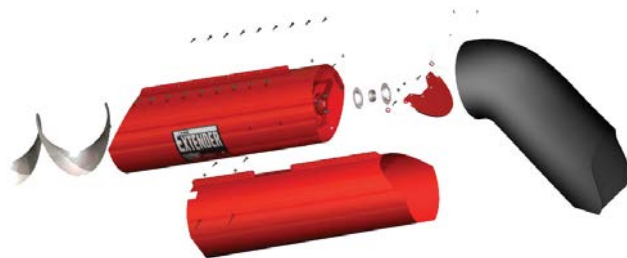

PART NUMBER	COMBINE MODELS	LENGTH	PRICE
CASE AXIAL FLOW 1440-2588			
9A000017	1440, 1460, 1480, 1640, 1660, 1680, 1644, 1666, 1688, 2144, 2166, 2188, 2344, 2366, 2388, 2577, 2588	36"	\$1,853.00
CASE (CIH) 2004-2011			
9A000023	7010 & 8010 from 2003-2006 Black 14" Auger	36"	\$1,853.00
9A000043	5088, 6088, 7088, 7120, 8120, 9120, 7230, 8230, 9230, Red w/14" Auger	36"	\$1,853.00
R1A000034	7010 & 8010 from 2007-2008 Red Auger	36"	\$1,930.00
R1A000033	7010 & 8010 from 2007-2008 Black Auger	36"	\$1,930.00
9A000056	8230, 9230 w/High Capacity Unloading 16" Auger	24"	\$2,003.00
9A000070	CIH w/ High Capacity and Actuator Spout - Red	24"	\$6,075.00
9A000071	CIH w/ High Capacity and Actuator Spout - Black	24"	\$6,075.00
NEW HOLLAND YELLOW			
9A000026	TR87, TR88, TR89, TR97, TR98, TR99, TX66, TX68	24"	\$2,077.00
NEW HOLLAND CNH			
9A000023	CR840, CR940, CR960, CR970, CX840, CX860 2003-2006 CR9040, CR9060, CR9070, CR9080, CR9090, CX9040, CX9060 2009-2014	36"	\$1,853.00
R1A000033	CR840, CR940, CR960, CR970, CX840, CX860 for 2007-2008		\$1,930.00
9A000066	9090, 9080 w/High Capacity Unloading 16" Auger	24"	\$1,866.00
JOHN DEERE			
9A000018	6620, 7720, 8820, 9400, 9500, 9600, CTS, 9510, 9610, 9550, 9650, 9750 w/13" Auger	36"	\$1,780.00
9A000064	9560, 9660, 9760, 9570, 9670, T670, S-Series w/14" Auger	28"	\$2,532.00
9A000034*	9760, 9860, 9770, 9870, S-Series w/17" Auger	36"	\$3,116.00
* Not recommended if combine is equipped w/ folding auger			
MASSEY			
9A000020	All Massey Rotarys up to 9790 - SPECIAL ORDER	36"	\$2,077.00
9A000044	9520, 9540, 9560, 9695, 9795, 9895 w/15" Auger	42"	\$3,264.00
9A000057	9520, 9540, 9560 w/16" Auger	42"	\$2,881.00
9A000065	9520, 9540, 9560 w/15" Auger - Newer Models	42"	\$2,997.00
GLEANER			
9A000024	Series L, N to R w/12" Auger - SPECIAL ORDER	24"	\$2,077.00
9A000030	Series N to 66, R76, S67, S77, S96, S97, S98 w/14" Auger	24"	\$1,781.00
9A000045	A65, A75, A85, A66, A76, A86 w/15" Auger - SPECIAL ORDER	42"	\$2,997.00
CATERPILLAR			
9A000020	Challenger Models w/12" Auger - SPECIAL ORDER	36"	\$2,077.00

SPECIAL INFORMATION

PRICES & SPECIFICATIONS

All prices and specifications are subject to change without notice. All shipments are billed at price prevailing at time of shipments. ALL PRICES F.O.B. BOYDEN OR SPENCER, IOWA OR AS DESIGNATED IN THIS CATALOG.

TERMS

Customers desiring credit must have good rating or furnish satisfactory reference before shipment will be made, otherwise all orders will be shipped C.O.D. No cash discounts allowed with C.O.D. shipments.

ORDERING

Prospective customers requesting open account status will be required to complete a Demco credit application. If open terms cannot be approved, other means of payment will be considered. Please furnish a completed Demco credit application with your first order.

SHIPMENTS

Our merchandise is carefully packed and thoroughly inspected before leaving our factory. Responsibility for its safe delivery is assumed by the carrier upon acceptance of the shipment. Claims for loss or damage sustained in transit must therefore be made upon the delivering carrier as follows:

CONCEALED LOSS OR DAMAGE - Concealed loss or damage means loss or damage which does not become apparent until the merchandise has been unpacked. The contents may be damaged in transit due to rough handling even though the carton may not show external damage. When the damage is discovered upon unpacking, make a written request for inspection by the carrier's agent within 15 days of the delivery date. Then file a claim with the carrier, since such damage is the carrier's responsibility.

VISIBLE LOSS OR DAMAGE - Any external evidence of loss or damage must be noted on the freight bill or express receipt, and signed by the carrier's agent. Failure to adequately describe such external evidence of loss or damage may result in the carrier refusing to honor a damage claim. The form required to file a claim will be supplied by the carrier.

SHIPPING ERRORS

Shipping errors resulting in shortages or goods ordered incorrectly by the customer, must be reported to Demco Mfg. within 10 days after receipt of merchandise.

PICK UP ORDERS

All orders picked up and signed for by the customer or customer's agent at the Boyden or Spencer, Iowa plants are considered complete as signed. Customer will receive a copy of signed order at time of loading.

PARCEL POST, U.P.S., FEDERAL EXPRESS & FREIGHT

Due to the special packing and handling on Parcel Post and United Parcel shipments, a combined shipping and handling fee will be charged on each carton. Weight limitations are as follows:

Parcel Post = 70 lbs.

UPS = 150 lbs.

Federal Express = 150 lbs. - per carton.

A pallet charge is added on all freight orders.

RETURNS

NO GOODS ARE TO BE RETURNED WITHOUT A RETURNED GOODS AUTHORIZATION NUMBER AND INVOICE NUMBER. When your order has been filled correctly, the concerned party returning goods must in all cases pay freight, the cost of handling and a 25% restocking charge. All goods to be returned are to be in first class condition. Additional charges will be made for goods returned in other than first class condition.

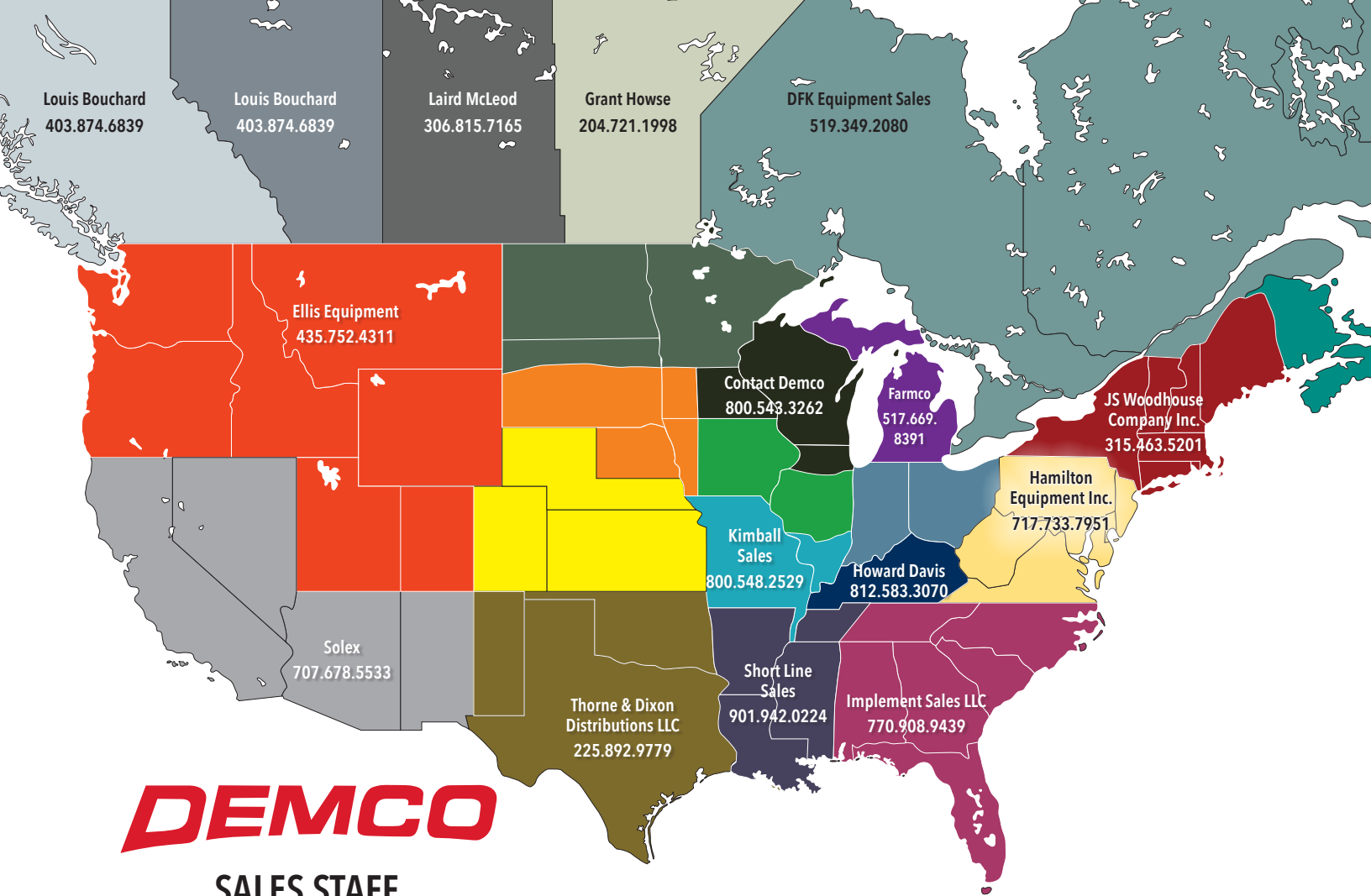

Chris Currans

(515) 708-1147
chris.currans@demco-products.com



Jordan Fulsebakke

(701) 970-9611
jordan.fulsebakke@demco-products.com



Mike Niska

(517) 204-3887
mike.niska@demco-products.com



Brian Tonniges

(308) 390-1400
brian.tonniges@demco-products.com



Derrik Netten

(319) 415-9790
derrik.netten@demco-products.com

