

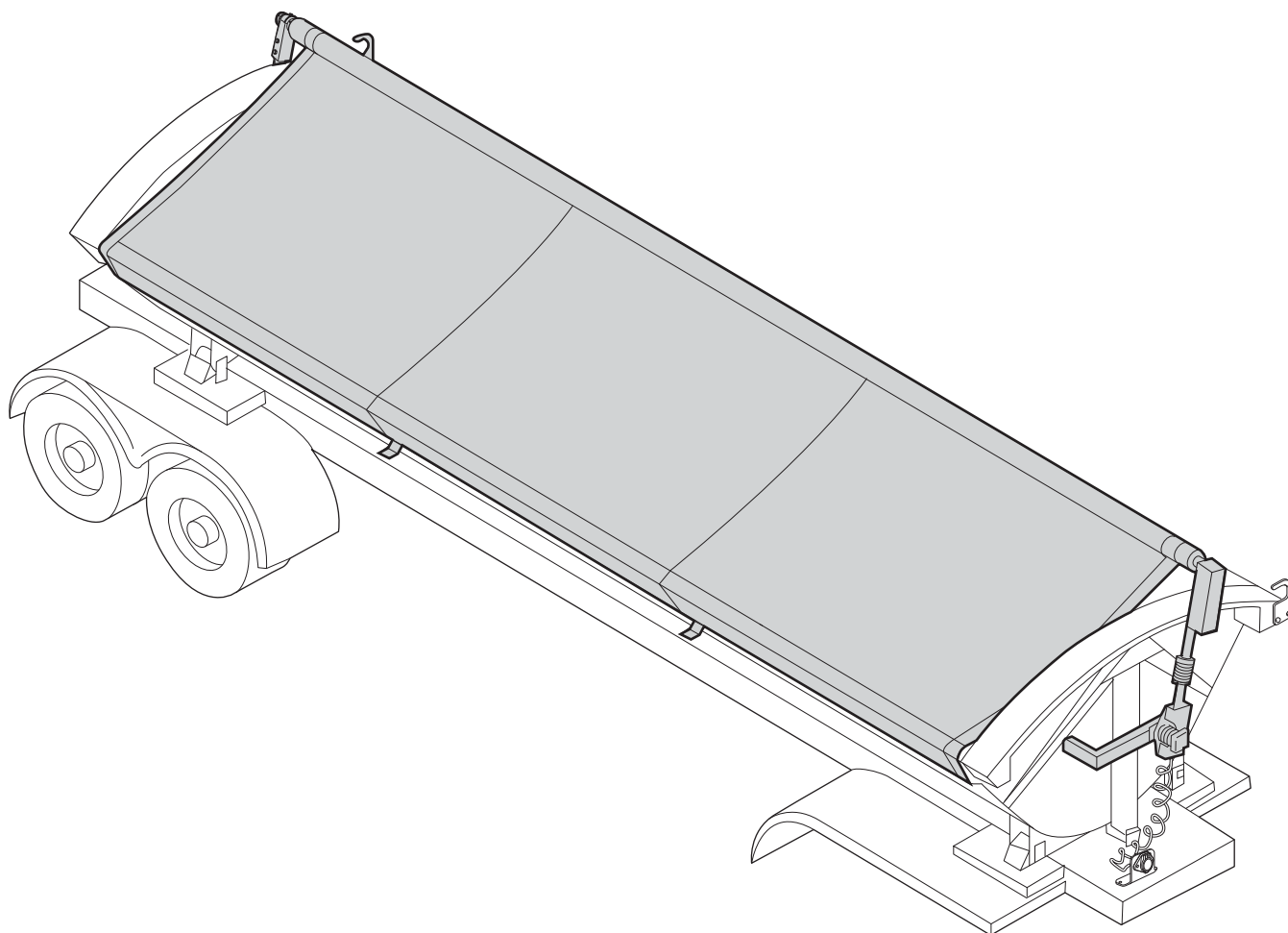

Serving the Truck & Trailer Industry
Since 1944



Side Kick 2

Installation Instructions & Parts Lists

Attention Dealers: Please give this owners manual to the customer when the product is delivered.

Call 800-535-9545 | www.aeroindustries.com

Indianapolis, IN | Omaha, NE | Streetsboro OH

Installation Instructions Directory

Item	Step	Page
Explanation of Safety Message		3-4
Preparation and Tools Required		4
Introduction		5
Install Quick-Release Mounting Plate (If Required)	1	5
Install Swing-Arm Mounting Bracket (Optional)	2	6
Install Spring Mount Post, Roller Plate, Spring, and Spring Stop	3	7
Install Swing-Arms Assemblies	4	8-9
Prepare Tarp Assembly	5	10-11
Install Tarp Assembly	6	11-13
Place Labels	7	14
PowerLockt™ Semi-trailer Truck Wiring	8a	15
PowerLockt™ Semi-trailer Wiring	8b	16
PowerLockt™ Optional Remote Wiring	8c	16
PowerLockt™ Alternate Remote Wiring	8c	16
Installation Adjustments	9	18
Spring Adjustment	10	19-20

Operation and Maintenance Directory

Item	Page
Operation and Maintenance	21-22
Power Loss Repair Bulletin	23

Parts List Directory

Item	Page
Parts Break Down	24
Spring Mount Assemblies	25
Roller Plate Assembly	26
Front Swing-Arm	27
Drive Box Unit Assembled	28
Rear Swing Arm	29
Electrical Hardware	30
Hardware and Optional Swing Arm Mounting	31

Important Safety Information

Explanation of Signal Words

- ⚠ WARNING:** Indicates a hazardous situation which, if not avoided could result in death or serious injury.
- ⚠ CAUTION:** Indicates a hazardous situation which, if not avoided could result in minor or moderate injury.

General Safety Messages

- ⚠ WARNING:** Read this entire manual and all safety messages before installing and operating this product.
- ⚠ WARNING:** Always wear safety glasses during installation and maintenance.
- ⚠ WARNING:** Keep all clothing clear of moving parts.
- ⚠ WARNING:** Keep everyone clear of the area.

Safety Messages related to the Installation of Side Kick 2™

- ⚠ CAUTION:** Use caution lifting heavy components. Use more than one person and/or proper equipment to handle components.
- ⚠ WARNING:** Use caution while installing the swing arms which will be under extreme spring tension. Arms may rotate unexpectedly.
- ⚠ WARNING:** Use OHSA approved ladders or scaffolding to work above ground level. Be sure that your working platform is secure as you work on the truck.
- ⚠ WARNING:** Properly fasten all components. If not properly secured components may come loose.

ⓘ IMPORTANT: Contains information critical to installation, operation, maintenance or warranty policy.

NOTICE: Is used to address practices not related to physical injury. Risk of product or vehicle being damaged.

NOTE: Contains information critical to the installation or operation of this product.



MAINTENANCE INSTRUCTIONS	
<ul style="list-style-type: none">* Refer to Maintenance sheet or website.* Repairs must ONLY be made after proper instruction.* Spring tension must be properly released before repairs.* Replace damaged or broken parts.* Keep path of arms clear.	
www.sidekickmaintenance.com	
⚠ WARNING	
Springs and arms are under extreme tension. DO NOT stand in the path of the swing arms.	
	
Broken or damaged components could cause death or serious injury	DO NOT stand in the path of the front/rear swing arms or injury could occur.
	
1-800-535-9545	
Label part# 0920-102001	
⚠ CAUTION	
	
DO NOT dump while covered.	DO NOT operate when damaged.
	
Tarp MUST be fully covered or uncovered before driving.	
www.sidekickoperation.com	
OPERATION INSTRUCTIONS	
<ul style="list-style-type: none">* Refer to Operations sheet or website.* Only drive with tarp in fully covered or uncovered position.* Routinely inspect tarp and arms and replace if damaged.	

This manual explains how to install, operate, and maintain the Side Kick 2™. Be sure to read the entire manual before beginning your installation.

Tools Required for Installation	
Safety Glasses	Hammer
Ladder and/or Scaffolding	Awl
Marker or Felt Pen	File
Tape Measure	Wire Brush
Black Electrical Tape	Drill Bits: 11/32", 13/32"
Electrical Wire Crimper	Sockets: 7/16", 1/2", 3/4"
Welder	Open End or Box Wrenches: 7/16", 1/2", 3/4"
Welding Rod	
Band Saw or Saws All	
Electric or Air Drill	
Ratchet	

Side Kick 2™

Installation Instructions

Introduction

Tarp Systems

There are two types of Side-Kick tarp systems. One type utilizes a mesh fabric that fits between the tub front and rear bulkheads.

Trailer Configurations

NOTE: The Side-Kick Cover is designed for use on various makes and models of trailers. Some original equipment manufacturer's (OEM) trailers may be partially equipped with Aero Side Kick ready hardware. Examine the trailer and carefully follow the steps required for your application.

NOTE: Side-Kick covers installed by trailer OEMs occasionally use custom brackets and hardware. Although instructions for some OEM hardware appears in this manual, Aero recommends obtaining specific installation and maintenance instructions for trailer OEM hardware.

Cover/Uncover Direction

Installation instructions show the Side-Kick is configured to cover the trailer from passenger-side to driver-side. The cover/uncover direction can be changed by switching the pivot boxes from front to back and making appropriate adjustments to the installation steps.

STEP 1

Install Quick-Release Mounting Plate (If Required)

Index	Description	Qty
1	Quick-Release Mounting Plates	7

NOTE: OEM installed quick-release mounting plates are typically placed on the passenger side of the tub. (See Figure 1) If the plates are installed, proceed to Step 2.

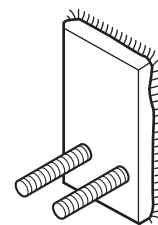

Figure 1

- 1) See Figure 2.** Layout the mounting plate (1) positions on the passenger side of tub. Mark a location for the front and rear plates, 3" from each end of the tub and 4" down from the bottom of tub side rail.

NOTE: Do not include rails as a part of the measurement. All measurements and layout should be on the tub.

- 2)** Mark the locations for the remaining mounting plates (1) equally spaced between the front and rear locations and 4" down from the bottom of tub side rail.
- 3)** Remove any dirt, debris, or paint from the tub at the seven plate locations and weld in place.
- 4)** Primer and paint the plates and tub to match the tub color.

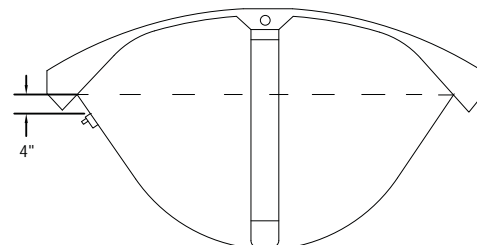

Figure 2

Side Kick 2™

Installation Instructions

STEP 2

Install Swing-Arm Mounting Bracket (Optional)

NOTE: Refer to OEM instructions for installing non Aero swing-arm mounting brackets.

Index	Description	Qty
1	Swing Arm Mounting Bracket	2
2	Mounting Bracket RH	2
3	Mounting Bracket LH	2
4	1/2-13 X 1 1/2" Hex Bolt	8
5	1/2-13 Nylon Hex Nut	8
6	1/2 Flat Washer	8

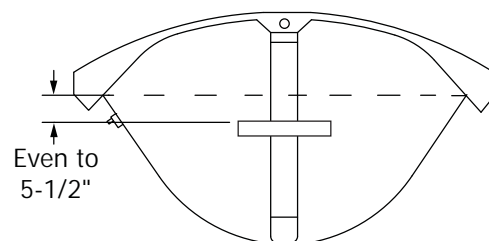

Figure 3

IMPORTANT: The placement of the pivot point is important for proper Side-Kick operation. Follow these steps carefully for optimum performance of the Side-Kick cover.

1) See Figure 4. Assemble the swing-arm mounting bracket (1) with a pair of mounting bracket (2 & 3) with provided fasteners. The mounting brackets (2 & 3) fit inside the swing-arm mounting bracket (1), with the mounting bracket (2 & 3) protruding from the swing-arm mounting bracket (1).

2) See Figure 3. Position, DO NOT install, the assembly on one end of the tub so the center of the bracket is centered side-to-side with the tub, level, and even to 5-1/2" below the tube side rail. Mark the location of the mounting brackets.

Mark bracket location and weld to tub.

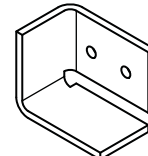

Mounting Bracket Weldment

IMPORTANT: Remove any dirt, debris, or paint from the tub at the weldment locations.

3) Disassemble the swing-arm mounting bracket (1) and weld the mounting bracket (2 & 3) in place.

4) See Figure 4. Assemble the swing-arm mounting bracket to the welded mounting brackets using provided fasteners.

5) Prime and paint to match the tub color.

6) Repeat these steps for the other end of the tub, using the same dimensions.

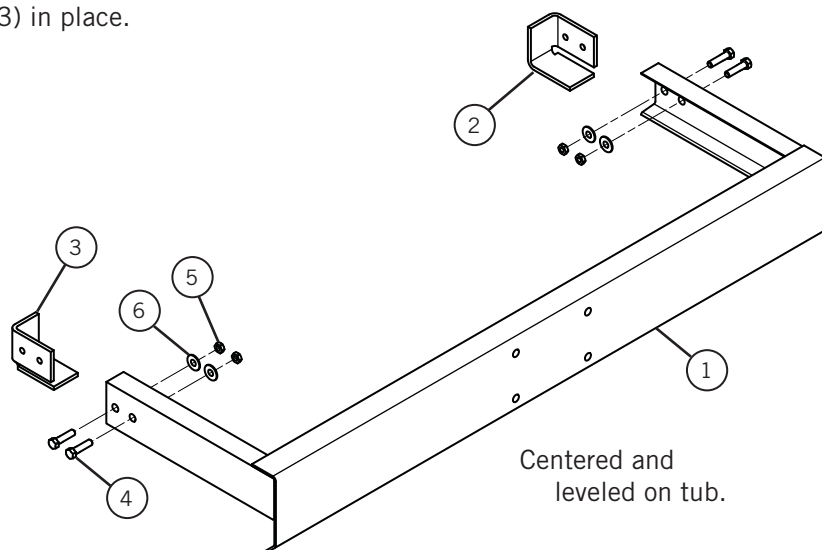

Figure 4

Side Kick 2™

Installation Instructions

STEP 3

Install Spring Mount Post, Roller Plate, Spring, and Spring Stop

Index	Description	Qty	Index	Description	Qty
1	Spring Mount Post	2	7	1/2-13 Nylon Hex Jam Nut	8
2	Roller Plate Assembly	2	8	1/2 Flat Washer	8
3	Hub Spring Front (White)	1	9	1/2-13 Hex Nut	1
4	Hub Spring Rear (Black)	1	10	1/2-13 x 3/4 SHCS	4
5	Spring Stop Assembly	2	11	1/2 Lock Washer	4
6	1/2-13 X 2" Cap Screw	8			

1) See figure 5. Orient the spring mount post (1) to the mounting bracket so the holes in the post are vertical. Mark holes using the spring mount post (1) as a guide.

2) Drill 19/32" diameter clearance holes. Install using 1/2-13 x 2 hex bolts (6), 1/2 flat washers (8), and 1/2-13 nylon hex jam nuts (7) provided.

3) Repeat steps for rear spring post.

4) See Figure 6 & 7. Slide the front roller plate assembly (2) onto the spring post bracket (1). Slide the hub spring - Front (White) (3) onto the front roller plate assembly and align spring into the bottom left adjustment hole of the roller plate assembly (2). Slide the spring stop assembly (5) onto the spring mount assembly behind spring and lock the spring turn shaft into bottom right notch of spring stop assembly. Insert the two 1/2-13 x 3/4 hex bolts (10) with 1/2 lock washers (11) through spring stop and into shaft of spring post bracket.

5) See Figure 6 & 7. Slide the rear roller plate assembly (2) onto spring post bracket (1). Slide hub spring - Rear (Black) (4) onto rear roller plate assembly and align spring into the top left adjustment hole of the roller plate assembly (2). Slide the spring stop assembly (5) onto the spring mount assembly behind spring and lock the spring turn shaft into top right notch of spring stop assembly. Insert the two 1/2-13 x 3/4 hex bolts (10) with 1/2 lock washers (11) through spring stop and into shaft of spring post bracket.

6) Grease zerks in spring post assemblies.

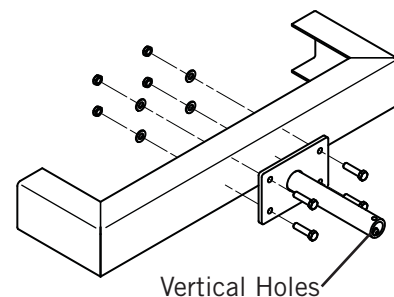

Figure 5

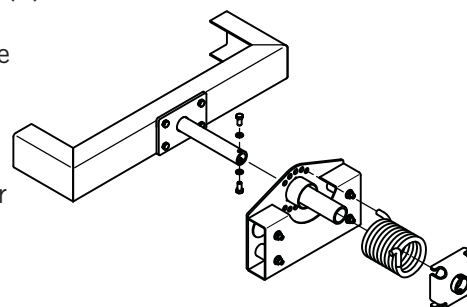

Figure 6

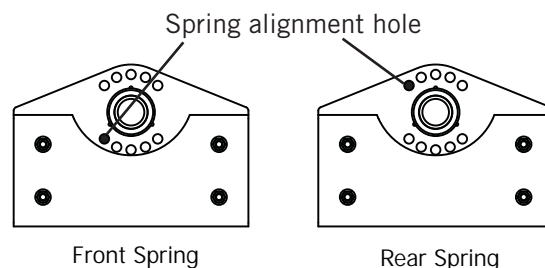

Figure 7

Side Kick 2™

Installation Instructions

STEP 4

Install Swing-Arm Assemblies

Index	Description	Qty
1	Swing-Arm Assembly, Front	1
2	Swing-Arm Assembly, Rear	1
3	Swing-Arm Lock Collar	4
4	5/16-18 x 1" Hex Bolt W/nylon Patch	2
5	Compression Spring	2
6	2" Flat Washer	2

Front Swing-Arm

1) See Figure 8. Slide a lock collar (3), compression spring (5) and 2" washer (6), over the power cables and onto the front swing arm assembly (1). This collar will be tightened in a later step.

2) See Figure 8. Slide the power cable and front swing-arm (1) through the rollers of the front pivot box assembly. Slide another lock collar (3) over the power cable and onto the front swing-arm (1) and tighten 5/16-18 x 1" bolt W/ nylon patch (4) thru hole in tube and tighten second bolt against tube.

⚠ WARNING: Collar could come off unless you make sure bolt in collar is thru hole in tube. Risk of injury to operator or bystander could result.

⚠ WARNING: Use caution while installing the swing arms which will be under extreme spring tension. Arms may rotate unexpectedly.

3) See Figure 9. To set the upper lock collar, rotate the front swing-arm along the bulkhead approximately 12" from the side tube. Raise the swing-arm assembly so the bottom of the motor drive unit assembly clears the trailer frame rail. While the assembly is in this position, slide the lock collar against the pivot box, or compression spring, and tighten.

NOTE: It will be necessary to fine-tune the upper lock collar placement for proper operation. Refer to the installation adjustments in Step 9 after the Side-Kick is installed.

4) Measure the distance between the open end of the front swing-arm (1) and the upper lock collar (3) and transfer that dimension to the rear swing-arm assembly (2).

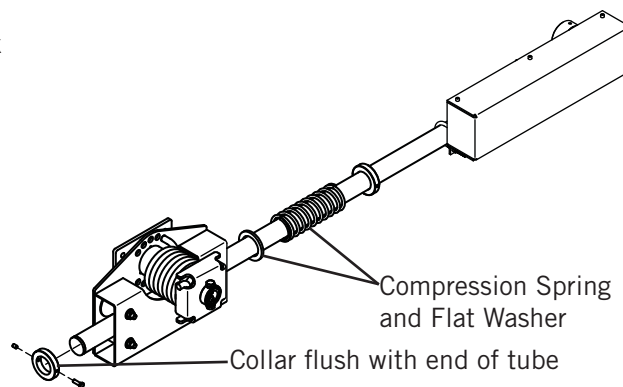

Figure 8

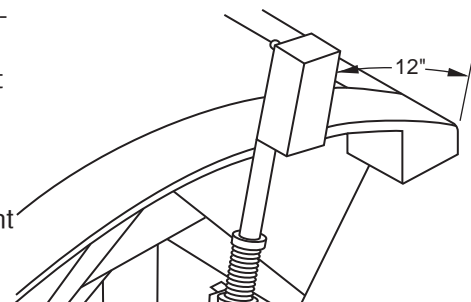

Figure 9

Side Kick 2™

Installation Instructions

Rear Swing-Arm

- ⚠ **WARNING:** Collar could come off unless you make sure bolt in collar is thru hole in tube. Risk of injury to operator or bystander could result.
- ⚠ **WARNING:** Use caution while installing the swing arms which will be under extreme spring tension. Arms may rotate unexpectedly.

5) See Figure 9. Install and tighten the upper lock collar (3) on the swing-arm assembly at the transferred measurement. Slide the compression spring (5) and 2" washer (6) onto the rear swing-arm assembly (2).

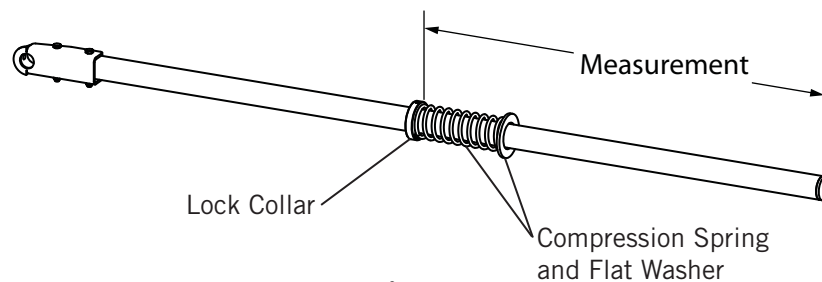

Figure 9

6) See Figure 10. Slide the swing-arm assembly (2) through the leg of the rear pivot box assembly. Slide the remaining lock collar (3) onto the rear swing-arm assembly and tighten one 5/16-18 x 1" W/ nylon patch (4) thru hole in tube and tighten second bolt against tube.

NOTE: It will be necessary to fine-tune the upper lock collar placement for proper operation. Refer to the installation adjustments in Step 9 after the Side-Kick is installed.

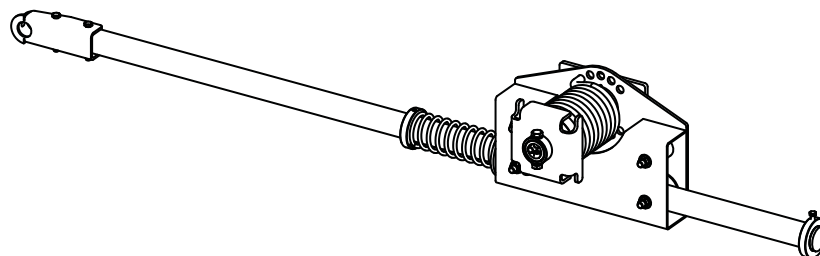

Figure 10

Side Kick 2™

Installation Instructions

STEP 5

Prepare Tarp Assembly

Index	Description	Qty
1	Roll-Up Bar Assembly	2
2	1-1/8" Galvanized Tube for Fixed Tube	9
3	Tarp	1

NOTE: To Accommodate various side-dump trailer configurations, the roll-up bar and fixed tube are two piece assemblies that must be sized and built to your application.

NOTE: Except where noted, the preparation of mesh and vinyl tarp systems are identical. Read the instructions carefully and follow the steps for your application.

NOTE: Proper orientation of Side-Kick components and measurements taken in these steps are critical to proper Side-Kick operation.

NOTE: Steps 1 and 2 are intended to position the Side-Kick components so an accurate measurement may be taken for the roll-up bar length.

- 1) Extend the front and rear swing-arm assemblies so the lower lock collars rest against the pivot box assemblies. Align the swing-arms so they are parallel with each other. Use temporary supports if necessary.
- 2) Check the orientation of the pivot box assemblies. The face of the boxes must be plumb.
- 3) **See Figure 10.** Measure and note the distance between the shaft collar face on the front roll-up adapter and the shaft bushing face on the swing-arm.
- 4) Subtract 1 1/2" from the noted distance. The resulting distance is the finished length of the 3" diameter aluminum tube.

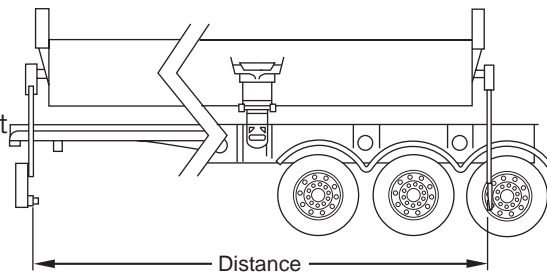

Figure 11

NOTE: DO NOT include the roll-up bar adapters as a part of the length of the 3" diameter aluminum tubing. This will cause the roll-up bar to be too short.

- 5) Lay two sections of the roll-up bar (1) on a flat surface, overlapping the open end of the tube with the welded billet in the other tube. Adjust the overlap so the 3" diameter tube is equal to the dimension determined in the previous step.
- 6) **See Figure 12.** Mark the open ended tube for a cut that allows a smooth and even weld to the billet in the other tube.
- 7) Cut the tube where marked and assemble the open ended tube onto the billet. Adjust the pieces so the length of the 3" tubing is equal to the dimension determined in Step 4.

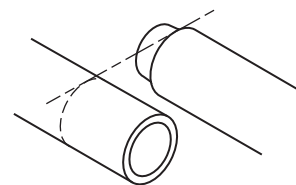

Figure 12

- 8) Weld the tubes Together.

Side Kick 2™

Installation Instructions

- 9) Create a Fixed tube (2) by assembling the two pieces of 1-1/8" galvanized tubing at the joint and welding them together.
- 10) Spread the tarp (3) out on a flat surface.
- 11) Lay the fixed tube (2) along the pocket in mesh tarp. Allow the fixed tube (2) to extend 1" beyond each end of the tarp (3) and cut the rod to length.
- 12) Insert the fixed tube (2) into the smaller pocket in the tarp (3).
- 13) **See Figure 13.** Slide the roll-up bar assembly (1) into the larger pocket in the tarp (3). Note the position of the long adapter shaft on the roll-up bar points toward the rear of the trailer.
- 14) Vinyl Tarp Only- Trim the rubber treads at each end of the roll-up bar to allow 1" to 2" of clearance from the vinyl tarp. Make sure the edge of the tread nearest the vinyl tarp is fastened to the roll-up bar. Add a self-tapping if necessary.
- 15) While the tarp (3) is laying flat, wind the tarp (3) onto the roll-up bar (1) by rolling it toward the fixed tube (2).

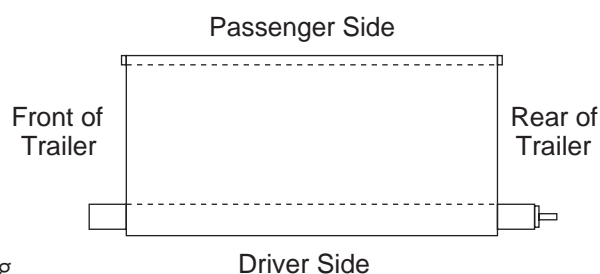

Figure 13

STEP 6

Install Tarp Assembly

NOTE: Refer to the trailer OEM instructions for non-Aero roll-up bar supports.

NOTE: Except where noted, the installation of mesh and vinyl tarp systems are identical. Read the instructions carefully and follow the steps for your application.

Index	Description	Qty	Index	Description	Qty
1	Tarp Assembly	1	7	5/16-18 Flange Nut	14
2	Fixed Tube Clamps	7	8	5/16-18 Cap Screw	5
3	Tarp Cradle	2	9	5/16 Flat Washer	5
4	Tarp Top Hook	2	10	5/16-18 Nylon Hex Nut	5
5	Rear Swing-Arm Shaft Collar	2	11	1/4 Self Tapping Screws	16
6	Roll-Up Bar Tarp Clamps	16			

- 1) **See Figure 14.** Place the tarp assembly (1) on top of the trailer tub bulkheads. The long adapter shaft is positioned toward the swing-arm end of the trailer.
- 2) Unroll the tarp until the fixed tube drapes over the passenger-side of the trailer, toward the fixed tube clamp weldments.

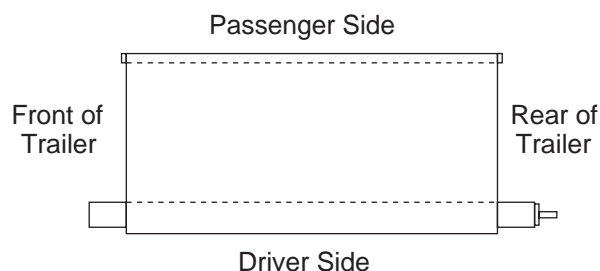

Figure 14

Side Kick 2™

Installation Instructions

3) See Figure 15. Center the mesh tarp between the bulkheads.

4) See Figure 16. Vinyl Tarp Only - Center the vinyl tarp over the tub bulkheads so an equal length of tarp overlaps the front and rear bulkheads.

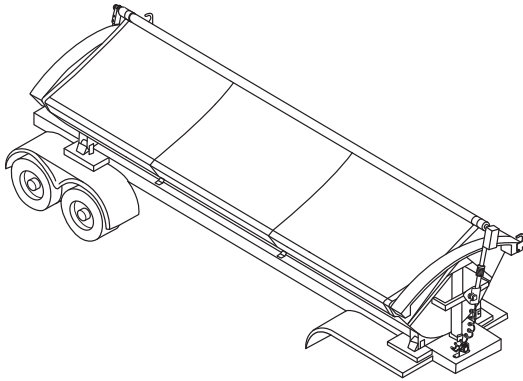

Figure 15

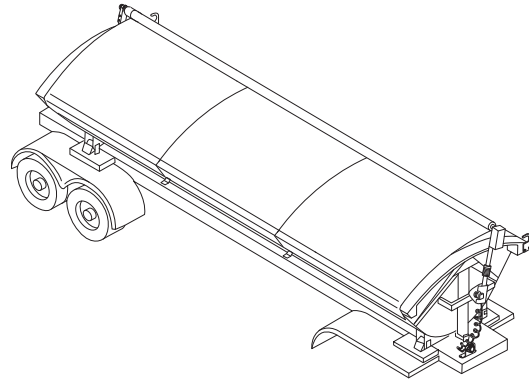

Figure 16

5) See Figure 17. Position the fixed tube and tarp slightly above the quick-release mounting plates. Use 5/16-18 flange nuts (7) to install the fixed tube clamps (2) onto the mounting plates, clamping the tarp in place. Make sure the fixed tube and tarp are straight and smooth with no substantial wrinkles.

6) Unroll the roll-up bar until it drapes over the driver-side of the trailer.

7) Raise the front swing-arm to reach the roll tube. The open end of the roll-up bar must be facing toward the motor. If the rear shaft adapter is toward the motor, the roll-up bar must be removed and reinserted into mesh tarp pocket correctly.

8) See Figure 18. Use three of the supplied 3/8" button head screws with lock washers to attach end of the roll pipe to the roll pipe adapter.

NOTE: It may be necessary to rotate roll tube or operate tarp motor to line up holes for mounting.

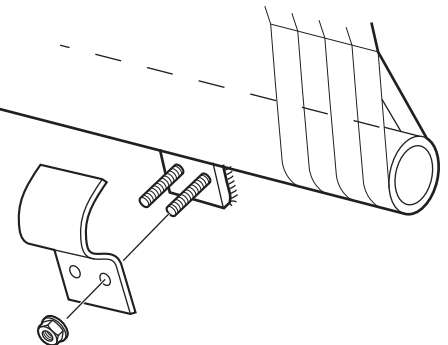

Figure 17

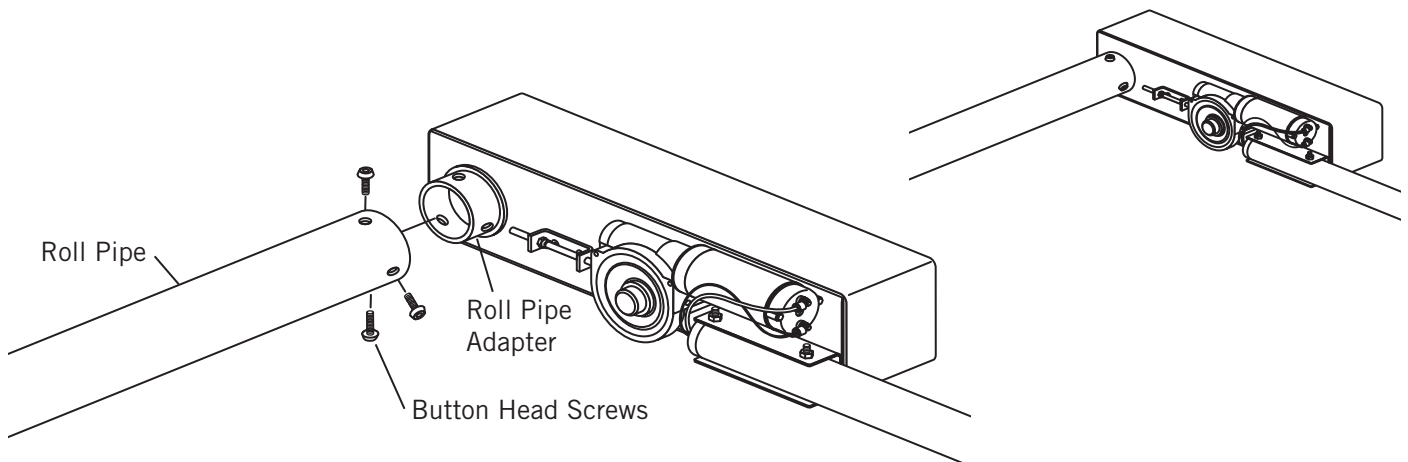

Figure 18

Side Kick 2™

Installation Instructions

11) See Figure 19 Slide the shaft collar (5) and the rear swing-arm onto the adapter shaft at the rear of the trailer. Re-check the pivot box face for plumb. Place the shaft collar (5) 1/4" from the swing-arm bushing and tighten.

12) Slide another shaft collar (5) onto the adapter shaft. Position it 1/4" away from the swing-arm bushing and tighten.

13) Check the alignment of the roll-up bar to the tub and bulkhead. The rubber tread on the roll-up bar should be aligned to track over the bulkhead, while allowing the mesh tarp to fit between the bulkheads. Vinyl Tarp Only - The vinyl tarp should overlap the bulkheads.

14) See Figure 20. While the roll-up bar is hanging over the side rail, use the self-tapping screws (11) and tarp clamps (6) to secure the tarp to the roll-up bar. Install a tarp clamp (6) at each end, then equally space and install the remaining clamps.

15) See Figure 21. Raise the roll-up bar past the corner of the tub to allow the installation of the tarp stop hook (4). Install a tarp stop hook (4) at each end of the tub using the 5/16-18 cap screws (8), 5/16 flat washers (9), and 5/16-18 nylon hex nuts (10) provided.

16) See Figure 22. Orient the tarp cradles (3) one third in from each end of the tub and 1/2" below the fixed tube. Mark the tub with the bracket location.

17) Remove any dirt, debris, or paint from the tub at the bracket locations.

18) Weld the tarp cradles (3) in place.

19) Prime and paint the components to match the tub color.

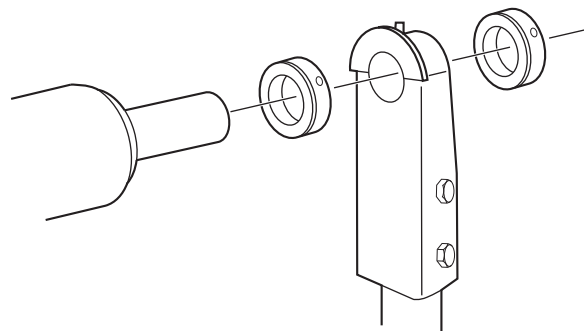

Figure 19

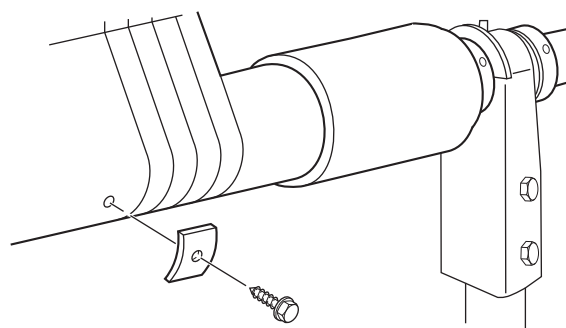

Figure 20

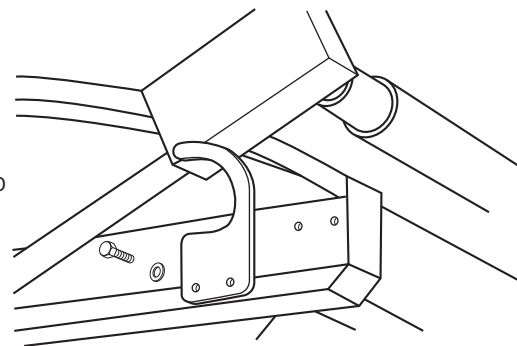

Figure 21

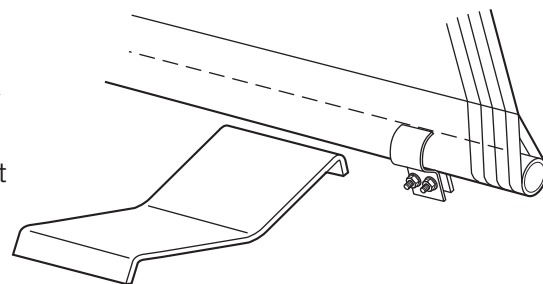

Figure 22

Side Kick 2™

Installation Instructions

Step 7

Place Labels

- 1) See Figure 23.** Locate a place for the safety label on the front of the trailer. On the side where the tarp system is in the closed position.
- 2)** Clean the area with soap and water, dry area.
- 3)** Remove backing and adhere label to trailer.
- 4)** Repeat for the rear of the trailer.

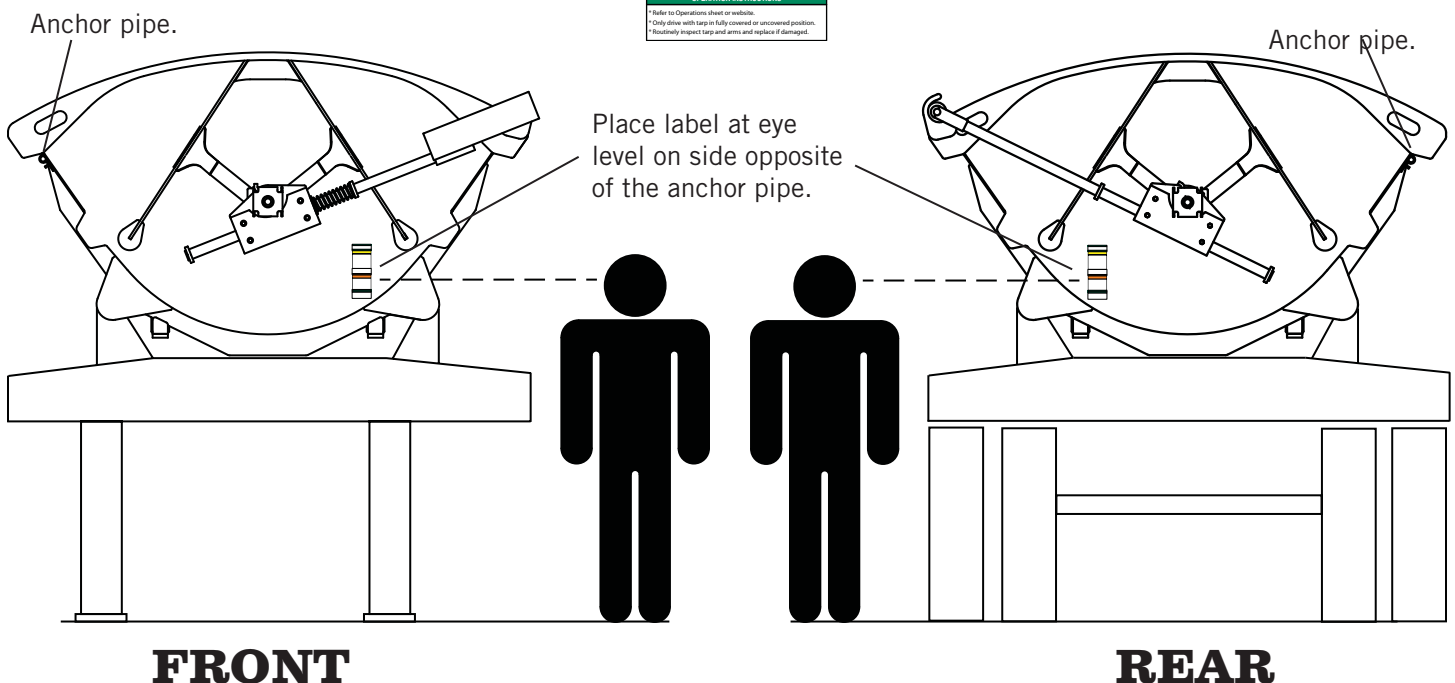
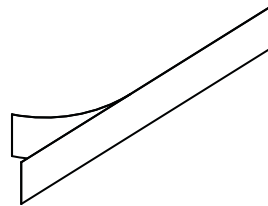

Figure 23

Side Kick 2™

Installation Instructions

Step 8a

Semi-trailer Truck Wiring

IMPORTANT: Locate Operation/Maintenance Sheet and keep near switch.

IMPORTANT: Switch is not rated for outdoor use.

- 1) Find a convenient place on the driver's side under the dashboard to mount the rocker switch with 1/4-20 x 1" hex bolts

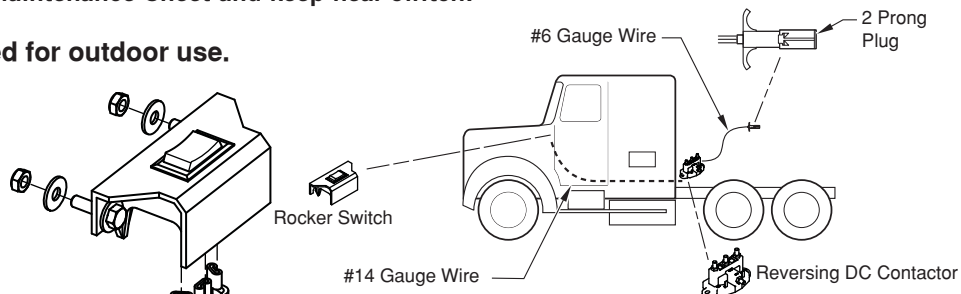

- 2) Mount reversing contactor outside near back of cab with 1/4-20 x 2" hex bolts.

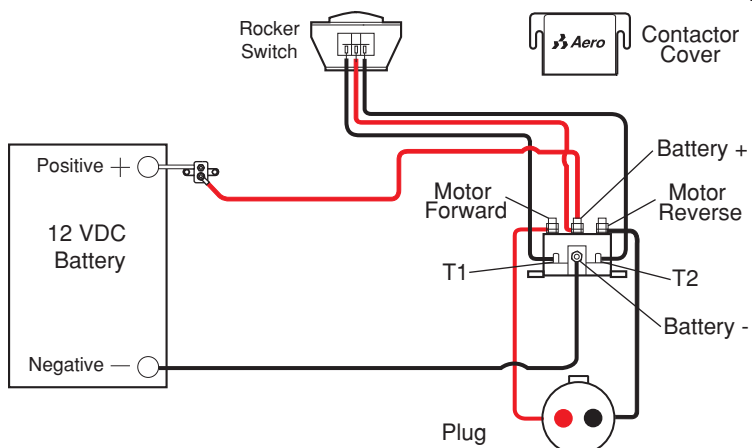

- 3) Run wire from switch to reversing contactor. Run wire from battery to reversing contactor. Secure all wire with clamps.

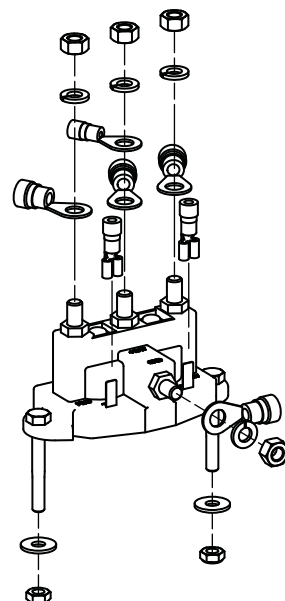

- 4) Connect breaker to battery and secure with zip ties.

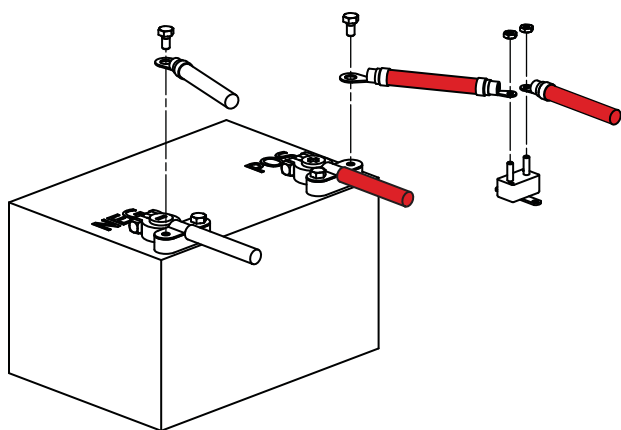

- 5) Run wires from reversing contactor to plug, making sure there is enough wire to reach the receptacle.

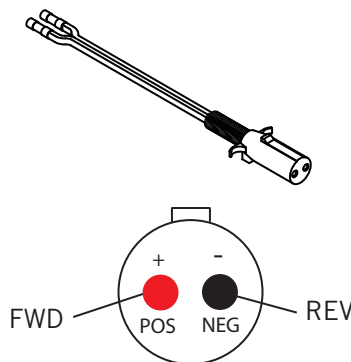

- 6) Place cover on reversing contactor.

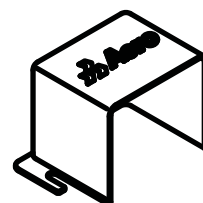

Side Kick 2™

Installation Instructions

Step 8b

Semi-trailer Wiring

- 1) Mount receptacle in convenient location.

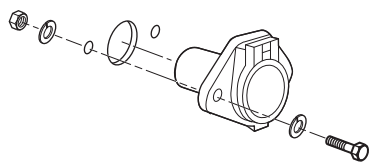

- 2) Run wire from receptacle to motor. Secure all wire with clamps.



Terminal 2 Terminal 1

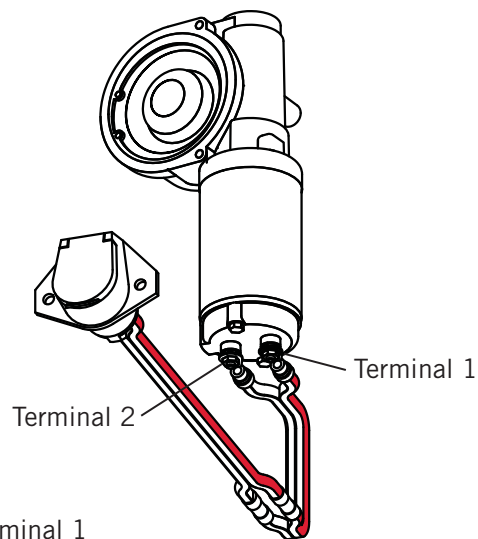

Step 12c

Optional Remote Wiring

IMPORTANT: Locate Operation/Maintenance Sheet and keep in a convenient location.

IMPORTANT: Remote receiver must be mounted with the wires at the bottom.

The optional remote kit replaces the use of the rocker switch. Follow steps 12a and 12b and replace the rocker switch with the remote receiver.

- 1) Mount the remote receiver to the back of the cab with the provided screws.
- 2) Connect remote receiver to reversing DC Contactor. Secure all wire with clamps.

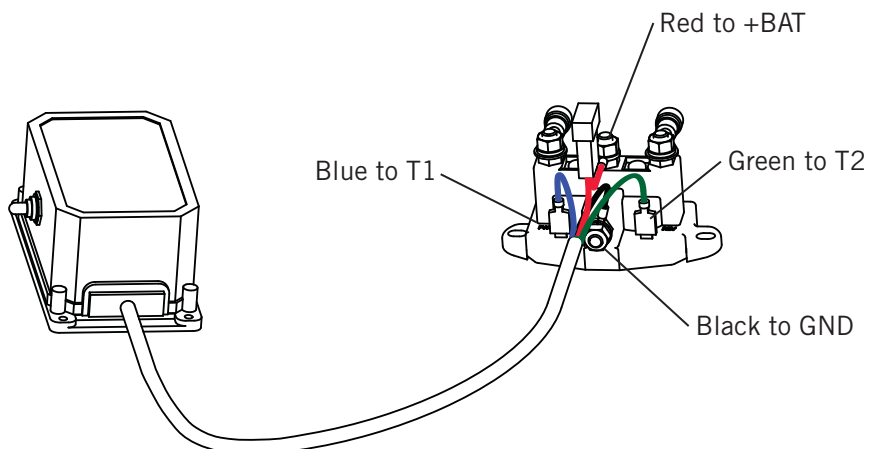

Side Kick 2™

Installation Instructions

Step 8d

Alternate Remote Wiring

⚠ IMPORTANT: Locate Operation/Maintenance Sheet and keep in a convenient location.

Semi-trailer Truck Wiring

1) Connect breaker to battery and secure with zip ties.

2) Run wire from battery to receptacle.
Secure all wire with clamps.

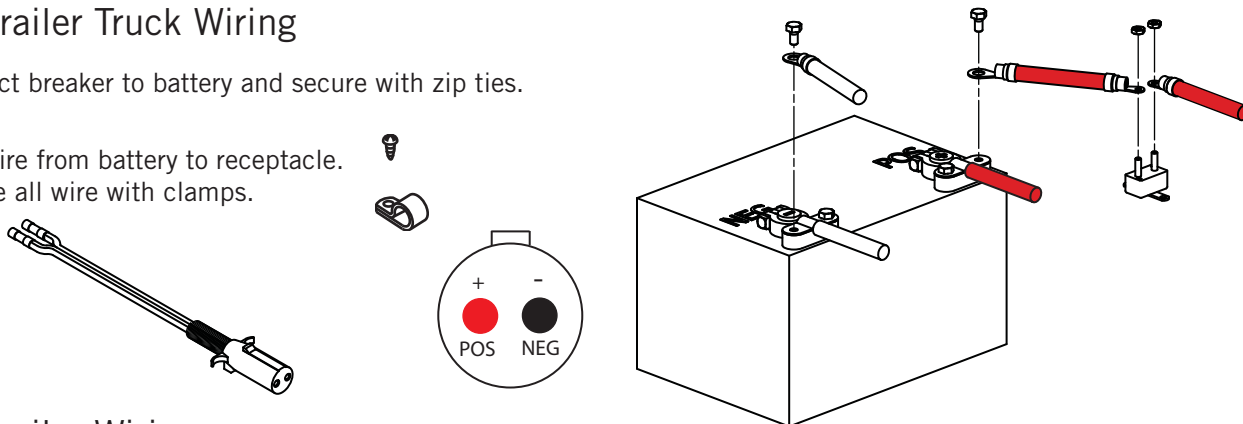

Semi-trailer Wiring

3) Mount receptacle in convenient location on trailer.

4) Mount reversing contactor under the nose of the trail with 1/4-20 x 2" hex bolts.

⚠ WARNING: DO NOT place remote receiver in the path of the swing arm, or injury could occur. Mount it on the face of the trailer on the same side as the anchor pipe.

⚠ IMPORTANT: Remote receiver must be mounted with the wires at the bottom.

5) Mount the remote receiver to the back of the cab with the provided screws.

6) Connect remote box to reversing DC Contactor. Secure all wire with clamps.

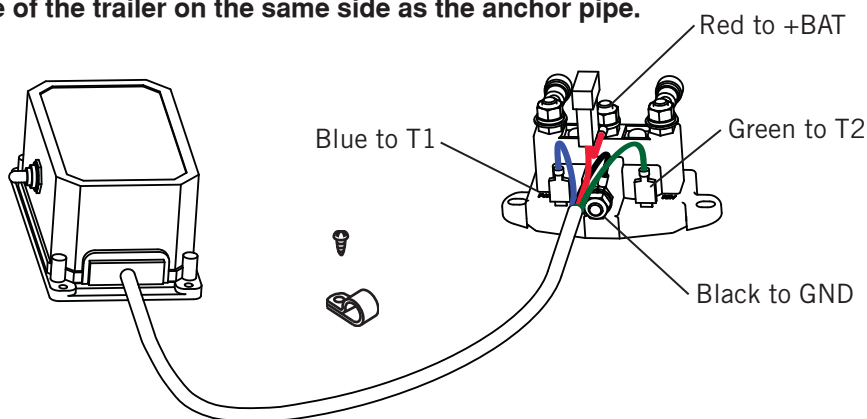

7) Connect receptacle to reversing DC contactor. Secure all wire with clamps.

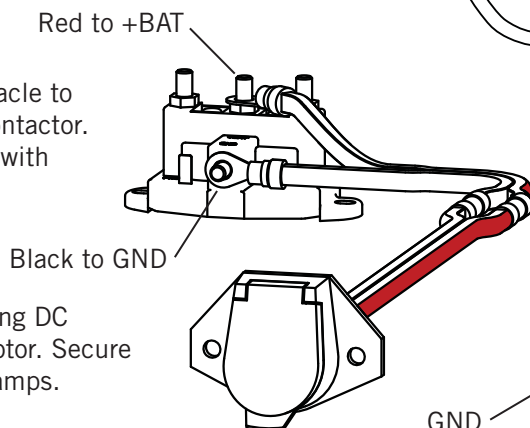

8) Connect reversing DC Contactor to motor. Secure all wire with clamps.

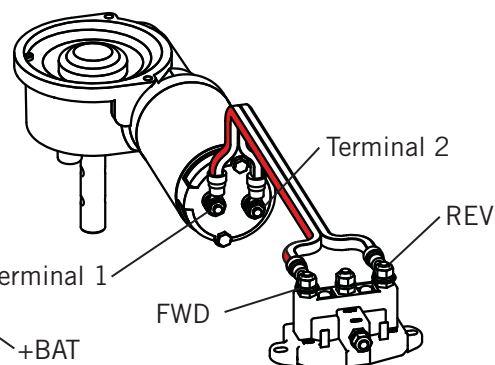

⚠ IMPORTANT: The reversing DC contactor should be mount under the nose of the trailer NOT near the motor.

STEP 9

Installation Adjustments

- 1)** Operate the Side-Kick cover through its full range of motion. The cover should operate smoothly and evenly.
 - When fully retracted, the tarp should be neatly wound around roll tube and on the passenger-side seat on the tarp cradle.
 - When fully deployed, the roll tube should sit in the tarp hooks on the driver-side of the trailer.
- 2)** If the unit hesitates, binds, or is unable to fully retract or deploy, perform the following inspections:
 - a)** Inspect the pivot assemblies, and swing-arm assemblies for proper alignment. Review the installation steps to correct the alignment.
 - b)** Check the placement of the swing-arm lock collars. Monitor the lock collars as the tarp is deployed or retracted. Adjust the lock collar placement to improve swing-arm function.
 - c)** Optional equipment ONLY: Adjust the tension on the compression springs, if used. There should be sufficient compression spring tension to push the swing-arm assemblies clear of the side-rail when deployed, but not so much tension that the cover is unable to retract. Adjust the compression spring lock collar toward the pivot box for better clearance of the side-rails. Adjust the compression spring lock collar toward the roll-up bar to allow the tarp to fully retract.
- 3)** It may be necessary to increase the spring tension of the spring assemblies, if so go to STEP 10.

Side Kick 2™

Installation Instructions

STEP 10

Spring Adjustment

The spring assemblies provided in the SK2 kit are assembled and ready to be installed with a preset tension setting used for most standard length side dump trailers. In the event you need to add more spring tension to the spring assembly simply follow the instructions below.

- ⚠ **WARNING:** The Side Kick 2 cover system operates under extreme spring tension to drive the swing-arms. To reduce the possibility of personal injury, the swing-arms must be secured before servicing the system.
- ⚠ **WARNING:** Make sure you have the tarp completely in the covered position. If you try to adjust springs while springs have tension applied, serious injury or death can occur.
- ⚠ **WARNING:** Always check to make sure that no one is in the immediate area of the tarp as it operates. Keep everyone clear of the area.
- ⚠ **WARNING:** Keep all clothing clear of moving parts.

1) See Figure 1. Deploy the tarp to its complete covered position. Start by adjusting the front spring (white) in the front spring assembly. It may be helpful to unbolt the roll pipe adapter from roll pipe (3 - 3/8" Allen head bolts) as you may need to release a small amount of preset spring tension still applied to swing arm.

2) See Figure 2. Remove the two 1/2" hex head bolts holding the spring stop assembly to the spring assembly post shaft.

3) See Figure 2. While keeping the outside spring stub in the same spring stop assembly notch, pull the spring stop assembly (with the spring) off of pivot post enough to get spring out of roller plate adjustment hole. While holding the spring and spring stop assembly stationary, pivot the roller plate CLOCKWISE until you can slide spring stub into next adjustment hole on pivot plate.

4) See Figure 2. Insert the two 1/2" Allen head bolts through spring stop assembly into spring assembly post shaft and tighten.

5) See Figure 1. Lift the swing arm back up and bolt to roll pipe.

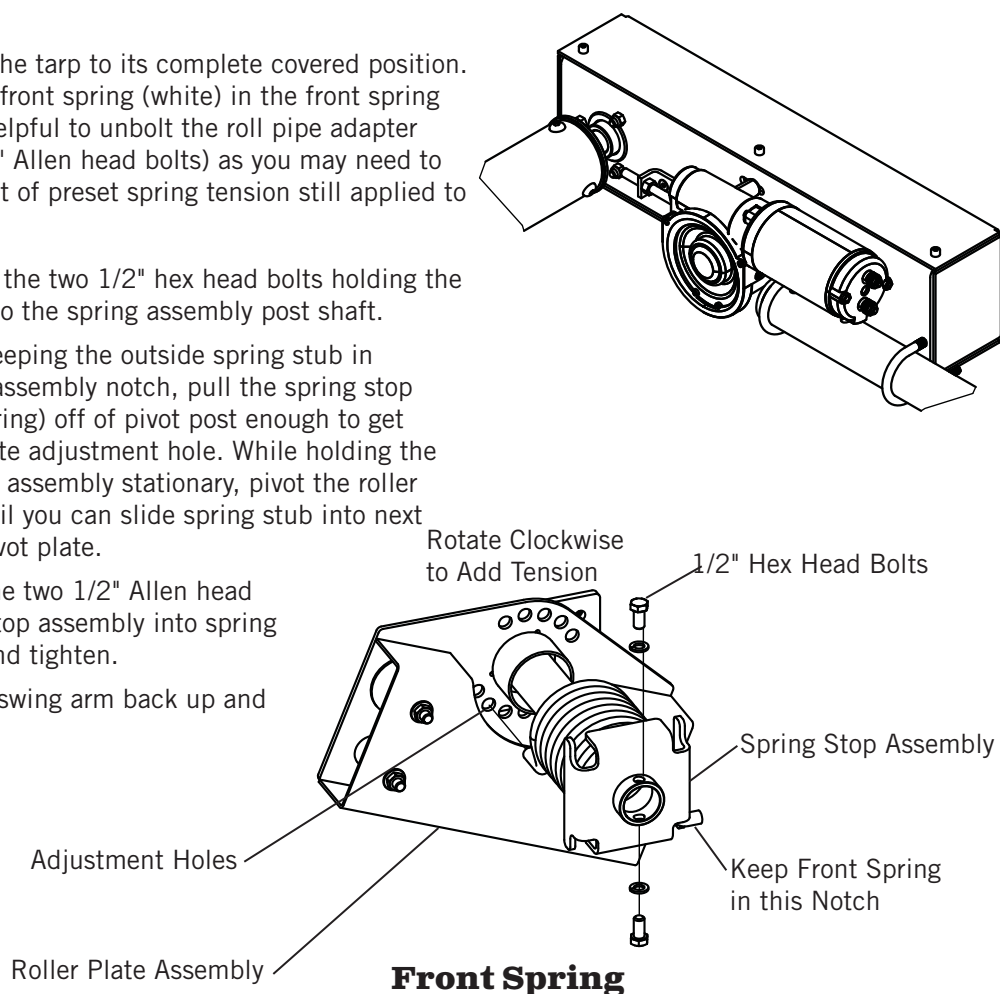

Side Kick 2™

Installation Instructions

6) See Figure 3. With the tarp deployed to its complete covered position, to adjust the rear spring (black) in the rear spring assembly. It may be helpful to remove rear swing arm from roll pipe as you may need to release a small amount of preset spring tension still applied to swing arm. Remove the rear swing arm by loosening and removing the lock collar on rear roll pipe adapter.

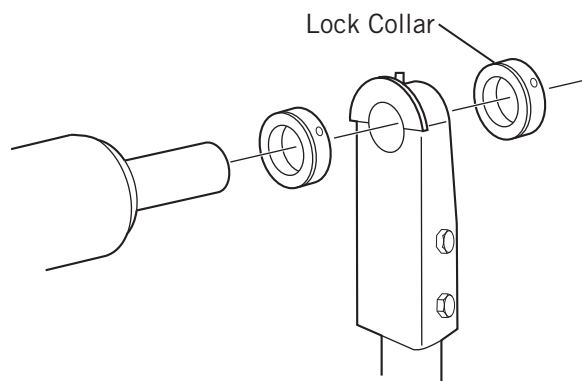

7) See Figure 4. Remove the two 1/2" Allen head bolts holding the spring stop assembly to the spring assembly post shaft.

8) See Figure 4. While keeping the outside spring stub in the same spring stop assembly notch, pull the spring stop assembly (with the spring) off of pivot post enough to get spring out of roller plate adjustment hole. While holding the spring and spring stop assembly stationary, pivot the roller plate COUNTERCLOCKWISE until you can slide spring stub into next adjustment hole on pivot plate.

9) See Figure 4. Insert the two 1/2" Allen head bolts through spring stop assembly into spring assembly post shaft and tighten.

10) See Figure 3. Lift the swing arm back up and bolt to roll pipe.

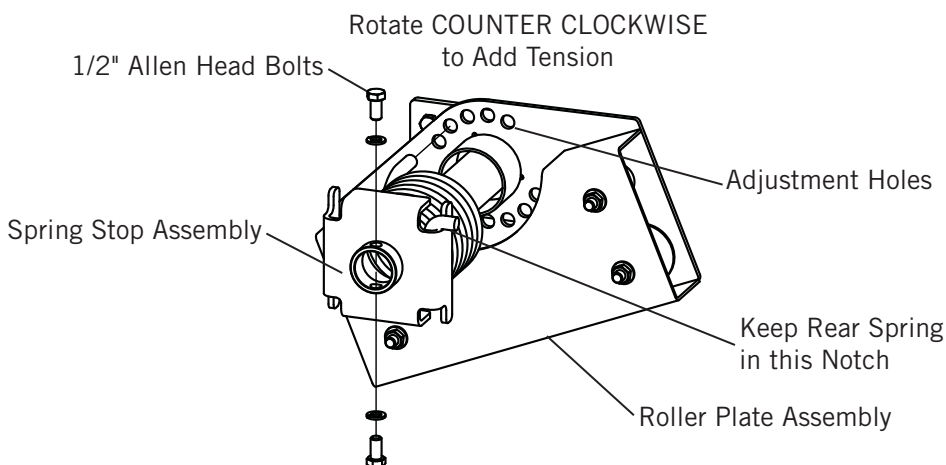

Rear Spring

Side Kick 2™

Operation & Maintenance

How to Operate PowerLock™

NOTICE: NOT RELEASING THE SWITCH WHEN THE COVERED OR UNCOVERED POSITION IS REACHED MAY CAUSE THE MOTOR TO BURN OUT.

Switch

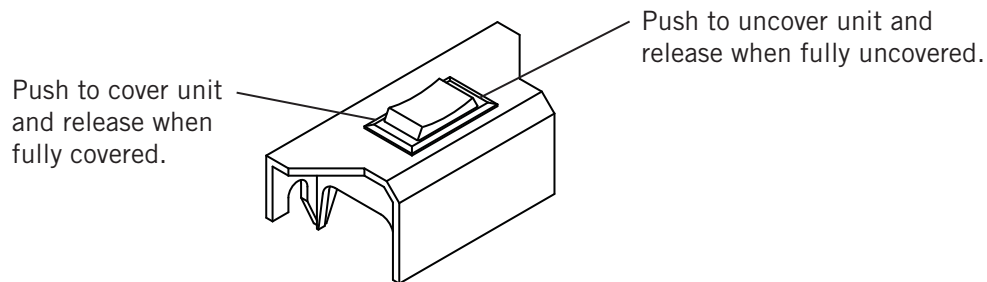

Remote Operation

To operate the remote, disable the safety lock out by pushing both buttons for 2 seconds.

NOTE: After 1 minute of not pushing a button on the remote the safety lock out is activated.

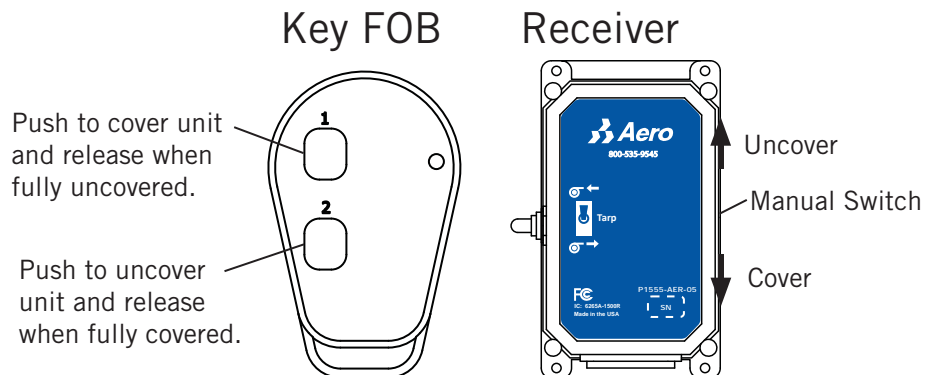

Explanation of Signal Words

⚠ WARNING: Indicates a hazardous situation which, if not avoided could result in death or serious injury.

⚠ CAUTION: Indicates a hazardous situation which, if not avoided could result in minor or moderate injury.

Safety Messages related to the operation of Side Kick 2™

Maintenance recommendations, safety messages, and repair instructions can be found at www.sidekickoperation.com or call 800-535-9545.

⚠ CAUTION: Routinely inspect tarp and swing arms, DO NOT operate if parts are worn or damaged. Worn or damaged parts may come loose. Replace all worn or broken parts IMMEDIATELY.

⚠ CAUTION: If the arms are damaged or fail to rotate freely under normal operation, DO NOT operate. Secure any damaged parts until repairs can be made.

⚠ CAUTION: DO NOT dump while covered. Dumping while covered could cause the side dump trailer to tip over.



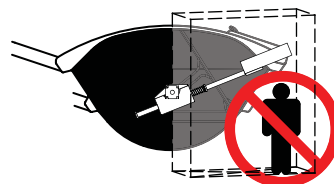





⚠ WARNING: The swing arms rotate under extreme spring tension during operation during operation. Make sure no one is in the path of or on the arms.



How to Maintain the Side Kick 2™

⚠ IMPORTANT: Replace all worn or broken parts immediately. Repairs must **ONLY** be made after proper instruction.

Minimal maintenance is required for the Side Kick 2™. Individual usage and operating conditions will determine when to check the Side Kick 2™. Aero Industries recommends a weekly inspection of the following items:

-  Inspect Tarp for wear and tears.
-  Inspect arms for damage (cracked, dented or bent).
-  **Bearings:** Pull the shafts from side to side and in and out. If there is excessive play, replace the bearings. Lubricate as often as necessary with penetrating oil. DO NOT use an excessive amount of lubricant.
-  **Springs:** Examine springs for breakage or distortion. Apply a light coat of penetrating oil to tension springs as needed.
-  **Fasteners:** Make sure that all mounting bolts and screws are in place and tight and that no parts are worn or damaged.
-  **Chain:** Check the chain tension, that links move smoothly, and make sure the master link is on. Lubricate the chain regularly with penetrating oil.
-  **Electrical Connections:** Check all electrical connections and tighten any that have become loose.
-  **Safety Labels:** Clean labels with soap and water. Replace if damaged and/or difficult to read.

Replacement Parts and instructions may be obtained from your Aero dealer or by contacting Aero Industries.

Explanation of Signal Words

- ⚠ WARNING:** Indicates a hazardous situation which, if not avoided could result in death or serious injury.
- ⚠ CAUTION:** Indicates a hazardous situation which, if not avoided could result in minor or moderate injury.

Safety Messages related to Maintenance of Side Kick 2™

Maintenance recommendations, safety messages, and repair instructions can be found at www.sidekickmaintenance.com or call 800-535-9545.

- ⚠ CAUTION:** Routinely inspect tarp and swing arms, DO NOT operate if parts are worn or damaged. Worn or damaged parts may come loose. Replace all worn or broken parts IMMEDIATELY.
- ⚠ WARNING:** The swing arms rotate under extreme spring tension and damaged arms could come loose unexpectedly allowing the arm to rotate to with tremendous force. Before any repairs see repair instructions on website shown above for "Properly Releasing Spring Tension" and properly release spring tension.
- ⚠ WARNING:** DO NOT unlock the clamps holding the anchor pipe before releasing the spring tension on the Side Kick 2™. Unlocking the anchor pipe clamps can cause a rapid release of spring tension.

Power Loss Repair Bulletin

This repair bulletin describes a temporary field repair for the Side Kick 2 cover system in the event of a power loss or other failure while the cover is partially deployed and can **NOT** get to covered position.

⚠ WARNING: The Side Kick 2 cover system operates under extreme spring tension to drive the swing-arms. To reduce the possibility of personal injury, the swing-arms must be secured before servicing the system.

NOTE: This procedure requires the use of two come-a longs or power pull devices.

NOTE: This is a temporary field repair. Contact Aero Industries or your Side Kick dealer for standard repairs.

STEP 1

How to Secure the Swing-Arms

⚠ WARNING: Both the front and rear swing-arms must be secure.

NOTE: To safely secure the swing-arms, come-a longs must be attached to the swing-arms, NOT the roll bar.

- 1) See Figure 1.** Attach one end of the come-along to the front swing-arm (A), near the motor housing. Attach the other end of the come-along to the trailer on the side the tarp is anchored (B).
- 2) See Figure 1.** Attach another come-along between the rear swing-arm (C) and trailer (D).
- 3)** Tighten the come-a long's equally until the tarp becomes slack and the swing-arms are secure.

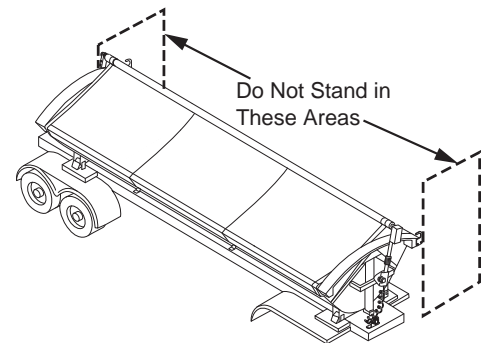

Figure 1

STEP 2

How to Disengage the Motor

- 1)** Once the swing-arms are secure, remove 3 hex head cap screws from front roll-up bar adaptor attached to front of roll tube and slide front swing arm (with front roll-up bar adaptor) out of front of roll-up bar and remove rear swing arm by removing outside 1 1/4" lock collar from rear roll-up bar adaptor and sliding arm off back of roll tube.

STEP 3

How to Complete the Covering Process

⚠ WARNING: The come-a long's are now retaining the force of the swing-arm spring tension. Use great care and make sure you understand how the come-along operates before adjusting.

- 1)** To cover the trailer, slowly and equally adjust the come-a longs until the roll tube is resting in the supports on the driver-side of the trailer. Remove or secure the come-a longs before transport.

⚠ WARNING: The tarp must be in the fully unrolled position and not under the latch plate, before any service/repair work can be performed.

Side Kick 2™

Parts List

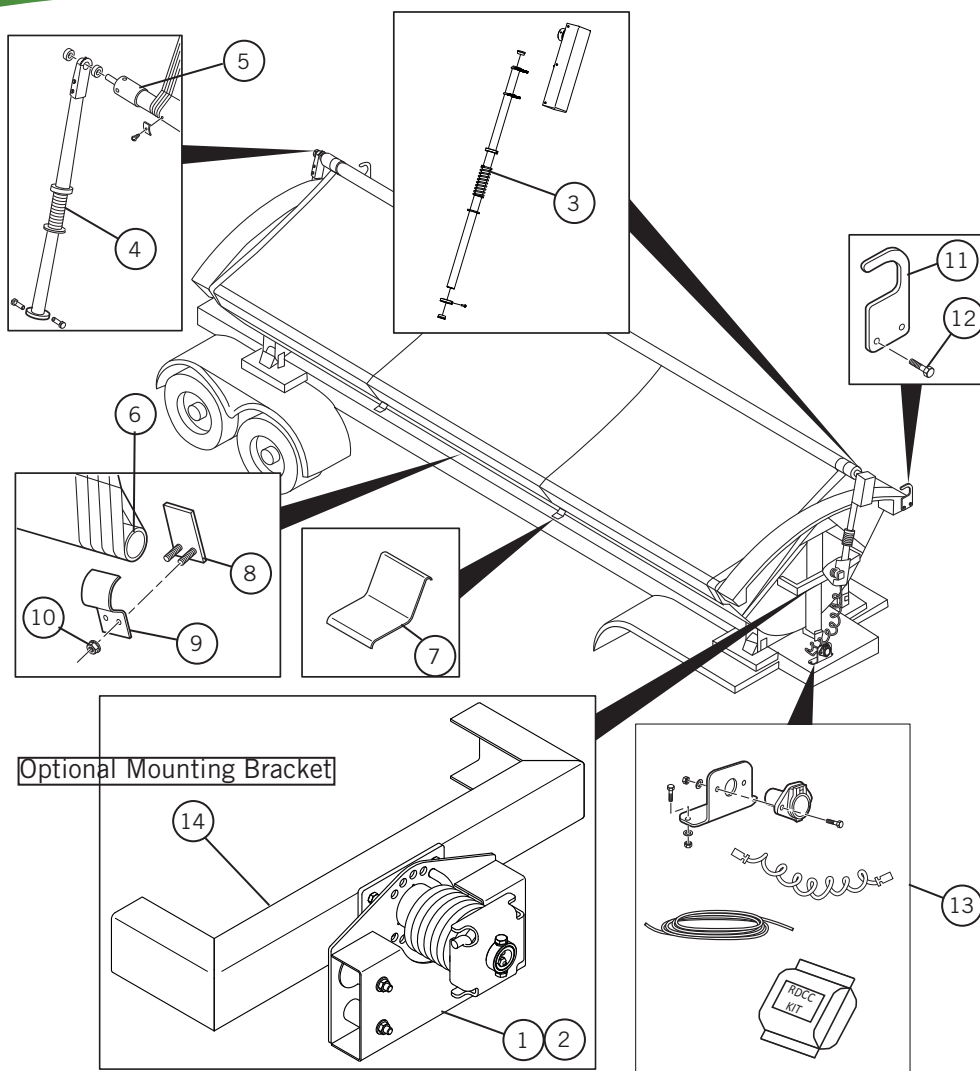

No.	Part No.	Description	Qty	Page
1	1001-961700	Spring Mount Assembly Front	1	21-22
2	1001-961701	Spring Mount Assembly Rear	1	21-22
3	1001-961703	Front Swing Arm Assembly	1	23-24
4	1001-961705	Rear Swing Arm Assembly	1	25
*5	1001-961702	Roll Tube Assemble	1	
6	1001-861801	Fixed Tube	2	
7	1001-860166	Tarp Cradle	2	
8	1001-961304	Quick Release Clamp Weldment	7	
9	1001-861323	CLAMP, ANCHOR PIPE	7	
10	0815-660210	5/16-18 Flange Nut	14	
11	1001-861320	Tarp Stop Hook	2	
12	0810-650510	5/16 Self-Tapping Screw	4	
13		Electrical Hardware		26
14		Swing Arm Mounting Bracket (OPTIONAL)		27
15		Hardware		27

*Roll Tube Assemble
includes the Fixed tube

Spring Mount Assemblies

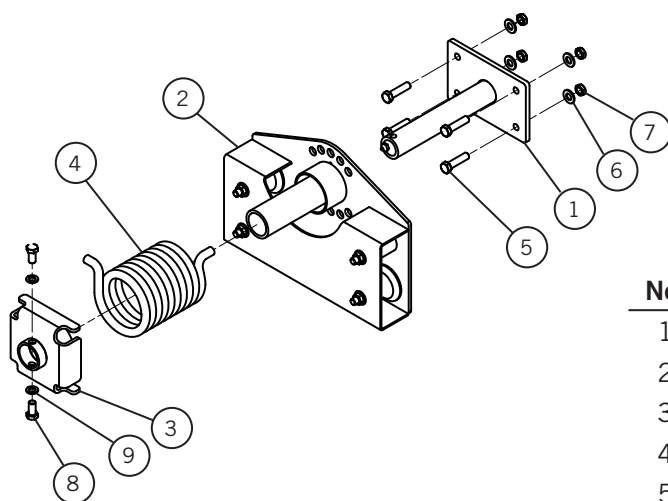

1001-961700 Spring Mount Assembly Front			
No.	Part No.	Description	Qty
1	1001-960701	Spring Mount Post	1
2	1001-961410	Roller Plate Assembly	1
3	1001-960703	Spring Stop Assy	1
4	1001-861408	SK2 Hub Spring LH	1
5	0810-600002	1/2-13 x 2 Hex Bolt	4
6	0820-680810	1/2 Flat Washer	4
7	0815-660127	1/2-13 NYLOCK Hex Jam Nut	4
8	0810-650553	1/2-13 x 3/4 SHCS	2
9	0820-680820	1/2 Lock Washer	2

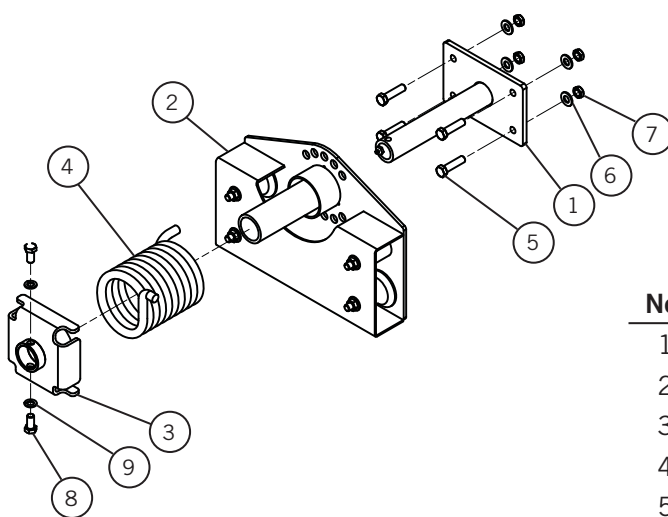

1001-961701 Spring Mount Assembly Rear			
No.	Part No.	Description	Qty
1	1001-960701	Spring Mount Post	1
2	1001-961410	Roller Plate Assembly	1
3	1001-960703	Spring Stop Assy	1
4	1001-861400	SK2 Hub Spring RH	1
5	0810-600002	1/2-13 x 2 Hex Bolt	4
6	0820-680810	1/2 Flat Washer	4
7	0815-660127	1/2-13 NYLOCK Hex Jam Nut	4
8	0810-650553	1/2-13 x 3/4 SHCS	2
9	0820-680820	1/2 Lock Washer	2

Roller Plate Assembly

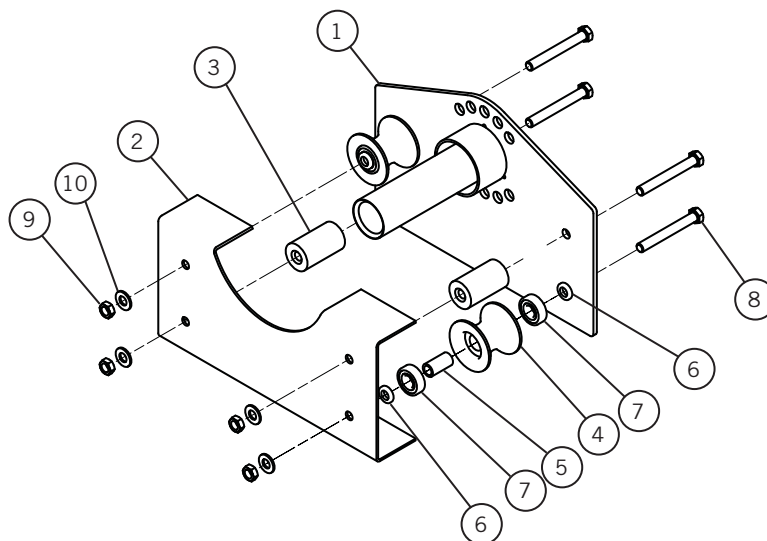

1001-961410 Roller Plate Assembly			
No.	Part No.	Description	Qty
1	1001-960702	Swivel Collar Assembly	1
2	1001-861411	Roller Plate	1
3	1001-861412	Roller Block	2
4	1001-861325	Roller Radius	2
5	1001-861304	Roller Spacer "V"	2
6	1001-861307	Steel Washer	4
7	0710-602144	Bearing .5" ID x 1.575" OD	4
8	0810-650839	1/2-13 x 4 Hex Bolt	4
9	0815-660127	1/2-13 Nylon Jam Hex Nut	4
10	0820-680810	1/2 Flat Washer	4

Front Swing Arm

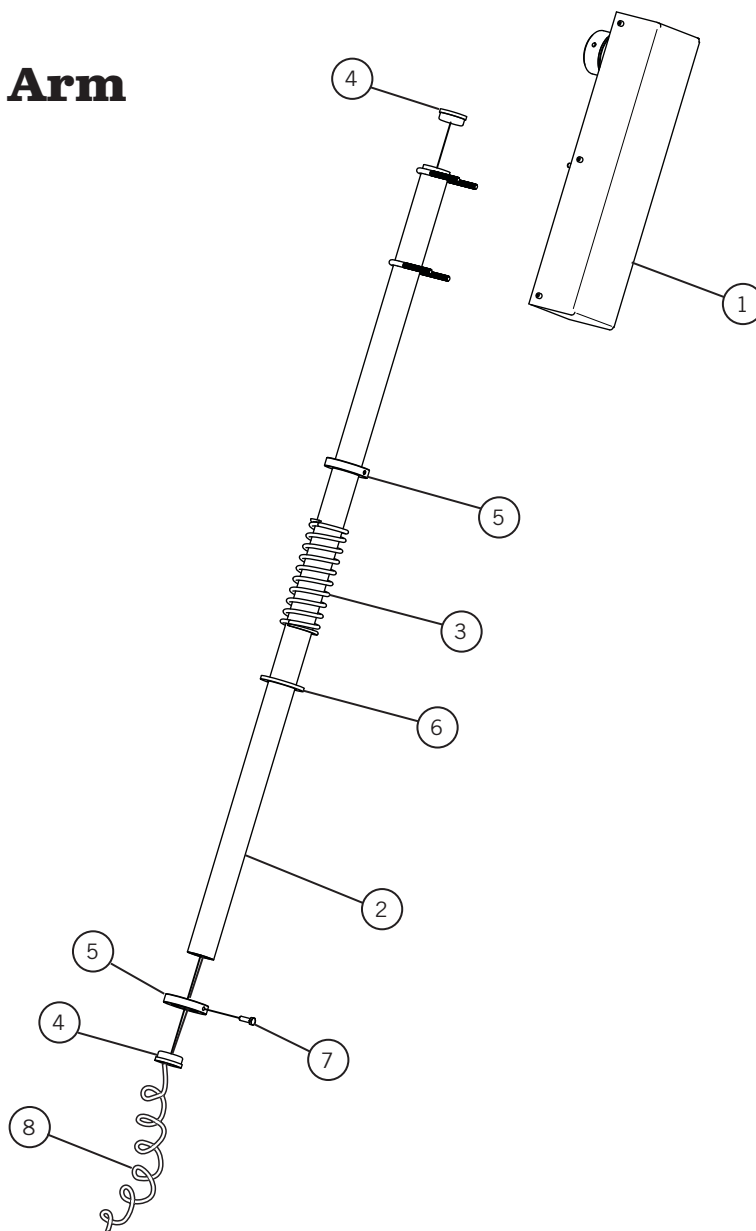

1001-961703 Front Swing Arm			
No.	Part No.	Description	Qty
1	1001-960720	DRIVE BOX UNIT ASSEMBLED (See Page 22)	
2	1440-281635	Steel Tube 2" Rd x 5' Lg	1
3	0715-619405	Compression Spring Jumbo	1
4	1001-861309	Swing Arm Tube Plug	2
5	1001-861316	Collar Lock Swing Arm	2
6	0820-680401	Washer 1/4 x 2 1/4 x 3 1/4	1
7	0810-650170	5/16-18 x 1 Hex Bolt W/Patch	2
8	0755-626433	Flex Cord Motor to Plug	1

Side Kick 2™

Parts List

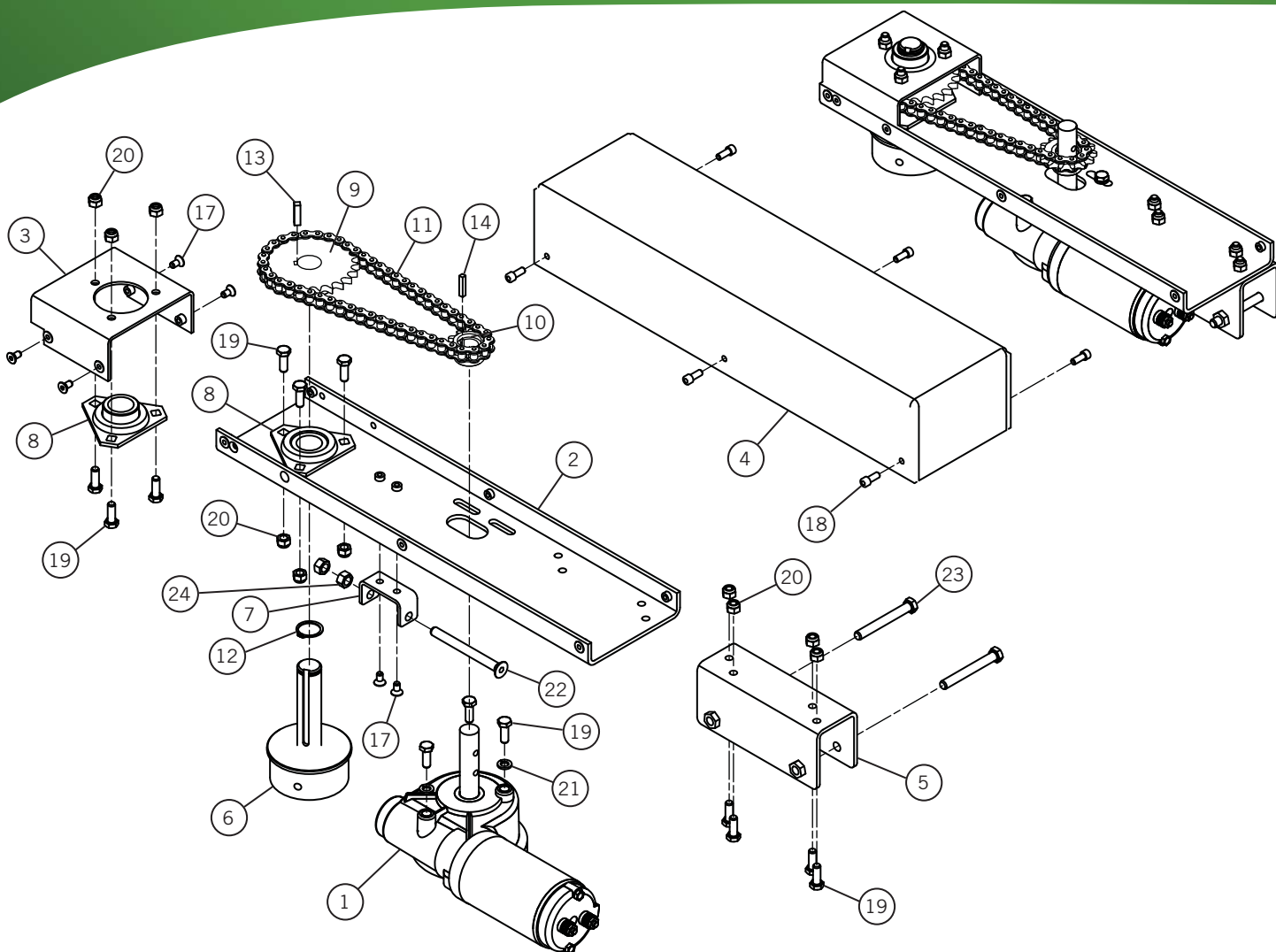

1001-960720 DRIVE BOX UNIT ASSEMBLED

No.	Part No.	Description	Qty	No.	Part No.	Description	Qty
1	0755-623421	Motor RA/SWB	1	14	1001-861736	KEY 3/16 X 3/16 X 1.625	1
2	1001-960710	Drive Mount Channel Assy	1	15	0825-670709	SET SCREW 1/4 X 20 X 1/4	2
3	1001-960711	Bearing Mount Assy	1	16	0825-670710	SET SCREW 1/4" X 28 X 1/4	1
4	1001-861722	Drive Unit Cover	1	17	0810-650497	1/4-20 x 1/2 FHCS	6
5	1001-861729	SWING ARM MOUNT BRKT	1	18	0825-617251	1/4-20 x 5/8 SHCS	6
6	1001-861717	Roll Pipe Adapter	1	19	0810-650552	5/16-18 x 7/8" Hex Bolt	13
7	1001-860774	Chain Tension Bracket	1	20	0815-660550	5/16-18 NYLOCK Hex Nut	10
8	1001-861714	Bearing Set 1" Bore	2	21	0820-680520	5/16 Lock Washer	3
9	1001-861719	Sprocket 40B24 1" Bore	1	22	0810-650496	3/8-16 x 4 FHCS	1
10	1001-861720	Sprocket 40B10 3/4" Bore	1	23	0810-670657	BOLT HHCS 3/8-16x3"	1
11	1001-861721	#40 Roller Chain	1	24	0815-660646	NUT HEX. 3/8-16 ZINC GR 5	2
12	0840-618505	SNAP RING 1" SHAFT	1	25	0755-626504	WIRE END #6 X 1/4 RING	2
13	1001-861723	KEY 1/4" x 1"	1	Items 15, 16, & 25 are not shown.			

Rear Swing Arm

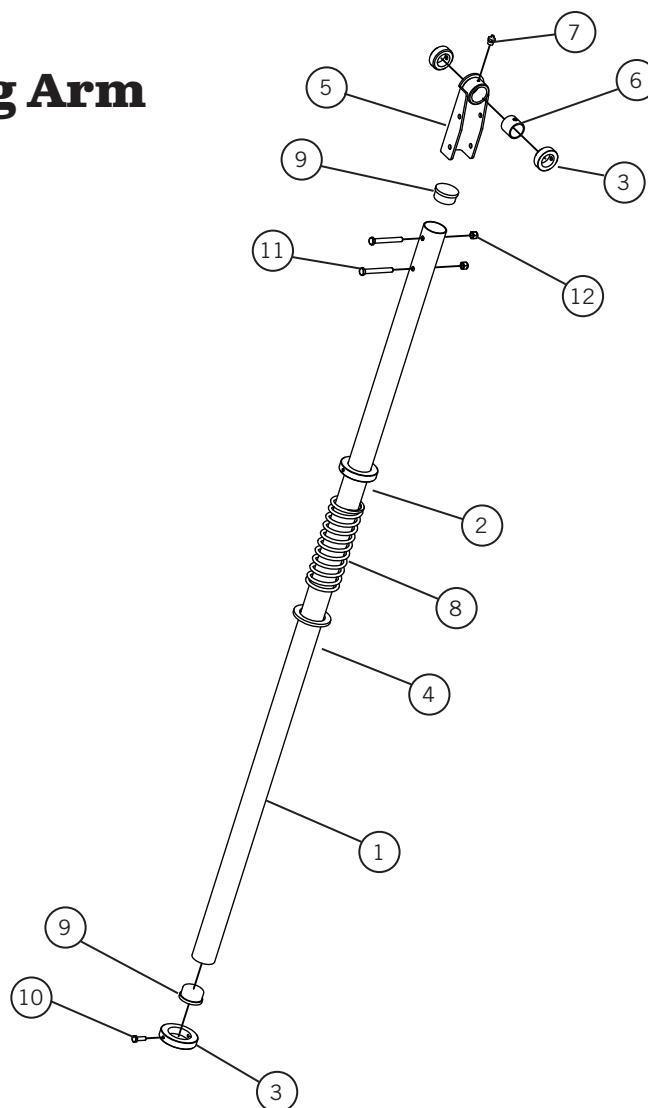

1001-961705 Rear Swing Arm			
No.	Part No.	Description	Qty
1	1440-281636	Steel Tube 2" Rd x 6' Lg	1
2	1001-861316	Collar Lock Swing Arm	2
3	0785-690335	Collar Shaft 1 1/4" ID	2
4	0820-680401	Washer 1/4 x 2 1/4 x 3 1/4	1
5	1001-962122	Motor Mount Bracket Assy	1
6	0845-691233	Bronze Bushing	1
7	0825-670394	Zerk 1/4-28 Straight	1
8	0715-619405	Compression Spring Jumbo	1
9	1001-861308	Swing Arm Tube Plug-Top	2
10	0810-650170	5/16-18 x 1 Hex Bolt W/Patch	2
11	0810-670657	3/8-16 x 3 Hex Bolt	2
12	0815-660660	3/8-16 NYLOCK Hex Nut	2

Electrical

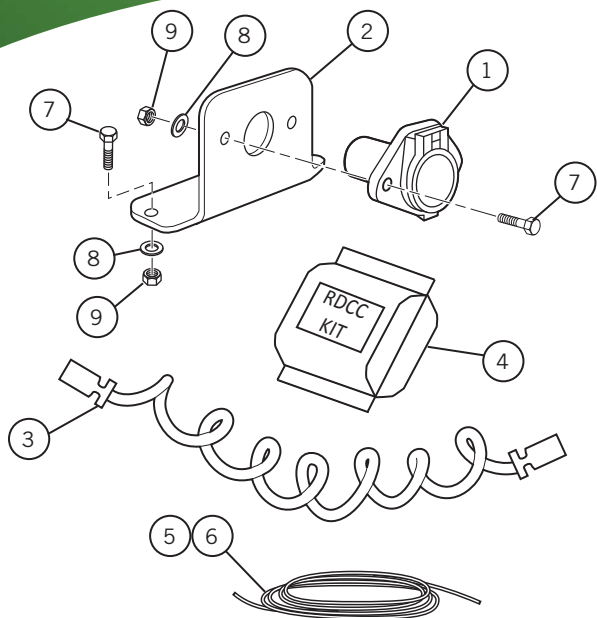

Electrical Hardware			
No.	Part No.	Description	Qty
1	1041-860143	Female Electrical Socket	2
2	1001-860165	Socket Mounting Bracket	2
3	0755-626434	Flex Cord with Plugs	1
4	0755-962108	RDCC Kit	1
5	0755-626540	WIRE 6/2 133/27 BC	20 ft
6	0755-626588	WIRE #14 GRAY	20 ft
7	0810-650552	5/16-18 x 7/8 Hex Bolt	4
8	0820-680510	5/16 Flat Washer	4
9	0815-660461	5/16-18 NYLOCK Hex Nut	4

RDCC Kit 12 V 40 Amp Rocker

0755-962108 RDCC Kit 12 V 40 Amp Rocker

Wire NOT included in Kits

No.	Part No.	Description
1	0755-623560	Reversing DC Contactor
2	0755-623559	DC Contactor Cover
3	0755-962102	Switch Rocker for DC Contactor
4	0755-623501	Circuit Breaker 40 Amp
5	0850-603757	Clamp Metal Loom Plastic
6	0930-861632	Wiring diagram RDCC
7	0755-962111	RDCC Elec Hwd Kit-Rocker

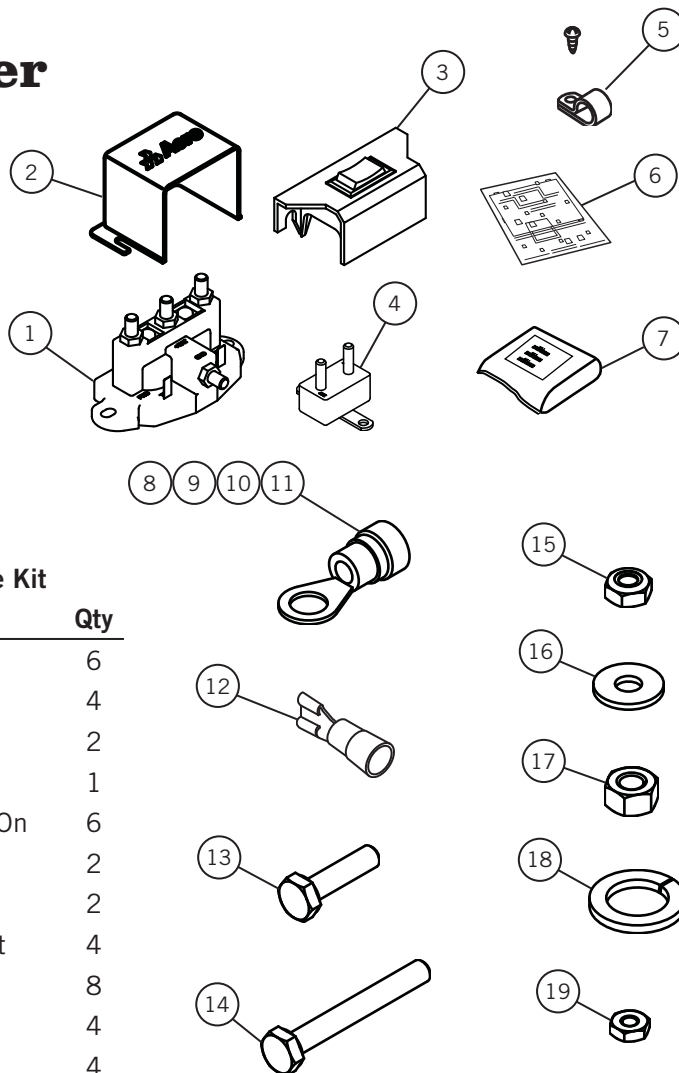

0755-962111 Hardware Kit

No.	Description	Qty
8	Wire End #6 x 3/8 Ring	6
9	Wire End #6 x #10 Ring	4
10	Wire End #6 x 1/4 Ring	2
11	Wire End #14 x 3/8 Ring	1
12	Wire End #14 x 1/4 Push On	6
13	1/4-20 x 1 Hex Bolt	2
14	1/4-20 x 2 Hex Bolt	2
15	1/4-20 Nylon Hex Jam Nut	4
16	1/4 Flat Washer	8
17	5/16-24 Hex Nut	4
18	5/16 Lock Washer	4
19	#10-32 Nylon Hex Nut	4

Side Kick 2™

Parts List

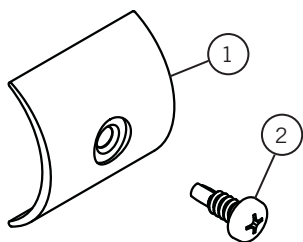

No.	Part No.	Description
1	1040-860129	U-Clamp
2	0825-650540	14 x 1 PPH, Self Drilling

1001-962200 HARDWARE KIT SIDEKICK 2			
No.	Part No.	Description	Qty
1	0755-626504	WIRE END #6 X 1/4 RING	10
2	1001-860774	CHAIN TENSION BRACKET SK2	10
3	1001-861320	TARP STOP - HIGH ROLLER	2
4	0755-623501	CIRCUIT BREAKER 40 AMP V5	4
5	0715-619405	JUMBO COMPRESSION SPRING	2
6	0710-602144	BEARING .5" I.D x 1.575" O.D.	10
7	1001-861725	SPACER NYLON 1" I.D.	16
8	1001-861739	CHAIN OFFSET LINK	10
9	0920-590467	DECAL SIDE KICK WARNING	4
10	0920-590472	DECAL SMALL SK2	4

Swing Arm Mounting (OPTIONAL)

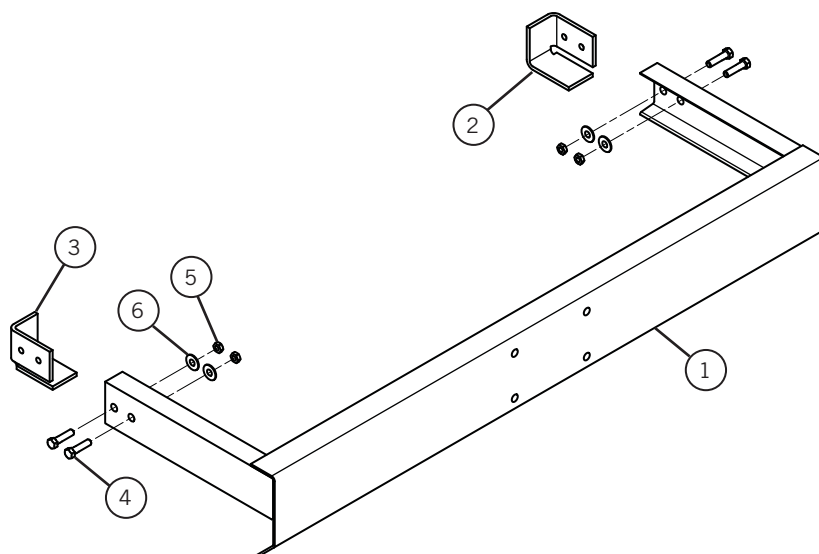

Swing Arm Mounting Hardware			
No.	Part No.	Description	Qty
1	1001-960150	Swing Arm Mounting Bracket	1
2	1001-861189	Mounting Bracket - RH	1
3	1001-861190	Mounting Bracket - LH	1
4	0810-650890	1/2-13 x 1 1/2 Hex Bolt GR2	2
5	0815-660855	1/2-13 NYLOCK Hex Nut	2
6	0820-680812	1/2 Flat Washer	4



INDIANAPOLIS, IN
Indianapolis, IN 46241
800-535-9545
FAX: 317-244-1311

OMAHA, NE
Omaha, NE 68137
800-535-9545
FAX: 402-895-6129

STREETSBORO, OH
Streetsboro, OH 44241
888-237-2262
FAX: 330-626-3277

© 2014 Aero Industries, Inc.

Sidekick is a trademark of Aero Industries, Inc.

Covered by one or more of the following patents in the US: 3692354, 4067601

Canadian patent: 2514605