

READ complete manual CAREFULLY BEFORE attempting operation.

BOLT TORQUE SPECIFICATIONS

Size	Grade	Torque
1/2"	5	75 ft/lbs.
3/4"	5	290 ft/lbs.
20MM	10.9	450 ft/lbs.

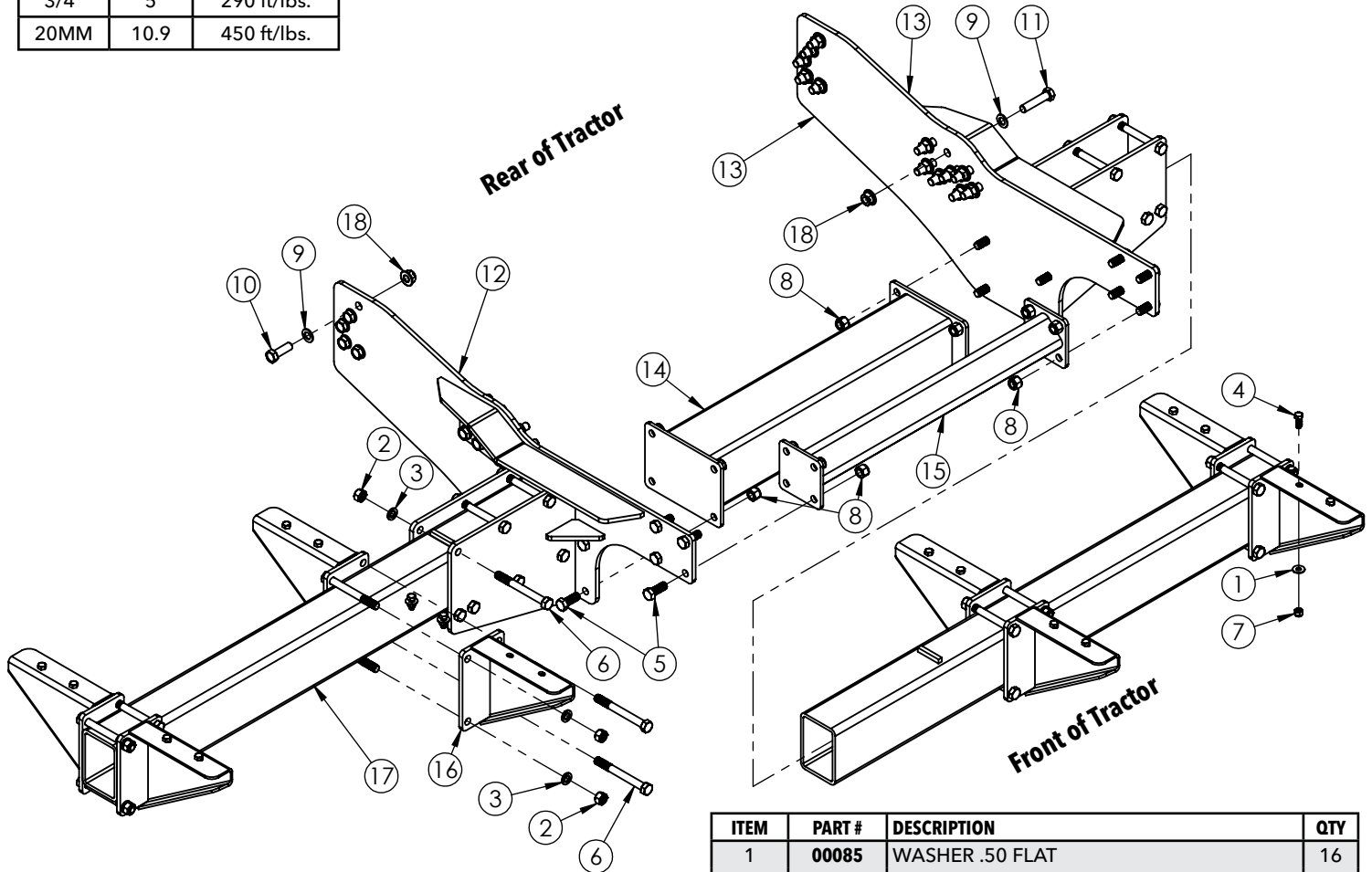

ITEM	PART #	DESCRIPTION	QTY
1	00085	WASHER .50 FLAT	16
2	00253	NUT .75NC HEX	32
3	00254	WASHER .75" LOCK	32
4	00967	BOLT .50NC X 1.25 GR5 HEX	16
5	01235	BOLT .75NC X 2.00 GR5 HEX	16
6	01964	BOLT .75NC X 7.00 GR5 HEX	32
7	02178	NUT .50NC NYLON INSERT LOCK	16
8	02961	NUT .75NC NYLON INSERT LOCK	16
9	07613	WASHER, FLAT, 20MM	26
10	14416	BOLT, M20-2.50 X 60MM GR10.9 HEX	10
11	14651	BOLT, M20-2.50 X 90MM GR10.9 HEX	16
12	16596-76	JOHN DEERE 9R RIGHT SIDE	1
13	16597-76	JOHN DEERE 9R LEFT SIDE	1
14	16598-76	UNDER BELLY SUPPORT	1
15	16599-76	FRONT CROSS SUPPORT	1
16	16600-76	TANK MOUNT SUPPORT	8
17	16601-76	MAIN TUBE SUPPORT	2
18	16603	NUT M20-2.5 LOCK FLANGE HEX	26

This baseplate requires John Deere's front axle support kit. Contact your dealer for more information

Please order replacement parts by PART NO. and DESCRIPTION.