

DEMCO

SIDEQUEST®

John Deere 8 Series PS
AC20111, Rev 1
2/19

READ complete manual CAREFULLY BEFORE attempting operation.

BOLT TORQUE SPECIFICATIONS

Size	Grade	Torque
20MM	10.9	515 ft/lbs.
22MM	10.9	702 ft/lbs.

Note: DEMCO's baseplate kits include wheel bolts for **heavy duty hubs**. For tractors with **standard hubs**, less than 2.31" thick, kit# 6072 is required.

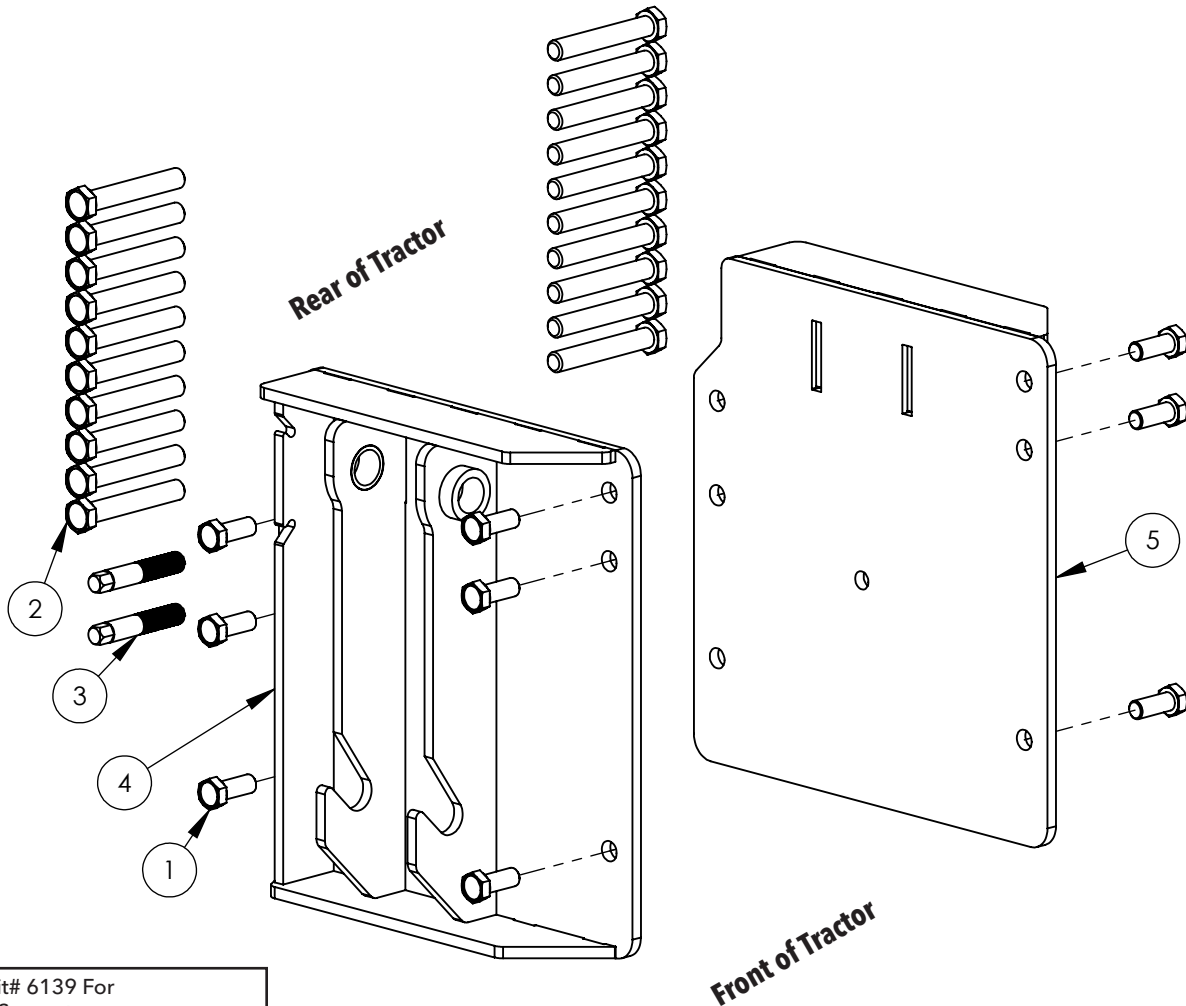

Optional: Kit# 6139 For Fuel/Water Separator

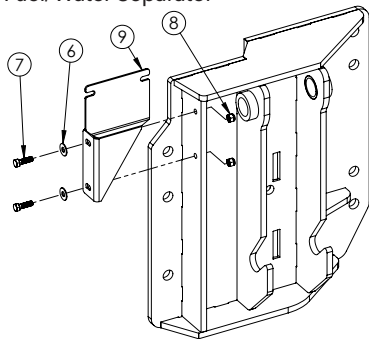

Use 13/32" drill bit and use bracket as drill template. Drill two holes and secure using provided fasteners. Attach filter with existing hardware.

ITEM	PART #	DESCRIPTION	QTY.
1.	03840	Bolt, 20MM-2.50 x 50MM Gr10.9	12
2.	13586	Bolt, 22MM-2.50 x 140MM Gr10.9 (Heavy)	20
-	13222	Bolt, 22MM-2.50 x 120MM Gr10.9 (Std)	20
3.	13919-95	Starter Stud	2
4.	15399-76	Right Baseplate For Deere PS FT4	1
5.	15400-76	Left Baseplate For Deere PS FT4	1
6.	00059	Washer, Flat .375	2
7.	00523	Bolt, .375NC X 1.25 Hex Head Gr5	2
8.	02592	Nut, .375NC Nylon Lock	2
9.	15378-76	John Deere Fuel Filter Bracket	1

Please order replacement parts by PART NO. and DESCRIPTION.

DEMCO

4010 320th Street • Boyden, IA 51234
www.demco-products.com • 800.543.3626