

DEMCO

SIDEQUEST®

John Deere 7R Series
7200R, 7215R, 7230R, 7260R, 7280R

AC20089, Rev 3
2/19

READ complete manual CAREFULLY BEFORE attempting operation.

BOLT TORQUE SPECIFICATIONS

Size	Grade	Torque
3/4"	5	290 ft/lbs.
20MM	10.9	515 ft/lbs.
22MM	10.9	702 ft/lbs.

Note: DEMCO's baseplate kits include wheel bolts for **heavy duty hubs**. For tractors with **standard hubs**, less than 2.31" thick, kit# 6072 is required.

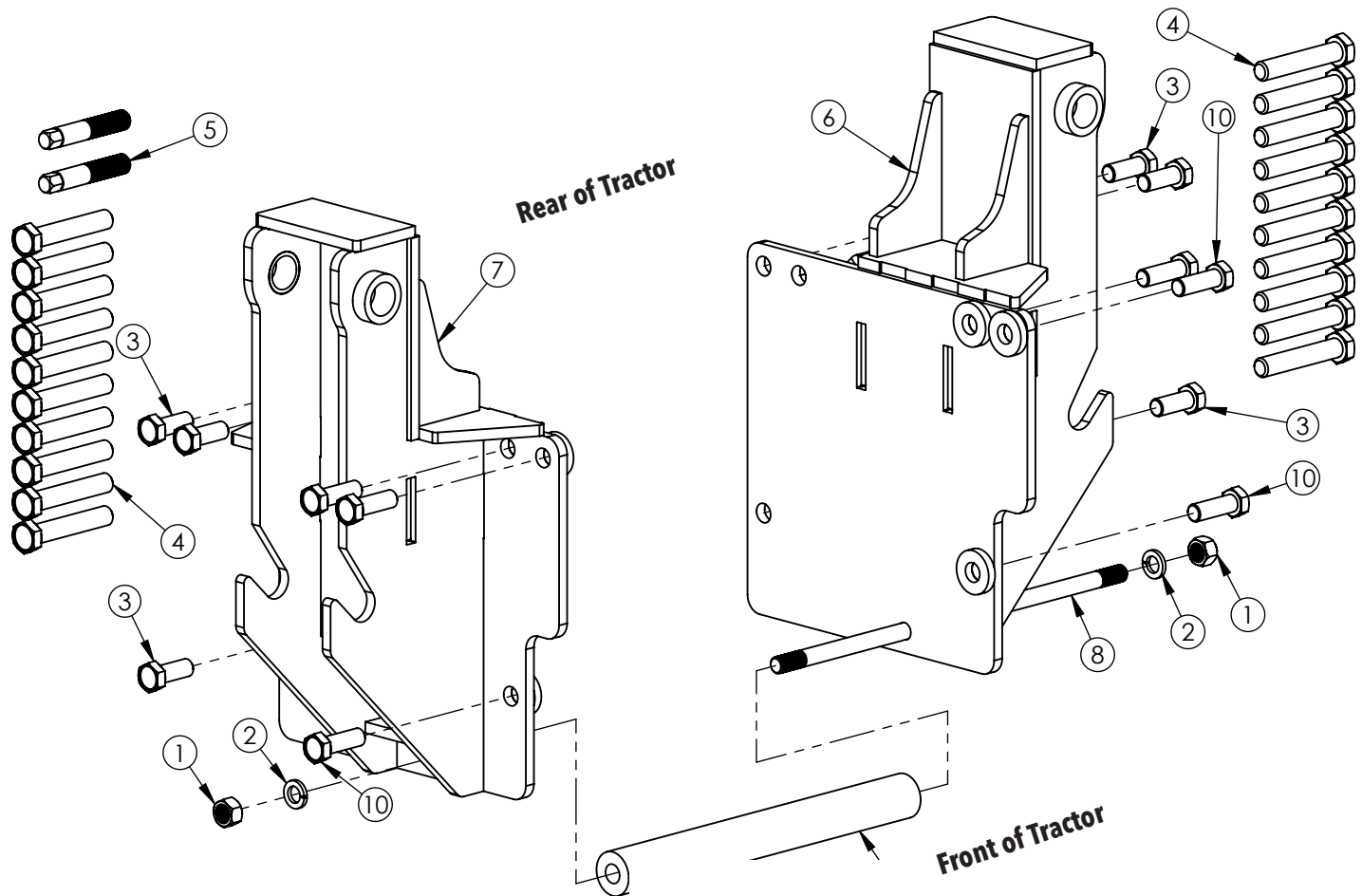

ITEM	PART #	DESCRIPTION	QTY.
1.	00253	NUT, 3/4" HEX	2
2.	00254	WASHER, 3/4" LOCK	2
3.	03840	BOLT, 20MM-2.50 X 50MM GR10.9	6
4.	13222	BOLT, 22MM-2.50 X 120MM GR10.9	20
-	13586	BOLT, 22MM-2.50 X 140MM GR10.9	20
5.	13919-95	STARTER STUD	2
6.	14104-35	LEFT BASEPLATE F/ JD 7000R SERIES	1
7.	14105-35	RIGHT BASEPLATE F/ JD 7000R SERIES	1
8.	14106-95	CROSS SHAFT	1
9.	14107-95	UNDERBELLY TUBE	1
10.	14416	BOLT, 20MM-2.50 X 60MM GR10.9	6

Please order replacement parts by **PART NO.** and **DESCRIPTION.**

BRACKET AND PANEL FIT UP OPTIONS

The SideQuest brackets will fit with the engine compartment panels in place but the panels can not be removed while the brackets attached with out modification. We recommend either remove the panels before attaching the brackets to the tractor or trim the panels as in the examples below.

Left Side

The door in the panel can be removed to check oil but panel must be trimmed to access engine area without removing SideQuest brackets.

Trim 5 inches of the recessed area.

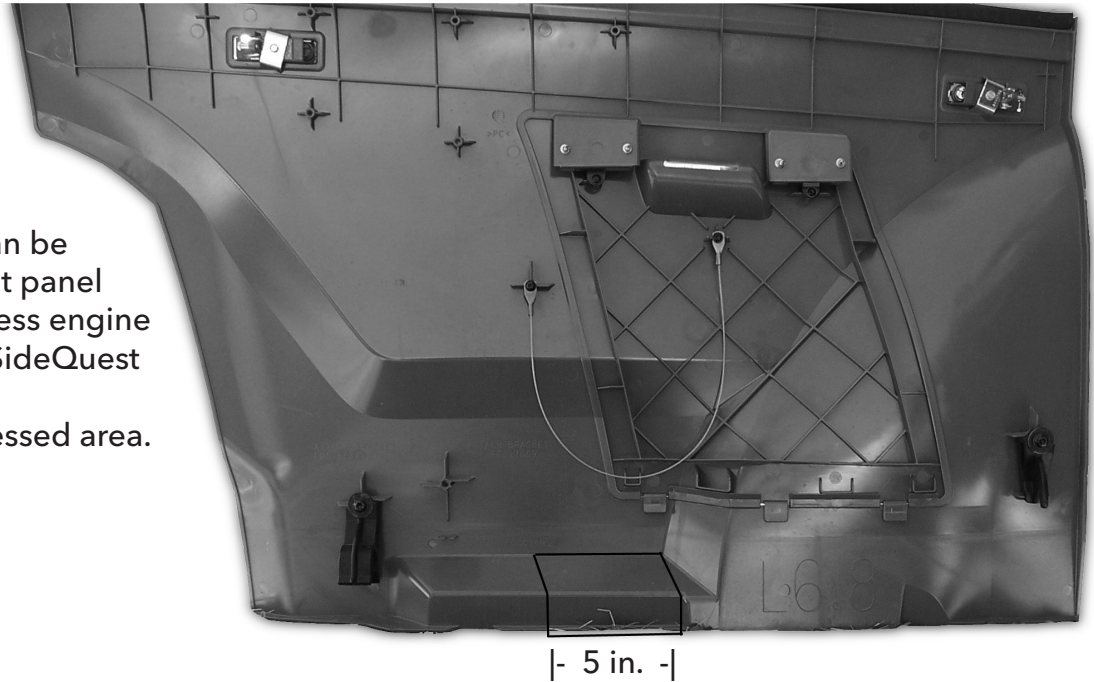

Right Side

The panel must be trimmed to access engine area without removing SideQuest brackets. Trim the recessed area outlined up to the first bracket mount.