

# Demco QUICK TACH INLINE MOUNTING BRACKETS

12-11  
AC20084,rev1

## CASE IH

7110, 7210, 8910,  
7120, 7220, 8920,  
7130, 7230, 8930,  
7140, 7240, 8940,  
7150, 7250, 8950

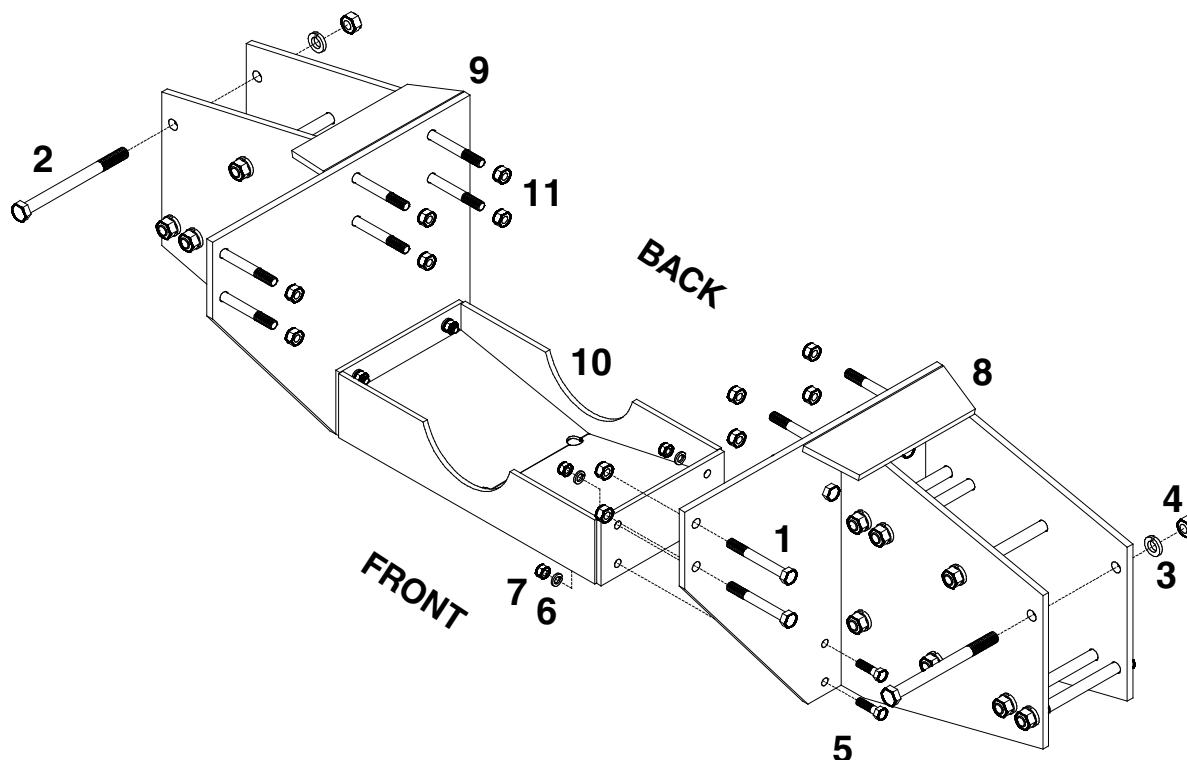

### ASSEMBLY REPLACEMENT PARTS

REF. PART NO.	PART NO.	QTY.	DESCRIPTION
1.	01336	12	5/8"-11UNC x 5" Hex Head Bolt (Gr.5)
2.	07681	16	3/4"-10UNC x 9" Hex Head Bolt (Gr.5)
3.	00254	16	3/4" Lockwasher
4.	00253	16	3/4"-10UNC Hex Nut
5.	00482	8	1/2"-13UNC x 1 3/4" Hex Hd Bolt (Gr.5)
6.	00084	8	1/2" Lockwasher
7.	00083	8	1/2"-13UNC Hex Nut
8.	10043-35	1	Mounting Bracket (Left Side)
9.	10044-35	1	Mounting Bracket (Right Side)
10.	10045-35	1	Spacer Assembly
11.	02587	12	5/8"-11UNC Nylon Insert Locknut

### BOLT TORQUE SPECIFICATIONS

STANDARD BOLTS:			METRIC BOLTS:	
Size	Grade	Torque	Size	Torque
5/8"	5	150 ft/lbs.	20mm	515 ft/lbs.
3/4"	5	290 ft/lbs.		

**READ complete manual CAREFULLY  
BEFORE attempting operation.**

Please order replacement parts by **PART NO.** and **DESCRIPTION.**

DEMCO • 4010 320th Street • P.O. Box 189 • Boyden, IA 51234

PH: (712) 725-2311 • Toll Free: 1-800-543-3626 • FAX: (712) 725-2380 or 1-800-845-6420

www.demco-products.com