

# SIDEQUEST<sup>®</sup>

by Demco

12-11  
AC20069, rev1

**John Deere  
8000 Track**

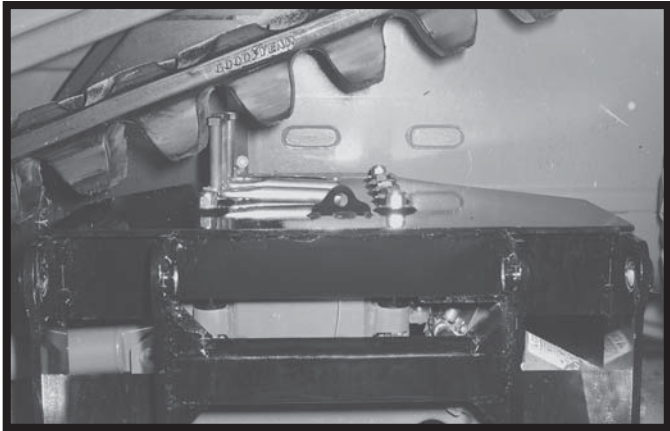

## Installation John Deere 8000 Track

Use any three holes in a row of the five holes depending on the track width. When position is determined remove every other bolt of the six bolts in the track mount, that will match up with the three bolts (#5) in the bracket. Repeat for other side of track mounting. On the row of bolts to the front of the tractor, hold bolts in bracket up to just short of flush of the bottom of bracket, secure in that position with vice grips. Also adjust track so bolts will miss lugs. Then slide in place and tighten all bolts. See diagram.

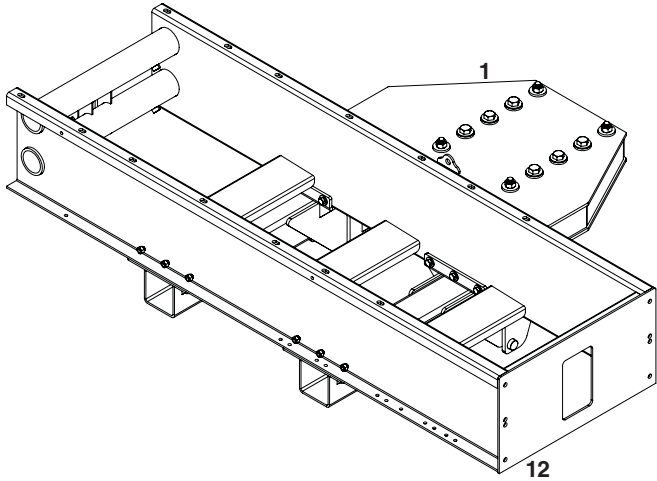
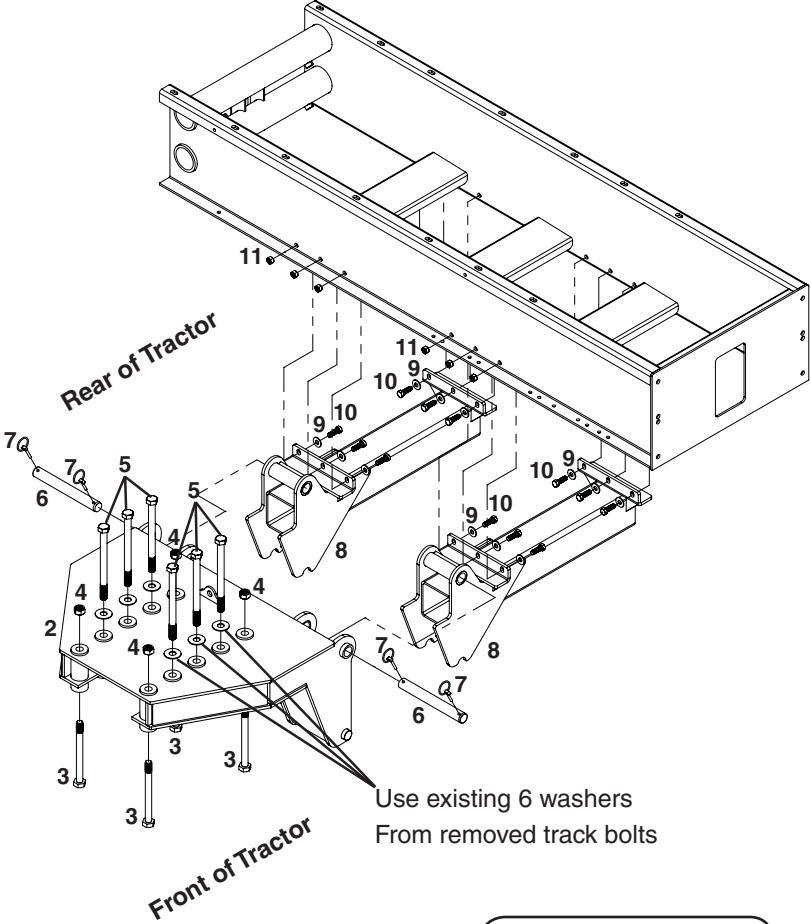

**ASSEMBLY  
REPLACEMENT PARTS**

REF. NO.	PART NO.	QTY.	DESCRIPTION
1.	12315-35	1	Right Baseplate for Sidequest
2.	12316-35	1	Left Baseplate for Sidequest
3.	02851	8	3/4"NC x 8-1/2 Hex Head Bolt (Gr. 5)
4.	02961	8	3/4"NC Nylon Insert Lock Nut
5.	12317	12	20mm-2.5 x 250mm Hex Bolt
6.	12186-95	4	Top Pin 1-1/4" x 10-1/4
7.	02397	8	Lynch Pin
8.	12185-35	4	Extension Arm
9.	00085	24	1/2" Flat Washer
10.	01254	24	1/2"NC x 1-1/2 Hex Head Bolt (Gr. 5)
11.	02178	24	1/2"NC Nylon Insert Lock Nut

BOLT TORQUE SPECIFICATIONS					
STANDARD BOLTS:			METRIC BOLTS:		
Size	Grade	Torque	Size	Grade	Torque
1/2"	5	75 ft/lbs.	20mm	5	515 ft/lbs.
3/4"	5	290 ft/lbs.			

**READ complete manual CAREFULLY  
BEFORE attempting operation.**

Please order replacement parts by **PART NO.** and **DESCRIPTION.**