

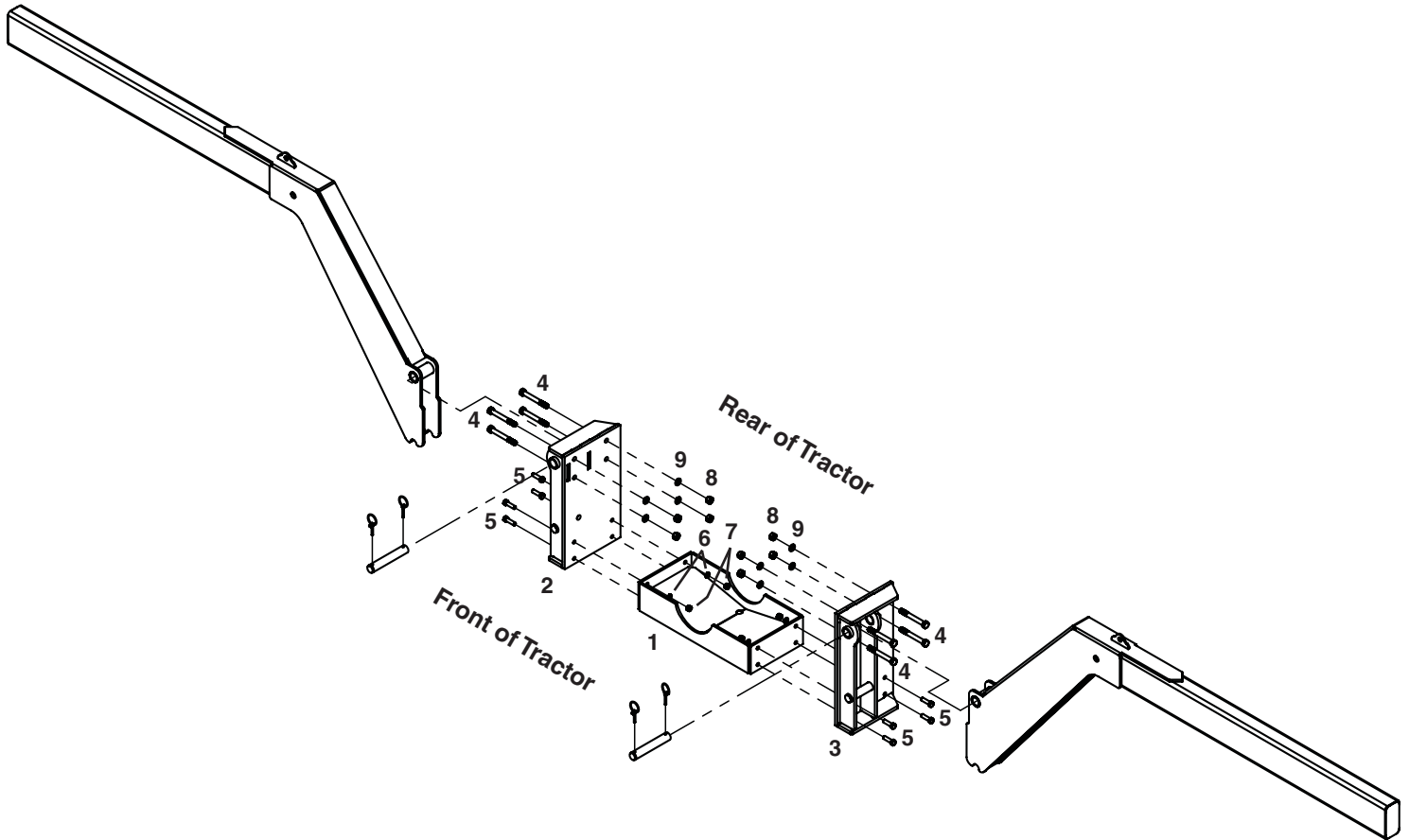

CASE IH MAG
7100, 7200, 8900



NOTE: Make sure that the bolts do not come in contact with the hydraulic lines on inside of frame.

BOLT TORQUE SPECIFICATIONS		
STANDARD BOLTS:		
Size	Grade	Torque
1/2"	5	75 ft/lbs.
5/8"	5	150 ft/lbs.

READ complete manual CAREFULLY BEFORE attempting operation.

ASSEMBLY REPLACEMENT PARTS

REF. PART NO.	PART NO.	QTY.	DESCRIPTION
1.	10045-35	1	Spacer Assembly
2.	12649-35	1	Right Baseplate for Sidequest
3.	12650-35	1	Left Baseplate for Sidequest
4.	01336	8	5/8"NC X 5" GR5 Hex Bolt
5.	00482	8	1/2"NC X 1-3/4" GR5 Hex Bolt
6.	00084	8	1/2" Lockwasher
7.	00083	8	1/2"NC Hex Nut
8.	00291	8	5/8"NC Hex Nut
9.	00248	8	5/8" Lockwasher

Please order replacement parts by **PART NO.** and **DESCRIPTION.**