



Doing Our Best to Provide You the Best

8C000002, Rev A
02/24

SIDE DUMP TRUCK BOXES

9CCRTB14, Truck Box Kit, 14'

9CCRTB15, Truck Box Kit, 15'

9CCRTB16, Truck Box Kit, 16'

9CCRTB17, Truck Box Kit, 17'

9CCRTB20, Truck Box Kit, 20'

9CCRTB24, Truck Box Kit, 24'



OPERATOR MANUAL

Product Disclaimer.....	3
Introduction.....	4
To the Dealer Checklist.....	6
To the Owner.....	7
Truck Box Specifications and Features.....	8
Safety.....	9
Maintenance Safety.....	12
Safety Decals/Reflectors.....	13
Tub Operating Instructions.....	15
Maintenance.....	17
Inspection and Maintenance Checklists.....	18
Electrical System.....	19
Light Kit (If Equipped).....	20
Hydraulic System.....	23
Hydraulic Cylinders and Bottom Cylinder Pins.....	24
Hydraulic Parts.....	25
Pivot Latch Parts.....	27
Tub Parts.....	28
Frame Parts.....	30
Model Specific Parts.....	32
Remote Grease Zerk Parts.....	33
Roll-Rite Electric Tarp (Option).....	34
Aero Electric Tarp (Option).....	47
Tarp Tips.....	48
Trailer Pro, Electric Over Hydraulic Kit.....	49
Trailer Pro, Installation/Operating Instructions.....	53
General Troubleshooting.....	54

In this document you will find information based on available knowledge at the time of its publication. To be accurate with the information, every effort was made but may not cover all details or variations of a trailer or provide every possibility in connection with its production, operation and maintenance. A Feature and Option may be presented in the manual that is not relevant to this trailer. Demco assumes no obligation of notice, to holders of this document, with changes made to a product.

SPECIFICATIONS AND DESIGN ARE SUBJECT TO CHANGE WITHOUT NOTICE.

Demco is often making improvements and developing new designs. In doing so, we reserve the right to make changes and/or improvements without obligation for equipment sold beforehand. Self-modification to our trailers may affect the operation, function, and safety, so this is not advised. If a replacement part is necessary, Demco should supply it, please contact your nearest dealer or Demco.

DEMCO STATEMENT OF PRODUCT SAFETY:

As a producer of agricultural and transportation equipment, Demco is fully aware of its responsibility of providing its customers products that perform their expected use, in a truly safe manner. Safety considerations shall be a fundamental and high precedence part of all engineering/design analysis and judgments involving Demco products. It is our stated policy that our products will be manufactured to coincide with the safety standards specified by the National Association of Trailer Manufacturers and/or any other officially recognized standards at the time manufactured. However, this statement should not be translated to mean that our product will uphold against a customer's own carelessness or disregard for common safety practices specified in each product's manual, nor will we be accountable for any such occurrence.

INTRODUCTION

At Demco we strive to design, produce and deliver the highest quality trailer on the market. Our employees have a strong background of knowledge and combined experience in manufacturing to put quality workmanship into our products. In this manual you will find information covering all models of the Demco Side Dump Truck Box line. Use the table of contents to locate specific areas of interest.

GENERAL INFORMATION

Demco requires that you and anyone else who will be operating and maintaining the truck box read and understand the guidelines in the manual for safe, efficient, and trouble free operations. Proper maintenance, adjustments and use will result in many years of service. Keep this manual handy for frequent reference and to pass on to new operators or owners. If assistance, information, or additional copies of the manual are needed, contact the nearest dealer, a distributor, or Demco.

PLEASE NOTE

- All documents within the manual referring to products not manufactured by Demco have been printed with the permission of the manufacturer specified.
- All references to driver, passenger, front and rear of the trailer are determined from a position behind the trailer and facing forward.

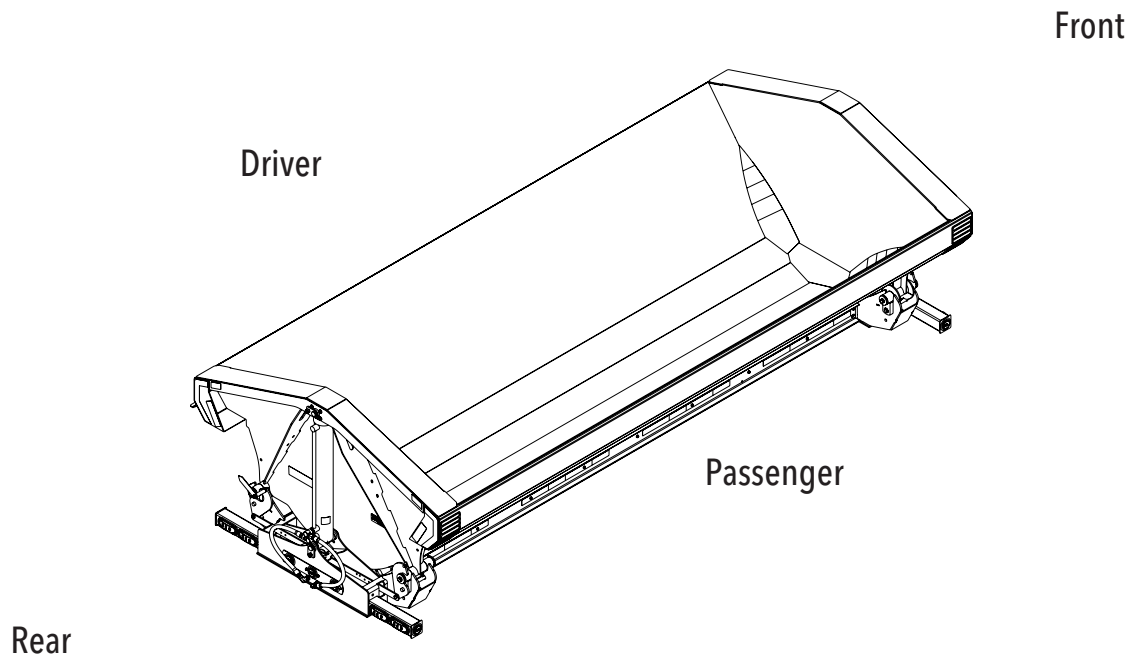

WARRANTY POLICIES

Please go online to review Demco Warranty Policies. The warranty information is located at www.demco-products.com/resources/warranty-policies.

The Demco Warranty does not cover the following:

- 1) Cleaning, transporting, mailing and service call charges.
- 2) Depreciation or damage caused by normal wear, accidents, improper protection or improper use.

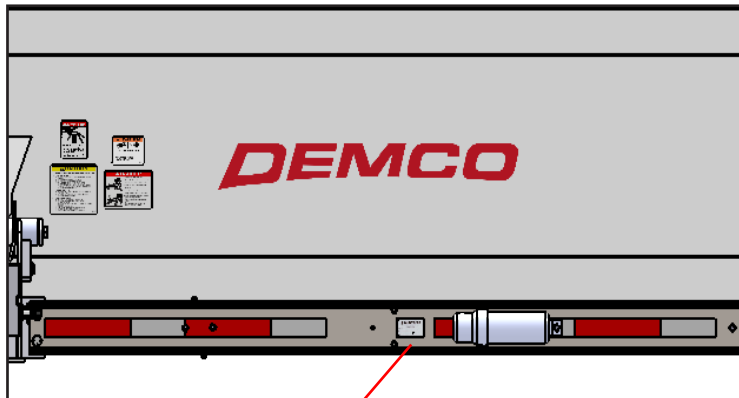

Serial Number

In addition to the VIN number Demco has placed a coded unit number on the chassis and the tub. Please contact Demco at 1-800-247-6010 if you need assistance locating these numbers.

Record your trailer model and serial number in the space provided below. You will need this to register your product warranty. Your dealer will also need this information to provide prompt, efficient service when ordering parts.

MODEL NO. _____
SERIAL NO. _____
DATE PURCHASED _____

Pre-Delivery Checklist

Inspect the truck box thoroughly after shipment to be certain it is functioning properly before delivering it to the customer. The following checklist is a reminder of points to cover. Check off each item as it is found satisfactory or after proper adjustment is made.

- 1. All hardware properly tightened
- 2. Lubrication of grease fittings
- 3. All decals properly located and readable
- 4. Lights function properly
- 5. Air lines tight and no pinched lines
- 6. Overall condition (touch up any scratches, clean and polish)
- 7. Operator's manual included

Date Delivered: _____

Signature of Salesman or Technician: _____

Delivery Checklist

Review the operator's manual with the customer. Explain the following:

- 1. Safe operation and service
- 2. Correct trailer operation
- 3. Daily and periodic lubrication and maintenance
- 4. Daily and periodic inspections
- 5. Trouble shooting
- 6. Storing truck box
- 7. Demco parts and service policies
- 8. Have the customer write the truck box model and serial number in space provided in manual introduction.
- 9. Give customer the operator's manual and encourage the customer to read the manual carefully.
- 10. Customer to complete warranty registration on Demco's website.

Date Delivered: _____

Signature: _____

Model No: _____

Serial No: _____

Thank you for your recent purchase of a New Demco Side Dump Truck Box. We're "Doing Our Best To Provide You The Best". However, in the event that a problem does occur, it is imperative that your warranty registration is on file so we can accurately respond to your specific circumstances. You will need the Model Number, Serial Number and Date of Purchase. (Space is provided on page 5 to record this information.)

**Register
Warranty
One of
Two Ways**

We have two easy ways to register your warranty:

- **Call our toll free number and ask for warranty registration.
1-888-274-6010**
- **Register on-line at:
www.demco-products.com/resources/product-registration**



Manuals and Assistance

This manual has been prepared to assist you in the operation of your new truck box and contains information pertaining to safety and operations.

Demco personnel are available to assist you if questions arise concerning the maintenance or operations of your truck box. 1-800-54DEMCO (800-543-3626).

To order any parts or additional options for your truck box, please contact your dealer or view our online manuals at: www.demco-products.com

- Current manuals are listed in | Semi Trailers | Side Dump Trailers | Side Dump Truck Boxes | Manuals (at the bottom of the page)
- Older manuals are listed in | Resources | Archived Manuals

TRUCK BOX SPECIFICATIONS AND FEATURES

1. Tub dump direction indicators visible in truck mirrors.
 2. Four integrated tub pivot points with greaseless pivot bearings.
 3. Tub dump direction controlled from the left side. No need to walk around the trailer to change dump direction.
 4. 1/4" AR450 Tub with exclusive "Flex Corner" design. (3/16" AR450 Available)
 5. Large Single "G" Rail on Tub. Lighter and Stronger than two rail systems.
 6. Hydraulic System: 3000 psi rated 3/4" Hoses, Fittings, Flow Divider, and Relief Valve.
 7. Twin 3000 psi rated 5" Cylinders.
 8. Standard LED lights in enclosed boxes with sealed plugs.
 9. Other Available Options:
 - Custom Paint Colors
 - Roll-Rite and Aero Electric Tarps
 - Remote Grease Zerks for Hydraulic Cylinders
 - 6" Hydraulic Dump Cylinders
 - Trailer Mounted EOH (electric over hydraulic) Control Valve
- *Consult your dealer or online brochure for more details.

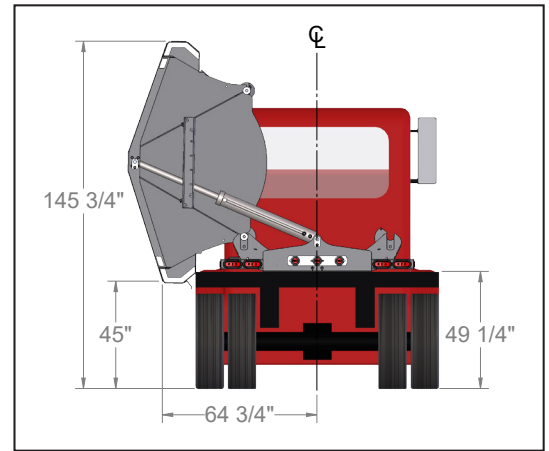

TRUCK BOX LENGTH	DIM "A"	DIM "B"	DIM "C"	DIM "D"
14'	18'-1/2"	16'-1"	14'-0"	15'-8"
15'	19'-1/2"	17'-1"	15'-0"	16'-8"
16'	20'-1"	18'-2"	16'-1"	17'-8"
17'	21'-1/2"	19'-1"	17'-0"	18'-8"
20'	24'-1"	22'-2"	20'-1/2"	21'-8"
24'	28'-1"	26'-2"	24'-1/2"	25'-8"

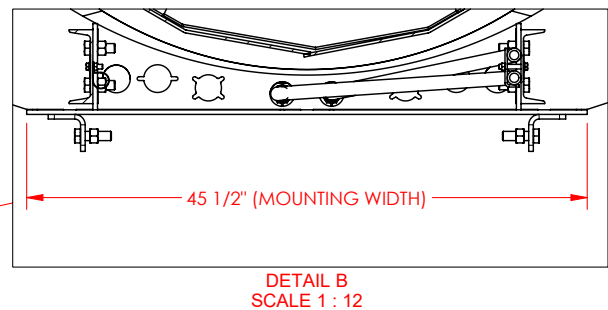
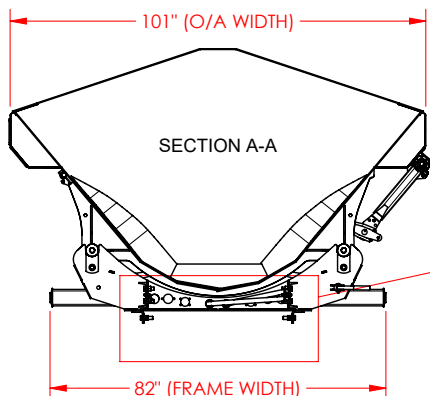
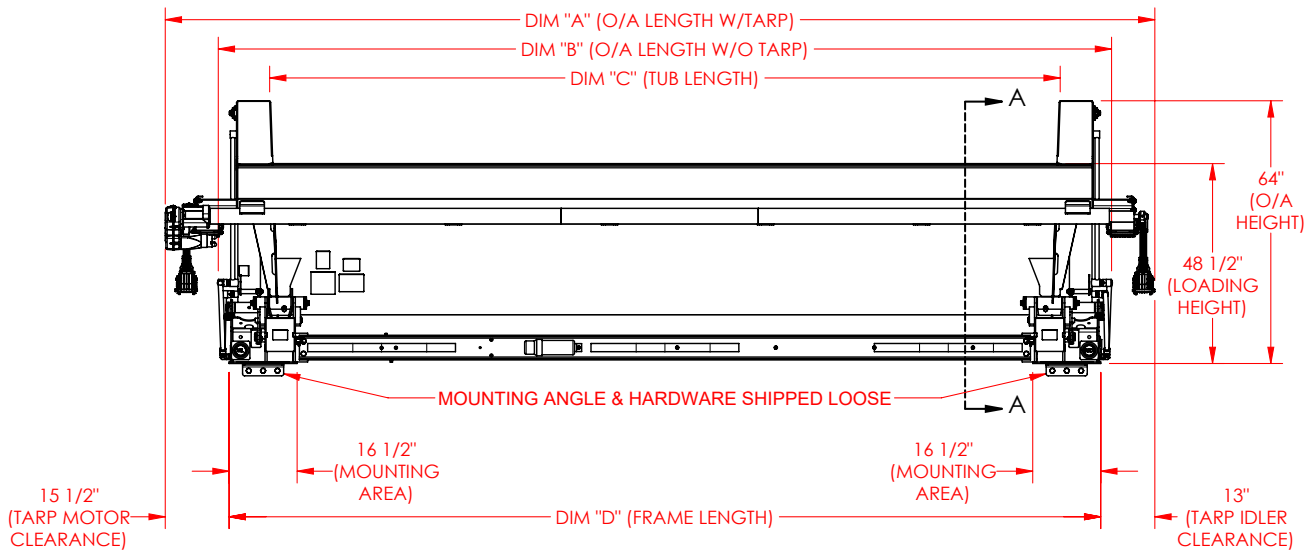

**RECOGNIZE SAFETY INFORMATION**

This is the safety-alert symbol. When you see this symbol on your machine or in this manual, be alert to the potential for personal injury. Follow recommended precautions and safe operation practices.

**FOLLOW SAFETY INSTRUCTIONS**

- Carefully read all safety messages in the manual and on your machine safety signs.
- Keep safety signs in good condition.
- Replace missing or damaged safety signs.
- Learn how to operate the machine and how to use controls properly.
- Do not let anyone operate without instruction.
- Keep your machine in proper working condition.
- Unauthorized modification to the machine may impair the function and/or safety and affect machine lift.

**PROTECT CHILDREN AND BYSTANDERS**

- Before you back, LOOK CAREFULLY behind for children.
- Clear area of children, pets and bystanders.

**ADOPT SAFE DRIVING PRACTICES**

- Always drive at a safe speed relative to local conditions and ensure that your speed is low enough for an emergency stop to be safe and secure. Keep speed to a minimum.
- Reduce speed prior to turns to avoid the risk of overturning.
- Avoid sudden uphill turns on steep slopes.
- Always keep the tractor or towing vehicle in gear to provide engine braking when going downhill. Do not coast.
- Do not drink and drive.
- Comply with state and local laws governing highway safety and movement of equipment on public roads.
- Use approved accessory lighting and necessary warning devices to protect operators of other vehicles on the highway during daylight and nighttime transport.



HIGHWAY AND TRANSPORT OPERATIONS

- Plan your route to avoid heavy traffic.
- Be a safe and courteous driver. Always yield to oncoming traffic in all situations, including narrow bridges, intersection, etc.
- Be observant of bridge loading ratings. Do not cross bridges rated lower than the gross weight at which you are operating.
- Always operate the tractor trailer in a position to provide maximum visibility at all times. Make allowances for increased length and weight of the equipment when making turns, stopping the unit, etc.



AVOID HIGH PRESSURE FLUIDS

- Escaping fluid under pressure can penetrate the skin causing serious injury.
- Avoid the hazard by relieving pressure before disconnecting hydraulic or other lines. Tighten all connections before applying pressure.
- Search for leaks with a piece of cardboard.
- Protect hands and body from high pressure fluids.
- If an accident occurs, see a doctor immediately.



DISPOSE OF FLUIDS PROPERLY

- Improperly disposing of fluids can harm the environment and ecology. Before draining any fluids, contact your local environmental agency for the proper waste disposal methods.
- Use proper container when draining fluids. **DO NOT** use food or beverage containers that may mislead someone into drinking from them.
- **DO NOT** pour oil into the ground, down a drain, or into a stream, pond, or lake. Observe relevant environmental protection regulations when disposing of oil and other harmful waste.





**THIS SYMBOL MEANS:
ATTENTION!
BECOME ALERT!
YOUR SAFETY IS
INVOLVED!**

TAKE NOTE! THIS SAFETY ALERT SYMBOL FOUND THROUGHOUT THIS MANUAL IS USED TO CALL YOUR ATTENTION TO INSTRUCTIONS INVOLVING YOUR PERSONAL SAFETY AND SAFETY OF OTHERS. FAILURE TO FOLLOW THESE INSTRUCTIONS CAN RESULT IN INJURY OR DEATH!

SIGNAL WORDS

Note use of following signal words **DANGER**, **WARNING**, and **CAUTION** with safety messages. The appropriate signal word for each has been selected using the following guidelines:

DANGER: Indicates an imminently hazardous situation that, if not avoided, will result in death or serious injury. This signal word is to be limited to most extreme situations typically for machine components which, for functional purposes, cannot be guarded.

WARNING: Indicates a potentially hazardous situation that, if not avoided, could result in death or serious injury, and includes hazards that are exposed when guards are removed. It may also be used to alert against unsafe practices.

CAUTION: Indicates a potentially hazardous situation that, if not avoided, may result in minor or moderate injury. It may also be used to alert against unsafe practices.

EQUIPMENT SAFETY GUIDELINES

Every year many accidents occur which could have been avoided by a few seconds of thought and a more careful approach to handling equipment. You, the operator, can avoid many accidents by observing the following precautions in this section. To avoid personal injury, study the following precautions and insist those working with you, or you yourself, follow them.

Operator should be a responsible adult. **DO NOT ALLOW PERSONS TO OPERATE THIS UNIT UNTIL THEY HAVE DEVELOPED A THOROUGH UNDERSTANDING OF SAFETY PRECAUTIONS AND HOW IT WORKS.**

DO NOT modify the trailer in anyway. Doing so may impair the function and/or safety and could affect the life of the trailer.

Never exceed the maximum capacity of the trailer. By doing so you risk damage to your Demco trailer. If it's ability to do a job, or to do so safely is in question **DON'T TRY IT.**

Review safety instructions with all users annually.

Replace any caution, warning, danger or instruction safety decal that is not readable or is missing. Location of such decals is indicated in this booklet.

Do not paint over, remove, or deface any safety signs or warning decals on your equipment. Observe all safety signs and practice instructions on them.

Working on Hydraulic Systems

⚠ DANGER: Clear area around trailer of bystanders before raising tub.

⚠ DANGER: Do not perform maintenance on tub body without physically blocking body and cylinders to prevent lowering.

⚠ DANGER



To prevent serious injury or death:
 • Before performing maintenance between the frame rails, the trailer should be hooked to tractor on a level surface, fully dumped, then hydraulic hoses uncoupled.
 • If service requires the tub to be partially dumped refer to owner's manual for proper safety procedures.

Before performing maintenance between the frame rails, the trailer should be hooked to tractor on a level surface, fully dumped, then hydraulic hoses uncoupled.

If service requires the tub to be partially dumped follow the proper safety procedures.

1. Make two tub braces using 1/4" x 3" x 3" angle iron.
2. Raise tub and insert angle iron over cylinder rod on each end. (See Photo)
3. After tub is secured in raised position:
 - a. Disengage the PTO; relieve the pressure from the hydraulic system by jogging control valve both directions to relieve pressure from the system.
 - b. When working on hydraulic systems, **EXTREME** caution must be used to avoid injuries from high pressure or hot oil.
 - c. Never attempt to work on loaded trailer.

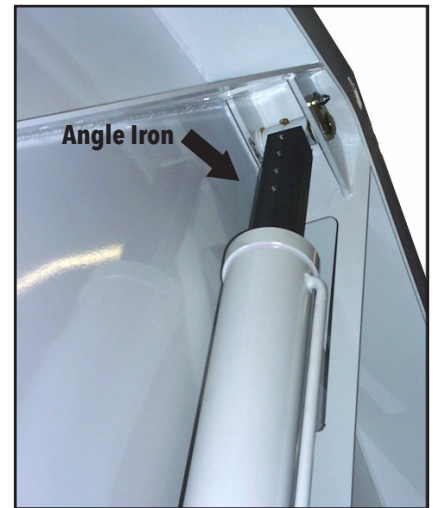

1/4" x 3" x 3" Angle Iron
(20" Min. Length)

WARNING: Hydraulic fluid escaping under pressure can have enough force to penetrate the skin. Hydraulic fluid may also infect a minor cut or opening in the skin. If injured by escaping fluid, see doctor at once. Serious infection or reaction can result if medical treatment is not given immediately. Make sure all connections are tight and that hoses and lines are in good condition before applying pressure to the system. Relieve all pressure before disconnecting the lines or performing other work on the hydraulic systems.

Tub and Frame Inspections

An important phase of the truck box upkeep and maintenance is the inspection and repair, if any, of all structural steel members of the truck box frame and tub. It is readily apparent that the frame and tub must be one solid unit to carry the load safely and quickly without danger of accident or further damage to the trailer. This also prevents subsequent major repair, cost and trailer down time.

The need for a complete frame and tub inspection stems from various reasons:

- Truck box loaded to maximum rated capacity, or greater.
- Rough handling may also cause structural failures of varying degrees. The failures are the results of metal fatigue due to flexing, twisting, distortion.

Frame and tub failure will show up in the steel frame members as weld cracks, cracked and loosened steel sections.

To detect any fractures before they become major failures:

- Once a month thoroughly inspect the truck box for any sign of failure and correct any defects.
- It is desirable to have the truck box completely washed down so all the joints and welds may be closely viewed.

IMPORTANT

Install new safety decals and reflectors if the old decals and reflectors are destroyed, lost, painted over or cannot be read. When parts are replaced that have decals or reflectors, make sure you install a new decal with each new part.

1AQAP2914



1AQAP4361

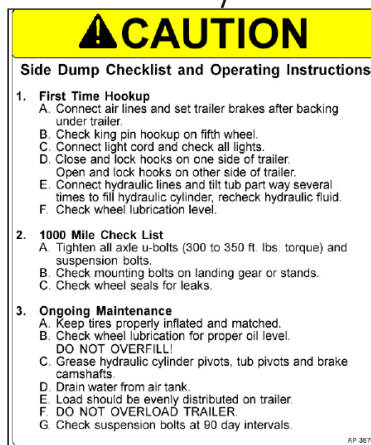
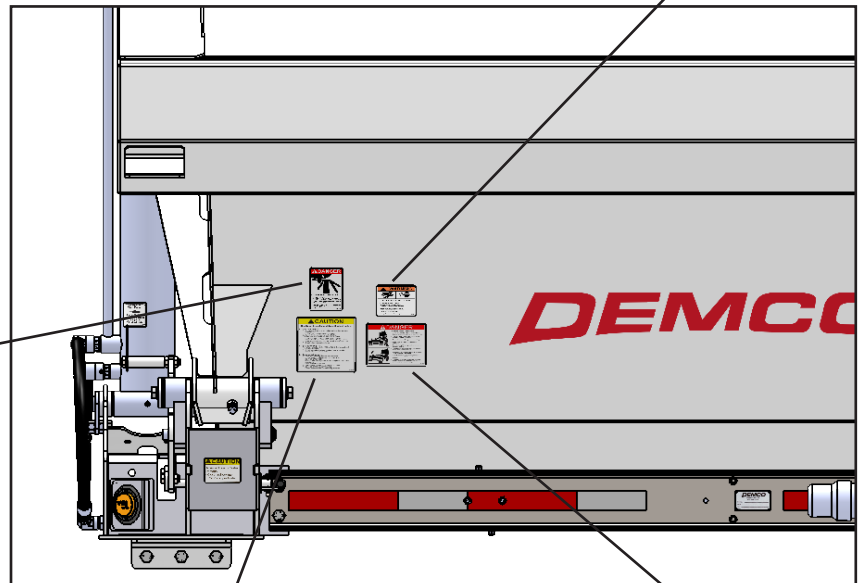

1AQAP3670

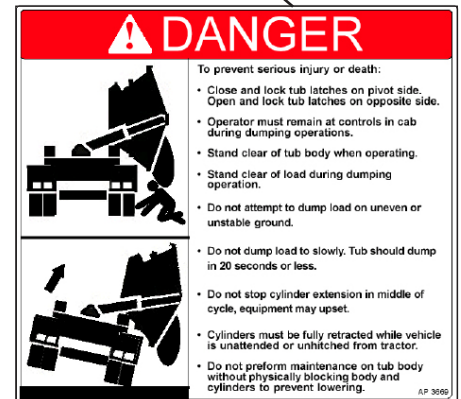

1AQAP3669

1AQAP3669 (1) DANGER (Load Dumping Safety) 8"W x 5-1/2"L

1AQAP3670 (1) CAUTION (Side Dump Checklist and Operating Instructions) 6"W x 7"L

1AQAP2914 (1) WARNING (High Pressure Fluid) 4"W x 4"L

1AQAP4361 (2) DANGER (Frame Area Maintenance) 3"W x 6-1/4"L

NOTE: New decals and reflectors are available from your dealer.

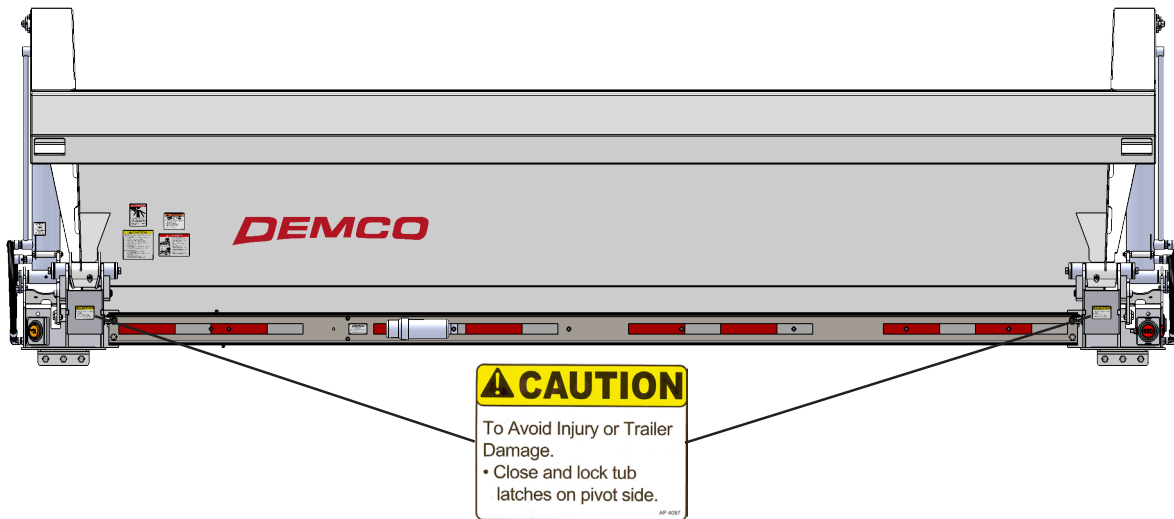

- *1AQAP4097 (4) Decal, CAUTION, Lock Tub Latches**
- *1AQAT000000 (4) White Conspicuity Tape, 2" Wide**

**White Reflectors
1AQAT000000**

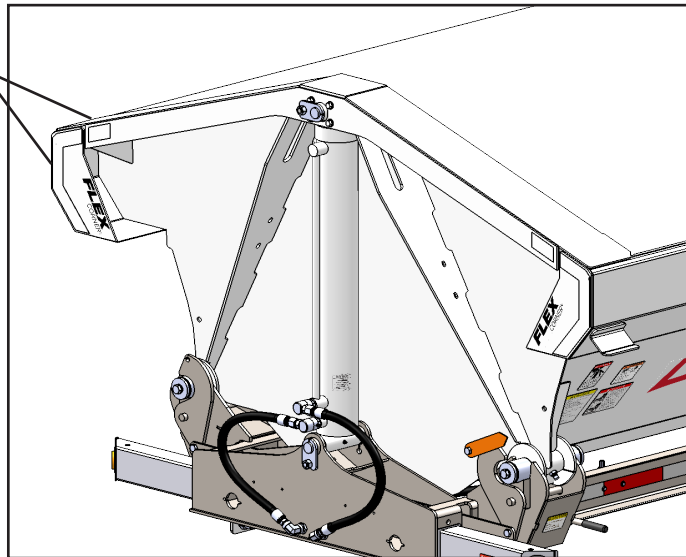

*** White Conspicuity Tape is located at both sides of both ends of tub.**

HOW TO APPLY SAFETY DECALS:

1. Be sure that the installation area is clean and dry.
2. Be sure temperature is above 50°F(10°C).
3. Decide on exact position before removing the backing paper.
4. Remove smallest portion of split backing paper.
5. Align decal over specified area and carefully press the small portion with the exposed sticky backing in place.
6. Slowly peel back remaining paper and carefully smooth remaining portions of decal into place.
7. Small air pockets can be pierced with a pin and smoothed out using a piece of decal backing paper.

Setting the Tub to Dump Curb-Side or Road-Side

CAUTION: Make sure the latches on each end of the tub are locked in the same direction. Failure to do so will result in damage to the side dump and/or tractor.

Latch Indicator Flag indicates direction of dump as shown below.

Latch Indicator Flag Open

Curb-Side Dump

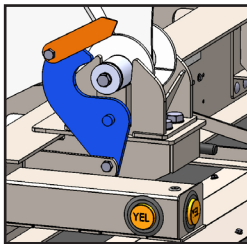

Latch Indicator Flag Closed

Road-Side Dump

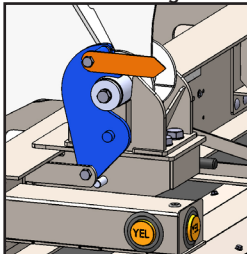

Before dumping the tub determine which direction the tub is going to dump when raised.

All steps are performed on the driver's side only.

NOTE: The following steps must be performed on both the front and the rear pivots.

Step One: Pull latch out to release pivot lock handle.

Step Two

Step Two: Pull bolt handle towards pivot pin to lock the tub in the left-hand (road-side) dump position.

Push bolt handle away from pivot pin to lock tub in the right-hand (curb-side) dump position.

Return latch to the locked position.

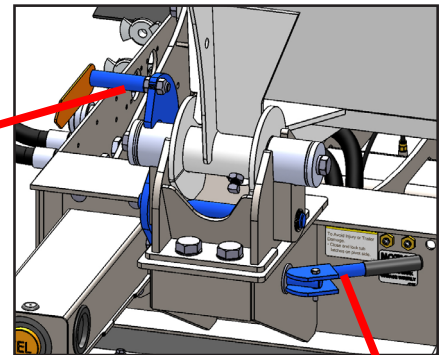
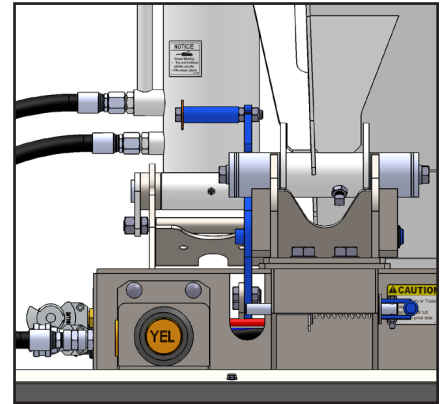

Step One

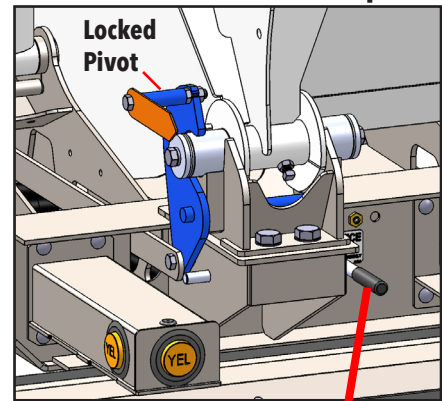

Locked Position

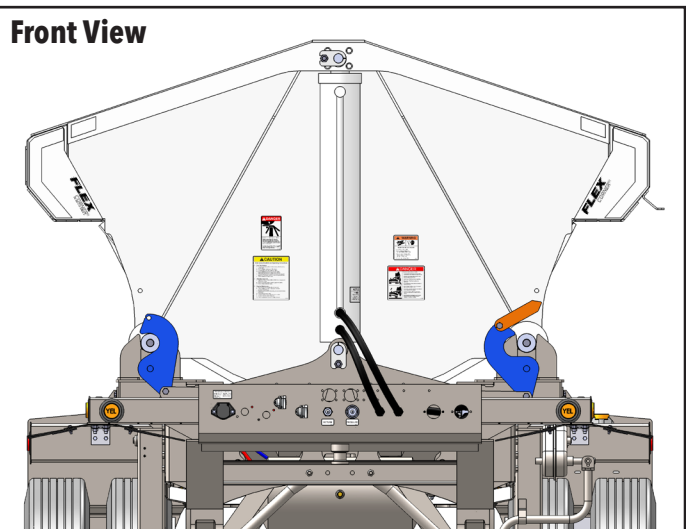

Locked Position for Curb-Side Dumping

First Time Hookup and Charging Cylinders

DANGER: Clear area around trailer of bystanders before charging system.



Tilt tub part way several times to fill hydraulic cylinders before extending cylinders completely. Extend and retract cylinders completely. Check for proper operation.

Filling and Dumping Trailer

DANGER: Clear area around trailer of bystanders before filling and dumping trailer.



NOTE: When Filling or Dumping loads, remain at the controls and stand clear of the trailer. The tub should dump in 20 seconds or less. DO NOT stop cylinder extension in middle of cycle, equipment may upset. DO NOT attempt to dump load on uneven or unstable ground.

Tub Size	Level Full - Cubic Yards	Heaped Full - Cubic Yards
14'	9.1	12.0
15'	9.8	12.9
16'	10.5	13.8
17'	11.1	14.6
20'	13.2	17.3
24'	15.8	20.8

Lubrication Maintenance

- Grease upper and lower pivot point zerks of both lift cylinders weekly. (Front lift cylinder zerks shown)

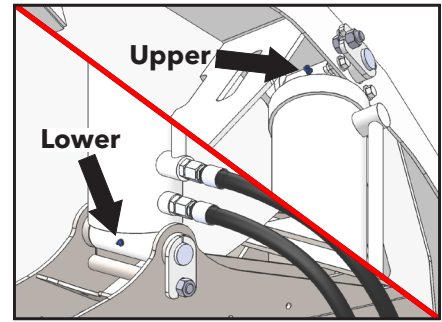

- If equipped with the remote grease zerk option, front lift cylinder zerks can be found near the curb-side front pivot. The rear lift cylinder zerks can be found near the road-side rear pivot. (Front lift cylinder zerks shown)

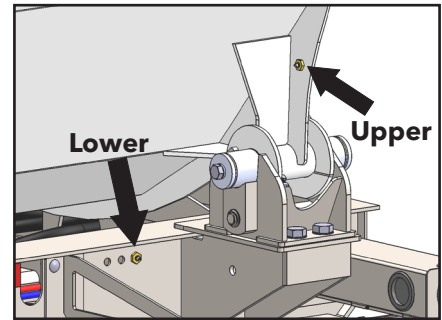

Inspect Lights Daily (If Equipped)

- Turn on truck lights and 4-way flashers. Walk around truck box to inspect that all lights are operating.

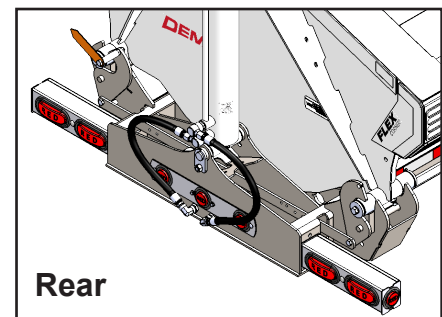
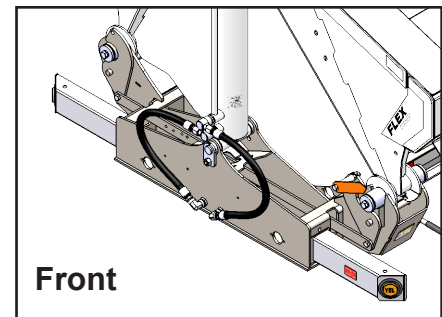

Inspect Hydraulic and Air Lines Daily

- Inspect hydraulic lines, air lines, and valves for leaks, rubbing, or crimped lines.

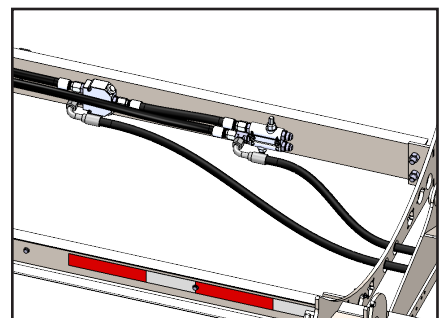

INSPECTION AND MAINTENANCE CHECKLISTS

Break-in Procedure Checklist

After the first twenty-four (24) hours of use, perform the following maintenance procedures:

1. If equipped, check all clearance lights, turn signal indicators, and stop lights.
2. Inspect hydraulic lines and valves for leaks, chaffing or crimped lines.

Pre-Trip Checklist

Perform the Pre-Trip checklist whenever the tractor/truck box has been left unattended.

1. If equipped, check that electrical cord is properly connected to the truck box plug.
2. Walk around truck box to check conditions of lights and tires.
3. Check tub dump latches to ensure they are both set for dumping to the same side.

Weekly Inspection Checklist

Perform the following checks Weekly, or if the truck box has not been used for more than a week.

1. Perform the Pre-Trip Checklist.
2. Grease the top and bottom cylinder pins on the front and rear cylinders.

Every 30 Days Checklist

Perform the following checks Every 30 Days on the hydraulic system:

1. Check hydraulic hoses for chaffing, crimping and fasten securely.
2. Check for hydraulic leaks.
3. Make sure valves are not leaking and are operating properly.
4. Hydraulic system is entirely dependent upon towing vehicle for its supply and control. Therefore, you must maintain hydraulic system on tow vehicle. Tow vehicle should maintain 30 GPM, oil flow at 2500 PSI.

NOTE: PERFORM THE ABOVE MAINTENANCE ON THE MINIMUM SCHEDULE, WHICHEVER COMES FIRST.

CAUTION: BE CERTAIN THE PRECEDING CHECKLIST INSPECTIONS HAVE BEEN PERFORMED.

NOTE: CLEAN HYDRAULIC SYSTEM AT LEAST ONCE PER YEAR.

Lights and Wiring

WARNING! Use only a 12 volt DC battery for checking lights or anti-lock systems. Never use battery chargers or transformers.

The lights and wiring system on every Demco Side Dump trailer meet or exceed all federal and state requirements in effect at the time of manufacture. Wherever required by law, lights and reflectors are marked by the manufacturer to indicate the appropriate specifications with which each complies.

For optimum performance and long life from the trailer's lights and wiring, follow this inspection procedure:

1. Clean all reflectors and lights. See that all lights burn properly. Replace all burned out lights and broken reflectors. Factory approved replacement parts should be used, and replacement bulbs of equal candle power should be used for safety.
2. Inspect all wiring to see that it is not frayed, and that it is properly supported and protected, with all connections tight. See that the light cable is clean and long enough to permit jackknife parking. Be certain that the cable is supported so that it cannot be pinched or entangled by the lower and upper couplers. Keep the 7-way plug on the light cable and the 7-way connector on the trailer free of corrosion.
3. Never replace fuses or breakers with metal foil or other devices.
4. A decal is located near the 7-way connector. You may trace individual electrical circuits by the wire colors indicated. Refer to the schematic drawing and the decal for conductor number and wire colors.

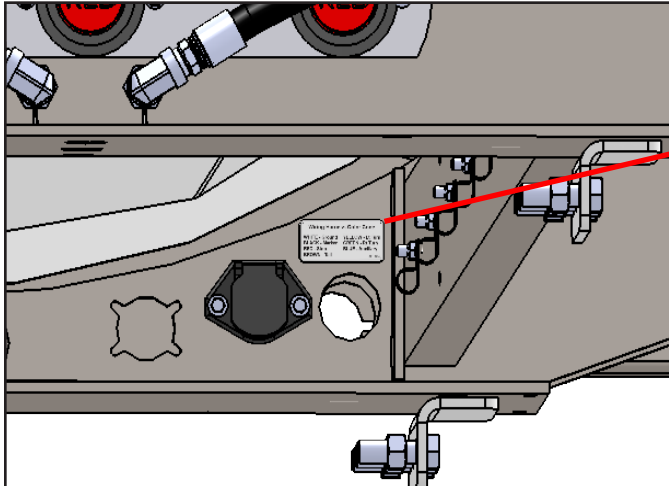

Wiring Harness Color Code

WHITE - Ground	YELLOW - Lt Turn
BLACK - Marker	GREEN - Rt Turn
RED - Stop	BLUE - Auxiliary
BROWN - Tail	

AP 3674

**1AQAP3674
WIRING HARNESS COLOR CODE DECAL**

BOM ID	Qty	Item No	Description
1	3*	1AEAP3641	WIRING HARNESS EXTENSION CORD, 60"
2	1	1AEX0088300	HARNESS, LWR, ID 3 PLUG, 60"
3	1	1AEX0088911	HARNESS, REAR S/T/T, RH & LH
4	2	1AEX3270084	HARNESS, FRONT M/C, 84"
5	1†	1AEX8882036	HARNESS, MAIN JUMPER, 36"
6	1	1AEX8983927	HARNESS, FRONT MAIN W/ FEMALE SOCKET

* 20' truck box requires (4)

* 24' truck box requires (5)

† Not used on 14', 20', & 24' truck boxes.

NOTE: A **RED BOM ID#** indicates an option.

LIGHT KIT (IF EQUIPPED)

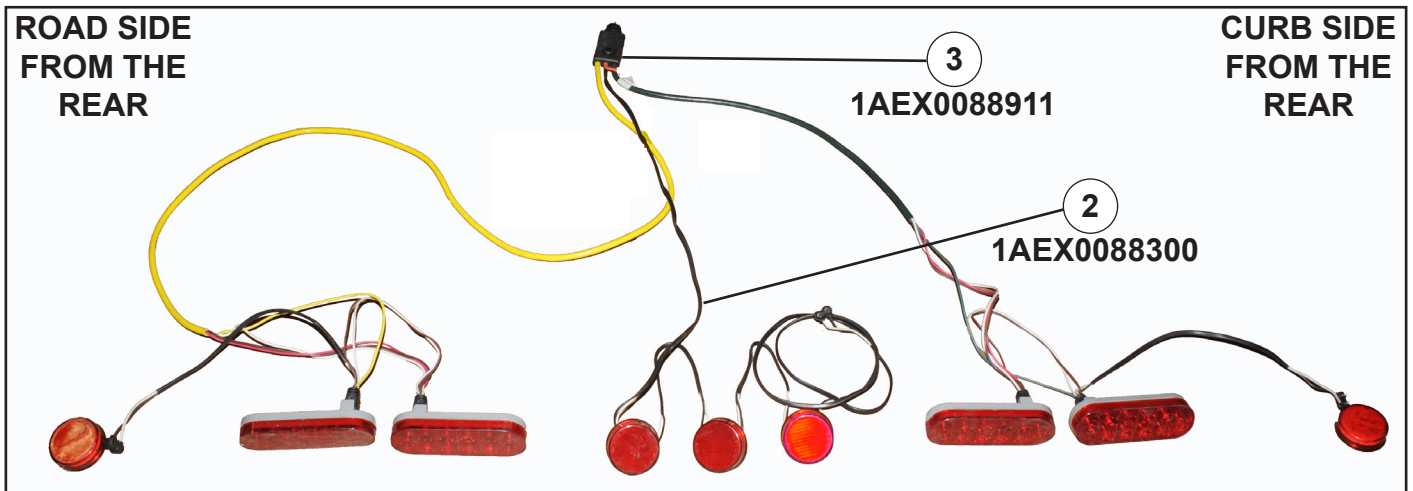
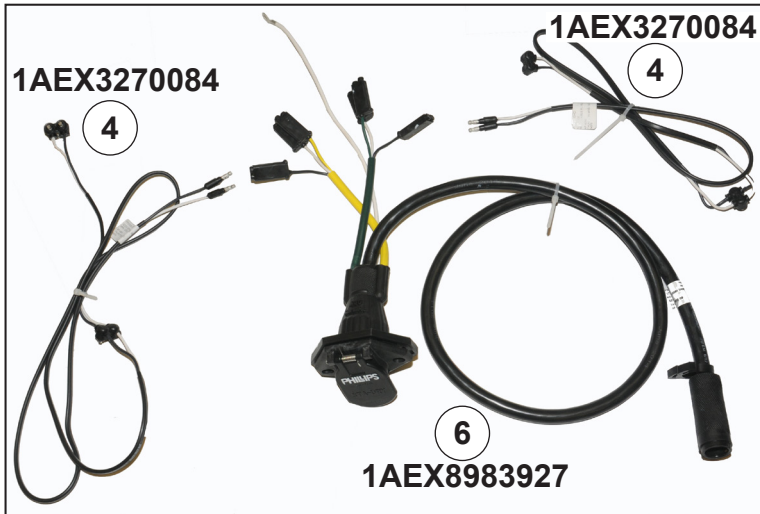
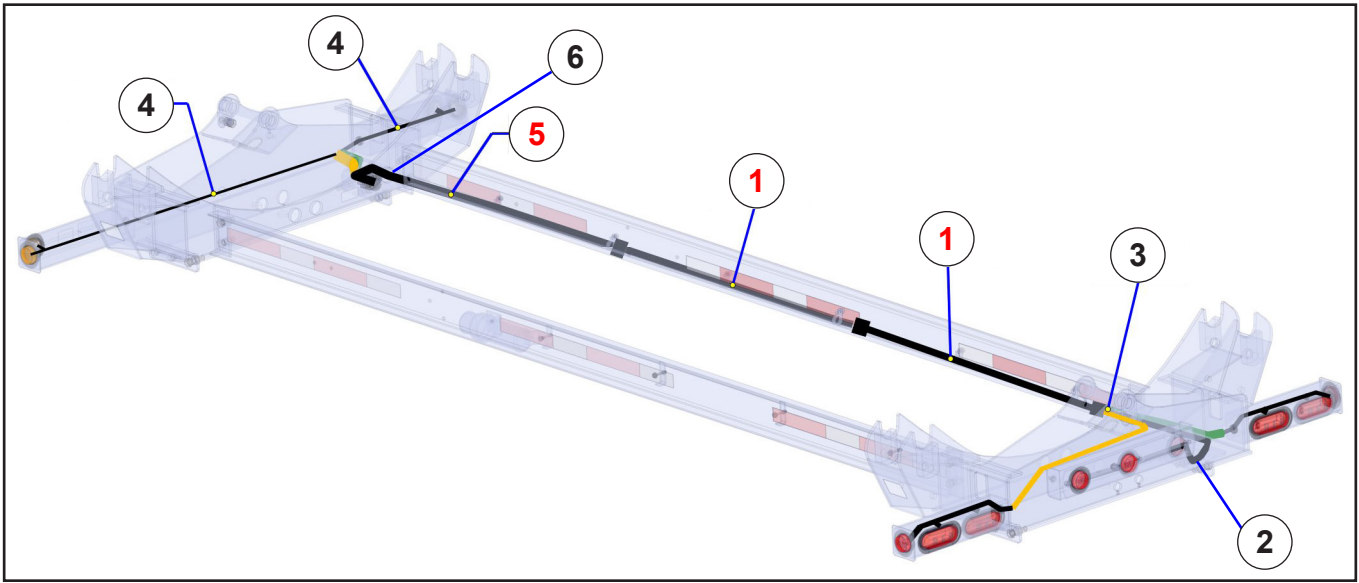

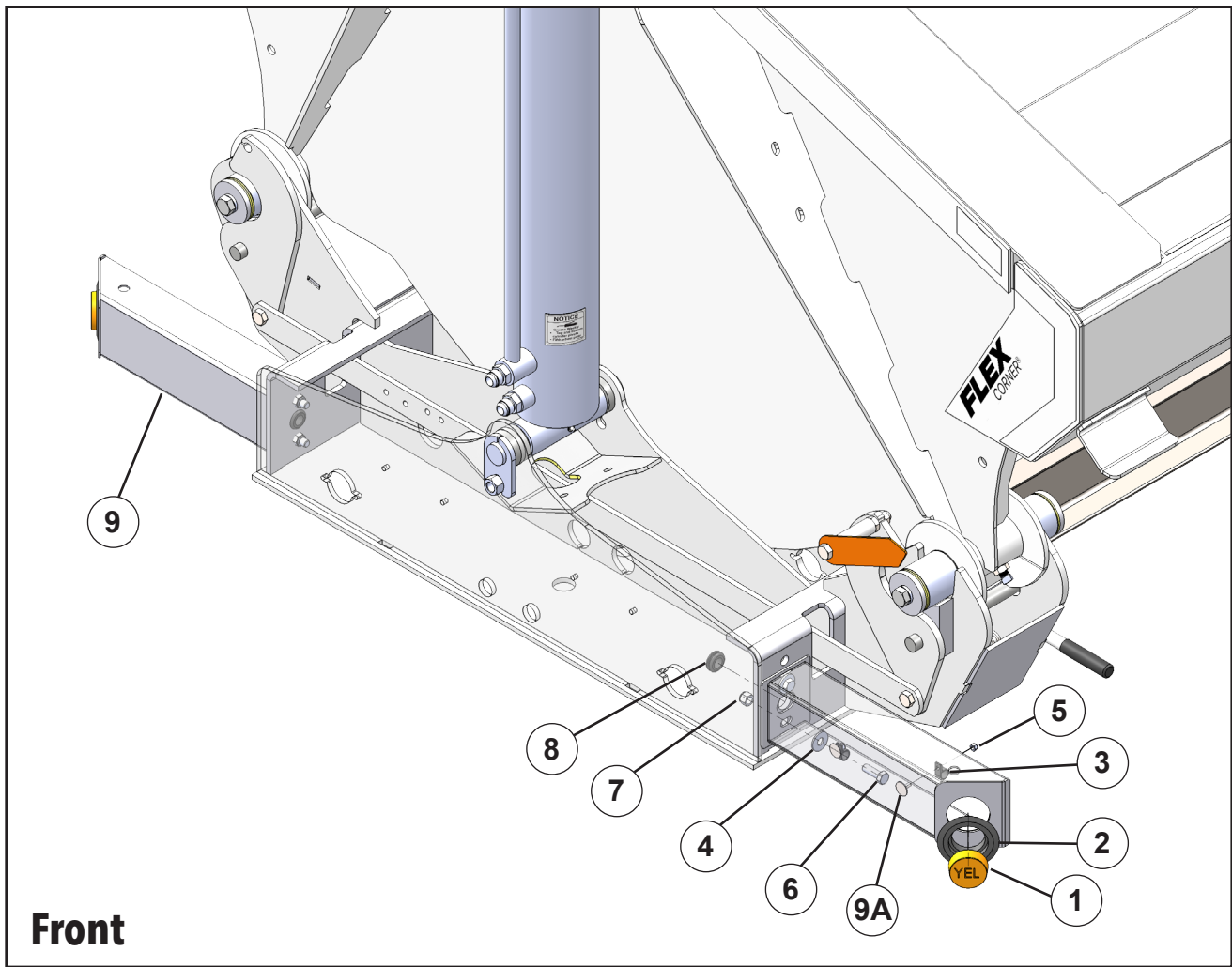

BOM ID	Qty	Item No	Description
1	2	1AEAP4311	LAMP, LED, CLEAR/MARKER, YELLOW, 2-1/2"
2	2	1AEG0010700	2-1/2" ROUND GROMMET
3	4	1AEN0025110	LOOM CLAMP, 5/8" ID, PLATED STEEL
4	4	1AF009H000	1/2 FLAT WASHER ZINC
5	4	1AFBP3587	NUT, HEX LOCK, 1/4"-20, NYLOCK ZINC PLATED
6	4	1AFC12HAAH0	1/2"-13 X 1-1/2" HEX BOLT GR 5 ZINC
7	4	1AFC18H000	NYLON INSERT LOCKNUT, 1/2-13 UNC
8	2	1ARAP4045	GROMMET, 3/4" ID, G3137-016
9	2	5C000270	TB FRONT LIGHT BOX MT, WELDMENT
9A	4	1AFC07D00L0	1/4"- 20 x 3/4" ELEVATOR BOLT ZINC PLATED

LIGHT KIT (IF EQUIPPED)

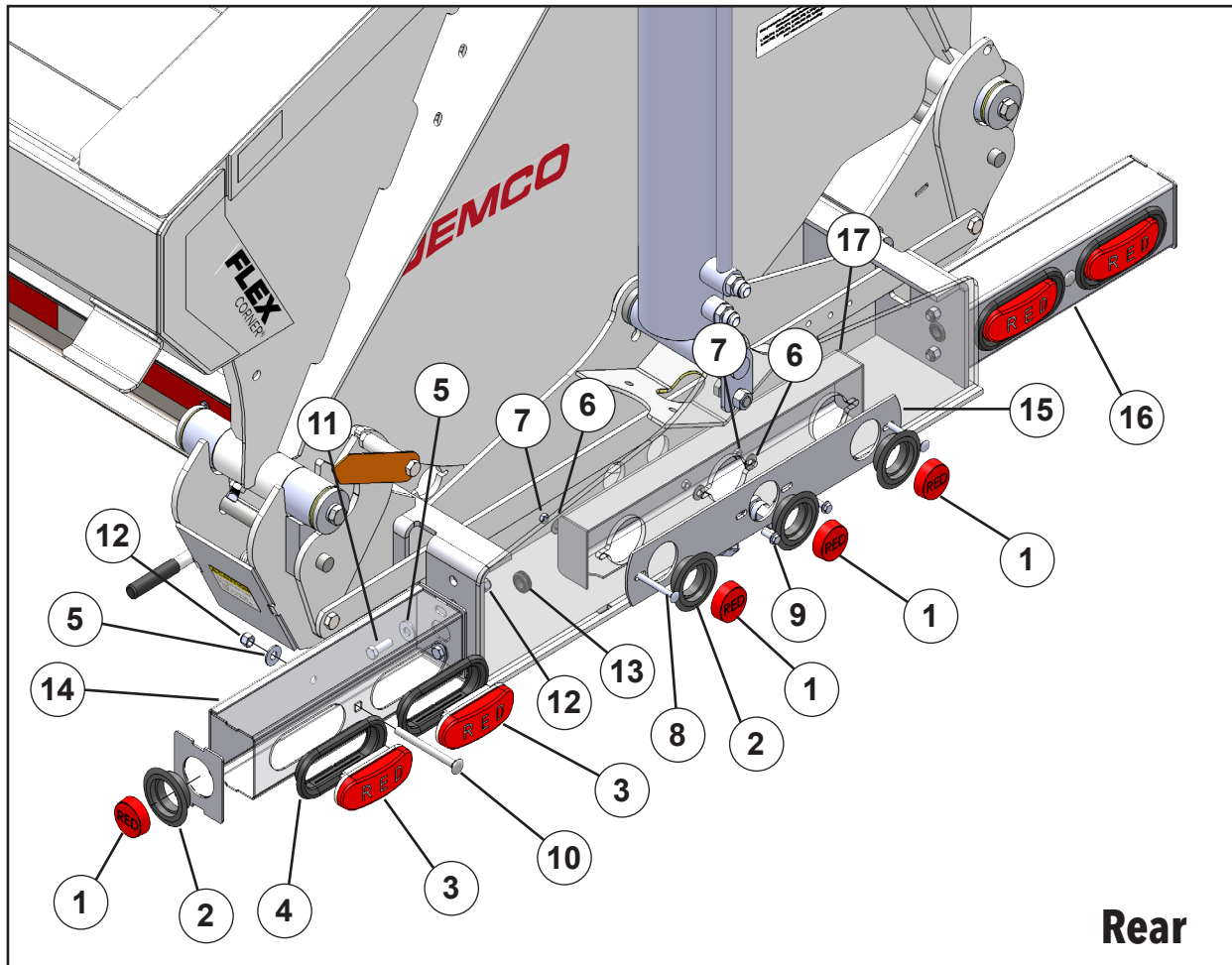

BOM ID	Qty	Item No	Description
1	5	1AEP4310	LAMP, LED, CLEAR/MARKER, RED, 2-1/2"
2	5	1AEG0010700	2-1/2" ROUND GROMMET
3	4	1AEL6050000	RED 6" OVAL-LED
4	4	1AEL0607003	MIDSHIP LIGHT GROMMET
5	6	1AF009H000	1/2 FLAT WASHER ZINC
6	4	1AF009F0000	3/8 FLAT WASHER ZINC
7	4	1AFBP3612	NUT, HEX LOCK, 3/8"-16 ZINC TOP-LOCK GRC ZINC & WAXED
8	2	1AFBP3687	BOLT, CARRIAGE, 3/8"-16X4 GRD 5, PLTD
9	2	1AFBP3692	BOLT, FLNG HEAD, 3/8"-16X1 GR8, SERR. CLEAR ZINC
10	2	1AFC04HEAH0	1/2-13 X 5 1/2 CARR BOLT ZINC PLATED
11	4	1AFC12HAAH0	1/2"-13 X 1-1/2" HEX BOLT GR 5 ZINC
12	6	1AFC18H000	NYLON INSERT LOCKNUT, 1/2-13 UNC
13	2	1ARAP4045	GROMMET, 3/4" ID, G3137-016
14	2	3C000349	TB REAR LIGHT BOX MT CHANNEL COVER
15	1	3CAM9058	ID LIGHT FACE PLATE
16	2	5C000271	TB REAR LIGHT BOX MT, WELDMENT
17	1	5CAM9184	LIGHT COVER, ID, TRUCK BOX

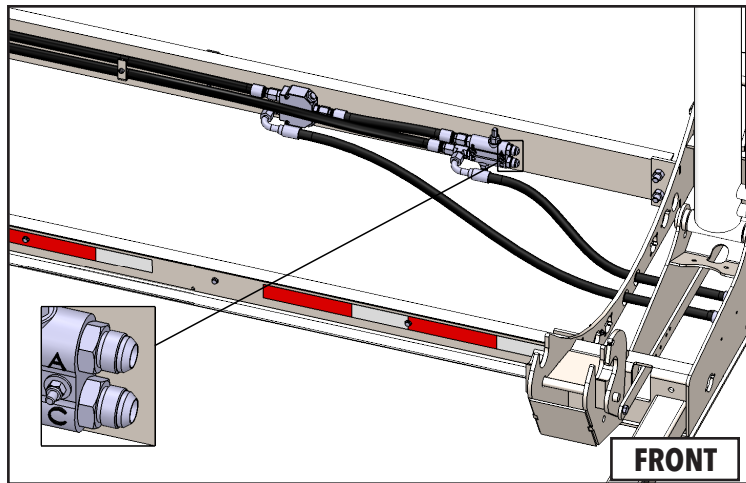

WARNING: Hydraulic fluid escaping under pressure can have enough force to penetrate the skin. Hydraulic fluid may also infect a minor cut or opening in the skin. If injured by escaping fluid, see doctor at once. Serious infection or reaction can result if medical treatment is not given immediately. Make sure all connections are tight and that hoses and lines are in good condition before applying pressure to the system. Relieve all pressure before disconnecting the lines or performing other work on the hydraulic systems.

Truck-Tractor Hydraulic Systems

Efficient, safe operation of side dump trailers require that the tractor hydraulic system provide a clean, high pressure, high volume oil supply. The hydraulic pump pressure should be set at 2500 PSI with a minimum output of 25 GPM supply and a minimum 15 gallon filtered and strained reservoir.

NOTE:

Hydraulic Oil Filter should be Changed every 25,000 miles or yearly, which ever comes first and hydraulic system flushed every 50,000 miles with pressure and flow rates checked.

Generic Tractor Hydraulic System

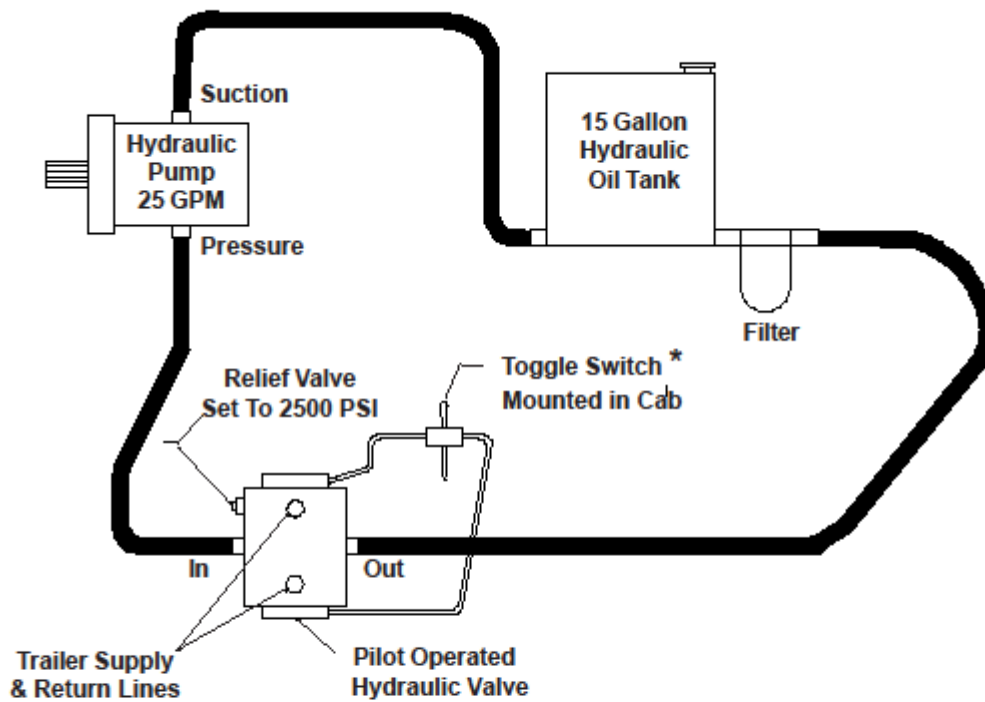

HYDRAULIC CYLINDERS & BOTTOM CYLINDER PINS

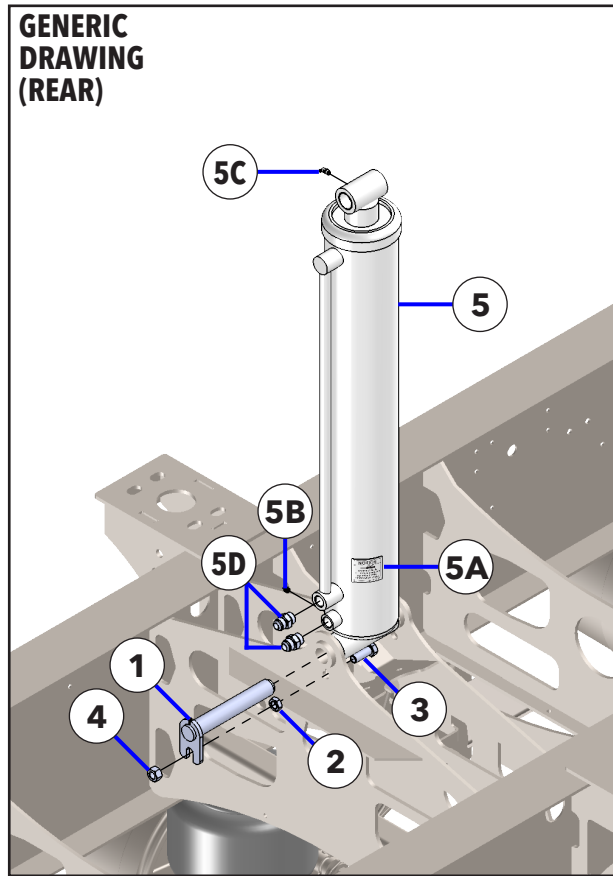
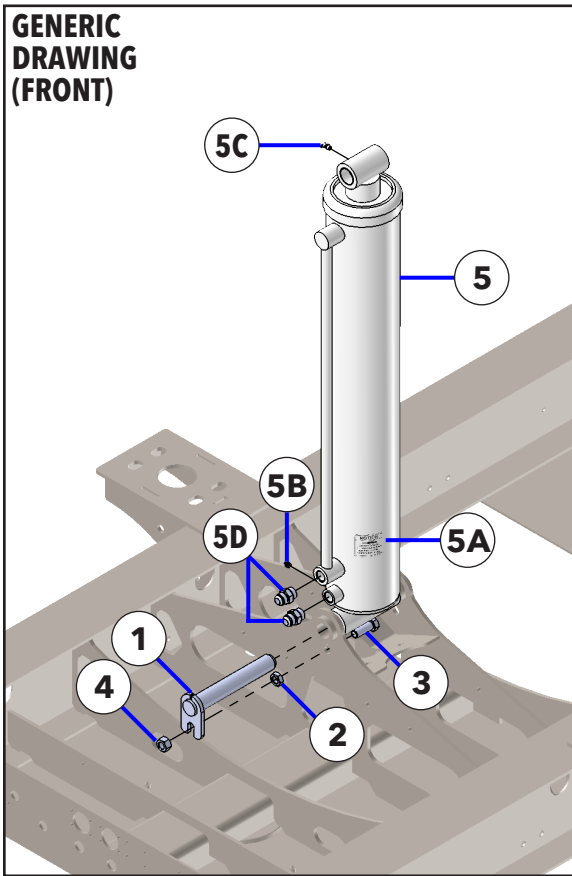

BOM ID	Qty	Item No	Description
1	2	5CAM9019	PIN, CYLINDER, 1-1/2" X 9-5/8"
2	2	1AFBP3107	NUT, HEX JAM, 3/4"-10, GR 2, PLATED
3	2	1AFBP3139	HEX CAP SCREW, 3/4"-10 X 2", GR 5, PLATED
4	2	1AFC05L0005	3/4 CENTERLOCK NUT
5	2	1AYDP6347	CYLINDER, HYDRAULIC, 5" X 36", WITH DROP TUBE
5	2	1AYDP6349	CYLINDER, HYDRAULIC, 6" X 36", WITH DROP TUBE
5A	2	1AQAP2986	DECAL, GREASE TRAILER WEEKLY, 2-3/4"W X 3"T
5B	2	1AKZAAA0000	GREASE ZERK, 1/8" NPT
5C	2	1AFBP3654	GREASE ZERK, 1/8" MP X 45 DEGREE ELBOW
5D	4	1AKDP4368	ADAPTER, 12MJIC-12MSAE, STRAIGHT, 6400-12
*	1	1AKDP6603	SEAL KIT 5" WETHERELL CYLINDER
*	1	1AKDP6569	SEAL KIT 6" WETHERELL CYLINDER

***Not shown in part diagrams.**

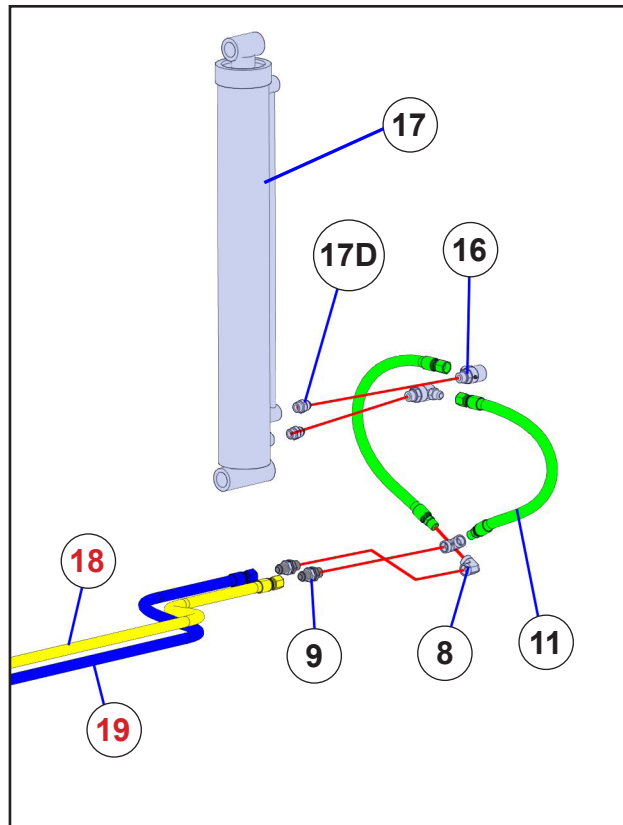
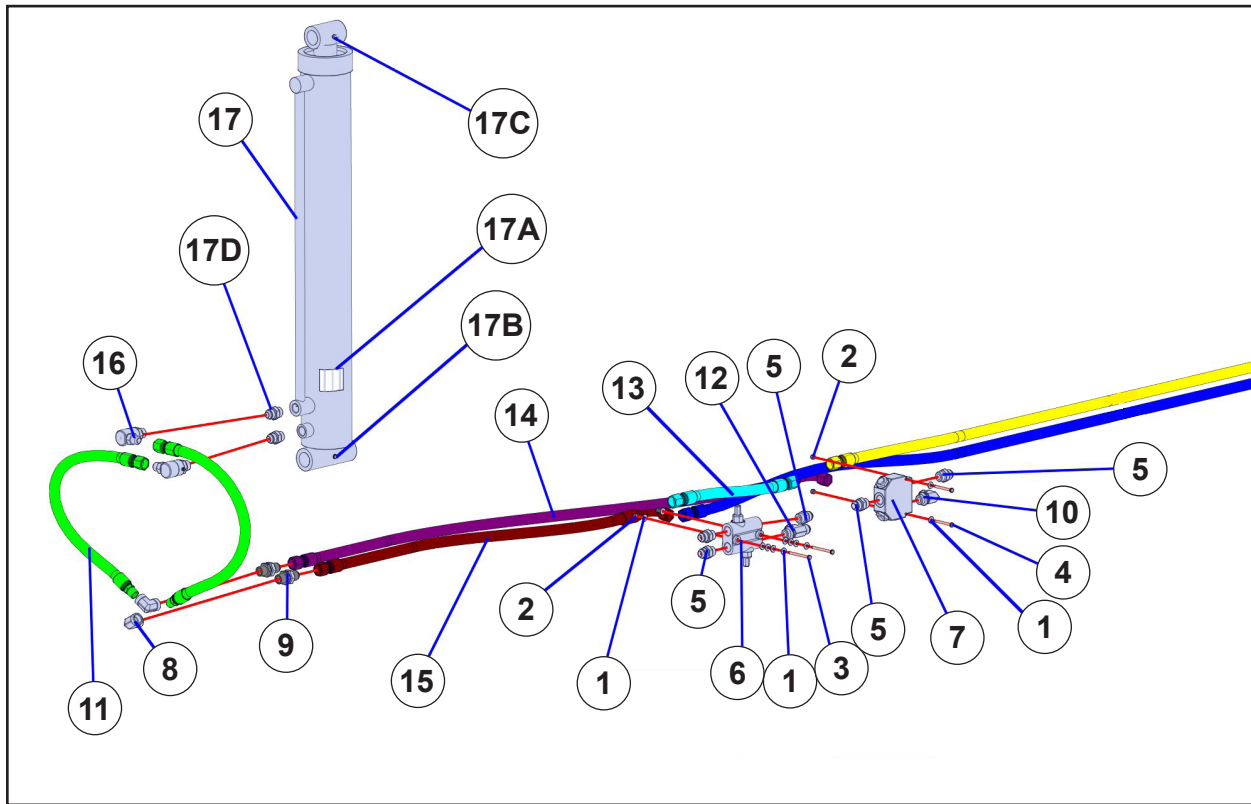

HYDRAULIC PARTS

BOM ID	Qty	Item No	Description
1	12	1AF009D0000	1/4 FLAT WASHER ZINC
2	4	1AFBP3587	NUT, HEX, 1/4"-20, NYLOCK, PLATED
3	2	1AFBP3588	HEX CAP SCREW, 1/4-20 X 3, GR 8, PLTD
4	2	1AFBP3589	HEX CAP SCREW, 1/4-20 x 2-1/2 GR 8, PLTD
5	5	1AKDP4368	ADAPTER, 12MJIC-12MSAE, STRAIGHT, 6400-12
6	1	1AKDP6302	VALVE, DOUBLE RELIEF, PRINCE, H-L
7	1	1AKDP6303	VALVE, PROPORTIONAL DIVIDER, PRINCE
8	4	1AKDP6306	ELBOW, 90*, 12FP-12FP, 5504-12-12
9	4	1AKDP6495	BULKHEAD ADAPTER W/ NUT, 12MJ-12MP, 2706-LN-12-12
10	1	1AKDP6538	ADAPTER, 12MJ-12MSAE 90*, 6801-12
11	4	1AKDP6540	HOSE, HYD, 3/4" X 32", 12FJX-12MP
12	1	1AKDP6557	TEE, 12MJ-12MSAE-12MJ, 6804-12
13	1	1AKDP6558	HOSE, HYD, 3/4" X 18-1/2", 12FJX-12FJX
14	1	1AKDP6574	HOSE, HYD, 3/4" X 70", 12FJX-12FJX90*
15	1	1AKDP6575	HOSE, HYD, 3/4" X 45", 12FJX-12FJX90*
16	4	1AKDP6609	SWIVEL, LIVE, 12MSAE-12MJ 90*, LS6801-12-12
17	2	1AYDP6347	CYLINDER, HYDRAULIC, 5" X 36", WITH DROP TUBE
17	2	1AYDP6349	CYLINDER, HYDRAULIC, 6" X 36", WITH DROP TUBE
17A	1	1AQAP2986	DECAL, GREASE TRAILER WEEKLY, 2-3/4"W X 3"T
17B	2	1AKZAAA0000	GREASE ZERK, 1/8" NPT
17C	2	1AFBP3654	GREASE ZERK, 1/8" MP X 45 DEGREE ELBOW
17D	4	1AKDP4368	ADAPTER, 12MJIC-12MSAE, STRAIGHT, 6400-12
18	1	§	HOSE, HYD, 3/4" X XXX", 12FJX-12FJX
19	1	§	HOSE, HYD, 3/4" X XXX", 12FJX-12FJX

§ Item numbers vary by Truck Box length.

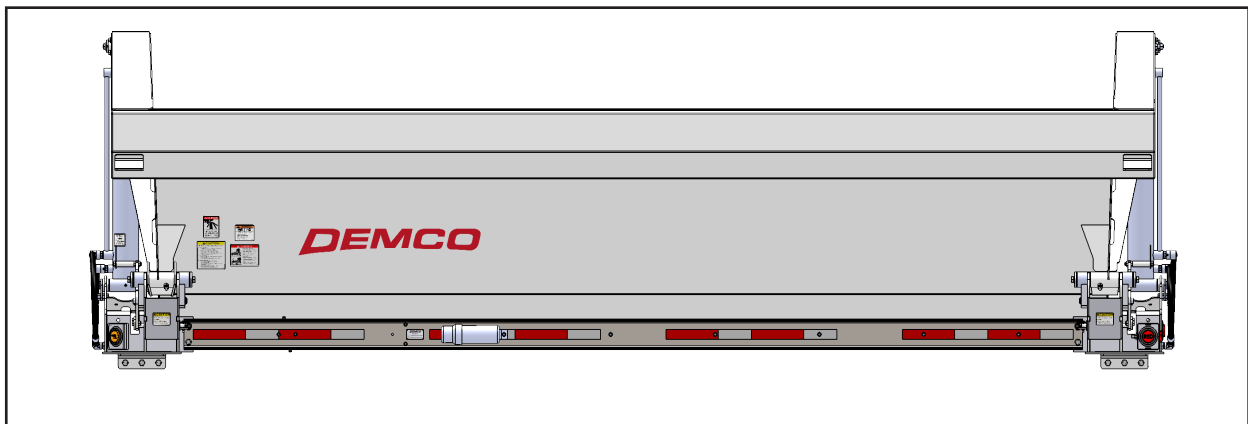

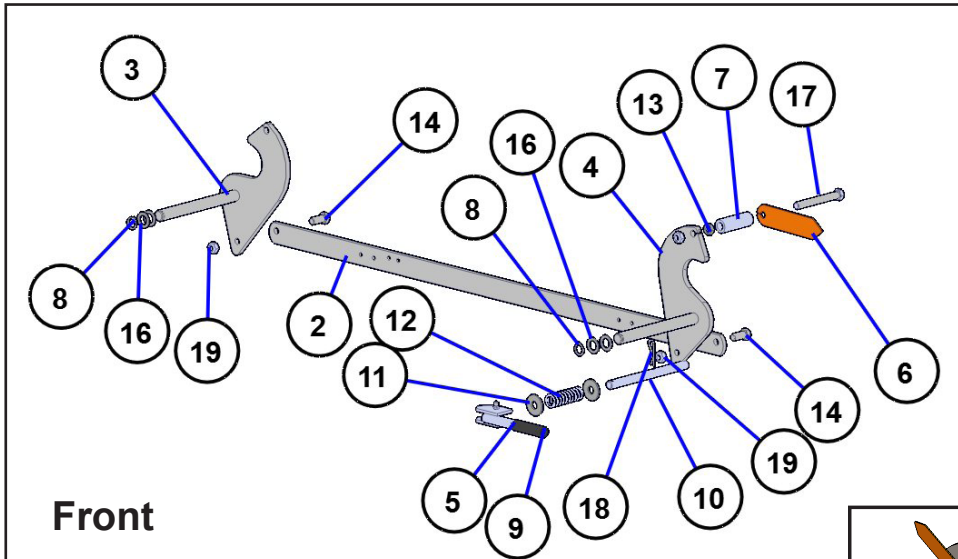

Front

BOM ID	Qty	Item No	Description
1	1	4CPKG00113	PACKAGE, PIVOT LATCH, 2001 SIDE DUMP
2	2	3CAM9078	LATCH CONNECTOR
3	2	5CAM9123	TUB PIVOT LOCK, LEFT HAND FRONT/RIGHT HAND REAR
4	2	5CAM9124	TUB PIVOT LOCK, RIGHT HAND FRONT/ LEFT HAND REAR
5	2	3CAM9125	LATCH LOCK HANDLE
6	2	3CAM9155	LATCH INDICATOR FLAG
7	2	3CAM9156	SPACER
8	4	1AFAP2407	SNAP RING, 1" EXTERNAL, HEAVY DUTY
9	2	1ABAP4208	GRIP, .843" ID X 4" OAL
10	2	1AFBM3727	PIN, LATCH LOCK, 3/4" X 10-3/8" OAL
11	4	1AFBP3033	WASHER, FLAT, 3/4", PLATED, STANDARD, TYPE A, SERIES W
12	2	1AFBP3066	COMPRESSION SPRING RIGID HITCH
13	2	1AFBP3080	NUT, HEX JAM, 5/8"-11, GRADE 2
14	4	1AFBP3097	HEX CAP SCREW, 5/8"-11 X 1-1/2", GRADE 5, PLATED
15	2	1AFBP3110	HEX CAP SCREW, 5/16"-18 X 2", GRADE 5, PLATED
16	8	1AFBP3215	MACHINERY BUSHING, 1-1/2" OD X 1" ID, 14 GAUGE, PLATED
17	2	1AFBP3298	HEX CAP SCREW, 5/8"-11 X 5-1/2", GRADE 5, PLATED
18	2	1AFBP3504	PIN, HAIRCLIP, 1/8"
19	6	1AFBP3615	NUT, HEX LOCK, 5/8"-11, GRADE 8, PLATED
20	2	1AFBP3644	NUT, HEX LOCK, 5/16"-18, TOP LOCK

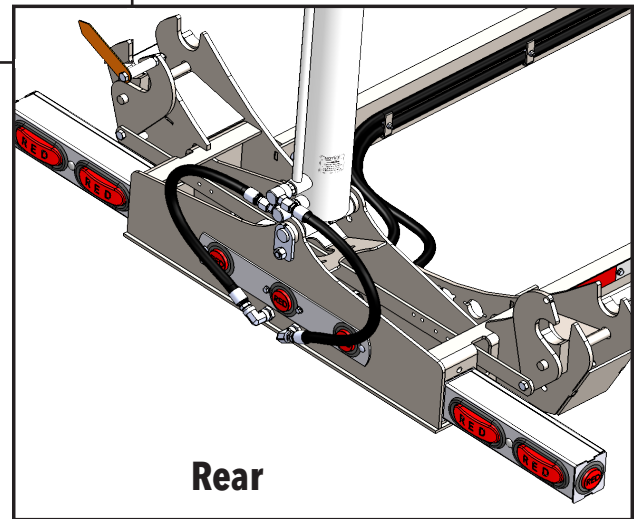

Rear

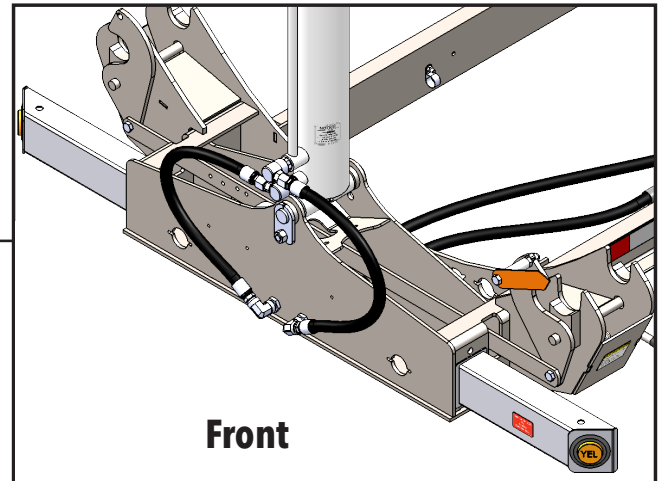

Front

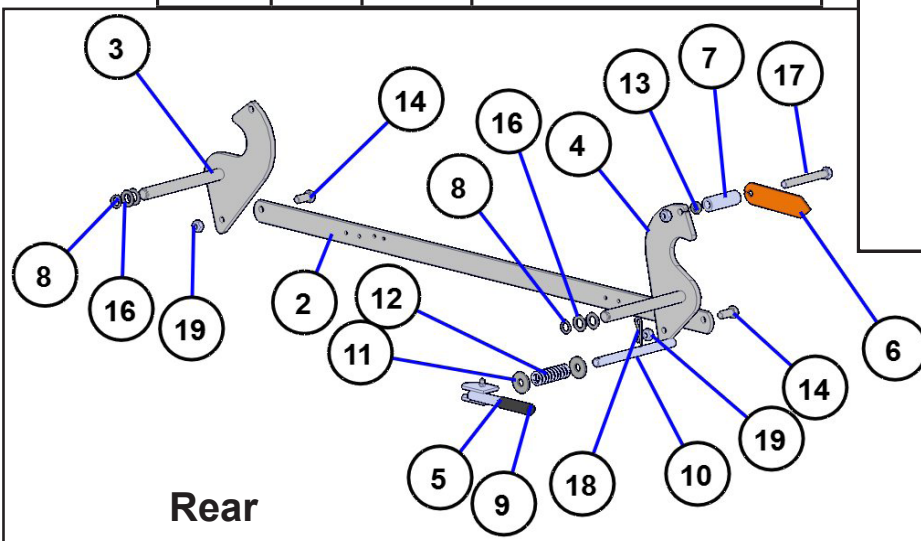

Rear

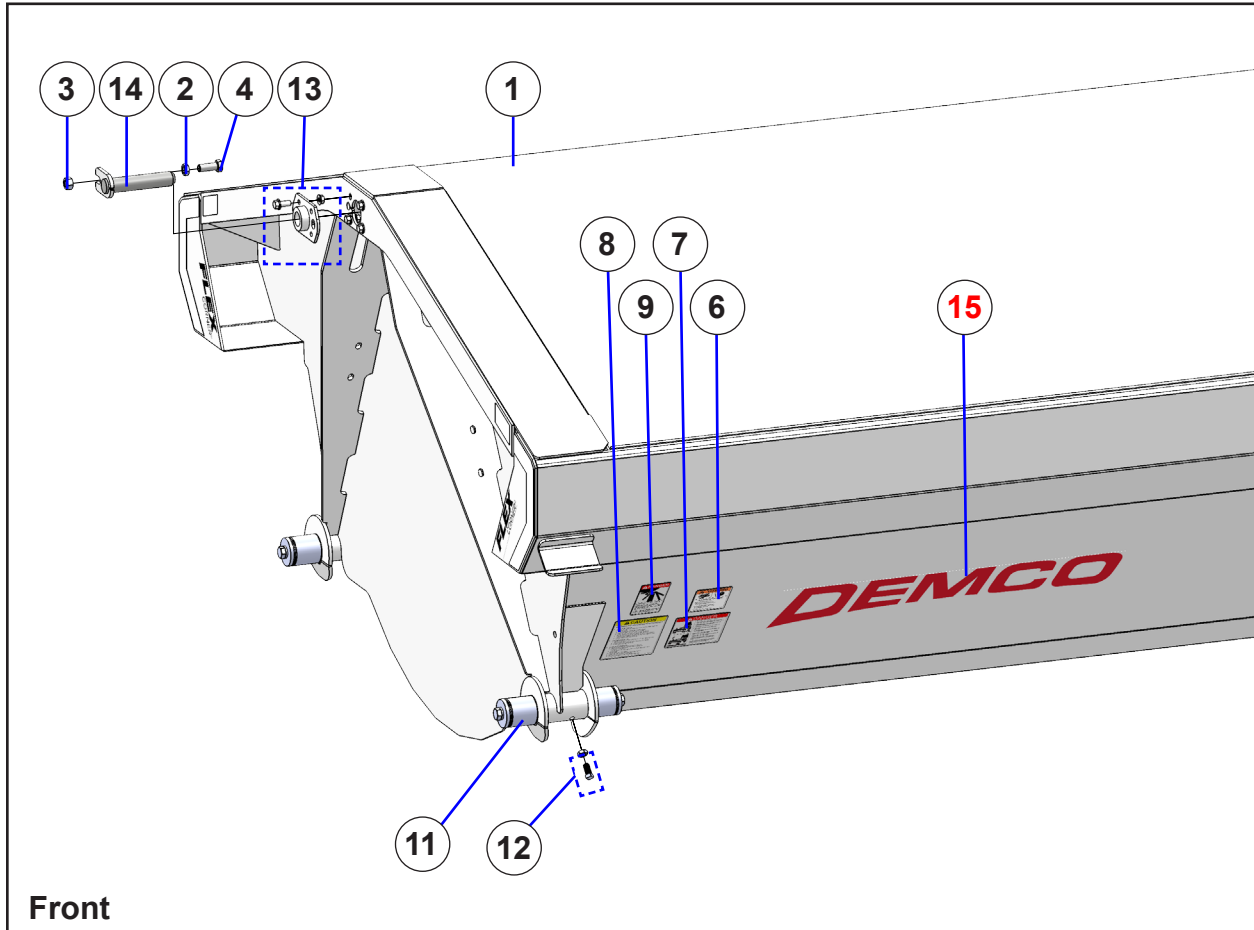

Front

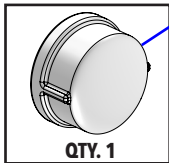

TUB DRAIN CAP 1AC4605K656 (BEGINNING MID-2023)

TUB DRAIN PLUG 1AUCP2263 (MID-2023 AND PRIOR YEARS)

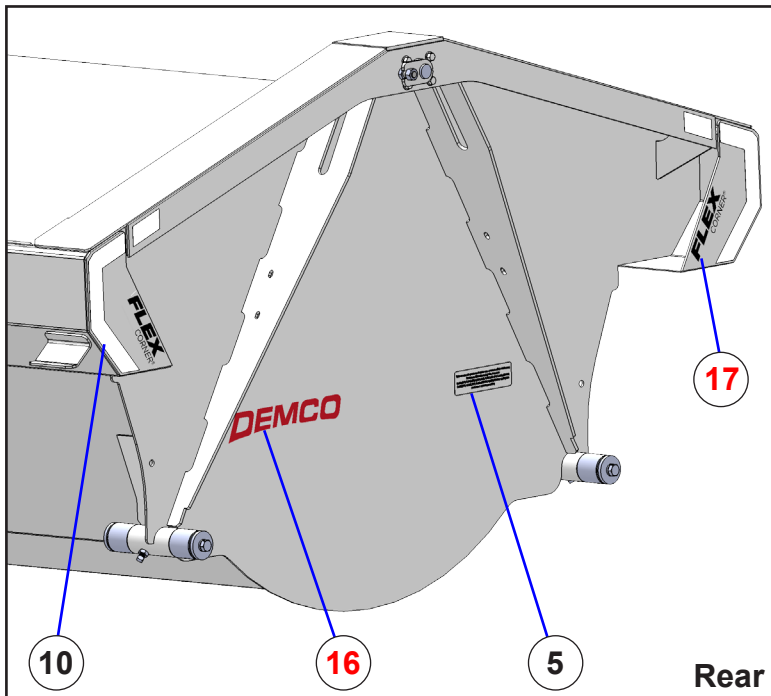
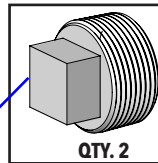

Rear



1AQAP4361

9



1AQAP3669

7



1AQAP3670

8



1AQAP2914

6

This product is protected under one or more of the following Demco Patents:
 5,480,214; 5,845,971; 6,257,670 B1; 6,402,453 B1;
 6,425,726; 6,428,264; 6,488,340 B2; 6,520,589 B2; 6,554,364
 and other patents pending

5

1AQAP2491

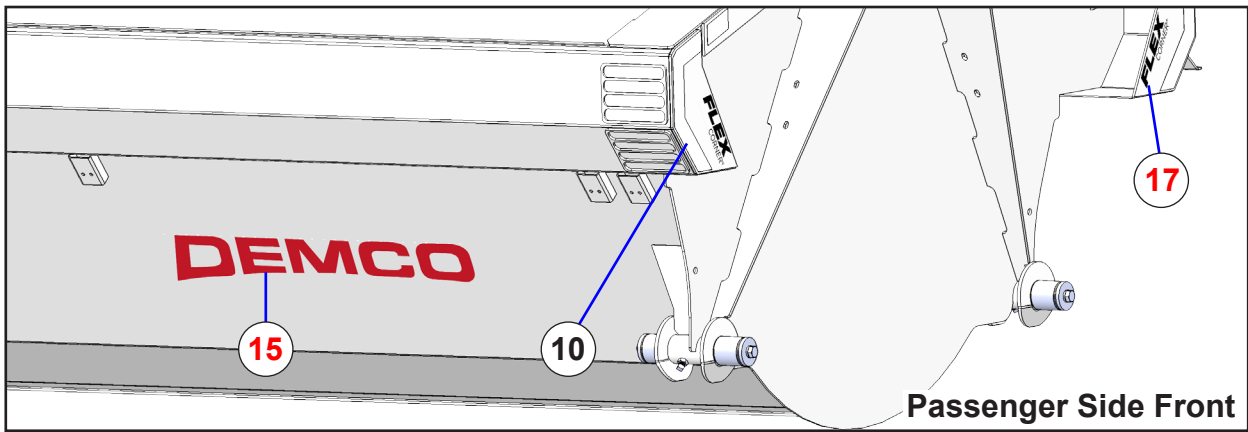

Passenger Side Front

NOTE: A RED BOM ID# indicates an option.

BOM ID	Qty	Item No	Description
1	1	†	TUB Item Numbers & Specifications are listed on Page 32
2	2	1AFBP3107	NUT, HEX JAM, 3/4"-10, GR 2, PLTD
3	2	1AFC05L0005	NUT, HEX LOCK, 3/4"-10, GR 2, PLTD
4	2	1AFC12LBAH8	HEX BOLT, 3/4-10 x 2-1/2, GR 8, YELLOW ZINC
5	1	1AQAP2491	DECAL, PATENT PROTECTION, 8-1/2"W X 2-1/2"L
6	1	1AQAP2914	DECAL, WARNING (HIGH-PRESSURE FLUID) 4"W X 4"L
7	1	1AQAP3669	DECAL, DANGER (LOAD DUMPING SAFETY) 8"W X 5-1/2"L
8	1	1AQAP3670	DECAL, CAUTION (SIDE DUMP CHECKLIST & INST) 6"W X 7"L
9	1	1AQAP4361	DECAL, DANGER (FRAME AREA MAINT) 3"W X 6-1/4"L
10	4	1AQAT000000	WHITE CONSPICUITY TAPE, 2" WIDE
11	4	4CFK2005	PIVOT PIN & BUSHING KIT (See sub-assembly parts list below)
12	4	4CAAM7991	ASSEMBLY, SET SCREW & JAM NUT, 5/8"-11 X 1-1/4", PLTD
12A	4	1AFBP3080	NUT, HEX JAM, 5/8"-11, GR 2, PLTD
12B	4	1AFBP3673	SET SCREW, SQ HEAD, 5/8"-11 X 1-1/4", PLTD
13	2	5C000015	ADJUSTABLE TOP CYLINDER MOUNT ASSEMBLY
13A	4	1AFC08H0000	NUT, HEX SERRATED FLANGE, 1/2"-13, PLTD
13B	4	1AFC37HAAD5	HEX CAP SCREW, 1/2"-13 X 1-1/4", SERRATED FLANGE HD, PLTD
14	2	5CAM9057	PIN, CYLINDER, 1-1/2" X 7-1/8", ANTI-ROTATION, PLTD
15	2	DE21000	DECAL, DEMCO LOGO, LARGE WHITE
15	2	DE21001	DECAL, DEMCO LOGO, LARGE RED
15	2	DE21026	DECAL, DEMCO LOGO, X-LARGE RED (only used on 20 & 24 TUB)
15	2	DE21027	DECAL, DEMCO LOGO, X-LARGE WHITE (only used on 20 & 24 TUB)
16	1	DE21004	DECAL, DEMCO LOGO, SMALL WHITE
16	1	DE21005	DECAL, DEMCO LOGO, SMALL RED
17	4	DE21024	DECAL, FLEX CORNER, BLACK
17	4	DE21025	DECAL, FLEX CORNER, WHITE,

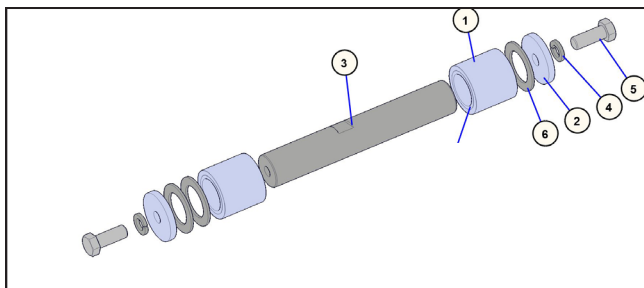

4CFK2005 PIVOT PIN & BUSHING KIT			
BOM ID	Qty	Item No	Description
1	2	4CAAM7990	ASSEMBLY, TUB PIVOT BEARING
2	2	3CAM9026	WASHER, PIVOT PIN
3	1	1AUAM9136	PIVOT PIN, 2" X 12-1/8" OAL, PLTD
4	2	1AF015L0000	WASHER, LOCK, 3/4", PLTD
5	2	1AFBP3139	HEX CAP SCREW, 3/4"-10 X 2", GR 5, PLTD
6	3	1AFBP3599	MACHINERY BUSHING, 3" OD X 2" ID X 10 GA, PLTD

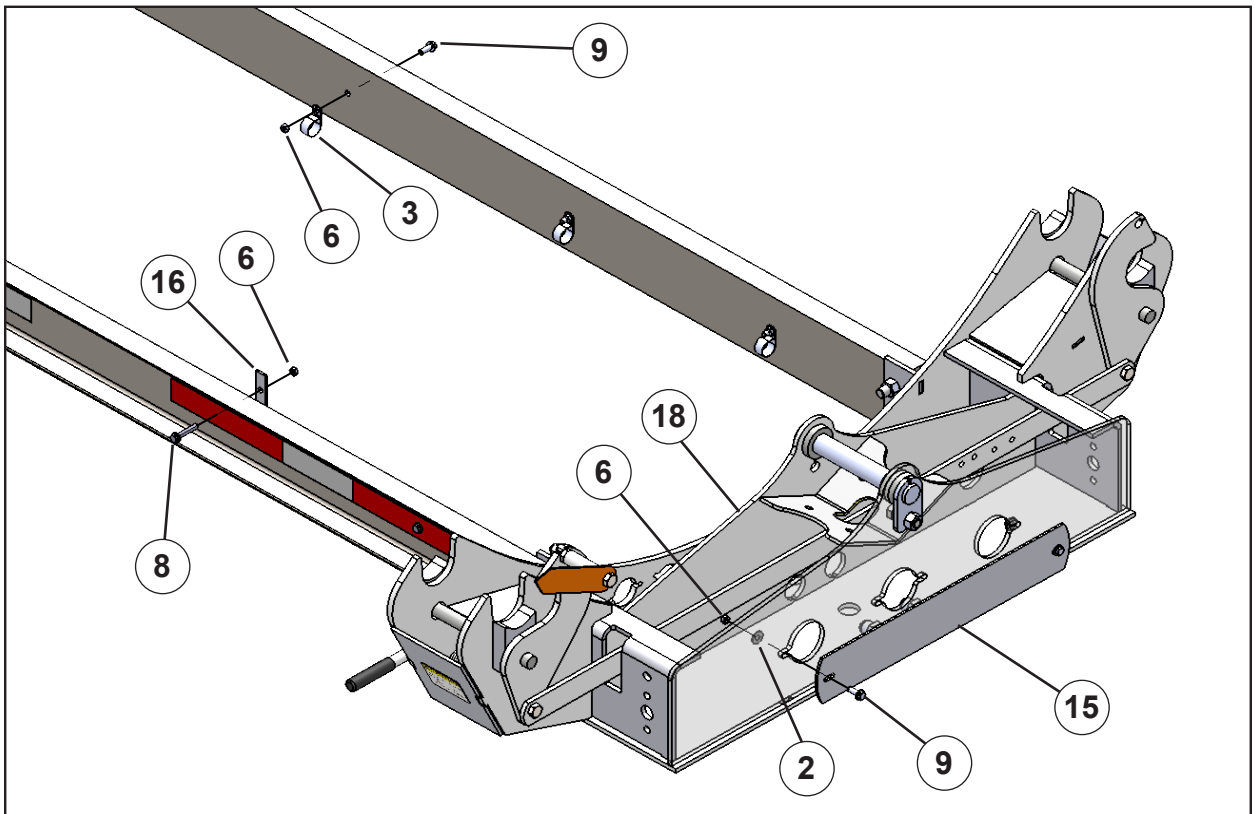
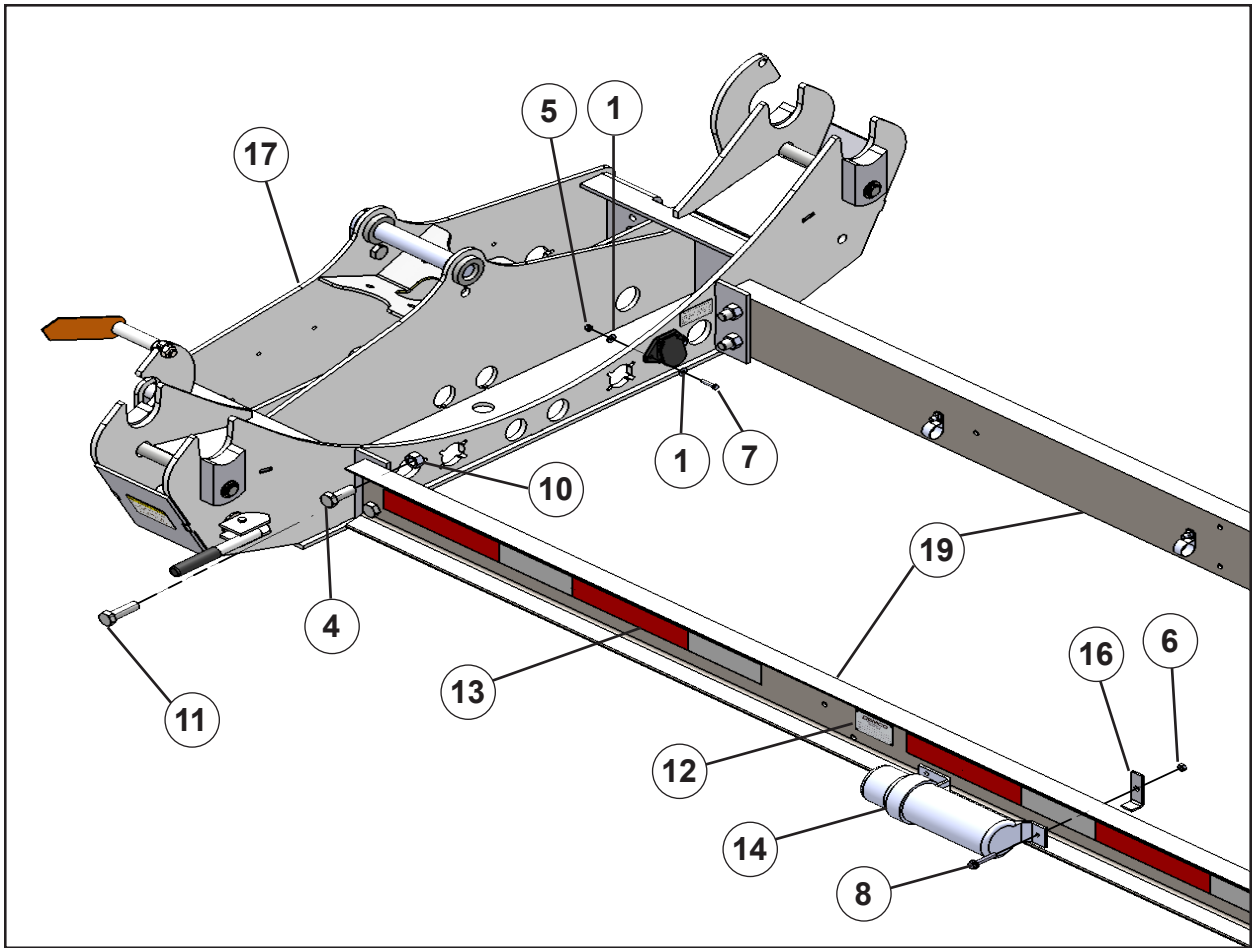

BOM ID	Qty	Item No	Description
1	4	1AF009D0000	1/4 FLAT WASHER ZINC
2	2	1AF009F0000	3/8 FLAT WASHER ZINC
3	†	1AFAP3809	1-1/4" HOSE SUPPORT CLAMP, 3/8" BOLT
4	8	1AFBP3139	HEX CAP SCREW, 3/4"-10 X 2", GR 5, PLATED
5	2	1AFBP3587	NUT, HEX, 1/4"-20, NYLOCK, PLATED
6	†	1AFBP3612	NUT, HEX LOCK, 3/8"-16, TOP LOCK, GRC, PLTD
7	2	1AFBP3648	HEX CAP SCREW, 1/4"-20 X 1-1/4" GR 8, PLTD
8	†	1AFBP3685	BOLT, FLNG HEAD, 3/8"-16 X 2", GR 8, PLTD
9	†	1AFBP3692	BOLT, FLNG HEAD, 3/8"-16 X 1", GR 8, PLTD
10	20	1AFC05L0005	3/4 CENTERLOCK NUT
11	12	1AFC12LBAH8	3/4 X 2-1/2 HEX BOLT GR 8, PLATED
12	1	1AQAL100000	DEEP ETCHED NAME PLATES
13	†	1AQAS000000	3M RED/WHT CONSPICUITY TAPE
14	1	1AU00000011	MANIFEST HOLDERS MWW
15	1	3C000351	TB ID COVER PLATE
16	†	3CAM8053	HOSE RETAINER, SINGLE
17	1	5CAM9185	TRUCK BOX PIVOT FRAME, FRONT
18	1	5CAM9186	TRUCK BOX PIVOT FRAME, REAR
19	2	‡	FRAME CHANNEL, XX' TRUCK BOX

† Part quantities vary by Truck Box length.

NOTE: A RED BOM ID# indicates an option.

‡ Item numbers vary by Truck Box length.

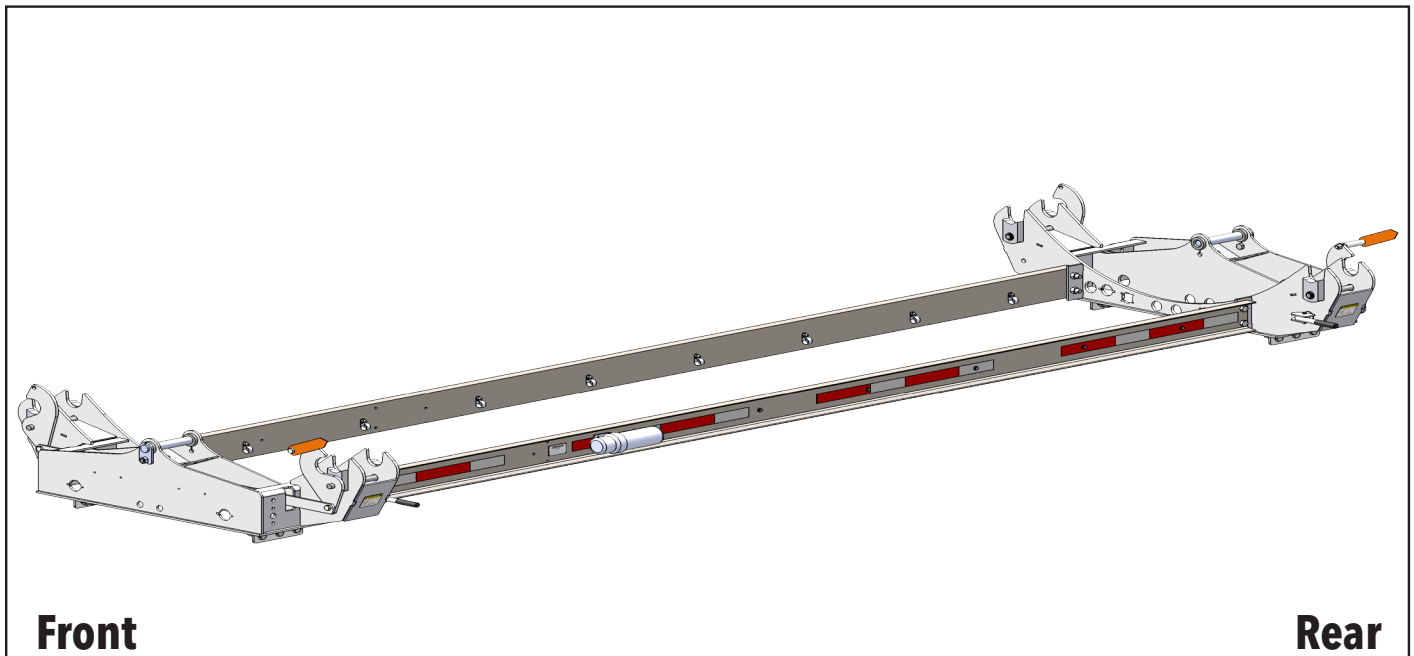

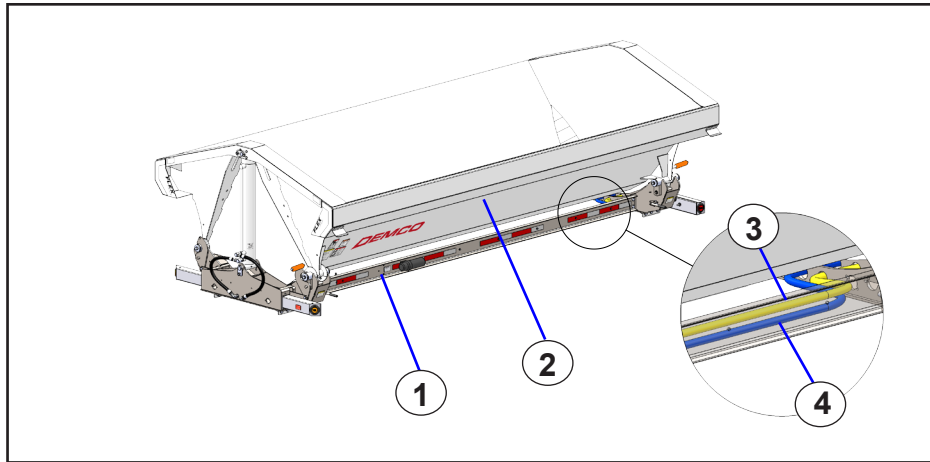

TRUCK BOX MODEL	BOM ID	Qty	Item No	Description
9CCRTB14	1	2	3CAM9438	FRAME CHANNEL, 14' TRUCK BOX
	2	1	5C000305	MY24 14' TUB, 1/4" AR450
	2	1	5C000331	MY24 14' TUB, 3/16" AR450
	3	1	1AKDP6630	HOSE, HYD, 3/4" X 133", 12FJX-12FJX
9CCRTB15	1	2	3CAM9436	FRAME CHANNEL, 15' TRUCK BOX
	2	1	5C000302	MY24 15' TUB, 1/4" AR450
	2	1	5C000328	MY24 15' TUB, 3/16" AR450
	3	1	1AKDP6544	HOSE, HYD, 3/4" X 144", 12FJX-12FJX
9CCRTB16	1	2	3CAM9187	FRAME CHANNEL, 16' TRUCK BOX
	2	1	5C000299	MY24 16' TUB, 1/4" AR450
	2	1	5C000325	MY24 16' TUB, 3/16" AR450
	3	1	1AKDP6557	HOSE, HYD, 3/4" X 157", 12FJX-12FJX
9CCRTB17	1	2	3CAM9434	FRAME CHANNEL, 17' TRUCK BOX
	2	1	5C000296	MY24 17' TUB, 1/4" AR450
	2	1	5C000322	MY24 17' TUB, 3/16" AR450
	3	1	1AKDP6624	HOSE, HYD, 3/4" X 169", 12FJX-12FJX
9CCRTB20	1	2	3CAM9439	FRAME CHANNEL, 20' TRUCK BOX
	2	1	5C000275	MY24 20' TUB, 1/4" AR450
	2	1	5C000209	MY24 20' TUB, 3/16" AR450
	3	1	1AKDP6632	HOSE, HYD, 3/4" X 205", 12FJX-12FJX
9CCRTB24	1	2	3C000201	FRAME CHANNEL, 24' TRUCK BOX
	2	1	5C000293	MY24 24' TUB, 1/4" AR450
	2	1	5C000319	MY24 24' TUB, 3/16" AR450
	3	1	1AKDP5338	HOSE, HYD, 3/4" X 234", 12FJX-12FJX
	4	1	1AKDP6585	HOSE, HYD, 3/4" X 280", 12FJX-12FJX

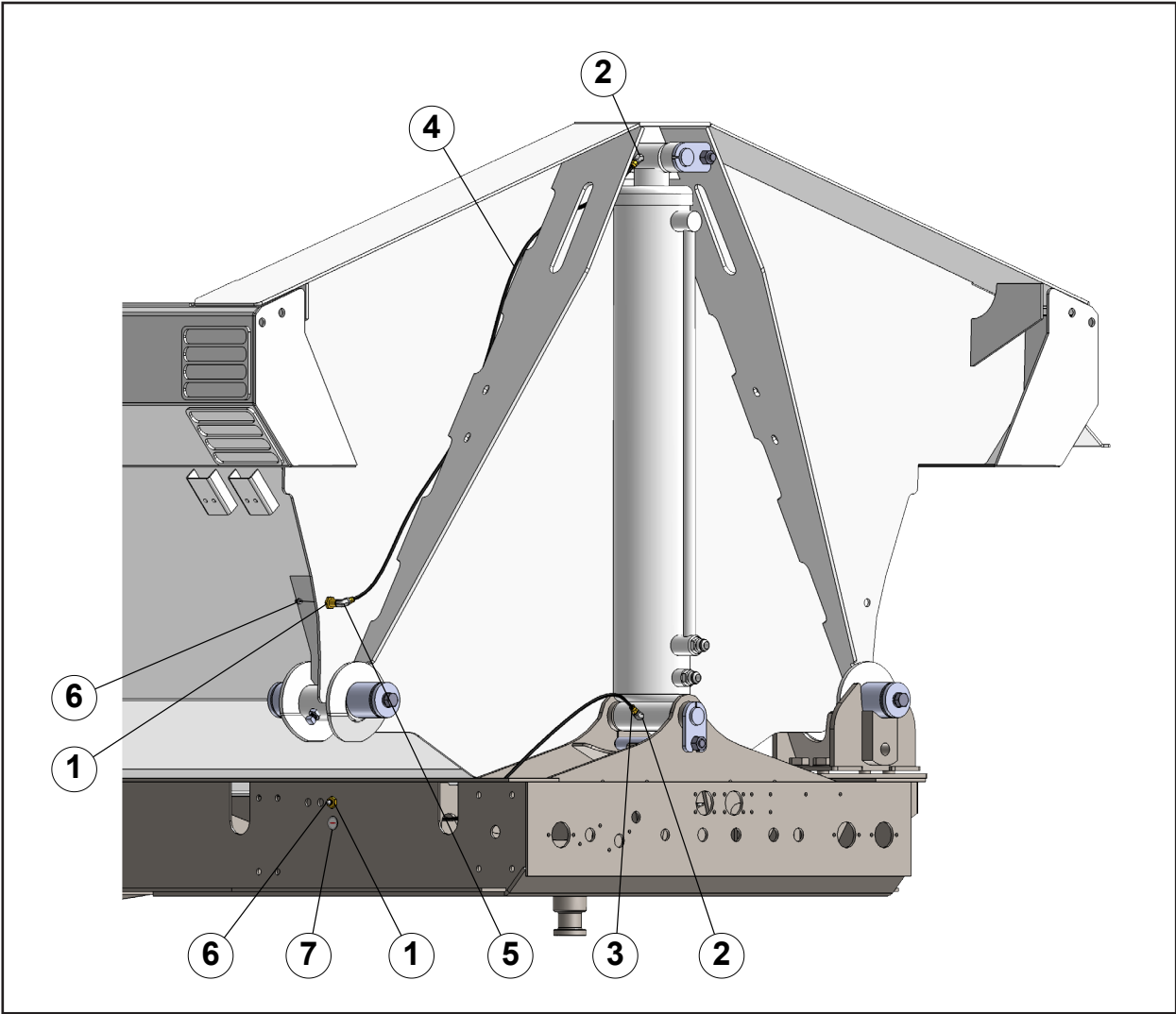

BOM ID	Qty	Item No	Description
1	4	1AFBP3423	BULKHEAD FITTING, 1/8" FNPT - 1/8" FNPT
2	4	1AKEABAAAA0	45 DEG ELBOW ADAPTER, 1/8" FNPT X 1/8" MNPT
3	2	1AKHAAAACA0	1/8" X 50" GREASE HOSE, 1/8" MNPT RIGID X 1/8" MNPT SWIV
4	2	1AKHAAAACA1	1/8" X 60" GREASE HOSE, 1/8" MNPT RIGID X 1/8" MNPT SWIV
5	2	1AKLABAAAA0	90 DEG ELBOW ADAPTER, 1/8" FNPT - 1/8" MNPT
6	4	1AKZAAA0000	1/8"-27 GREASE ZERK, STRAIGHT, PLTD
7	4	1AQBC015065	DECAL, GREASE GUN, RED ON WHITE

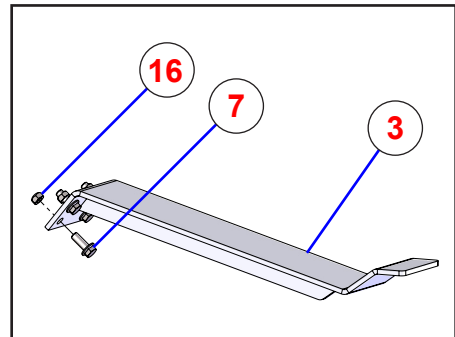
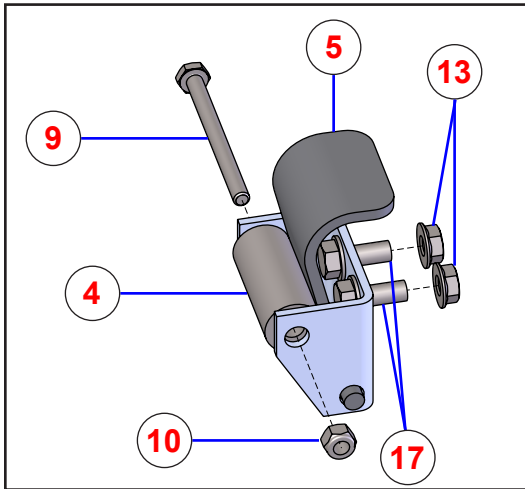
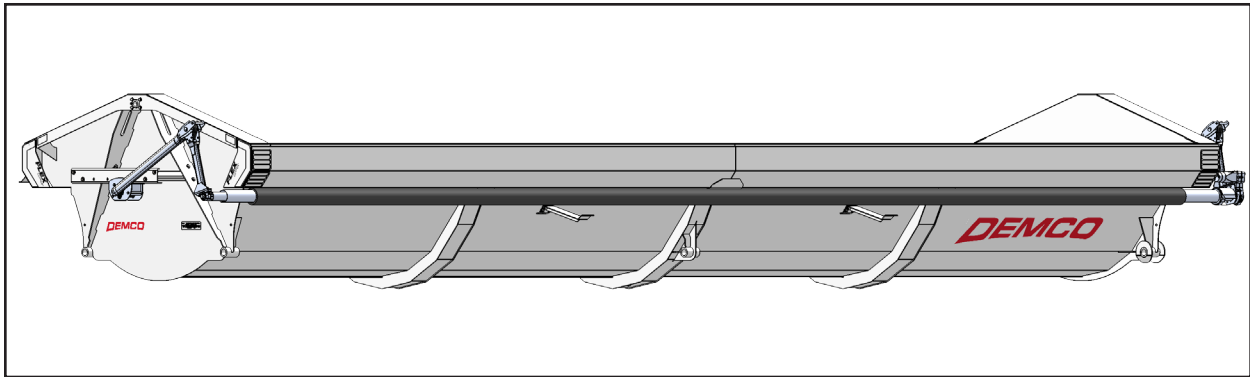
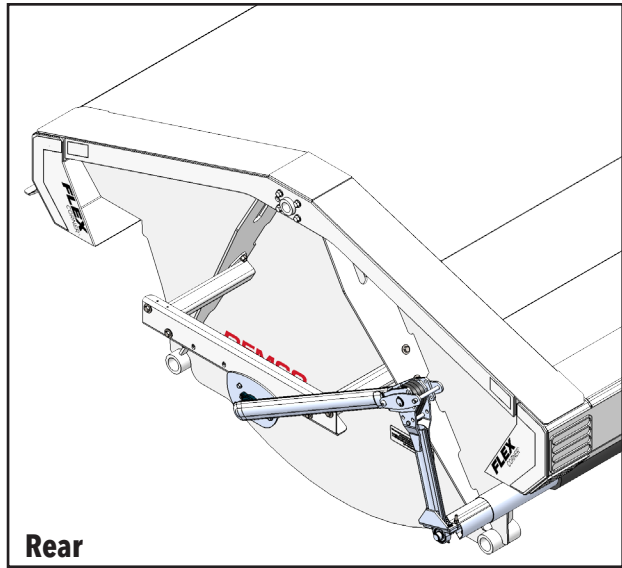
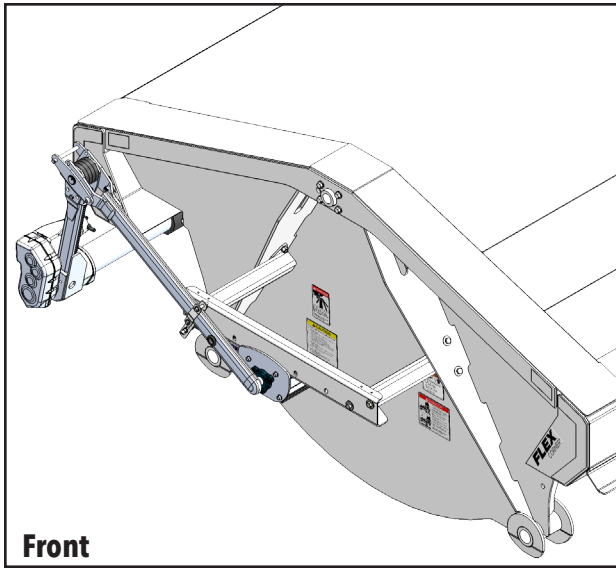

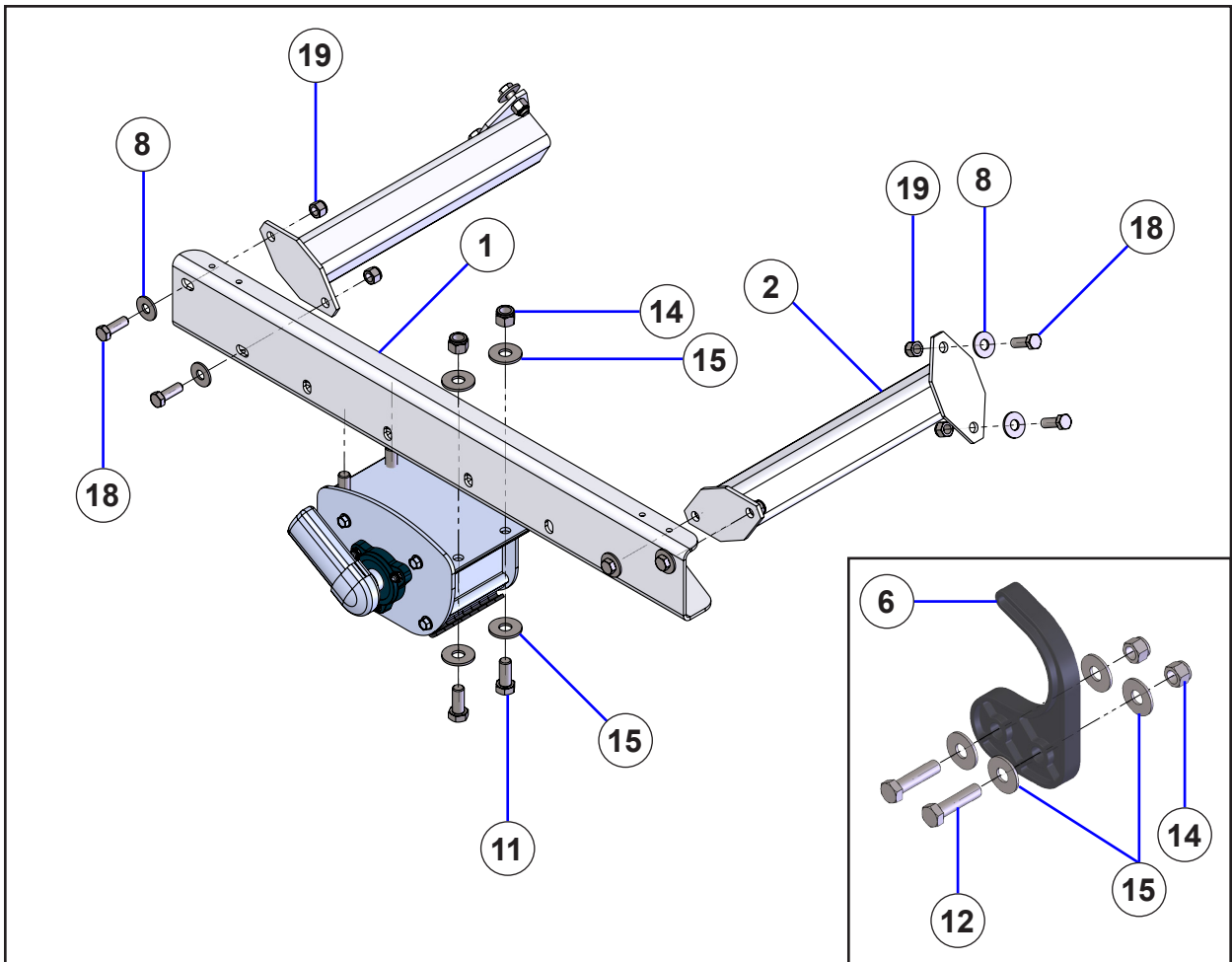

BOM ID	Qty	Item No	Description
1	2	3CAM9385	TARP MOUNTING CHANNEL
2	4	5CAM9038	TARP CHANNEL MOUNT
3	*	5C000008	BRACKET, TARP SUPPORT
4	*	1AUAM9073	SPACER, TARP MOUNTING, 7/8" OD X 11/32" ID X 2" OAL
5	*	1AZAP4108	CLAMP, STEEL CLAMP FOR TARP SECURING ROD PLTD, EA (36830)
6	2	1AZAP4152	SPOOL, TARP SPOOL HOOK FOR SIDE DUMP SYSTEM, EA (36840)
7	*	1AFC12FAA05	HEX CAP SCREW, 3/8"-16 X 1", GR 5, PLTD
8	16	1AF009H0000	WASHER, FLAT, 1/2", PLTD
9	*	1AFBP3588	HEX CAP SCREW, 1/4"-20 X 3", GR 8, PLTD
10	*	1AFC18D0000	NUT, HEX LOCK, 1/4"-20, NYLOCK, PLTD
11	4	1AFC12JAAH5	HEX CAP SCREW, 5/8"-11 X 1-1/2", GR 5, PLTD
12	4	1AFC12JBAH5	HEX CAP SCREW, 5/8"-11 X 2-1/2", GR 5, PLTD
13	*	1AFC08E0000	NUT, HEX SERRATED FLANGE, 5/16"-18, PLTD
14	12	1AFC18J0000	NUT, HEX LOCK, 5/8"-11, NYLOCK, PLTD
15	16	1AF009J0000	WASHER, FLAT, 5/8", PLTD
16	*	1AFBP3612	NUT, HEX LOCK, 3/8"-16, TOP LOCK, PLTD
17	*	1AFC37E00L0	HEX CAP SCREW, 5/16"-18 X 3/4", SERRATED FLANGE HD, PLTD
18	16	1AFC12HAAH8	HEX CAP SCREW, 1/2"-13 X 1-1/2" GR 8, PLTD
19	16	1AFC18H0000	NUT, HEX LOCK, 1/2"-13, NYLOCK, PLTD

* Quantities vary by tub length.

NOTE: A RED BOM ID# indicates an option.

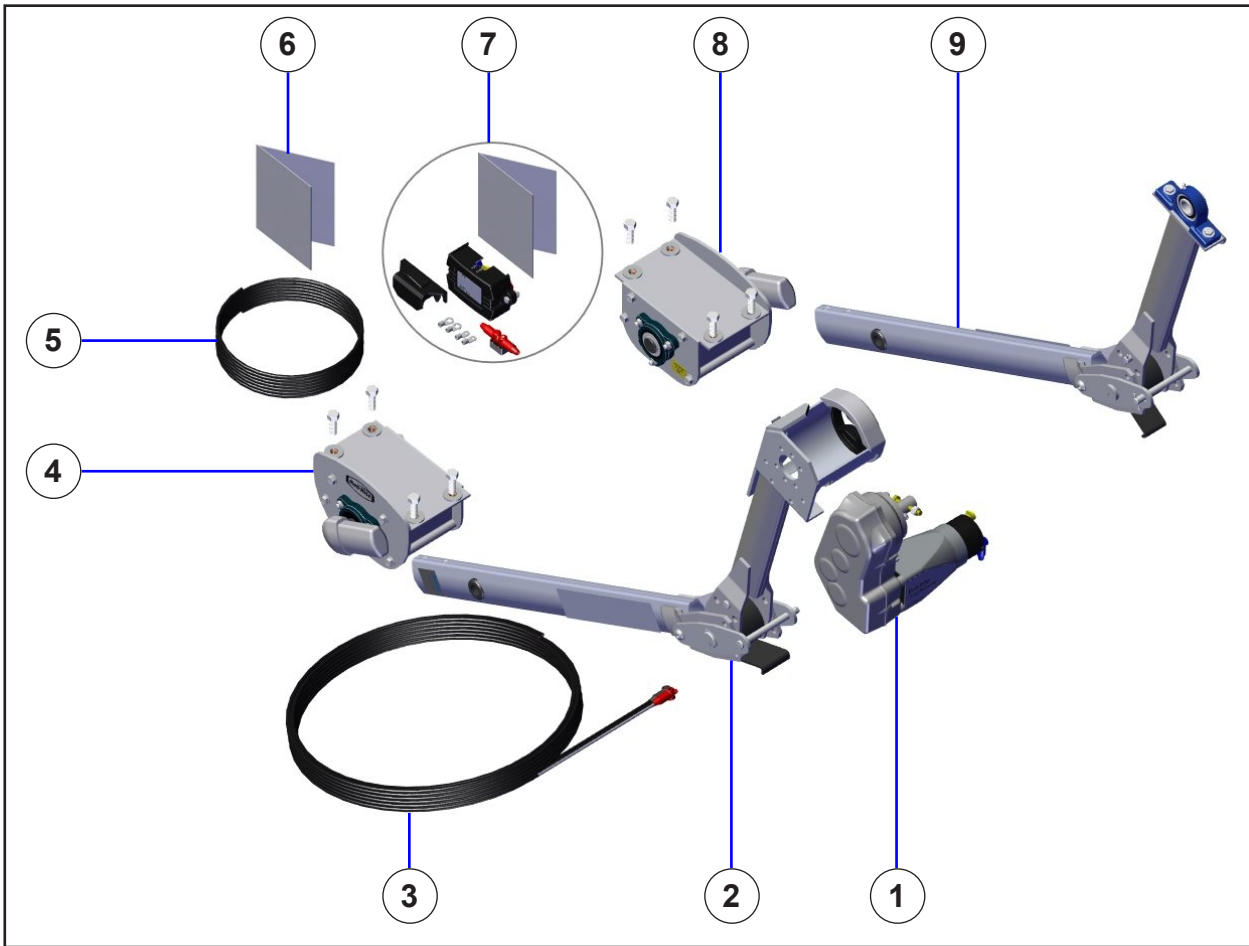

1AZAP3576 (Rite-Lock Power Arm Kit, Pass. Side Stowing for Side Dump 12V TS)			
BOM ID	Qty	Item No	Description
1	1	1AZAP4293	MOTOR, ROLL RITE TARP (10200)
2	1	-	PIVOT, ASSY FRONT 4-SPRING KNUCKLE ARM, MOTOR END (46802)
3	1	1AEW000WF62	PARALLEL BAT CABLE, 6GA, BLK W/RED (11330)
4	1	-	PIVOT, UB ASSEMBLED STS 8-SPR FRONT (102354)
5	1	1AZAP4295	CABLE, 16GA / 3COND, BLU/YEL/RED, 15' (11411)
6	1	-	INSTRUCTIONS, UNIVERSAL STS DUMP SYSTEM (102317)
7	1	1AZ00103460	ELECTRIC KIT, TSCM W/ SS GEN1+ RELAY & ROCKER SW, 6GA (103460)
8	1	-	PIVOT, UB ASSEMBLED STS 8-SPR REAR (102353)
9	1	-	PIVOT, ASSY REAR KNUCKLE ARM, NON-MOTOR END (46803)

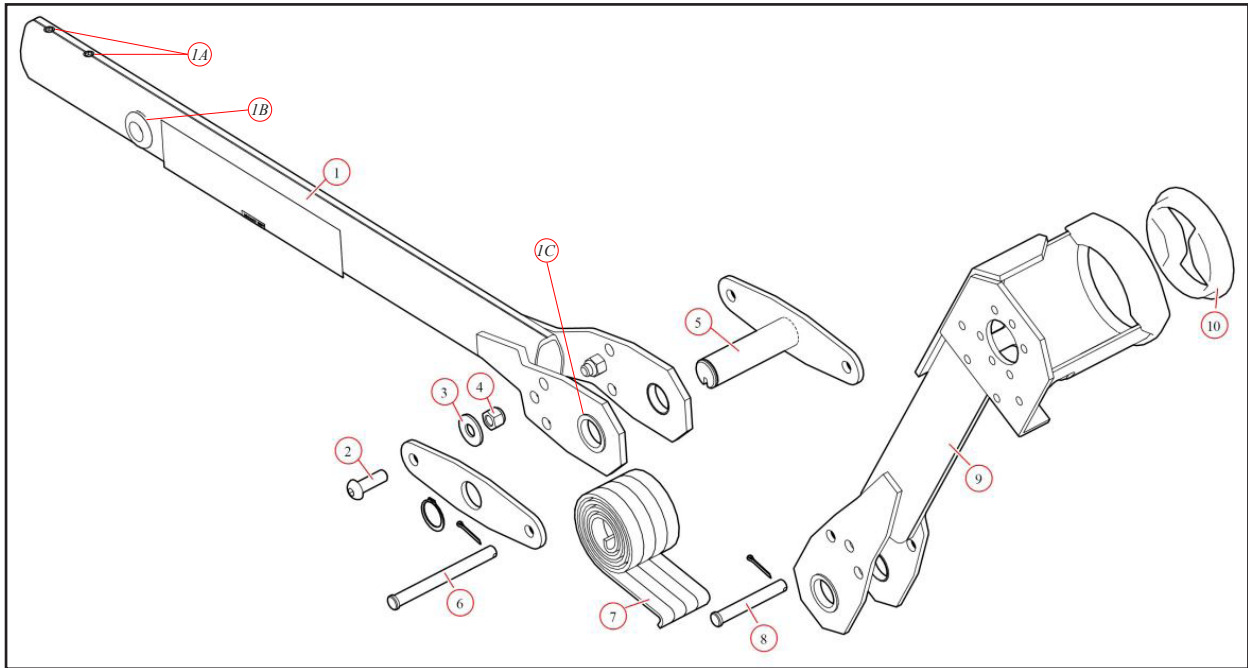

Pivot, Assy Front 4-Spring Knuckle Arm, Motor End (46802)

BOM ID	Qty	Item No	Description
* 1	1	-	PIVOT TUBE, BASE W/SIDE PLATES, 4 SPRING STS KNUCKLES (102199)
1A	1	-	SCREW, 1/2" X 5/8" SET (18291)
1B	1	-	GROMMET, RUBBER 7/8 ID X 1/8 GROOVE FOR TOP MT PIVOTS (16419)
1C	1	-	BUSHING, 1-1/4 POLY T-BUSHING FOR PIVOT PIN (47040)
2	2	-	BOLT, 1/2" X 1-1/2" BUTTON HEAD PLTD (18295)
3	2	1AF009H0000	WASHER, 1/2" FLAT PLTD (18412)
4	2	1AFC18H0000	NUT, 1/2" NYLOCK NUT PLTD (18631)
5	1	-	BRACKET, 4-SP KNUCKLE W/STOP PLATE FOR STS MOTOR END (47970)
6	1	-	PIN, 1/2" X 5-1/4" CLEVIS (18540)
7	4	1AZAP4589	SPRING, SPIRAL TORSION 1-1/4" (47230)
8	1	1AFAP4507	PIN, 1/2" X 3-1/2" CLEVIS (18520)
9	1	-	PIVOT TUBE, FRONT UPPER FOR 4-SP KNUCK W/BUSH 13.06" (102197)
10	1	1AZAP4539	BUSHING, AXLE STABILIZER FOR 4" AXLE (37580)

* Note: All High Capacity Kits require longer lower tarp arms.

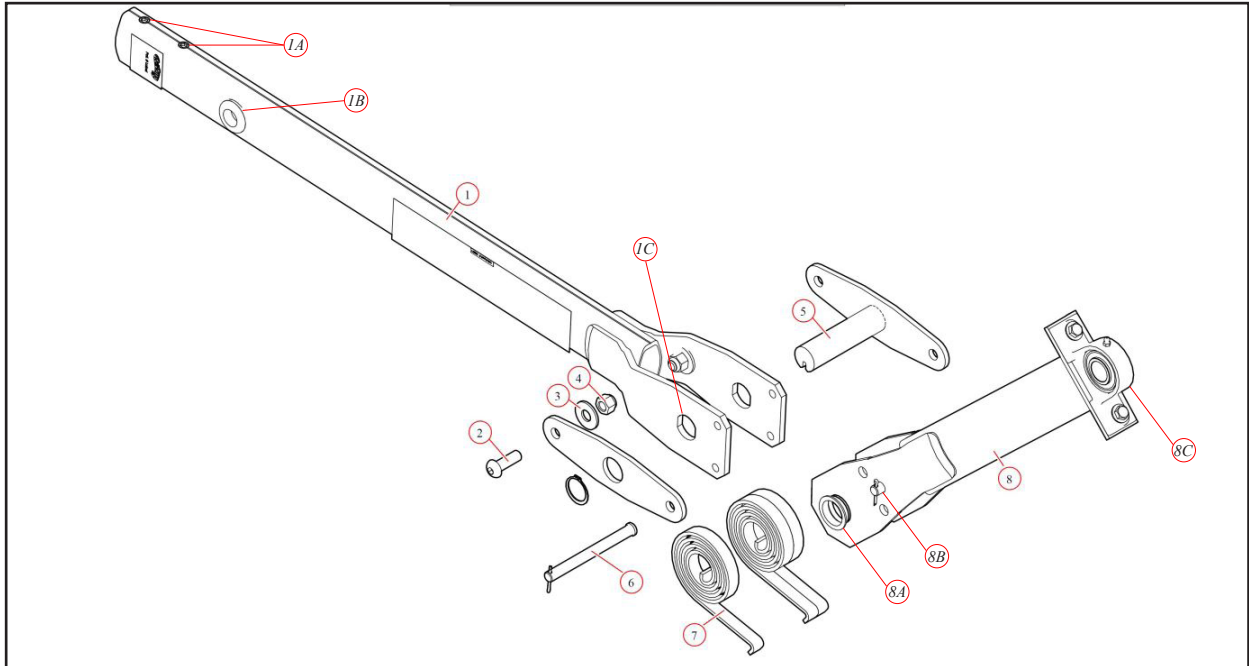

Pivot, Assy Rear Knuckle Arm, Non-Motor End (46803)

BOM ID	Qty	Item No	Description
* 1	1	-	PIVOT TUBE, BASE W/SIDE PLATES, 4-SPRING STS KNUCKLES (102199)
1A	1	-	SCREW, 1/2" X 5/8" SET (18291)
1B	1	-	GROMMET, RUBBER 7/8 ID X 1/8 GROOVE FOR TOP MT PIVOTS (16419)
1C	1	-	BUSHING, 1-1/4 POLY T-BUSHING FOR PIVOT PIN (47040)
2	2	-	BOLT, 1/2" X 1-1/2" BUTTON HEAD PLTD (18295)
3	2	1AF009H0000	WASHER, 1/2" FLAT PLTD (18412)
4	2	1AFC18H0000	NUT, 1/2" NYLOCK NUT PLTD (18631)
5	1	-	BRACKET, 4-SP KNUCKLE W/STOP PLATE FOR STS MOTOR END (47970)
6	1	-	PIN, 1/2" X 5-1/4" CLEVIS (18540)
7	4	1AZAP4589	SPRING, SPIRAL TORSION 1-1/4" (47230)
8	1	-	PIVOT TUBE, REAR UPPER FOR 4-SP KNUCKLE W/BEARING (47890)
8A	1	-	BUSHING, 1-1/4 POLY T-BUSHING FOR PIVOT PIN (47040)
8B	1	1AFAP4507	PIN, 1/2" X 3-1/2" CLEVIS (18520)
8C	1	1AZ31050000	BEARING, PILLOW BLOCK (31055)

* Note: All High Capacity Kits require longer lower tarp arms see page 41 for High Capacity specific tarp parts.

Pivot, UB Assembled STS 8-Spr Front (102354)			
BOM ID	Qty	Item No	Description
1	1	-	PIVOT PIN, FOR 8-SPR ROLLER BEARING PIV, DRIVER SIDE (47400)
2	2	-	BEARING, CARRIER UNDERBODY FLANGED (47800)
2A	3	1AFC18F0000	NUT, 3/8" NYLOCK NUT PLTD (18628)
2B	3	1AFBP3633	BOLT, 3/8-16 X 1-1/8", BUTTON HEAD, PLTD (18242)
3	8	1AZAP4589	SPRING, SPIRAL TORSION 1-1/4" (47230)
4	8	1AFC37FAAH5	BOLT, 3/8 X 1-1/2", THREAD-CUTTING SCREW, HEX WASHER HD (18120)
5	1	-	PLATE, AL FRONT FOR EXT BOLT FLANGE MOUNT UB BOX (102349)
6	1	-	BRACKET, EXT BODY WITH HOLES FOR 8-SPR UB BOX (102269)
7	1	-	PLATE, AL BACK FOR EXT BOLT FLANGE MOUNT UB BOX (102259)

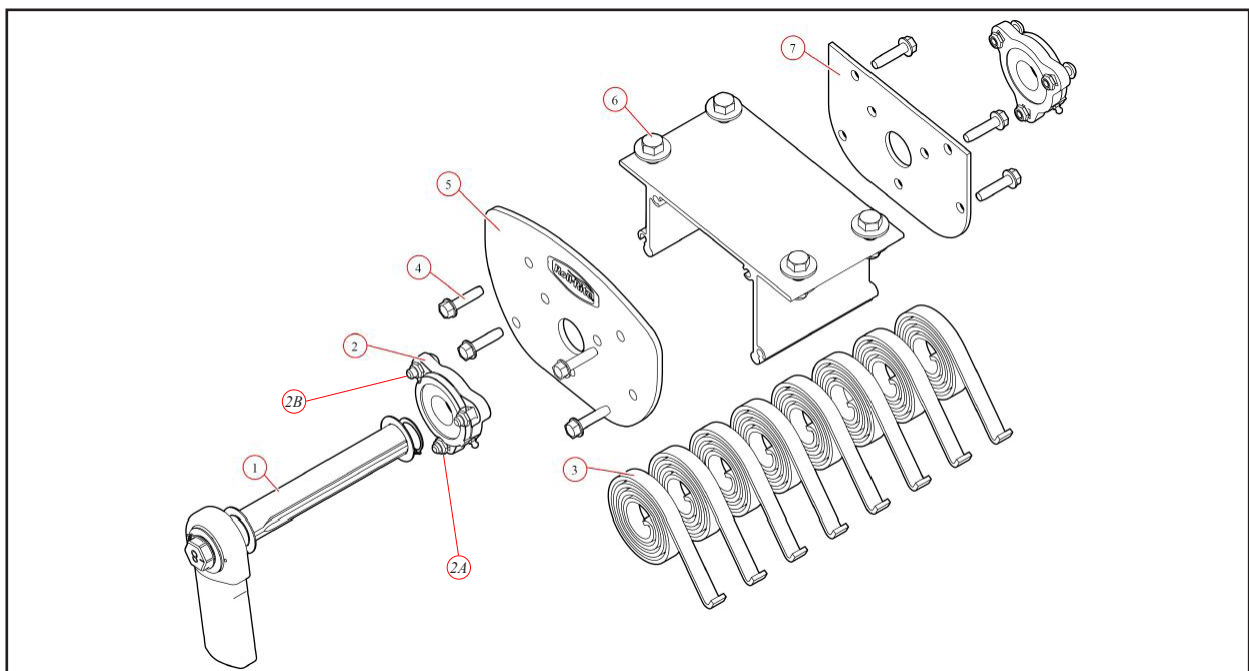

Pivot, UB Assembled STS 8-Spr Rear (102353)			
BOM ID	Qty	Item No	Description
1	1	-	PIVOT PIN, FOR 8-SPR ROLLER BEARING PIV, PASS SIDE (47410)
2	2	-	BEARING, CARRIER UNDERBODY FLANGED (47800)
2A	3	1AFC18F0000	NUT, 3/8" NYLOCK NUT PLTD (18628)
2B	3	1AFBP3633	BOLT, 3/8-16 X 1-1/8", BUTTON HEAD, PLTD (18242)
3	8	1AZAP4589	SPRING, SPIRAL TORSION 1-1/4" (47230)
4	8	1AFC37FAAH5	BOLT, 3/8 X 1-1/2", THREAD-CUTTING SCREW, HEX WASHER HD (18120)
5	1	-	PLATE, AL FRONT FOR EXT BOLT FLANGE MOUNT UB BOX (102349)
6	1	-	BRACKET, EXT BODY WITH HOLES FOR 8-SPR UB BOX (102269)
7	1	-	PLATE, AL BACK FOR EXT BOLT FLANGE MOUNT UB BOX (102259)

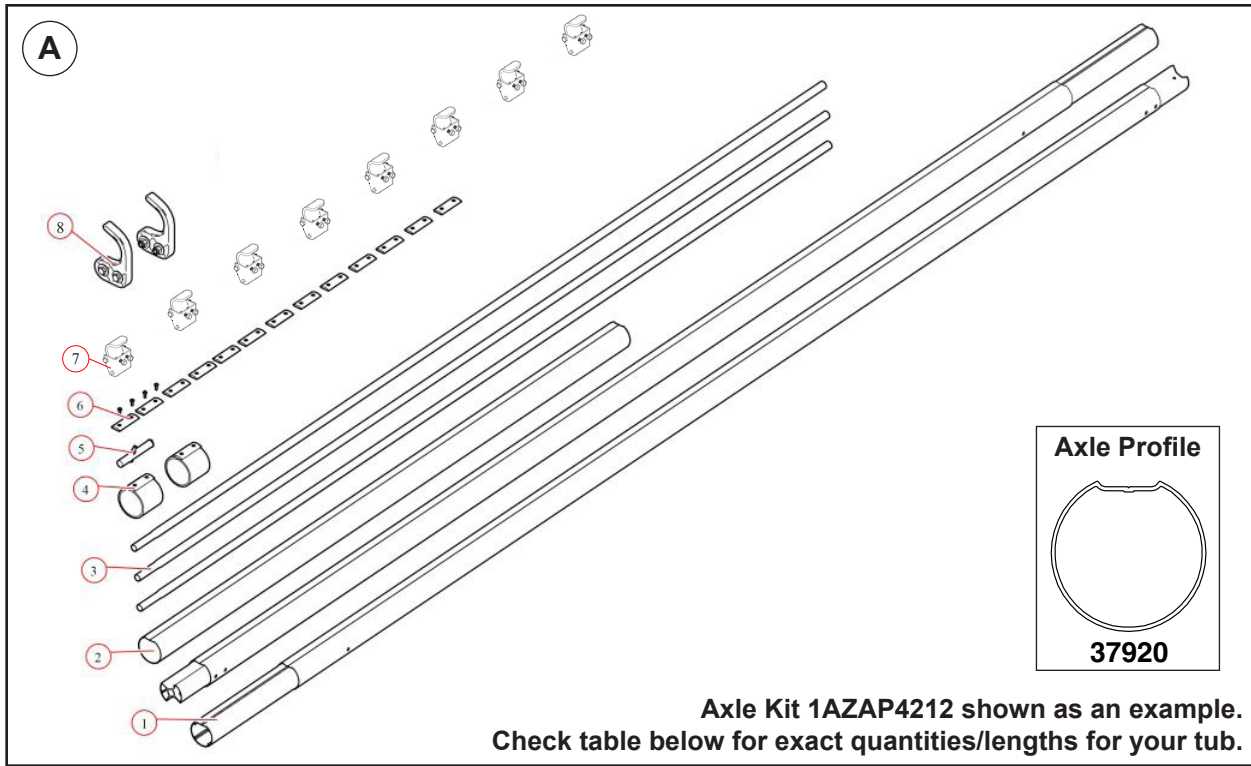

(A)	(1) + (2)	(3)	(6)	(7)	
Tub Length	Axle Kit Item No	Axle Tube Length	Fixed Tarp Rod Length	Axle Tarp Clips (C/C)	Tarp Rod Clamps (1AZAP4108)
14'	1AZAP4279	17' - 2 1/2"	13' - 8 1/4"	6 (32")	6
15'	1AZAP4279	18' - 2 1/2"	14' - 8 1/4"	6 (34")	6
16'	1AZAP4279	19' - 3"	15' - 8 3/4"	6 (36")	6
17'	1AZAP4459	20' - 2 1/2"	16' - 8 1/4"	6 (38")	6
20'	1AZAP4459	23' - 3"	19' - 9 1/4"	7 (38")	6
24'	1AZAP4410	27' - 3"	23' - 9"	10 (32")	6
30'	1AZAP4212	33' - 6"	30' - 0 3/8"	11 (36")	8
34'	1AZAP4212	37' - 6"	34' - 0 1/2"	11 (40")	8
37'	1AZAP4563	40' - 3"	36' - 9 1/4"	11 (44")	8

BOM ID	Qty	Item No	Description
1		-	AXLE, 4" UNIVERSAL FRONT/REAR SECTION FOR SIDE DUMP (37920)
2		-	EXTRUSION, 4" AXLE, 98" (102367)
3		-	STEEL TUBING, 1.125D X 16GA X 12' RND GALV W/SWEDGE (101815)
4	2	-	AXLE SLEEVE, SIDE DUMP BELT STYLE, AXLE SLEEVE KIT (102379)
5	1	-	HARDWARE, STUB SHAFT KIT FOR SIDE DUMP SYSTEM (102365)
6		-	CLIP, TARP CLIP W/HARDWARE FOR STS AXLE (37830)
7		1AZAP4108	CLAMP, STEEL CLAMP FOR TARP SECURING ROD PLTD, EA (36830)
8	2	1AZAP4095	SPOOL, TARP SPOOL HOOK FOR SIDE DUMP SYSTEM, EA (36840)

Tub Length	Tarp Kit	Mesh Tarp	Tarp Size
14'	1AZAP3576	1AZAP4598	13'-6" x 162"
15'	1AZAP3576	1AZAP4599	14'-6" x 162"
16'	1AZAP3576	1AZAP4600	15'-6" x 162"
17'	1AZAP3576	1AZAP4601	16'-6" x 162"
20'	1AZAP3576	1AZAP4602	19'-7" x 162"
24'	1AZAP3576	1AZJ23800RE	23'-8" x 162"
30'	1AZAP3576	1AZAP4603	29'-10" x 162"
34'	1AZAP3576	1AZAP4604	33'-10" x 162"
37'	1AZAP3576	1AZAP4605	36'-7" x 162"

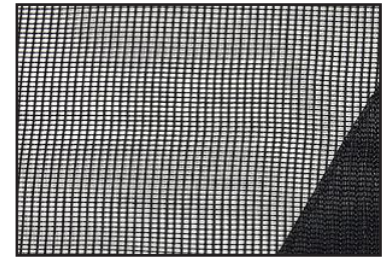

Mesh Tarp

Roll-Rite Electric Tarp Parts for High-Capacity Kits Only

Tub Length	Axle Kit	Tarp Kit	Mesh Tarp	Tarp Size	Axle Tube Length	Fixed Tarp Rod Length
20' H.C.	1AZAP4459	1AZAP4402	-	20' x 147"	23' - 3"	20' - 1 3/4"
24' H.C.	1AZAP4410	1AZAP4402	1AZAP4409	24' x 147"	27' - 3"	24' - 1 1/2"
34' H.C.	1AZAP4212	1AZAP4402	1AZAP3950	34' x 147"	37' - 6"	34' - 4 3/4"
37' H.C.	1AZAP4563	1AZAP4402	1AZAP4562	37' x 147"	40' - 3"	37' - 1 3/4"

Note: All High Capacity Kits, including XL Kits, use the same quantity and spacing of Axle Tarp Clips and Tarp Rod Clamps as standard tubs. Longer lower tarp arms are required for all High Capacity Kits - use Item Number 1AZ102266RE (ROLL-RITE HIGH CAPACITY TARP ARM, EA, #102266).

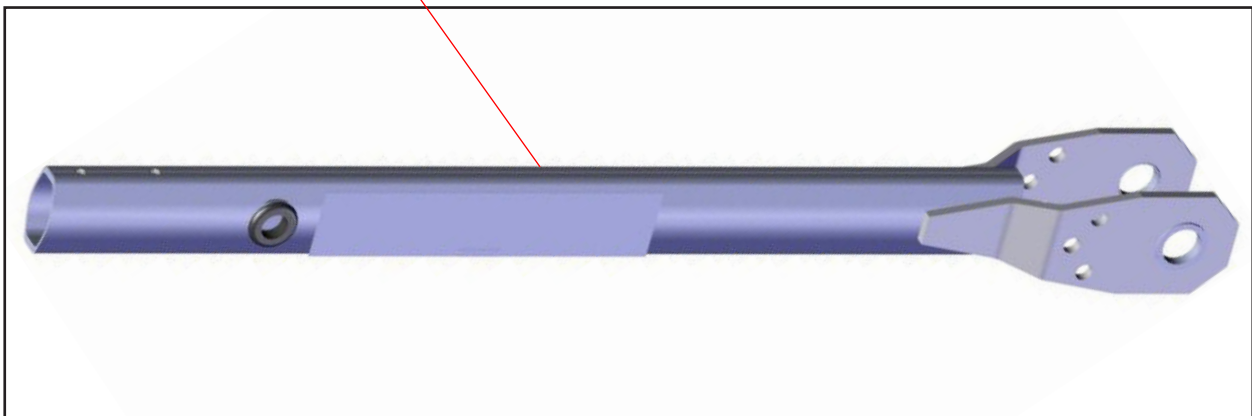

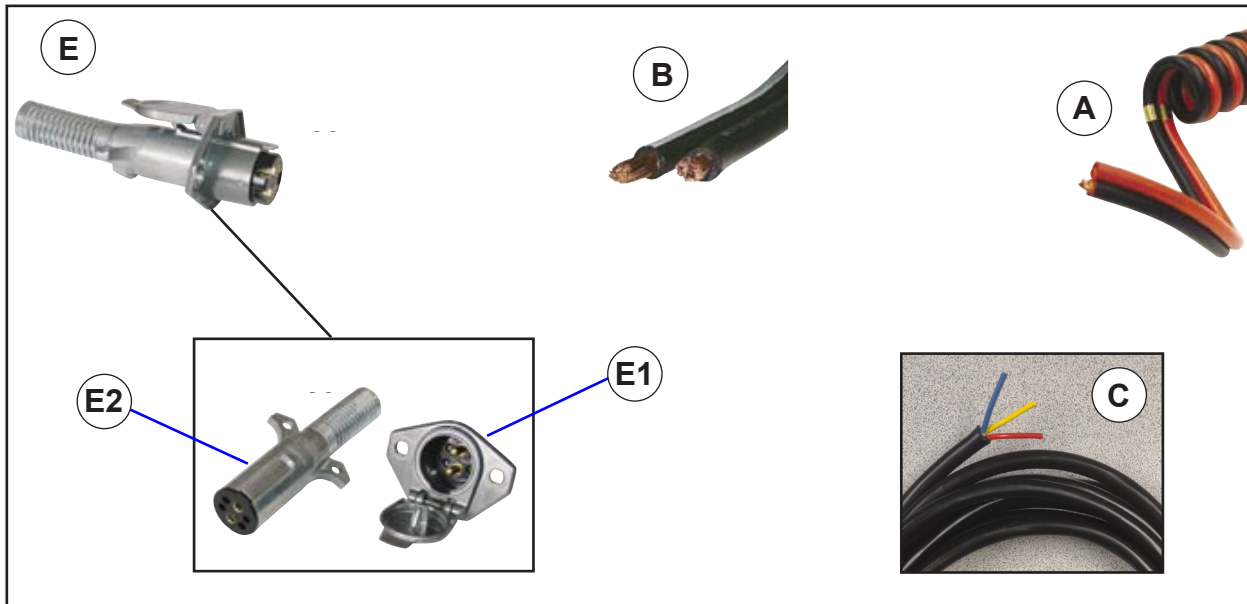
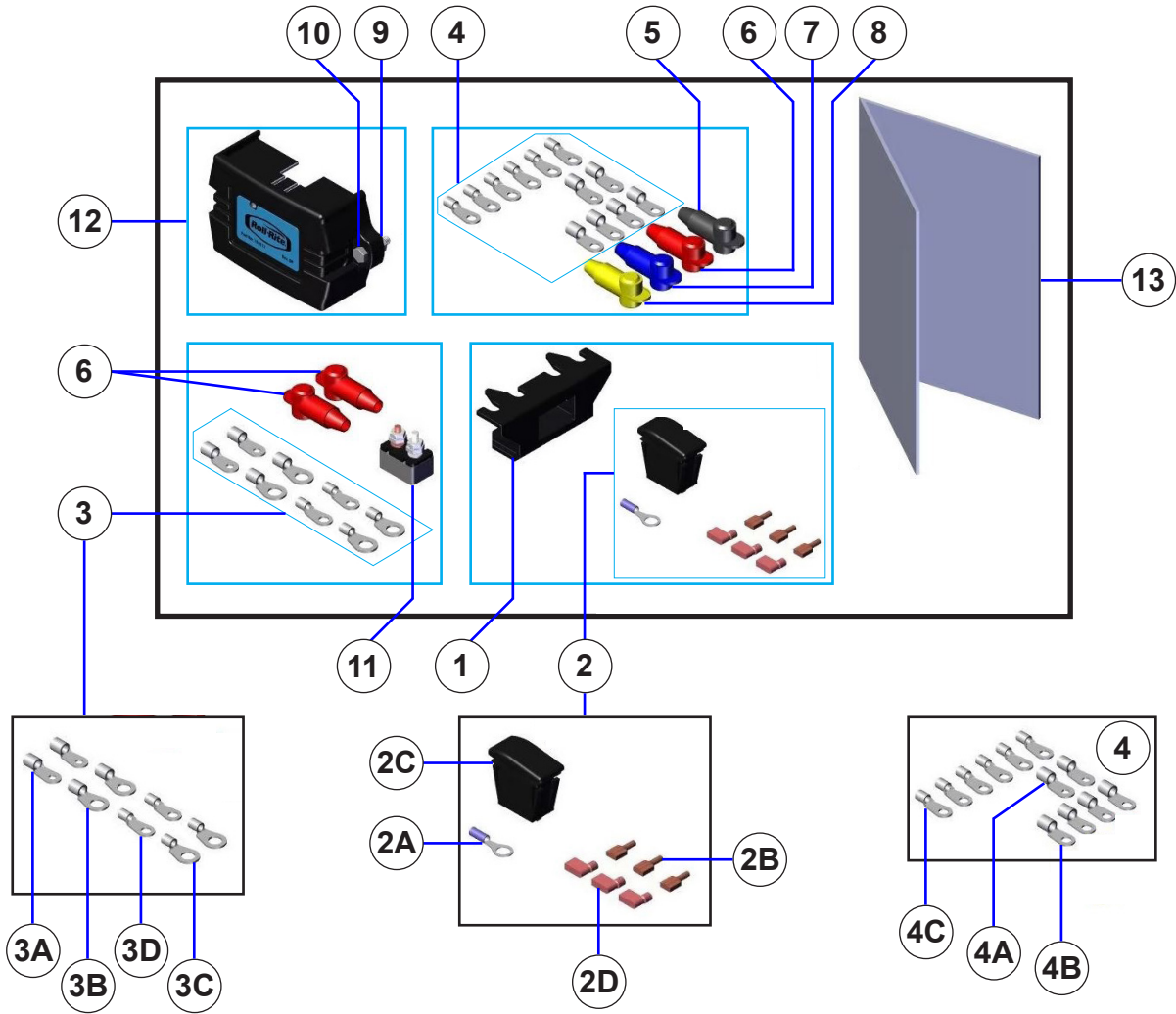

1AZ00103460 (Electric Kit, TSCM W/SS Gen1+ Relay & Rocker Switch, 6GA)			
BOM ID	Qty	Item No	Description
1	1	1AZ00010390	MOUNT BRACKET, ROCKER SWITCH (10390)
2	1	-	ROCKER SWITCH KIT (10915)
2A	1	1AEC0031506	TERMINAL, 14 GA INSULATED, 3/8" RING (16080)
2B	3	-	TERMINAL, 18 GA INSULATED, Q.D. FEMALE (16118)
2C	1	1AZ00019300	SWITCH, ROCKER (OPEN/CLOSE) (19300)
2D	3	-	TERMINAL, 14-16 GA INSULATED, Q.D. FLAG FEMALE (100460)
3	1	-	TERMINAL KIT FOR CIRC. BREAKER, 6/8 GA TERMINALS (10918)
3A	2	-	TERMINAL, 6 GA, #10 RING (16020)
3B	2	1AEC0036073	TERMINAL, 6 GA, 3/8" RING (16030)
3C	2	-	TERMINAL, 8 GA, 3/8" RING (16150)
3D	2	1AEC0033002	TERMINAL, 8 GA, 1/4" RING (16155)
4	1	-	TERMINAL KIT FOR SS RELAY, 6/8 GA TERMINALS (10919)
4A	2	-	TERMINAL, 6 GA, #10 RING (16020)
4B	4	1AEC0036071	TERMINAL, 6 GA, 1/4" RING (16021)
4C	6	1AEC0033002	TERMINAL, 8 GA, 1/4" RING (16155)
5	1	-	TERMINAL BOOT, BLACK, 8-2GA (16200)
6	3	-	TERMINAL BOOT, RED, 8-2GA (16201)
7	1	-	TERMINAL BOOT, BLUE, 8-2GA (16202)
8	1	-	TERMINAL BOOT, YELLOW, 8-2GA (16203)
9	2	1AFC08D0000	HEX NUT, 1/4-20 FLANGE, SERRATED, PLTD (18620)
10	2	1AFC12DAA05	HEX BOLT, 1/4-20 X 1", GR5, PLTD (18700)
11	1	1AZ00101259	50A MANUAL RESET CIRCUIT BREAKER, RITE TOUCH (101259)
12	1	1AZ00103238	12V RITE TOUCH RELAY SS GEN1+ W/HOUSING (103238)
13	-	-	ELECTRICAL COMPONENT INSTALLATION GUIDE (105568)

TO ADD TARP CONTROLS TO A SECOND TRACTOR FOR A STANDARD HYDRAULIC SIDE DUMP, SEE YOUR DEALER FOR COMPLETE KIT AND PRICING FOR [4CFK2014 \(KIT, ROLL-RITE TARP, CONTROL SWITCH FOR 2ND TRACTOR\)](#). FOR EOH TRAILERS, SEE PAGE 49.

Other Electrical Components for Roll-Rite Tarps			
BOM ID	Qty	Item No	Description
A	-	1AZ00011320	6GA DUAL COILED CORD (11320)
B	-	1AEW000WF62	PARALLEL BAT CABLE, 6GA, BLK W/RED (11330)
C	-	1AZAP4295	CABLE, 16GA / 3COND, BLU/YEL/RED, 15' (11411)
E	-	1AZAP4211	MALE & FEMALE PLUG SET, 2-PIN, ROLL-RITE TARP (12760)
E1	1	1AZAP4236	FEMALE PLUG, 2-PIN, ROLL-RITE TARP (12770)
E2	1	1AZAP4235	MALE PLUG, 2-PIN, ROLL-RITE TARP (12780)

**Roll-Rite Generation 1+ Solid State Reversing Relay with Rocker Switch
(Tarp Uncovering to the right of driver)**

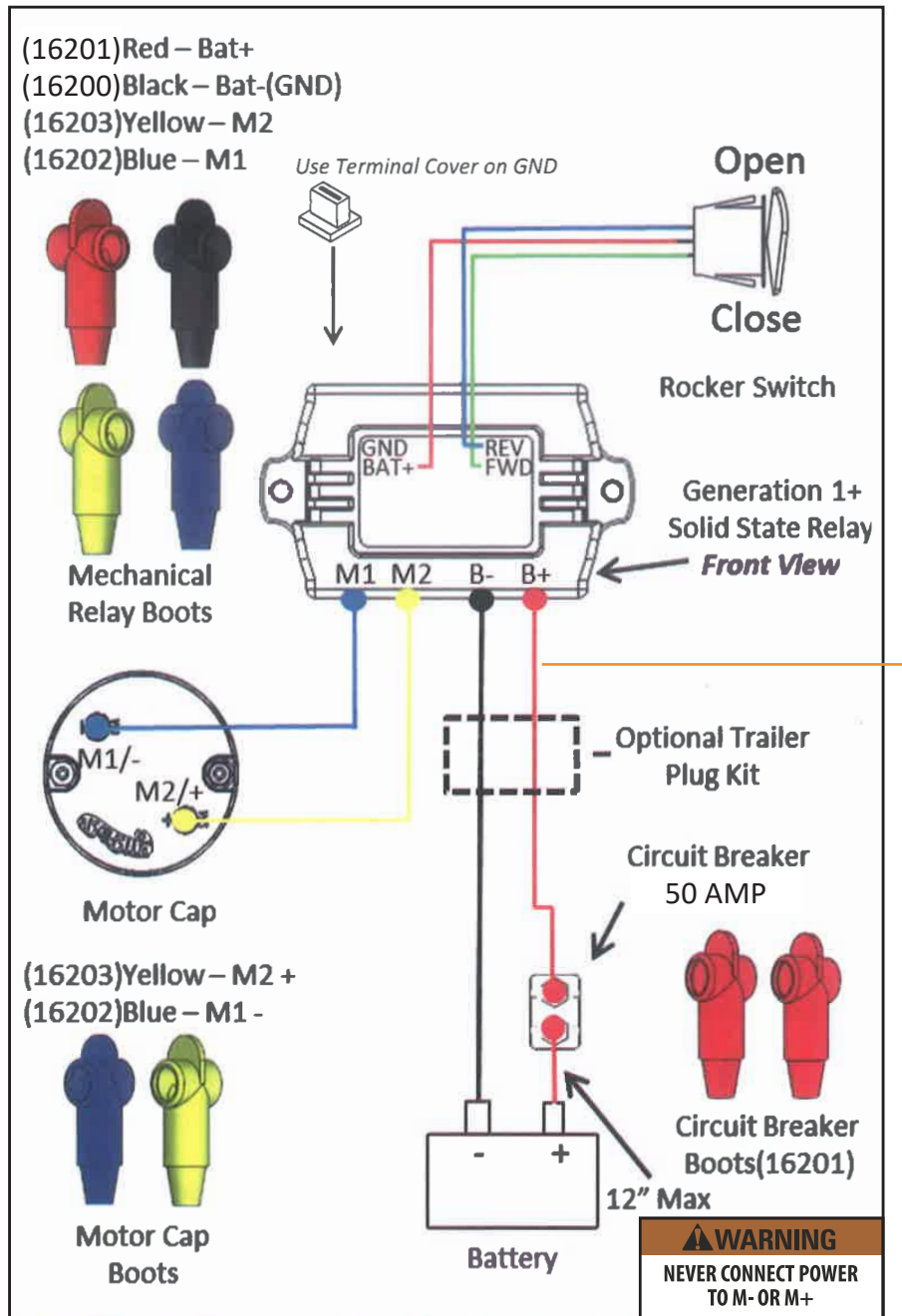

WARNING

Note: After installation, the terminals on the B+ circuit contain un-switched 12V energy at all times. Installation requirements must be followed to avoid contact between these terminals and chassis ground.

Wiring the Tractor

There are two items to wire on the tractor before you can operate your Demco side dump. The control box and the tarp power wire.

To install the control box, find a suitable location in the cab of the tractor and mount the control box. The red and black two wire cable attached to the back of the box is the power wire. Plug the cigarette lighter end into a power connection in the cab.

If you do not have an available outlet for the cigarette lighter end, use the following instructions:

- Cut the cigarette lighter plug off.
- Split apart the wires and connect the red wire to a 12v dc power source and the black to ground.
-  - **Red wire must be positive and Black negative. Reversing these wires can damage the control system.**
- A bag of terminals is included to allow you to tap into most truck fuse panels.

Route the gray cord and male 9 pole plug out of the cab and to the front bulkhead of the side dump. Plug the cord into the female 9 pole socket on the trailer bulkhead. You will now be able to raise and lower the rear axle and dump the tub.

NOTE: Air must be supplied to the side dump for the lift axle to operate properly. Hydraulic oil must be supplied to the side dump to dump the tub.

To use the tarp you will need to supply 12 volt power to the side dump to operate the tarp motor. Due to the large power draw of the tarp motor, the electrical supply must be hooked directly to the battery and the heavy #6 wire included with the kit must be used.

Refer to the Roll Rite wiring diagram for reference. The relay has been already mounted on the side dump and the momentary switch that rolls/unrolls the tarp is in the control box installed previously. All that needs to be done is to run a wire from the battery to the female two pole socket on the road side front corner of the side dump.

Locate the circuit breaker as close to the positive battery post as possible. If the circuit breaker is not mounted to the battery box or truck frame, make sure that the terminals cannot touch anything that would create a short circuit. See image on next page for installation orientation of circuit breaker.

Separate enough of the white wire on the #6 white/black cord to reach from the positive battery terminal to the circuit breaker. Cut off the white wire. Strip the white wire and crimp on ring terminals to match the battery cable bolt and the post on the circuit breaker.



Do not hook the white wire to the battery until everything else is wired.

Crimp a ring terminal on the white wire on the remaining white/black cord and attach it to the circuit breaker.

Crimp a ring terminal on the black wire and attach it to the negative battery post.

Route the white/black cord to the female socket on the side dump. Cut the cord and strip the ends back to slip into the terminals on the back of the male 2 pin plug. Match the white and black wires to the corresponding wires in the side dump socket. You may need to slip the cover off the back of the socket to make sure that the wires match up. Secure the white/black cord to the truck frame.

Hook the white wire to the battery.

The tarp will now operate from the control box. It is best to have the tractor running while operating the tarp.

Hydraulic Hook-Up

The tractor must have a hydraulic pump and reservoir to supply hydraulic oil to the side dump to dump the tub. The pump needs to supply a minimum output of 25 gallons per minute of oil at 2500psi. We recommend a minimum 15 gallon filtered and strained reservoir system. The tractor should also have a relief valve to protect the tractor's hydraulic system.

When hooking the tractor to the side dump, the pressure line from the pump must hook up to the female quick coupler on the side dump and the return to the reservoir must hook up to the male quick coupler. The control valve on the side dump will not operate properly if the oil flow is reversed. The quick couplers on the side dump are marked "in" and "out" as a reminder.

The following Demco mounting parts are needed if an Aero Electric Tarp option is added. Please contact Aero directly at 1-800-535-9545 or online at www.aeroindustries.com.

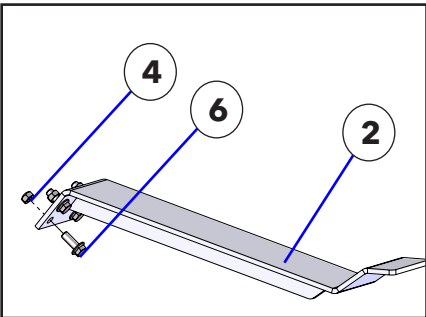
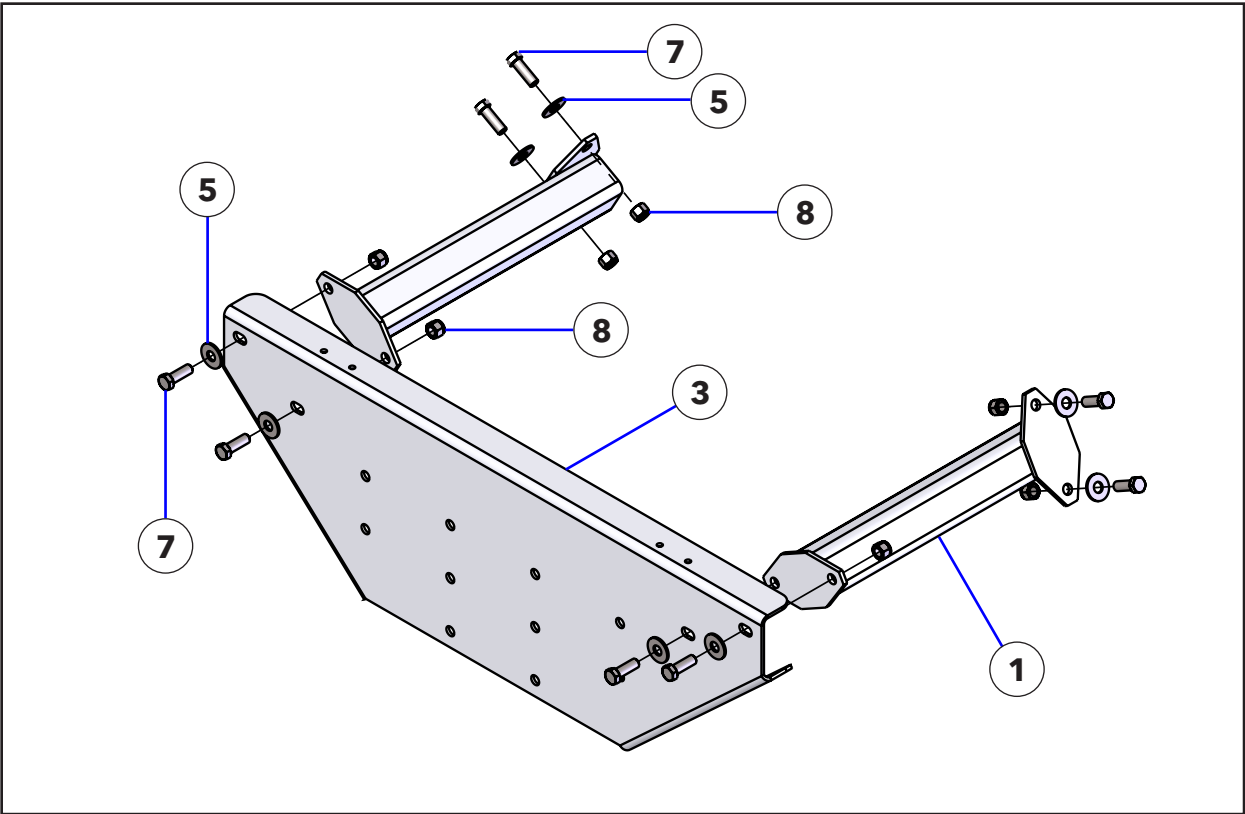

BOM ID	Qty	Item No	Description
1	4	5CAM9038	TARP CHANNEL MOUNT
2	2	5C000008	TARP SUPPORT BRACKET, AERO/ROLL-RITE
3	2	5C000021	AERO TARP MOUNT PLATE ASSY
4	8	1AFBP3612	NUT, HEX LOCK, 3/8-16, TOP LOCK, GR C, PLTD
5	16	1AF009H0000	WASHER, FLAT, 1/2", PLTD
6	8	1AFC12FAA05	HEX BOLT, 3/8-16 X 1", GR 5, PLTD
7	16	1AFC12HAAH8	HEX BOLT, 1/2-13 X 1-1/2", GR 8, PLTD
8	16	1AFC18H0000	NUT, HEX LOCK, 1/2-13, NYLON, PLTD

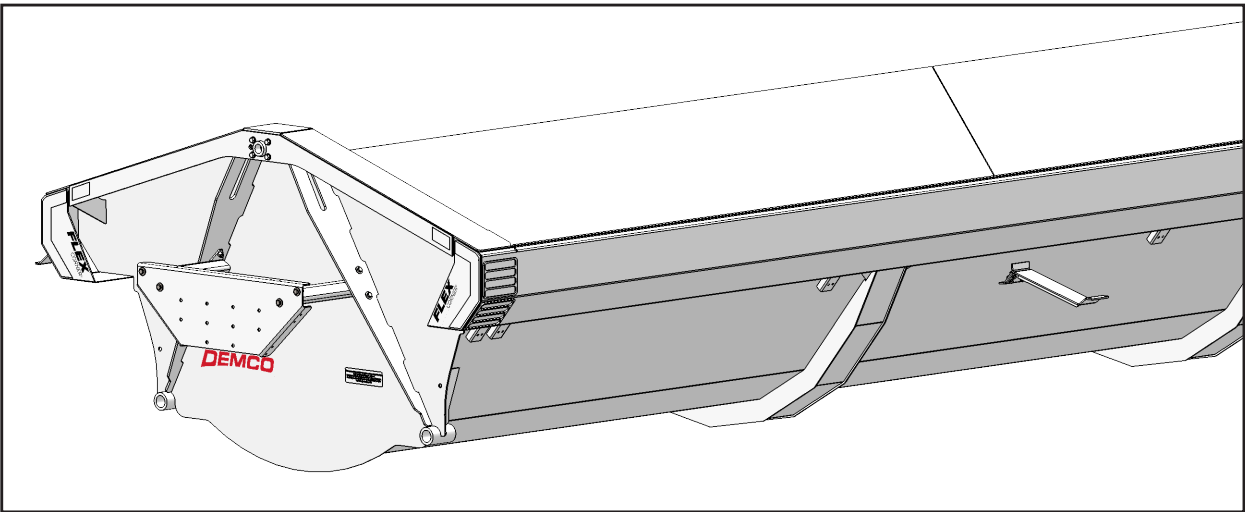

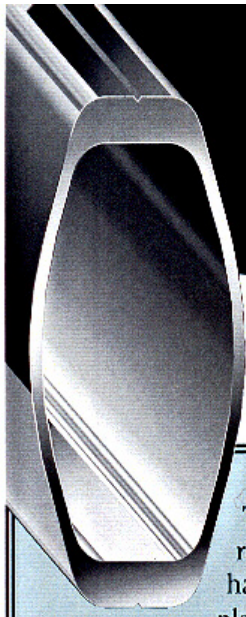

Tarp Tips...

This section will be occasionally featured in your TarpTalk™ to address frequently asked questions or to refresh you on various technical issues. As always, if you have a question or encounter frequent technical issues, please contact the Roll-Rite Customer Service Center at 1-800-297-9905 or check out our FAQs online at www.RollRite.com under Customer Support.

Q. *My motor is not working. How do I tell if the problem is with the motor, the relay, or the switch?*

A. Follow steps 1-4 below to trouble-shoot your system:

- 1.** Disconnect both power wires from the motor. Using jumper cables and a fully charged spare battery, momentarily supply power to the motor terminals, first one direction, and then the other. If the motor does not run, please call our Customer Service department at 1-800-297-9905. If the motor runs when connected to the spare battery, then the motor is OK and you need to re-connect the original power wires to the motor and continue Step 2.
- 2.** Using a test light or a voltage meter, verify that the BATT+ and BATT- terminals on the relay are properly connected. If not, check the wiring and circuit breaker between the battery and the relay for problems such as loose terminals and/or worn, broken, or pinched spots on the wire. If power is reaching the relay, continue to Step 3.
- 3.** Using a small piece of jumper wire, momentarily connect first the T1 terminal and then the T2 terminal to BATT+. You should be able to hear the relay click each time and the motor should operate each time. If you do not hear the relay click, please call our Customer Service department. If you hear the relay click but the motor does not operate, then you need to check the wiring between the relay and the motor. If you hear the relay click **and** the motor operates, then the relay is OK and you need to continue to Step 4.
- 4.** The following procedure assumes that you are using a standard SPST switch similar to the one that was shipped with the relay. If you are using something else, such as a lighted switch, you may have to adjust the procedure accordingly. Using a small piece of jumper wire, momentarily connect the center terminal (common) first to one of the outer terminals, and then to the other outer terminal. If the motor does not operate during this test, then you need to check the wiring between the switch and the relay. If the motor operates during this test, then the problem is in the switch, please call our Customer Service department. ■

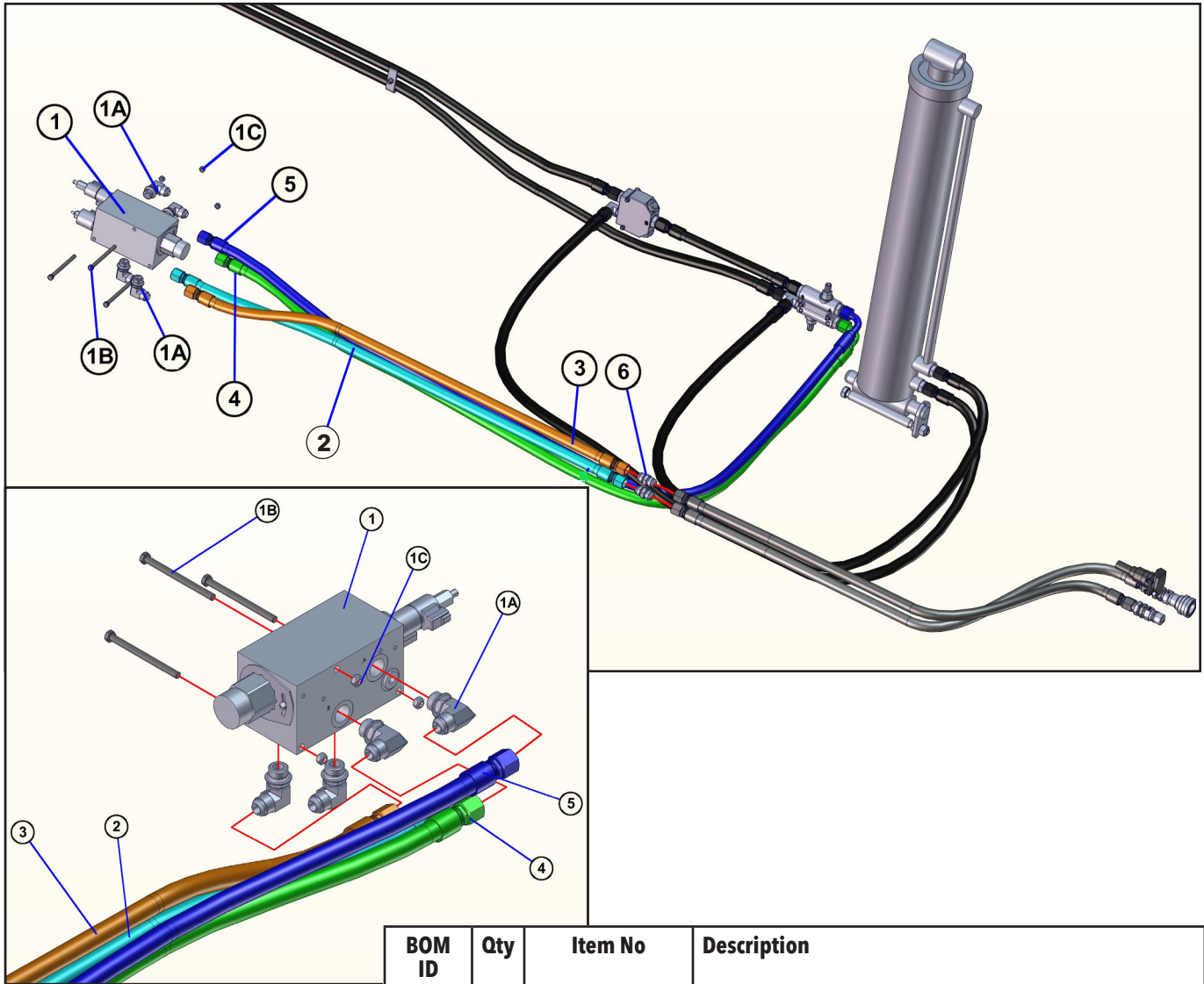

BOM ID	Qty	Item No	Description
1	1	1AAAP4543	VALVE, EOH, TRAILERPRO 302-578
1A	4	1AKDP6538	ADAPTER, 12MJ-12MSAE 90 DEGREE, 6801-12
1B	3	1AFBP3118	HEX CAP SCREW, 3/8"-16 X 5", GR 5, PLTD
1C	3	1AFBP3612	NUT, HEX LOCK, 3/8"-16, TOP LOCK, GR C, PLTD
2	1	1AKDP6546	HOSE, HYDRAULIC, 3/4" X 57", 12FJX-12FJX
3	1	1AKDP6554	HOSE, HYDRAULIC, 3/4" X 53", 12FJX-12FJX
4	1	1AKDP6614	HOSE, HYDRAULIC, 3/4" X 105", 12FJX-12FJX90
5	1	1AKDP6615	HOSE, HYDRAULIC, 3/4" X 108", 12FJX-12FJX90
6	2	1AKDP4388	UNION, 12MJ-12MJ, 2403-12

TO CONVERT YOUR SIDE DUMP TO TRAILER PRO ELECTRIC CONTROLS, CONTACT YOUR DEALER FOR COMPLETE KIT AND PRICING FOR 4CFK2018 (KIT, TRAILER PRO, EOH VALVE ADD-ON).

**TO ADD A CONTROL BOX TO A SECOND TRACTOR:
CONTACT YOUR DEALER FOR
4CFK2017 (KIT, TRAILER PRO CONTROL BOX FOR 2ND TRACTOR, W/ROLL-RITE)
FOR DEMCO SIDE DUMPS EQUIPPED WITH ROLL-RITE TARPES;**

-OR-

**CONTACT YOUR DEALER FOR
4CFK2016 (KIT, TRAILER PRO CONTROL BOX FOR 2ND TRACTOR, W/AERO)
FOR DEMCO SIDE DUMPS EQUIPPED WITH AERO TARPES.**

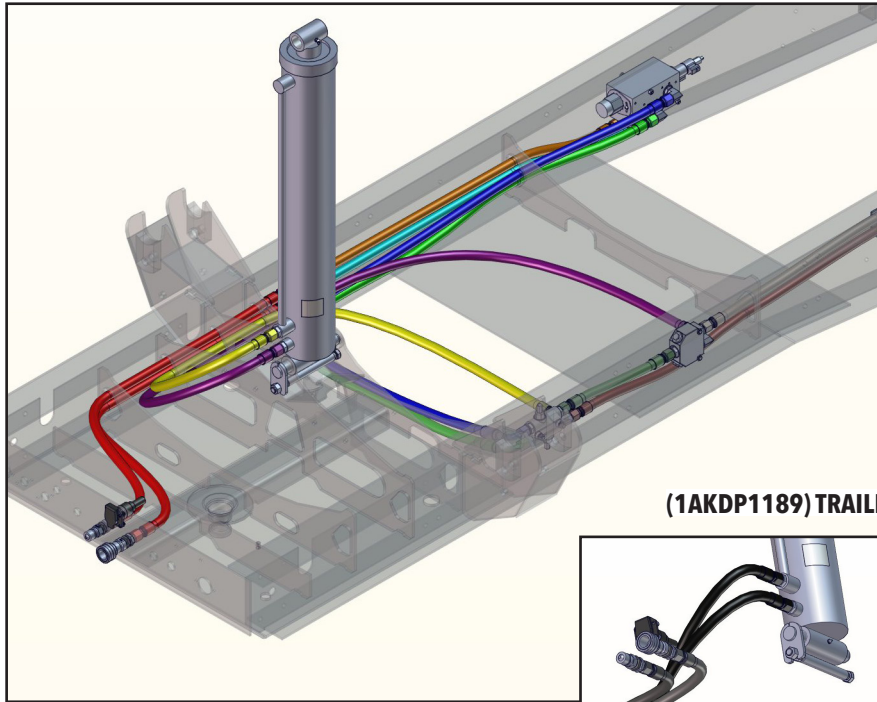

(1AKDP1189) TRAILER PRO HOSE KIT; 4CFK2018

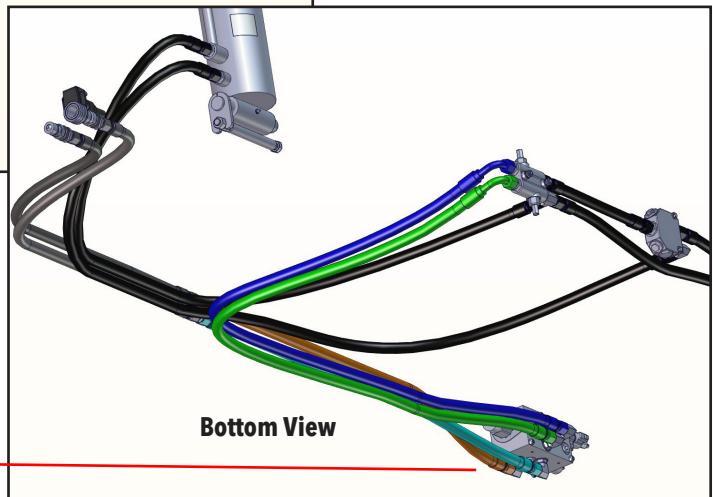

Bottom View

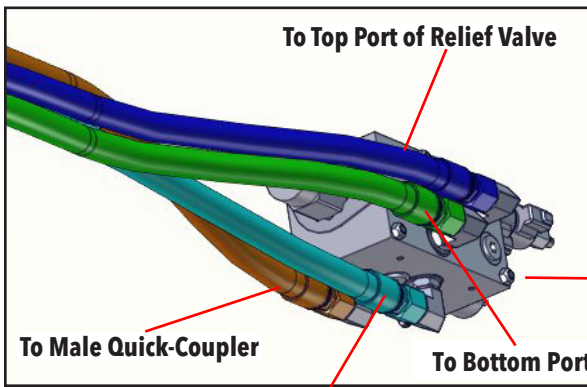

To Male Quick-Coupler

To Bottom Port of Relief Valve

To Female Quick-Coupler

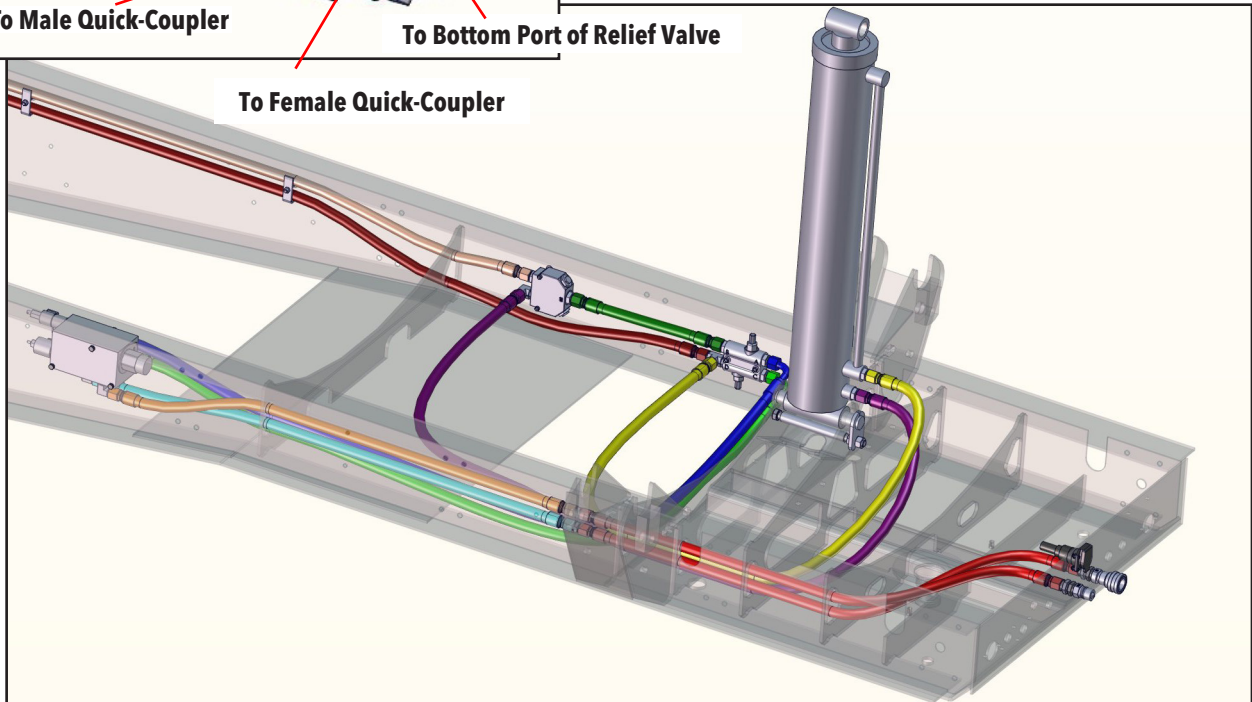

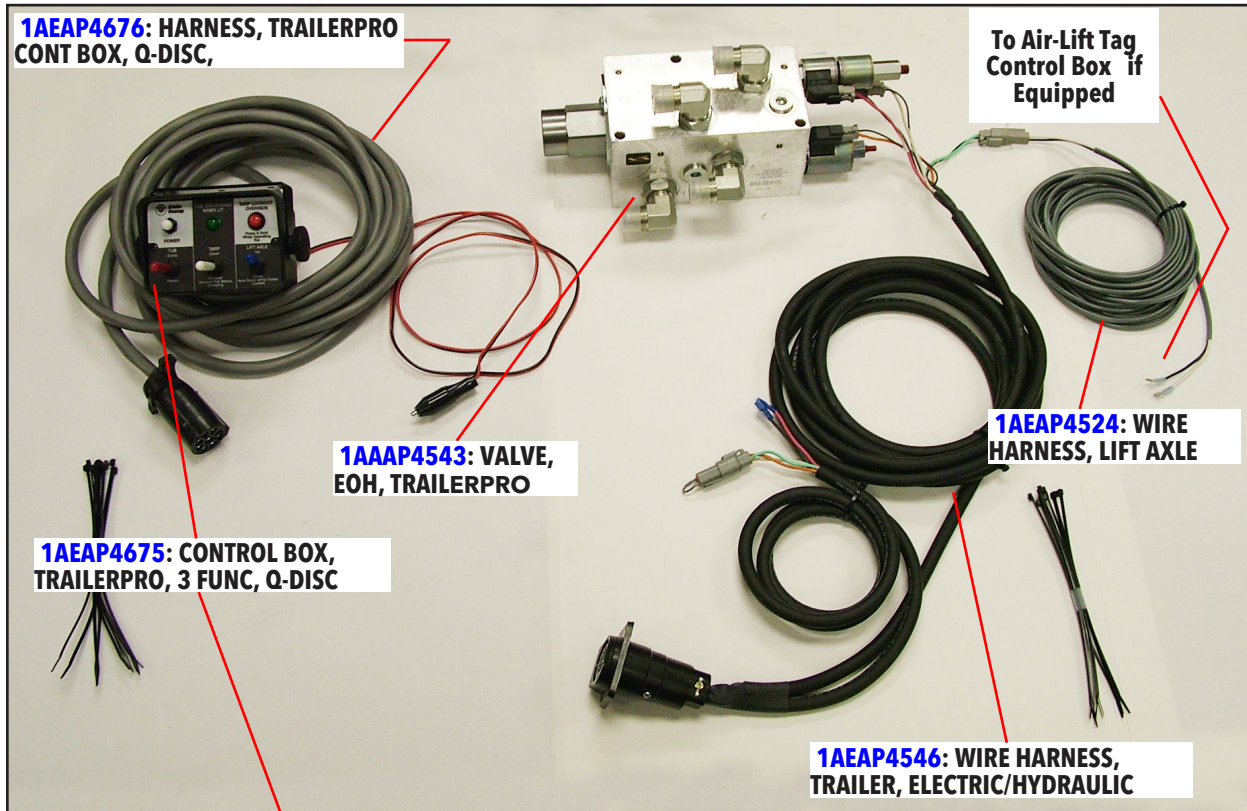

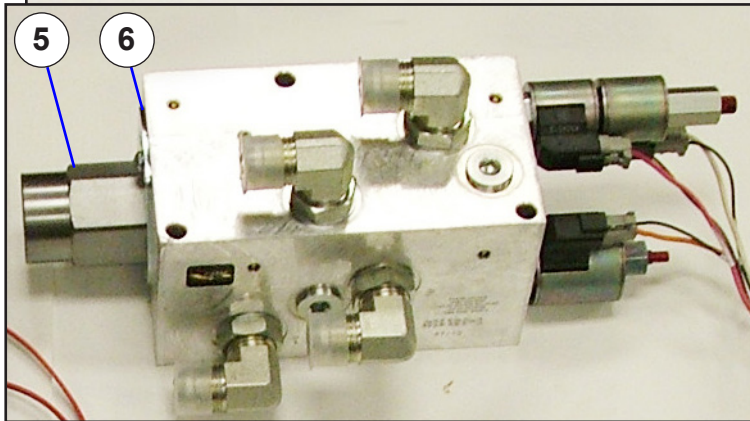
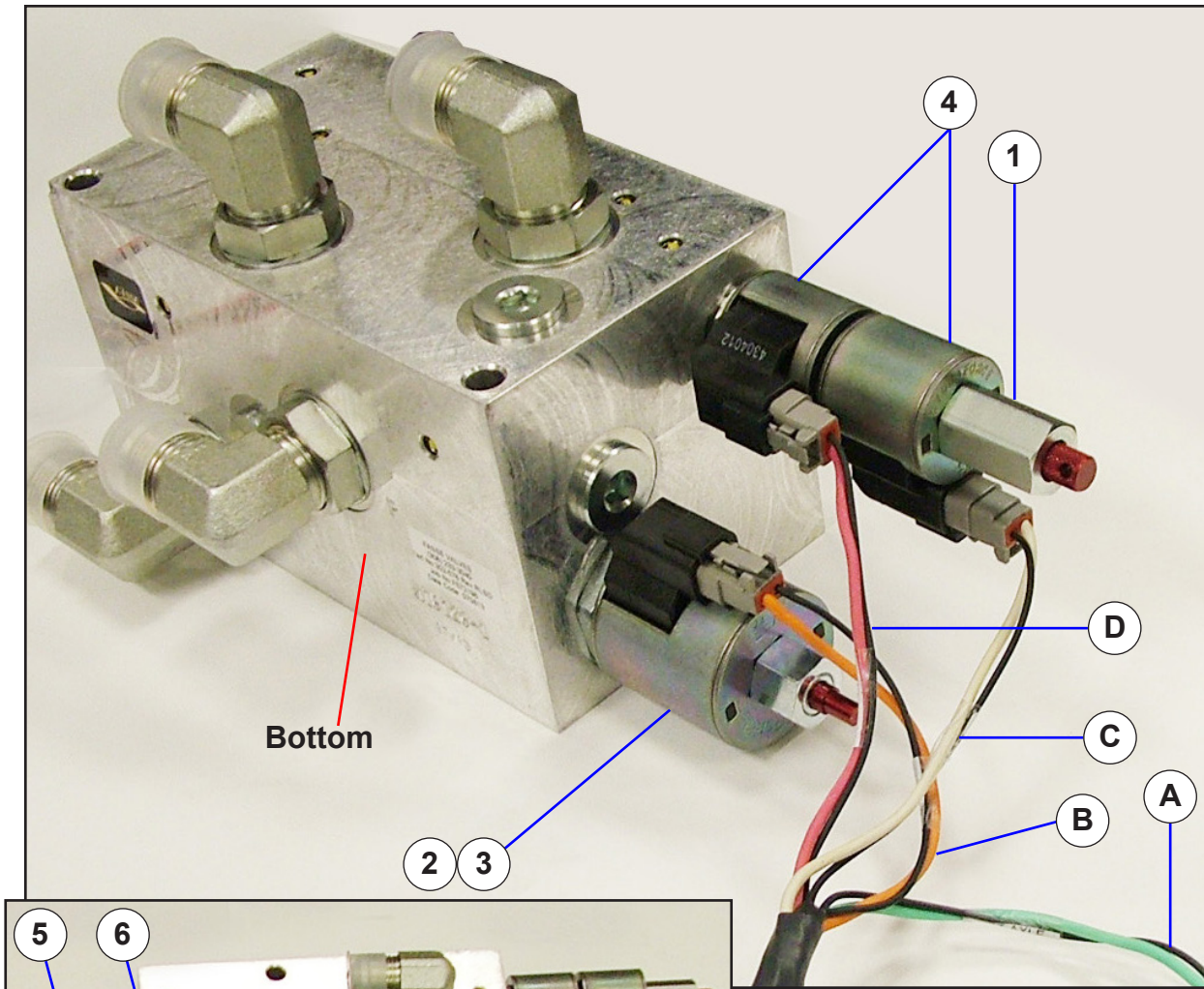

BOM ID	Color	Connection
A	GREEN / BLACK	TO LIFT AXLE
B	ORANGE / BLACK	FLOW CONTROL COIL
C	WHITE / BLACK	DIRECTIONAL CONTROL COIL
D	RED / BLACK	DIRECTIONAL CONTROL COIL

BOM ID	Qty	Item No	Description
1	1	1AAAP4590	CARTRIDGE, EOH VALVE, DIRECTIONAL, 273-982
2	1	1AAAP4591	CARTRIDGE, EOH VALVE, FLOW CONTROL, 273-339
3	1	1AAAP4605	COIL, EOH VALVE, 1.81" OD, FLOW CONTROL, 10V, 253-800
4	2	1AAAP4606	COIL, EOH VALVE, 1.43" OD, DIRECTIONAL, 10V, 253-071
5	1		CARTRIDGE, HYD, HPD42-S67C, 273-340
6	1		LOCK NUT ADAPTER, CARTRIDGE HYD, 273-341

Installing the Control Box in the Tractor

Find a suitable location in the cab of the tractor and mount the control box. The red and black two wire cable attached to the back of the box is the power cable. Plug the cigarette lighter end into a power outlet in the cab.

If you do not have an available outlet for the cigarette lighter end, use the following instructions:

- Cut the cigarette lighter plug off.
- Split apart the wires and connect the red wire to a 12 volt dc power source and the black wire to ground.
- A bag of terminals is included to allow you to tap into most fuse panels.



WARNING: Red wire must be positive and black wire negative. Reversing these wires can damage the control system. Route the gray cord and male 9 pole plug out of the cab and to the front bulkhead of the side dump. Plug the cord into the female 9 pole socket on the side dump bulkhead.

To operate your Demco side dump, your tractor will need a hydraulic pump that can supply a minimum of 25gpm to the trailer at 2,500 psi. See page 36 for more information on the tractor's hydraulic requirements.

Operating the TrailerPro Control Box

If your side dump is equipped with a tarp, you will also need to wire a power cord from the tractor's battery to the side dump to supply power to the tarp's motor. For wiring instructions, see pages 56-58 for an Aero tarp option or pages 64-66 for a Roll-Rite tarp option. For more detailed wiring instructions, refer to the online Parts Manual.

Press the "Power" button to turn the system on. The button will light up to indicate the power is on. Press the button again to turn the system off.

Dumping the Tub

When the green light in the top center is illuminated, the tub can be dumped. (See Tarp Lock Out Option on next page.)

The red switch in the lower left corner operates the tub. To dump the tub, turn on the tractor's hydraulic pump and then lift and hold the red toggle in the "dump" position to raise the tub and empty its contents. Release the switch when the cylinders reach the fully extended position.



WARNING: Do not stop dumping the load in mid dump and then try to return the tub to the transport position. You may tip over the side dump instead of returning the tub. Push and hold the red switch in the "Return" position to bring the tub back to its transport position. Release the switch when the cylinders are fully retracted.

ELECTRICAL SYSTEM

MALFUNCTION	PROBABLE CAUSE	CORRECTIVE ACTION
All lights fail to light.	Inter-vehicular cable not properly plugged into receptacles on semi-trailer and towing vehicle	Pull plugs out and reinsert them. Be sure plugs seat properly.
	Light switch on towing vehicle is malfunctioning	Check light switch.
	No current from towing vehicle	Check circuit breaker and wiring on towing vehicle.
	Short circuit in wiring	Check wiring for bare spots in insulation.
	Dirty or corroded contacts in receptacle or on plug of inter-vehicular cable	Clean receptacle and plug.
	Dirty or corroded contacts in connectors of semi-trailer wiring	Clean corroded contacts in connectors.
Lights burn dim or flicker.	Loose, dirty, or corroded terminals	Clean and tighten terminals.
	Poor or loose ground	Clean and tighten terminals on short (ground) cable.
	Defective lamps	Replace defective lamps.
	Dirty or corroded lamp socket or contact in receptacle, or on plug of inter-vehicular cable	Clean or replace lamp socket, receptacle, or plug.
Individual lamps do not light.	Burned out lamp	Replace lamp.
	Broken or loose connection	Tighten, repair, or replace broken connections. Clean poor or dirty connections.
	Damaged light assembly	Repair or replace light assembly.
	Dirty or corroded lamp socket	Remove lamp and clean contacts.
	Dirty or corroded contact in receptacle or on plug of inter-vehicular cable	Clean receptacle and plug.

HYDRAULIC SYSTEM

MALFUNCTION	PROBABLE CAUSE	CORRECTIVE ACTION
Tub will not dump.	Hoses not connected to power unit	Clean hydraulic coupler and connect to trailer.
	Power unit malfunction	Check power unit pressure and flow rate.
	Ruptured line or loose fitting	Check for hydraulic leaks - replace hydraulic hose and/or fitting.
	Hydraulic cylinder	Replace cylinder packing.
	Proportional valve	Check pressure at both cylinders for equal pressure.
	Double relief valve	Adjust high-pressure relief cartridge.
Tub dumping slowly.	Dirt in relief valve	Disassemble valve. Clean with diesel fuel or kerosene, or replace cartridge.
	Chattering noise in relief valve	Dirty valve or pressure set too low and by-passing. Check pressure setting.
	Power unit hydraulic system	Check pressure and flow rate on power unit.

TARP (Roll-Rite Optional Part)

MALFUNCTION	PROBABLE CAUSE	CORRECTIVE ACTION
The motor is not working (RollRite Tarp Brand)	Power Supply Issue	Disconnect both power wires from the motor. Using jumper cables and a fully charged spare battery, momentarily supply power to the motor terminals, first one direction, and then the other. If the motor does not run, call RollRite Customer Service at 1-800-297-9905. If the motor runs when connected to the spare battery, then the motor is OK. Reconnect original power wires to the motor.
	The wiring and circuit breaker between the battery and the relay	Use a test light or a voltage meter to verify that the BATT+ and BATT- terminals on the relay are properly connected. If not, check the wiring and circuit breaker between the battery and the relay for problems, such as loose terminals and/or worn, broken, or pinched spots on the wire.
	The relay not clicking with T1 & T2 attached to BATT+	Use a small piece of jumper wire, momentarily connect first the T1 terminal and then the T2 terminal to BATT+. If you do not hear the relay click, call the RollRite Customer Service at 1-800-297-9905.
	The wiring between the relay and the motor	Use a small piece of jumper wire, momentarily connect first the T1 terminal and then the T2 terminal to BATT+. If you hear clicking but the motor does not operate, check the wiring between the relay and the motor.
	The wiring between the switch and the relay	Assuming that you are using a standard SPST switch similar to the one that was shipped with the relay, (if you are using something else, you may have to adjust the procedure accordingly) use a small piece of jumper wire to momentarily connect the center terminal (common) first to one of the outer terminals. Then repeat for the other outer terminal. If the motor does not operate during this test, check the wiring between the switch and the relay.
	The Switch	Assuming that you are using a standard SPST switch similar to the one that was shipped with the relay, (if using something else, adjust the procedure accordingly) use a small piece of jumper wire to momentarily connect the center terminal (common) first to one of the outer terminals. Then repeat for the other outer terminal. If the motor operates during this test, then the problem is in the switch, call RollRite Customer Service at 1-800-297-9905.
For Additional FAQs on RollRite Tarps		Please go online to www.RollRite.com and then to the Customer Support section or call Customer Support at 1-800-279-9905

TARP (Aero Optional Part)

MALFUNCTION	PROBABLE CAUSE	CORRECTIVE ACTION
Cover only partially deployed and CANNOT get to covered position (Aero Tarp Brand)	Power loss or failure	<p>WARNING! The Aero Side Kick 2 cover system operates under extreme spring tension to drive the swing-arms. To reduce the possibility of injury, the swing arms must be secured before servicing the system. The following instructions are for a temporary field repair. Contact Aero Industries or your Side Kick dealer for standard repairs.</p> <p>Step 1: Secure Swing Arms. Attach come-alongs to the swing-arms, NOT the roll bar. 1) See Figure 1. Attach one end of the come-along to the front swing arm (A), near the motor housing. Attach the other end of the come along to the trailer on the side the tarp is anchored (B). 2) Attach another come-along between the rear swing-arm (C) and the trailer (D). 3) Tighten the come-alongs equally until the tarp becomes slack and the swing-arms are secure.</p> <p>Step 2: Disengage the Motor 1) Once the swing-arms are secure, remove 3 hex head cap screws from front roll-up bar adaptor attached to front roll tube and slide front swing arm (with front roll-up bar adaptor) out of front of roll-up bar and remove rear swing arm by removing outside 1-1/4" lock collar from rear roll-up bar adaptor and sliding arm off back of roll tube.</p> <p>Step 3: Complete the Covering Process WARNING! The come-alongs are now retaining the force of the swing-arm spring tension. Use great care and make sure you understand how the come-along operates before adjusting. 1) To cover the trailer, slowly and equally adjust the come-alongs until the roll tube is resting in the supports on the driver-side of the trailer. Remove or secure the come-alongs before transport. WARNING! The tarp must be in the fully unrolled position and not under the latch plate, before any service/repair work can be performed.</p>
For Additional FAQs on Aero Tarps		Please go online to www.aeroindustries.com or call Customer Support at 1-800-535-9545

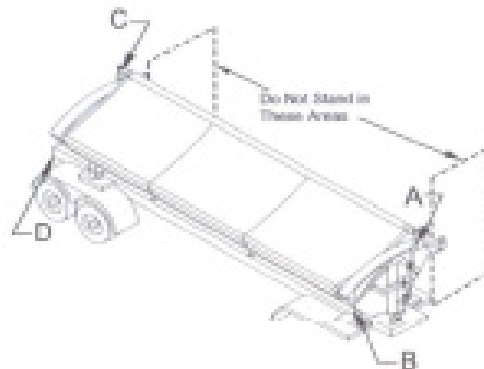

Figure 1

DEMCO

4010 320th St., Boyden, IA. 51234

Phone: (712) 725-2311

Fax: (712) 725-2380

Toll Free: 1-800-54DEMCO (1-800-543-3626)

**Demco warranty policies, operator manuals, and product registration
can be found online:**

www.demco-products.com